



**APPLICATION AND PERMIT TO OCCUPY OR
PERFORM OPERATIONS UPON A STATE HIGHWAY**

See Oregon Administrative Rule, Chapter 734, Division 55

PERMIT NUMBER

04M 54275

CLASS : KEY#

GENERAL LOCATION			PURPOSE OF APPLICATION (TO CONSTRUCT/OPERATE/MAINTAIN)		
HIGHWAY NAME AND ROUTE NUMBER Albany-Junction City 99E			<input type="checkbox"/> POLE LINE	TYPE	MIN. VERT. CLEARANCE
HIGHWAY NUMBER 058	COUNTY Linn		<input type="checkbox"/> BURIED CABLE	TYPE	
BETWEEN OR NEAR LANDMARKS Approx 95' West of Cox Creek			<input checked="" type="checkbox"/> PIPE LINE	TYPE Sanitary sewer	
HWY. REFERENCE MAP <i>GIS</i>	DESIGNATED FREEWAY <input type="checkbox"/> YES <input checked="" type="checkbox"/> NO	IN U.S. FOREST <input type="checkbox"/> YES <input checked="" type="checkbox"/> NO	<input type="checkbox"/> NON-COMMERCIAL SIGN AS DESCRIBED BELOW		
APPLICANT NAME AND ADDRESS City of Albany Public Works Attn: Chris Cerklewski 333 Broadalbin St SW Albany, OR 97321			<input type="checkbox"/> MISCELLANEOUS OPERATIONS AND/OR FACILITIES AS DESCRIBED BELOW		
			BOND REQUIRED <input type="checkbox"/> YES <input checked="" type="checkbox"/> NO		FOR ODOT USE ONLY REFERENCE: OAR 734-055-0035(2) AMOUNT OF BOND Ø
			INSURANCE REQUIRED <input checked="" type="checkbox"/> YES <input type="checkbox"/> NO		REFERENCE: OAR 734-055-0035(1) SPECIFIED COMP. DATE 12-1-2022

DETAIL LOCATION OF FACILITY (For more space attach additional sheets)

MILE POINT TO	MILE POINT	ENGINEERS STATION TO	ENGINEERS STATION	SIDE OF HWY OR ANGLE OF CROSSING	DISTANCE FROM		BURIED CABLE OR PIPE		SPAN LENGTH
					CENTER OF PVMT	R/W LINE	DEPTH/VERT.	SIZE AND KIND	
0.69	0.69	A30+98	A32+25	90 degrees	North manhole = 64' South manhole = 62'	North Manhole = 15' South Manhole = 2.5'	21.5'	30" Sanitary Sewer Carrier in 48" Steel Casing	110.5'

DESCRIPTION OF DESIRED USE

Jack and bore new 48" steel casing under Hwy 99E and install 30" sanitary sewer carrier pipe.

SPECIAL PROVISIONS (FOR ODOT USE ONLY)

TRAFFIC CONTROL REQUIRED

YES [OAR 734-055-0025(6)] NO

OPEN CUTTING OF PAVED OR SURFACED AREAS ALLOWED

YES [OAR 734-055-0100(2)] NO [OAR 734-055-0100(1)]

♦ **AT LEAST 48 HOURS BEFORE BEGINNING WORK, THE APPLICANT OR HIS CONTRACTOR SHALL NOTIFY THE DISTRICT REPRESENTATIVE** Thomas.Sagers@odot.state.or.us **AT PHONE NO.:** _____ **OR EMAIL OR FAX THIS PAGE TO THE DISTRICT OFFICE AT:** _____ **SPECIFY TIME AND DATE WORK IS TO OCCUR.**

♦ A COPY OF THIS PERMIT AND ALL ATTACHMENTS SHALL BE AVAILABLE AT THE WORK AREA DURING CONSTRUCTION.

♦ **ATTENTION: Oregon Law requires you to follow rules adopted by the Oregon Utility Notification Center. Those rules are set forth in OAR 952-001-0001 through OAR 952-001-0090. You may obtain copies of the rules by calling the center at (503) 232-1987.**

CALL BEFORE YOU DIG 1-800-332-2344

COMMENTS (FOR ODOT USE ONLY)

Permit and permission to conduct work within the ODOT right of way. See attached provisions, pages 2 - 7.

IF THE PROPOSED APPLICATION WILL AFFECT THE LOCAL GOVERNMENT, THE APPLICANT SHALL ACQUIRE THE LOCAL GOVERNMENT OFFICIAL'S SIGNATURE BEFORE ACQUIRING THE DISTRICT MANAGER'S SIGNATURE.

LOCAL GOVERNMENT OFFICIAL SIGNATURE X		TITLE	DATE
APPLICANT SIGNATURE X <i>Christopher L. Chlubek</i>	APPLICATION DATE 11/30/2021	TITLE Civil Engineer II	TELEPHONE NO. 541-917-7646
DISTRICT MANAGER OR REPRESENTATIVE X <i>Kenneth W. ...</i>			APPROVAL DATE 12/17/21

734-3457 (2/2021)

Prepared By: *[Signature]* Reviewed By: *[Signature]*

STSE

**√GENERAL PROVISIONS FOR POLELINE,
PIPELINE, BURIED CABLE PERMITS AND MISCELLANEOUS PERMITS**

(Rev) May 2003

APPLICANT: City of Albany	HIGHWAY: 058	MP: 0.69	
-------------------------------------	------------------------	--------------------	--

All checked (√) provisions apply.

WORKSITE

- √1. Permittee must call for utility locates before digging ("Call Before You Dig") 1-800-332-2344 per Oregon Administrative Rules (Chapter 952, Division 1). You may be held liable for damages. Pre-marking of excavation areas is required.
- √2. Permittee shall have a copy of this permit and all attachments at the work site. They shall be available to the District Manager or representative at their request.
3. Permittee shall acknowledge, in writing, receipt and review of Oregon Administrative Rules (Chapter 734, Division 55) governing miscellaneous facilities and operations on the highway right of way as the governing provisions of this permit or agreement. Copies of this rule may be obtained from any district maintenance office.
- √4. Permittee shall review the Oregon Administrative Rules (Chapter 734 Division 55) governing miscellaneous facilities and operations on the highway right of way as the governing provisions of this permit or agreement. Web Site: http://arcweb.sos.state.or.us/rules/OARS_700/OAR_734/734_055.html.
- √5. Access control fence must be maintained during construction and restored to its original or better condition after construction is complete.
- √6. The Permittee shall not use state highway right of way to display advertising signs or merchandise of any kind.
- √7. The stopping and parking of vehicles upon state highway right of way for the maintenance of adjoining property or in furtherance of any business transaction or commercial establishment is strictly prohibited.
- √8. All grass and small brush within the work area shall be rotary or flail mowed to ground level prior to the beginning of work to facilitate clean up. Disturbed areas shall be reseeded with grass native to the area in an appropriate seeding time.
- √9. The spreading of mud or debris upon any state highway is strictly prohibited and this violation shall be cause for immediate cancellation of the permit. Clean up shall be at the applicant's expense. The highway shall be cleaned of all dirt and debris at the end of each work day, or more frequently if so determined by the District Manager or representative.
- √10. Permittee shall replace any landscape vegetation or fences that are destroyed. Any damage that is not fully recovered within 30 days (weather permitting) shall be replaced by ODOT at the expense of the Permittee. A "plant establishment" shall be understood to be part of the planting work to assure satisfactory growth of planted materials. The plant establishment period will begin when the original planting and all landscape construction has been

completed and approved. The length of the establishment period will be one calendar year or as defined in the permit Special Provisions.

11. Permittee shall install and maintain landscaped area. Planting shall be limited to low-growing shrubs, grass or flowers that do not attain sufficient height to obstruct clear vision in any direction. The Oregon Department of Transportation (ODOT) shall have the right to remove said landscaping at any time such removal may appear to be in the public interest, without liability or loss, injury, of damage or any nature whatsoever.

TRAFFIC

- √12. During construction or maintenance, the work area shall be protected in accordance with the current Manual on Uniform Traffic Control Devices, (MUTCD), Federal Highway Administration, US Department of Transportation, and the Oregon Department of Transportation supplements thereto. Flaggers must have a card or certificate indicating their completion of an approved work zone traffic control course. All traffic control devices shall be maintained according to the American Traffic Safety Services Association (ATSSA), Quality Standards for Work Zone Traffic Control Devices handbook.
- √13. Permittee shall provide a detailed traffic control plan for each phase of the work, showing signs and cones. Plans shall be reviewed and approved by Oregon Department of Transportation in advance of construction or maintenance.
- √14. All damaged or removed highway signs shall be replaced by the permittee. Installation shall be according to MUTCD standards or ODOT specifications, and shall be completed as soon as possible but no later than the end of the work shift.
15. ~~No lane restrictions are permitted on the roadway during the hours of darkness, on weekends, or between 6:00 AM and 9:00 AM, or 4:00 PM and 7:00 PM (Monday thru Thursday off by noon on Friday) without prior approval by ODOT.~~
- √16. Traffic control with lane restrictions are permitted on the roadway with the following guidelines:
See attached EXHIBIT: DISTRICT 4 LANE RESTRICTIONS, 02/26/2018

DRAINAGE

17. On-site storm drainage shall be controlled within the permitted property. No blind connections to existing state facilities are allowed.
18. Excavation shall not be done on ditch slopes. Trench excavation shall either be at ditch bottom or outside ditch area. (Minimum depth at bottom of ditch shall be 36 inches; minimum depth outside of ditch shall be 42 inches).
19. Only earth or rock shall be used as fill material and shall slope so as not to change or adversely affect existing drainage. Fine grade and seed the finished fill with native grasses to prevent erosion.
20. A storm drainage study stamped by an Oregon Registered Professional Engineer (PE) is required. The study must meet standards of the National Pollution Discharge Elimination Systems (NPDES) when any of the following conditions apply:
 - Whenever a four inch pipe is inadequate to serve the developed area,

- development site is one quarter acre or larger in size, OR contributes one half cubic feet per second OR directly or indirectly affects state facilities,
 - or as directed by the District Manager or representative.
 - An advance deposit for ODOT hydrology reviews may be required.
21. Permittee shall provide on-site retention for storm water runoff that exceeds that of the undeveloped site.
22. All water discharged to an ODOT drainage system must be treated prior to discharge. All requests for connection to an ODOT storm system must meet any requirements of the National Pollutant Discharge Elimination System (NPDES). This may include local jurisdiction approval of on-site water quality treatment facilities and/or development of an operation and maintenance plan for any on-site water quality treatment facility, as determined by local jurisdiction

EXCAVATION/CONSTRUCTION

- √23. The following ODOT documents and any supplements and subsequent revisions thereto, where applicable and not otherwise superceded by the permit language herein, but only to the extent that they provide standards and performance requirements for work to be performed under the permit, shall be incorporated for use in the permit: "Oregon Standard Specifications for Construction (2015)" and relevant Metric Standard Drawings. ODOT shall have authority over acceptance of all materials and workmanship performed under this permit as stated in Section 00150.00 of the "Oregon Standard Specifications for Construction (2015)." For additional Supplemental and Special Provisions please refer to: <http://www.odot.state.or.us/techserv/roadway/specs/home.htm>. Standard Specification books are available on this site.
24. Open cutting of pavement is allowed in areas specifically approved by District Manager or representative.
25. Trench backfill shall be according to the attached typical drawing, marked as Exhibit A or B. Which ever applies.
26. Open cutting of the highway is allowed with construction in accordance with OAR 734-55-0100. All excavation in paved areas shall be backfilled and the roadway surface patched before the end of each shift. In special cases where steel plates are allowed, said plates shall be pinned and a temporary cold patch applied to the edges. The permittee shall be fully responsible for monitoring and maintenance of temporary patching and steel plating.
27. Compaction tests shall be required for each open cut per Oregon Standard Specification for Construction. Compaction tests shall be conducted once for every 300 lineal feet per lift of continuous trench according to the Manual of Field Test Procedures (MFTP), published by ODOT. Percent Compaction shall be 95%. At the discretion of the District Manager or representative, results of compaction test shall be provided to District Manager or representative at applicants' expense.
28. Control Density Fill (CDF) shall be used as surface backfill material in place of crushed rock in open trenches that impact the travel portions of the highway. A ¾"-0, or 1"-0 rock will be used for the aggregate. The amount of cement used shall not exceed 3.0% of the total mixture's weight. Maximum compressed strengths must not exceed 250 pounds per square inch (psi).
29. Surface restoration shall be a minimum of eight inches of hot asphalt-concrete (AC), compacted in two inch lifts, or match existing pavement depth, whichever is greater. Sand-seal all edges and joints.
- √30. All aggregate shall conform to Oregon Standard Specification for Construction, Section 02630 - Base Aggregate.

- √31. Any area of cut or damaged asphalt shall be restored by the applicant (call ODOT for restoration requirements). For a period of two years following the patching of paved surface, permittee shall be responsible for the condition of permittee's pavement patches, and during that two year period shall repair to District Manager or representative satisfaction any of the patches which become settled, cracked, broken, or otherwise faulty.
32. An overlay to seal an open-cut area shall be completed prior to the end of the construction season, or when minimum temperature allows per "Oregon Standard Specification for Construction" and any subsequent revisions thereto. Typical overlay shall be 1.5 inches deep and cover the affected area from edge of pavement to edge of pavement, and taper longitudinally at a fifty feet to one inch (50' : 1") ratio. Taper may be adjusted by the District Manager as required. For a period of two years following this patching of the surface, the permittee shall be responsible for the condition of said pavement patches, and during that time shall repair to the District Manager or representative's satisfaction any of the patches which become settled, cracked, broken or otherwise faulty.
- √33. Highway crossings shall be bored or jacked. Bore pits shall be located behind ditch line or in areas satisfactory to the District Manager. Unattended pits shall either be protected by a six-foot fence, backfilled, or steel plated and pinned.
- √34. Permittee shall install a "tracer wire" or other similar conductive marking tape or device, if installing any non-conductive, un-locatable underground facility, in order to comply with Oregon Utilities Coordination Council (OUCC), per OAR 952-01-0070 (6).
- √35. Trench backfill outside of ditch line or in approved areas can be native soil compacted at optimum moisture in twelve inch layers to 90% or greater of the maximum density.
- √36. Native material that is found to be unsatisfactory for compaction shall be disposed of off the project and granular backfill used.
- √37. Trench backfill in rock slope or shoulder shall be crushed 1"-0 or ¾"-0 size rock compacted at optimum moisture in eight-inch layers. Compaction tests shall be conducted according to the Manual of Field Test Procedures (MFTP), published by ODOT. Percent compaction shall be 95%. At the discretion of the District Manager or representative, results of compaction tests shall be provided to District Manager or representative at applicant's expense.
- √38. Where excavation is on fill slope steeper than a two to one (2:1) ratio, slope protection shall be provided using four-inch size rock laid evenly to a minimum depth of twelve inches.
- √39. No more than 300 feet of trench longitudinally along the highway shall be left open at any one time and no trench shall be left in an open condition overnight (during non work hours).
40. Areas of disturbed cut and fill slopes shall be restored to a condition suitable to the District Manager or representative. Areas of erosion to be inlaid with an acceptable riprap material.
- √41. All underground utilities shall be installed with three-foot or more of horizontal clearance from existing or contract plans guardrail posts and attachments. All non-metallic water, sanitary and storm sewer pipe shall have an electrically conductive insulated Number 12-gauge copper tracer wire the full length of the installed pipe using blue wire for water and green for storm and sanitary sewer piping.
- √42. Any area of cut or damaged concrete shall be restored in accordance with the attached Typical Section-Pipe Section under sidewalk.

- √43. Utility markers and pedestals shall be placed as near the highway right-of-way line as practical. In no case shall pedestals and line markers be located within the highway maintenance area.
- √44. No cable plowing is allowed within the lateral support of the highway asphalt (i.e. at six feet lower than the edge of the asphalt, no plowing within nine feet of the edge of the asphalt).
- √45. Review by ODOT Bridge Engineers is required for all proposed bridge and structure attachments and for utility or any facilities to be installed within sixteen feet of bridge foundations, supports, and walls or related, or within the influence zone of bridge facilities.

Miscellaneous:

- √46. Permittee shall be responsible and liable for (1) investigating presence/absence of any legally protected or regulated environmental resource(s) in the action area; (2) determining any and all restrictions or requirements that relate to the proposed actions, and complying with such, including but not limited to those relating to hazardous material(s), water quality constraints, wetlands, archeological or historic resources(s) state and federal threatened or endangered species, etc., (3) complying with all federal, state, and local laws, and obtaining all required and necessary permits and approvals.
- √47. If the permittee impacts a legally protected/regulated resource, permittee shall be responsible for all costs associated with such impact, including, but not limited to all costs of mitigation and rehabilitation, and shall indemnify, and hold ODOT harmless for such impacts and be responsible and liable to ODOT for any associated costs or claims that ODOT may have.
- √48. Plans are approved by ODOT in general only and do not relieve the permittee from completing construction improvements in a manner satisfactory to ODOT. The District Manager or representative may require field changes. When revisions are made in the field, permittee is responsible to provide "as built" drawings, within 60 days from completion of highway improvements, and shall submit them to the District Office issuing the permit.
- √49. Permittee shall be responsible for locating and preserving all existing survey monumentation within the work area in accordance with ORS 209.150 and/or 209.155. If monumentation or its accessories are inadvertently or otherwise disturbed or destroyed, applicant shall be responsible for all costs and coordination associated with it's reestablishment by a professional licensed surveyor.

SPECIAL PROVISIONS

- √50. Any areas of damaged curb and/or sidewalk shall be restored to a like new condition. All damaged sections shall be saw-cut to the next joint and the panel replaced in its entirety. If the highway surface or highway facilities are damage by the applicant, applicant shall replace or restore the highway or highway facilities to a condition satisfactory to ODOT, whether discovered at the time of installation or at a later date. ODOT may have the applicant replace or restore the highway or highway facilities to a condition satisfactory to be determined by ODOT. ODOT may choose to replace or restore the highway or highway facilities by contractor or state forces and the costs incurred to be paid by the applicant under the terms outlined in OAR 734-055-0020(2). The contractor will be notified of the damages and given 48 hours to comply. In those situations where public safety has been impaired no notice will be given. CALL THE ODOT CONTACT LISTED ON PAGE 1 OF THIS PERMIT FOR PAVEMENT RESTORATION REQUIREMENT.

- √51. NO UNPROTECTED CLEATS ON THE ASPHALT. Any damages resulting from the applicant's operations shall be immediately identified on the road in a manner approved by Authorized Officer, until repairs are made to the satisfaction of the ODOT District Manager or his/her representatives. Any damage to the asphalt surface or shoulder shall be temporarily repaired within 24 hours. Track cleats may be accepted upon request provided that plywood, tires, or any other acceptable means can protect the asphalt.
- √52. All equipment shall be parked off the right-of-way or in areas acceptable to the ODOT District Manager or ODOT representative.
- √53. Work site shall be restored to "as found" or better condition.
- √54. The staging of materials on the highway asphalt is not allowed. This includes rock, backfill materials, spoils, constructions supplies, and etc.
- √55. ODOT Station 2 Contact Requirements:
When traffic control is required that disrupts, diverts, or may cause traffic impacts or delays contact ODOT Station 2 at 503-362-0457. You will need to provide a contact name, phone number, the highway, mile point, type of work and how long traffic will be affected.
- √56. Special Lane Closure Restrictions: No Holiday Weekend lane closures.
If the holiday falls on a Monday, the holiday weekend would be from noon on Friday – midnight on Monday.
If the holiday falls on a Thursday, the holiday weekend would be from noon on Wednesday – midnight on Sunday. OFF highway by noon on Friday.
- √57. Work is approved per the attached plan. Any deviation from the plan requires ODOT approval prior to construction. If this service is removed, it is to be removed in its entirety.
- √58. Utilities buried within 5' of a ditch section must be placed at a minimum depth of 3' below the lowest elevation of the ditch.
- √59. All utility facilities that are not at a minimum of 42" deep need to be located 3' or less to the right of way property line (and outside of the highway maintenance area). If it is not possible to locate such utilities in this location, a detail sheet that includes the type of facility, location and verbiage stating the reason of the location must be submitted to ODOT for review and written approval. These detail sheets/plans are required by ODOT, District 4 to be stamped approved as part of the permit.
- √60. All facilities must be clearly marked. In the event that this facility is damaged, ODOT will not be held responsible for repair or replacement.
- √61. When construction activities block or interfere with normal pedestrian routing, provide safe passage for pedestrians either through the construction, or rerouted around the construction, utilizing ODOT Standard Drawing TM844 and the requirements of the 2015 Oregon Standard Specifications for Construction (Brown Book), page 141, subsection 00220.02, 8th bulleted item with reference to the subsequent bulleted items.
When construction activities block or interfere with shoulders or bike Lanes, install a 48 inch " BICYCLES ON ROADWAY " sign in advance of each shoulder or bike lane closure at sign spacing "A" from the "TCD Spacing Table" shown on ODOT Standard Drawing TM800.
- √62. Contact ODOT at 541-757-4211 to discuss questions or concerns regarding this permit. Any changes or part of the permit that the applicant does not understand or agree with, must be changed or worked out prior to commencing the work.

DISTRICT 4 LANE RESTRICTIONS

02/26/2018

Highways	Mileposts	LANE RESTRICTIONS							NOTES:
		Off Hwy by 12 PM Friday	No Closures during Commute Times	No FRI/SAT closures & open by 10 AM Sunday	Nights Only	Nights Only in summer	No Weekend Closures		
I-5 / 001	209.06 - 244.68				X		X	Night work hours = 9 PM to 5:30 AM only	
99W / 001W	63.42 - 75.68	X	X						
99W / 001W	75.68 - 82.59				X				
99W / 001W	82.59 - 104.36		X						
US101 / 009	91.46 - 105.90	X					X		
US101 / 009	105.90 - 143.33				X			Daytime closures allowed 10/1-3/1 in multi-lane sections	
US101 / 009	144.37 - 167.61	X	X				X		
US20 / 016	0.00 - 1.96				X				
US20 / 016	1.96 - 32.98		X						
OR18 / 039	0.00 - 21.18	X	X			X	X		
OR34 / 027	39.81 - 58.56		X						
US20 / 033	0.00 - 5.75				X				
US20 / 033	5.75 - 49.76	X	X	X			X		
US20 / 033	49.76 - 56.80							Daytime work may be allowed in multi-lane sections	
US20 / 31	0.00 - 11.23				X			Daytime work may be allowed in multi-lane sections	
99E / 164	5.28 - 8.39		X						
99E / 058	0.00 - 5.81				X				
99E / 058	5.81 - 7.90	X	X						
OR22 / 032	10.63 - 22.01		X				X		
OR229 / 181	23.48 - 31.24		X						
OR223 / 191	4.73 - 9.95		X						
OR34 / 210	0.00 - 18.13	X	X						
OR228 / 212	0.00 - 21.46		X						

DISTRICT 4 LANE RESTRICTIONS

02/26/2018

OR200	0.00 - 2.03	X				
-------	-------------	---	--	--	--	--

**Any deviation from this document must be requested and approved by the District Manager
 More restrictions to work times may be added if the District observes traffic congestion and/or conditions that warrant a change.

No Restriction Highways	
US20 / 016	32.98 - 71.50
OR34 / 027	0.00 - 39.87
OR180	0.00 - 19.25
OR229 / 181	0.00 - 23.48
OR223 / 191	9.95 - 31.40
OR194	0.00 - 7.56
OR201 / 501	0.00 - 9.49
OR226 / 211	0.00 - 25.71
99E / 164	0.00 - 5.28
99E / 058	7.90 - 28.22

- General Restrictions:**
- 1.) No Holiday Weekend Closures
 - 2.) One lane in each direction must remain open at all times on multi-lane highways.
 - 3.) Refer to MUTCD and Oregon Temporary Traffic Control handbook for general traffic control guidelines.

Definitions:

Commute Times: 6 AM to 9 AM and 4 PM to 7 PM, Monday - Friday.
 Summer Season: June 1st - November 1st
 Night Work Hours: 7 PM to 6 AM (1-5 only: 9 PM to 5:30 AM)
 Closures: Reduction of travel lanes
 Weekend: 12 PM Friday - 7 PM Sunday
 Holiday: 12 PM the day before the holiday, OR holiday weekend through midnight on the holiday.
*Example 1 - Holiday falls on a Monday, the holiday weekend would be from 12 PM on Friday to 12 AM Monday.
 Example 2 - Holiday falls on a Thursday, the holiday weekend would be from 12 PM on Wednesday to 12 PM Sunday.*

DETERING Lynn S

04M 5 4 2 7 5

From: Schumacher, Lori <Lori.Schumacher@cityofalbany.net>
Sent: Tuesday, November 30, 2021 5:04 PM
To: WAHL Carla S; DETERING Lynn S; SAGERS Thomas *Tom
Cc: Cerklewski, Chris
Subject: ODOT Permit Application: City of Albany, SS-22-01, Cox Creek Interceptor Improvements: Phase 2
Attachments: Permit Application_ODOT_SS-22-01, City of Albany Cox Creek.pdf; SS-22-01, ODOT Detailed Map.pdf; SS-22-01, Cox Creek ODOT Plans.pdf

This message was sent from outside the organization. Treat attachments, links and requests with caution. Be conscious of the information you share if you respond.

Hello,

I am submitting the attached documents to obtain an ODOT permit for the above referenced project. You will find the requested information detailed below and attached.

- Application – Please see attached
- Application Information:
 - Address: City of Albany Public Works
Attn: Chris Cerklewski
333 Broadalbin St SW
Albany, OR 97321
 - Phone: 541-917-7646
 - Fax: 541-917-7573
 - E-mail: Chris.cerklewski@cityofalbany.net
- Detailed Map – Please see attached 90% Construction Drawings and Detailed Map.
- Open Cut Surfaces – This work will not require open cut surfaces along Hwy 99E
- Liability Insurance – The project contract will require the contractor to provide all insurance required by the permit. The contractor will provide insurance certifications to ODOT once the project is bid and awarded. This has been the typical method of acquiring the permit insurance in the past.

Please let Chris Cerklewski (copied) know if there are any additional requirements that need to be addressed.

Thank you,

**Lori Schumacher**

Civil Engineer II

Office: 541-917-7653

Fax: 541-917-7573

City of Albany, Oregon
333 Broadalbin St SW, Albany, Oregon 97321
www.cityofalbany.net

DISCLAIMER: This email may be considered a public record of the City of Albany and subject to the State of Oregon Retention Schedule. This email also may be subject to public disclosure under the Oregon Public Records Law. This email, including any attachments, is for the sole use of the intended recipient(s) and may contain confidential and privileged information. Any unauthorized review, use, disclosure or distribution is prohibited. If you have received this communication in error, please notify the sender immediately and destroy all copies of the original message.

SS-22-01, Cox Creek Interceptor Improvements, Phase 2
Detailed Map

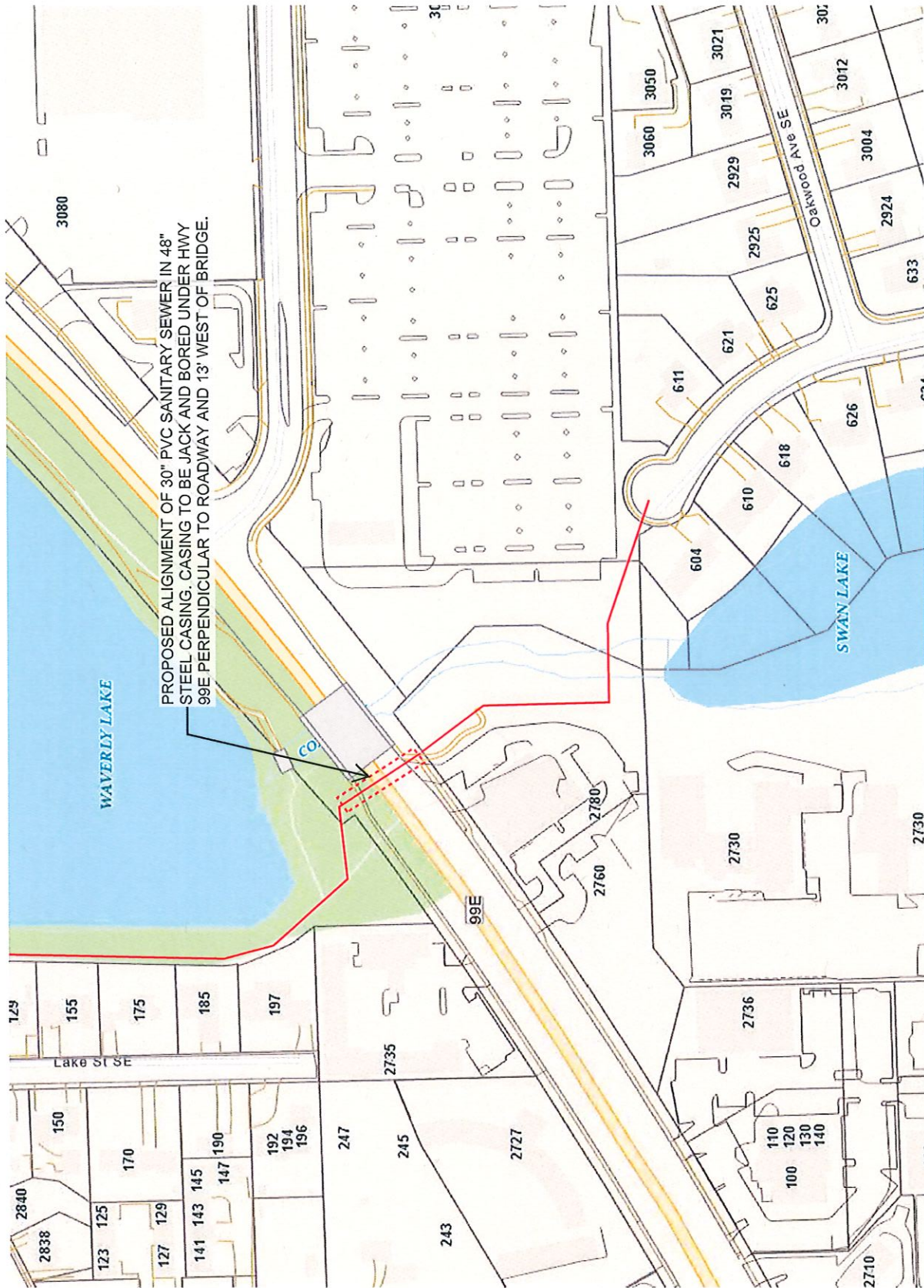

CITY OF ALBANY

SS-22-01, COX CREEK INTERCEPTOR IMPROVEMENTS: PHASE 2

SHEET INDEX

- SHEET NO. 1. COVER & GENERAL NOTES
- SHEETS NO. 2-6. COX CREEK SEWER INTERCEPTOR CONSTRUCTION
- SHEET NO. 7. BAIN STREET WATER LINE
- SHEETS NO. 8-9. SURFACE RESTORATION PLANS
- SHEETS NO. 10-14. EPSC PLAN

LEGEND	
	EXISTING WATER SERVICE
	RECONNECT EXISTING METER
	EXISTING WATER VALVE
	NEW WATER VALVE
	EXISTING WATER LINE
	EXISTING GAS LINE
	EXISTING STORM LINE
	EXISTING SANITARY SEWER LINE
	EXISTING OLD DUCT
	EXISTING COMMUNICATION LINE
	EXISTING UNDERGROUND POWER LINE
	EXISTING OVERHEAD POWER LINE
	EXISTING POWER POLE
	EXISTING SANITARY SEWER MANHOLE
	NEW CURB INLET
	NEW CATCH BASIN
	EXISTING STREET LIGHT
	EXISTING TRAFFIC SIGN
	EXISTING ATTRACTANT
	NEW WATER LINE
	NEW SEWER LINE
	NEW SANITARY SEWER MANHOLE CLEANOUT
	NEW SANITARY SEWER MANHOLE
	NEW SEWER LATERAL PROPERTY LINE CLEANOUT
	NEW SEWER LATERAL PRIVATE CLEANOUT

SCALE VARIES ON
INDIVIDUAL PLAN SHEETS

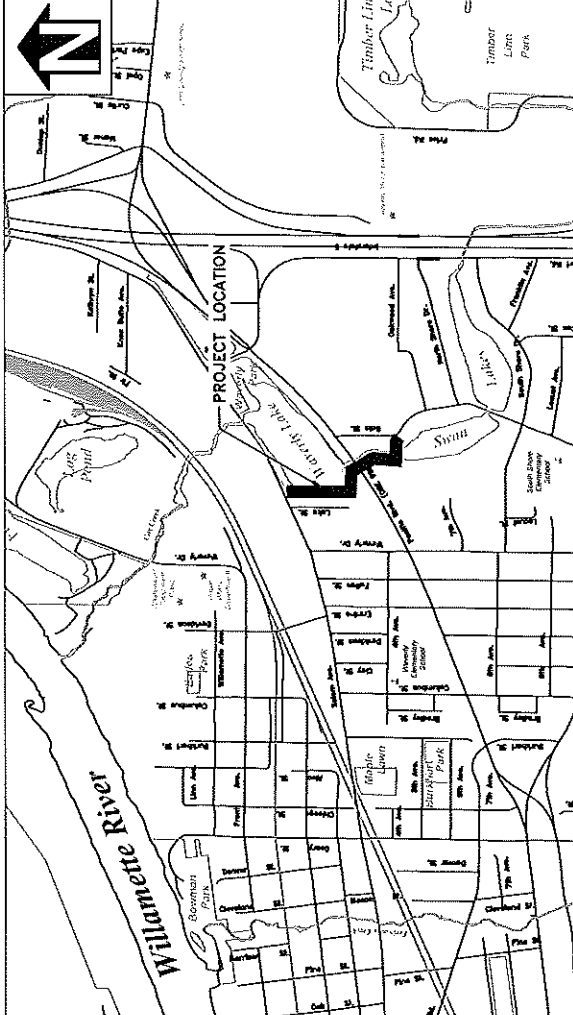

Vicinity Map
Not to Scale

GENERAL NOTES

1. ALL CONSTRUCTION SHALL CONFORM TO THE CITY OF ALBANY STANDARD CONSTRUCTION SPECIFICATIONS AND ASSOCIATED STANDARD DRAWINGS. THE CURRENT VERSION OF THE CITY OF ALBANY STANDARD CONSTRUCTION SPECIFICATIONS CAN BE FOUND ON THE CITY'S WEBSITE AT WWW.CITYOFALBANY.NET.
2. UTILITIES SHOWN ARE FOR REFERENCE ONLY. FOR A FIELD LOCATE, CALL THE UTILITIES NOTIFICATIONS CENTER AT 1-800-332-2344.
3. OPERATING ACCESS FOR CITY MAINTENANCE PERSONNEL TO EXISTING AND NEW WATER VALVES AND MANHOLES SHALL BE CONTINUOUSLY MAINTAINED BY THE CONTRACTOR DURING ALL CONSTRUCTION ACTIVITIES.
4. CONTRACTOR SHALL VERIFY ALL EXISTING PIPE ELEVATIONS, PIPE DIAMETERS, AND PIPE MATERIALS AT CONNECTION AND ABANDONMENT LOCATIONS PRIOR TO CONSTRUCTION. ANY DISCREPANCIES SHALL BE REPORTED TO ENGINEER PRIOR TO BEGINNING WORK.
5. ATTENTION: OREGON LAW REQUIRES YOU TO FOLLOW RULES ADOPTED BY THE OREGON UTILITY NOTIFICATION CENTER. THOSE RULES ARE SET FORTH IN OAR 952-001-0010 THROUGH OAR 952-001-0090. YOU MAY OBTAIN COPIES OF THE RULES BY CALLING THE CENTER. (NOTE: THE TELEPHONE NUMBER FOR THE OREGON UTILITY NOTIFICATION CENTER IS (503) 232-1987).
6. CONTRACTOR SHALL BE RESPONSIBLE FOR PROPER INSTALLATION AND MAINTENANCE OF ALL EROSION PREVENTION SEDIMENT CONTROL (EPSC) MEASURES IN ACCORDANCE WITH LOCAL, STATE, AND FEDERAL REGULATIONS UNTIL ALL CONSTRUCTION IS COMPLETED AND APPROVED BY THE CITY OF ALBANY, AND VEGETATION/LANDSCAPING IS ESTABLISHED. FOR GUIDANCE, REFER TO THE CITY OF ALBANY EPSC MANUAL WHICH CAN BE FOUND AT WWW.CITYOFALBANY.ORG.

DESIGNED BY: L. SCHUWACHER	DATE: 11/30/2021
DRAWN BY: L. SCHUWACHER	CHECKED BY: C. GERKLEWSKI
REVISIONS:	NO. BY:

SS-22-01, COX CREEK INTERCEPTOR IMPROVEMENTS: PHASE 2

PUBLIC WORKS DEPARTMENT
ENGINEERING SERVICES

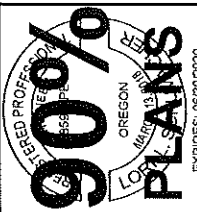

SHEET NO. 1 OF 14
PROJECT NO: SS-22-01
FILE: FILENAME.DWG

NO.	DATE	REVISIONS
1	11/30/2021	DESIGNED: L. SCHUWACHER CHECKED: C. CERKLEWSKI
2		
3		
4		
5		
6		
7		
8		
9		
10		

SS-22-01, COX CREEK INTERCEPTOR - PACIFIC BLVD (HWY 99E)
ENGINEERING SERVICES

PUBLIC WORKS DEPARTMENT
ENGINEERING SERVICES

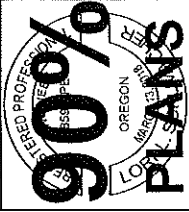

EXPIRES: 05/30/2022
SHEET NO. 4 OF 14
PROJECT NO. SS-22-01
FILE: BASE.DWG

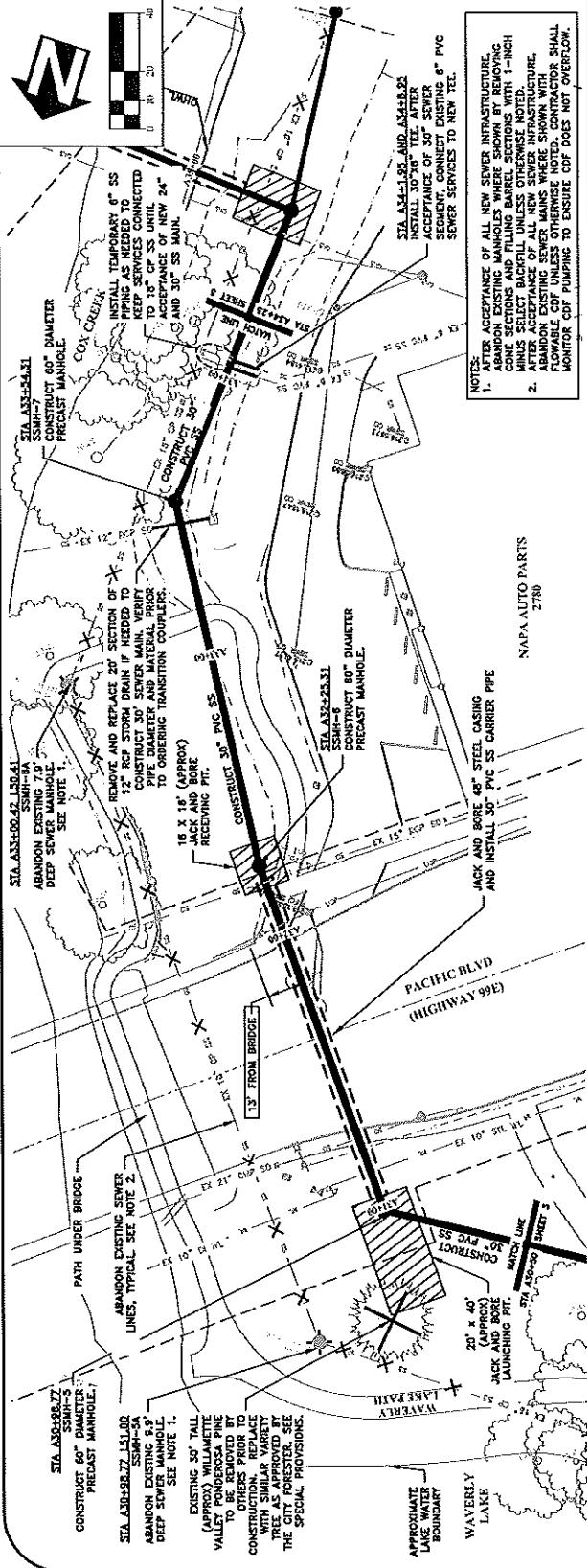

NEW COX CREEK SEWER INTERCEPTOR PROFILE

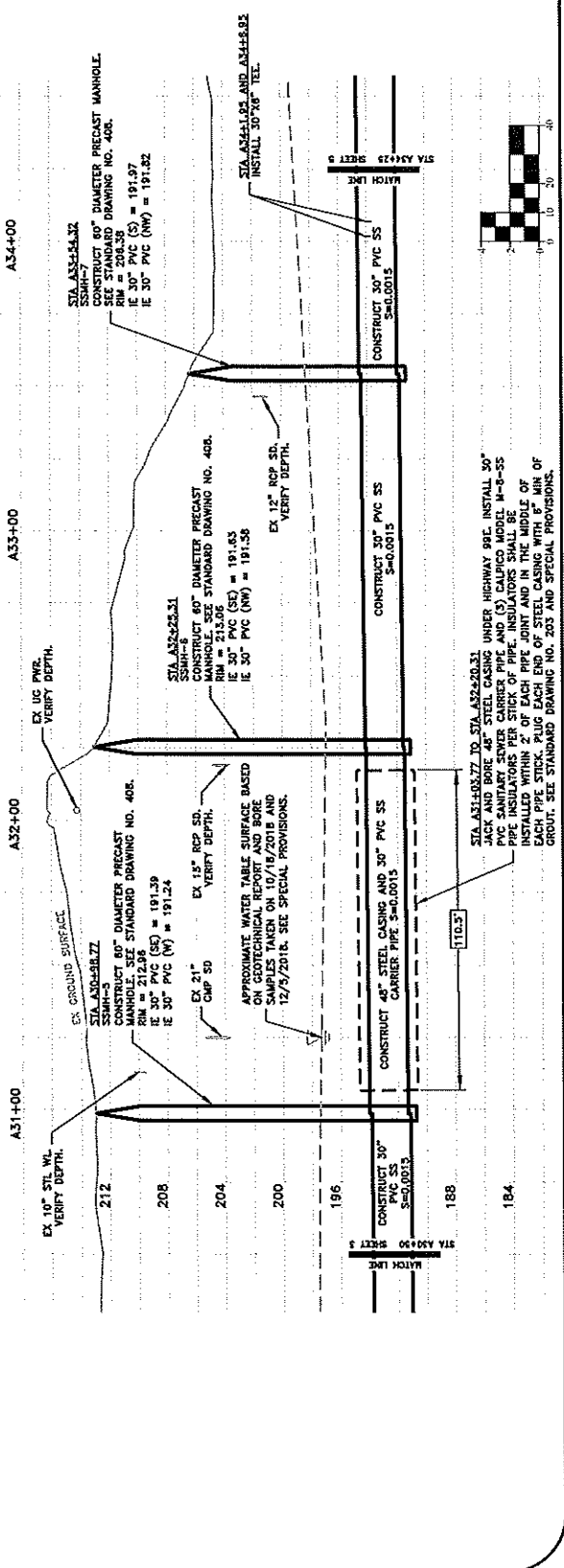

NOTES:
1. AFTER ACCEPTANCE OF ALL NEW SEWER INFRASTRUCTURE, ABANDON EXISTING MANHOLES WHERE SHOWN BY REMOVING THE 1" HIGH CONCRETE CURB. THE CONTRACTOR SHALL MONITOR CDF PUMPING TO ENSURE CDF DOES NOT OVERFLOW.
2. AFTER ACCEPTANCE OF ALL NEW SEWER INFRASTRUCTURE, ABANDON EXISTING SEWER MAINS WHERE SHOWN BY REMOVING THE 1" HIGH CONCRETE CURB. THE CONTRACTOR SHALL MONITOR CDF PUMPING TO ENSURE CDF DOES NOT OVERFLOW.

STIA A31+06.77 TO STA A32+20.31
JACK AND BORE 48" STEEL CASING UNDER HIGHWAY 99E. INSTALL 30" PVC MANHOLE. VERIFY DEPTH. SEE STANDARD DRAWING NO. 408.
INSTALL WITHIN 2' OF EACH PIPE JOINT AND IN THE MIDDLE OF EACH PIPE STICK. PLUG EACH END OF STEEL CASING WITH 8" AIR OF GROUT. SEE STANDARD DRAWING NO. 203 AND SPECIAL PROVISIONS.

SS-22-01, COX CREEK INTERCEPTOR IMPROVEMENTS: PHASE 2
SURFACE RESTORATION PLAN - WAVERLY LAKE PATH

PUBLIC WORKS DEPARTMENT
ENGINEERING SERVICES

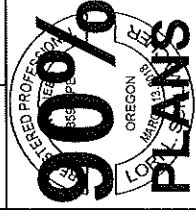

EXPIRES: 06/30/2020
SHEET NO. 8 OF 14
PROJECT NO: SS-22-01
FILE: BASE.DWG

DESIGNED: L. SCHUWACHER
DRAWN: L. SCHUWACHER
CHECKED: C. CERKLEWSKI
DATE: 11/30/2021
REVISIONS
NO.
DATE
BY

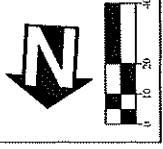

APPROXIMATE LIMITS OF HYDROSEEDING AREA. CONTRACTOR SHALL BACKFILL TRENCH WITH SELECT BACKFILL TO WITHIN 18" OF FINISHED GRADE AND COMPLETE BACKFILL WITH 18" OF TOPSOIL. SURFACE OF OPPOSITE SIDE OF TRENCH SHALL BE RESTORED WITH HYDROSEED. TYPICAL THIS SHEET.

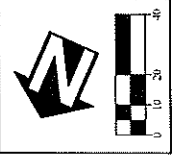
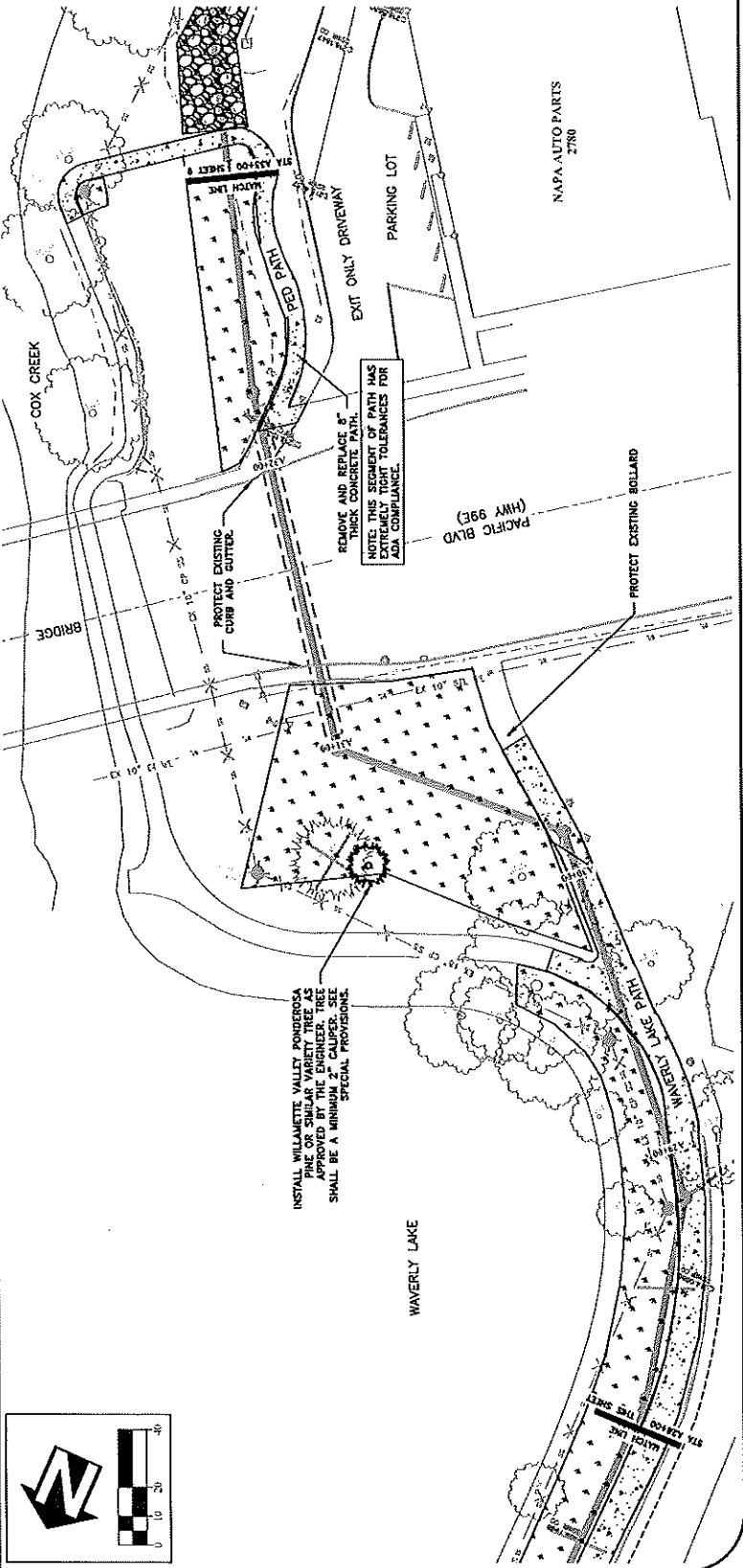
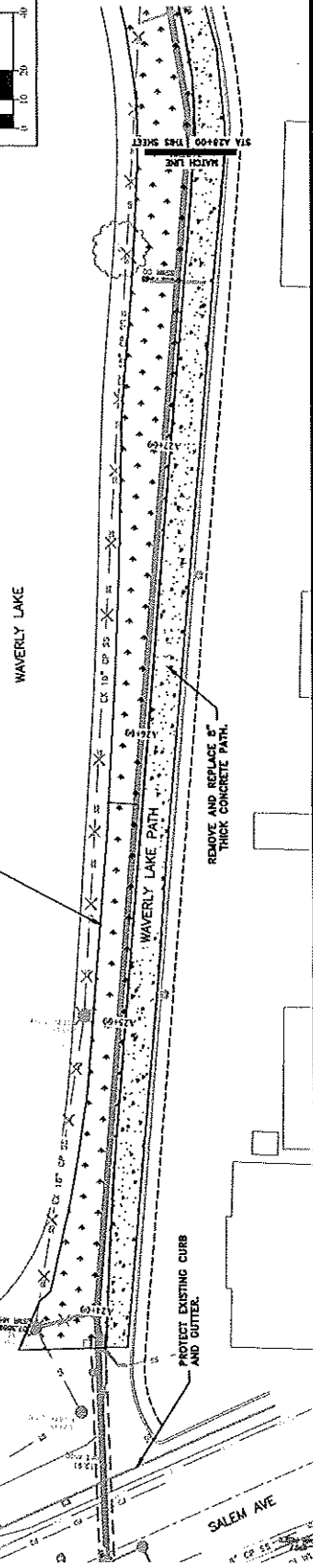

DESIGNED BY:	L. SCHUMACHER
DRAWN BY:	L. SCHUMACHER
CHECKED BY:	C. CERKLEWSKI
DATE:	11/30/2021
REVISIONS:	
NO.	
DATE	

SS-22-01, COX CREEK INTERCEPTOR IMPROVEMENTS; PHASE 2
 EPSC PLAN GENERAL NOTES

PUBLIC WORKS DEPARTMENT
 ENGINEERING SERVICES

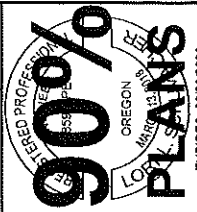

SHEET NO. 10 OF 14
 PROJECT NO: SS-22-01
 FILE: BASE.DWG

GENERAL EPSC NOTES:

1. TOTAL DISTURBED AREA OF PROJECT: 0.63 ACRES
2. A COPY OF THE 1200-CN EROSION PREVENTION AND SEDIMENT CONTROL PERMIT SHALL BE MAINTAINED ON SITE AT ALL TIMES.
3. PERMANENT RE-SEEDING OF DISTURBED NON-WETLAND SURFACES SHALL BE COMPLETED WITH A 50-50 BLEND OF PERENNIAL RYEGRASS AND FINE FESCUE OR APPROVED EQUAL AT A RATE OF 220 POUNDS PER ACRE UNLESS SHOWN OTHERWISE ON THE CONSTRUCTION DRAWINGS.
4. VACUUM SWEEP ALL CONCRETE GUTTERS AND UNDISTURBED PAVEMENT WITHIN THE PROJECT LIMITS, AS WELL AS SIDE STREETS AND CONSTRUCTION ENTRANCES WITHIN 300 FEET OF THE PROJECT LIMITS. AT LEAST ONCE PER WEEK AND AS DIRECTED BY THE ENGINEER.

STANDARD EPSC PERMIT CONDITIONS

1. PRIOR TO ANY GROUND DISTURBING ACTIVITY ON THE SITE, AN INITIAL INSPECTION BY CITY STAFF IS REQUIRED. EROSION PREVENTION AND SEDIMENT CONTROL (EPSC) MEASURES MUST BE IN PLACE PRIOR TO THE INSPECTOR ARRIVING. CALL (541) 791-0116 TO SCHEDULE YOUR INSPECTION.
2. EPSC MEASURES MUST BE INSTALLED IN SUCH A MANNER AS TO ENSURE THAT SEDIMENT AND SEDIMENT-LADEN WATER DOES NOT ENTER UPON ADJACENT PROPERTIES OR RIGHTS-OF-WAY, THE STORMWATER SYSTEM, WETLANDS, OR WATERS OF THE STATE.
3. EPSC MEASURES SHOWN ON THE PLANS ARE MINIMUM REQUIREMENTS. FOR ANTICIPATED SITE CONDITIONS, DURING THE CONSTRUCTION PERIOD, THE EPSC MEASURES SHALL BE UPGRADED AS NEEDED FOR CHANGING CONDITIONS AND TO ENSURE THAT SEDIMENT AND SEDIMENT-LADEN WATER DOES NOT LEAVE THE SITE.
4. EPSC MEASURES SHALL BE INSPECTED DAILY BY THE PERMIT HOLDER, AND MAINTAINED AS NECESSARY TO ENSURE THEIR FUNCTION.
5. STABILIZED GRAVEL CONSTRUCTION ENTRANCES SHALL BE INSTALLED AT THE BEGINNING OF CONSTRUCTION AND MAINTAINED FOR THE DURATION OF THE PROJECT. ADDITIONAL MEASURES MAY BE REQUIRED TO ENSURE THAT ALL PAVED AREAS ARE KEPT CLEAN FOR THE DURATION OF THE PROJECT.
6. EPSC MEASURES SHALL BE KEPT IN PLACE UNTIL PERMANENT GROUND COVER IS ESTABLISHED.
7. EXPOSED SOIL MUST BE PERMANENTLY STABILIZED AGAINST WIND AND WATER EROSION BEFORE THE EPSC PERMIT CAN BE CLOSED. ONCE THE SITE IS STABILIZED, SCHEDULE A FINAL INSPECTION BY CALLING (541) 791-0116. PERMANENT SOIL STABILIZATION INCLUDES LANDSCAPING, SEEDING, OR COVERING EXPOSED SOIL WITH A MINIMUM 2-INCH LAYER OF BARK OR WOOD CHIPS.
8. IT IS THE PROPERTY OWNER'S RESPONSIBILITY TO ENSURE THAT ANY PROPOSED GRADING, FILL, EXCAVATION, OR OTHER SITE WORK DOES NOT NEGATIVELY IMPACT DRAINAGE PATTERNS TO OR FROM ADJACENT PROPERTIES.

WET WEATHER PERMIT CONDITIONS

1. WET WEATHER EROSION PREVENTION MEASURES WILL BE IN EFFECT FROM OCTOBER 1 THROUGH APRIL 30.
2. SOIL EXPOSED FOR MORE THAN 2 DAYS SHALL BE COVERED WITH PLASTIC SHEETING, MATTING, OR A 2-INCH LAYER OF MULCH, BARK, WOOD CHIPS, SAWDUST, OR STRAW TO MINIMIZE EROSION POTENTIAL
3. EXPOSED SOILS SHALL BE SEEDDED NO LATER THAN SEPTEMBER 1ST TO ALLOW TIME FOR PROPER GERMINATION AND GROWTH BEFORE THE WET WEATHER SEASON.
4. ANY DISTURBED AREAS NOT HYDROSEEDDED BY SEPTEMBER 1ST SHALL BE HYDROSEEDDED WITH A LAYER OF ECOBLANKET WITH TERRASEEDING BY REXIUS, INC. OR APPROVED EQUAL. NO ADDITIONAL PAYMENT WILL BE MADE FOR THE USE OF ECOBLANKET AND TERRASEEDING.

TRENCH DEWATERING PLAN

A DETAILED TRENCH DEWATERING PLAN SHALL BE SUBMITTED TO THE ENGINEER AT THE PRECONSTRUCTION CONFERENCE. THE PLAN SHALL SHOW HOW THE CONTRACTOR PLANS TO DEWATER THE TRENCHES DURING CONSTRUCTION WITHOUT TRANSPORTING SEDIMENT INTO STORM DRAINS AND BODIES OF WATER. SEE SPECIAL PROVISIONS.

TREE PROTECTION NOTES

TREES TO BE RETAINED WILL BE PROTECTED BY INSTALLATION OF TREE PROTECTION FENCING TO PREVENT INJURY TO TREE TRUNKS OR ROOTS.

SS-22-01, COX CREEK INTERCEPTOR IMPROVEMENTS: PHASE 2
EPSC PLAN - WAVERLY LAKE

PUBLIC WORKS DEPARTMENT
ENGINEERING SERVICES



EXPIRES: 06/30/2020
SHEET NO. 11 OF 14
PROJECT NO: SS-22-01
FILE: BASE.DWG

DESIGNED: L. SCHUMACHER
DRAWN: L. SCHUMACHER
CHECKED: C. CERKLEWSKI
DATE: 11/30/2021
REVISIONS
NO:
BY:

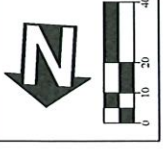
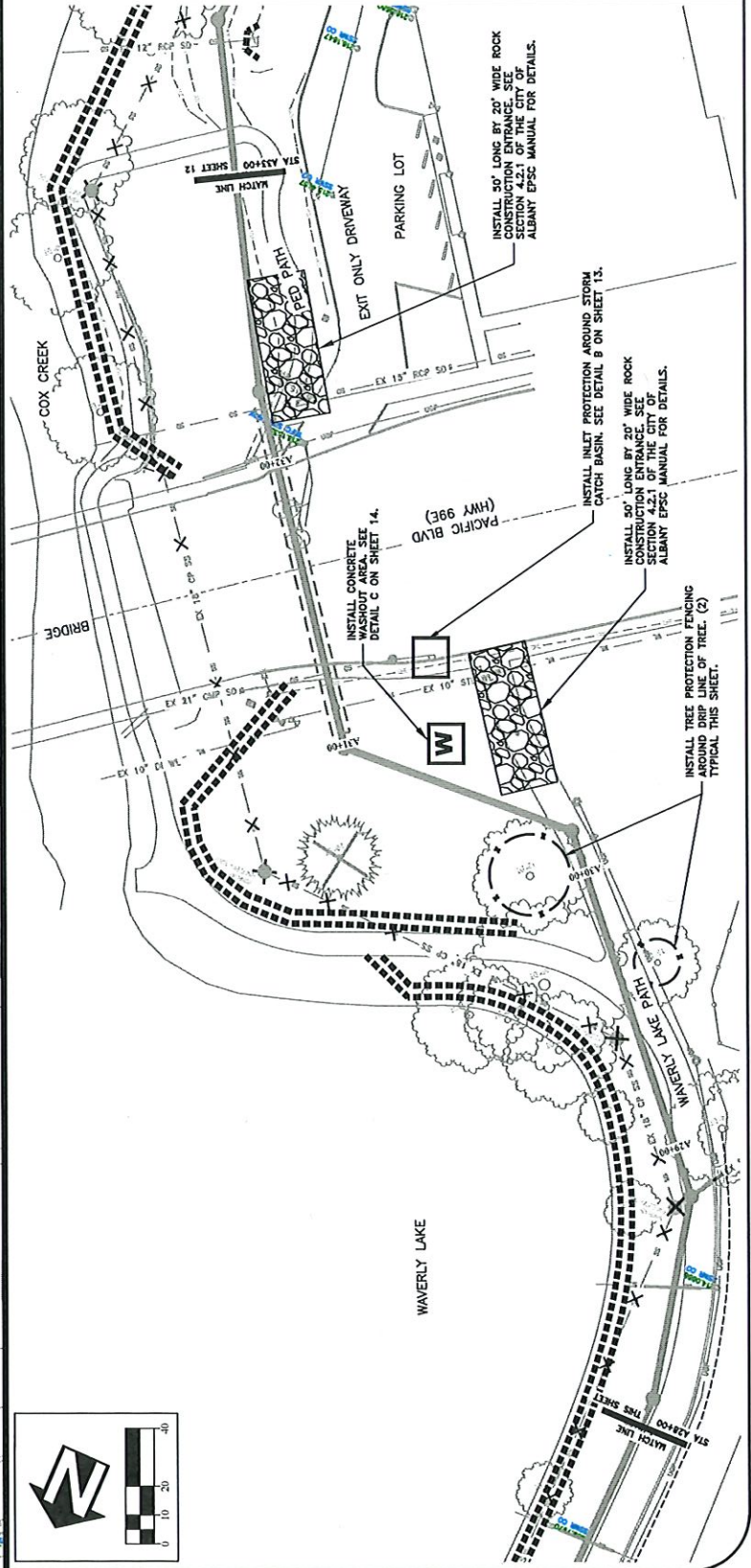
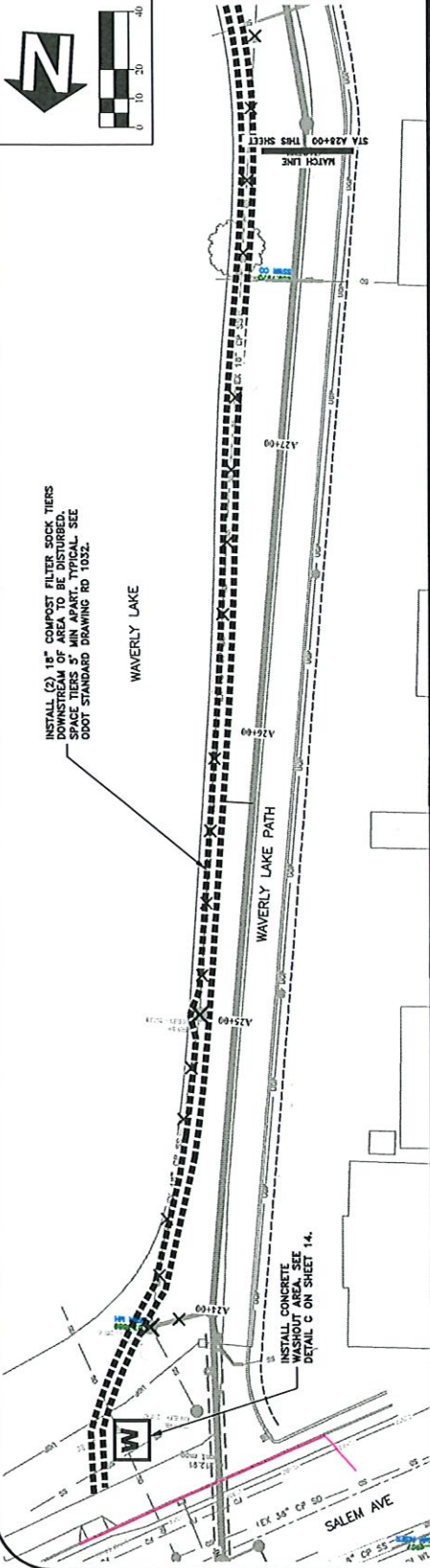

DETAIL A: CURB INLET SEDIMENT DAM

Curb Inlet Sediment Dam

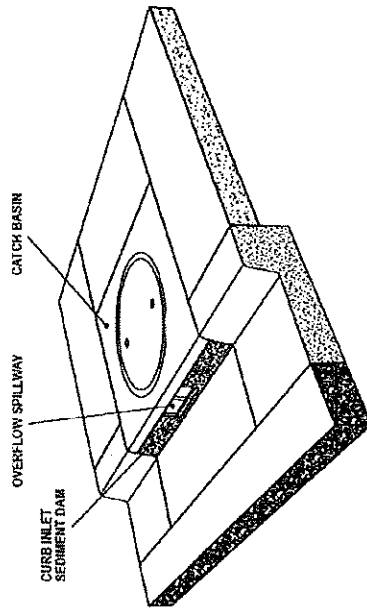

PRODUCT:
 Material: 100% Non-woven Polyfiber
 Color: Blue
 Height: 5" (Custom)
 Width: 36" - 54" - 70" (Custom)

INSTALLATION:
 Place strap through hole(s) provided. Wrap around the horizontal rod in mouth of curb inlet and extend strap through adjacent hole and tie.

AMERICAN ENVIRONMENTAL PROTECTIVE SOLUTIONS & PRODUCT®
 20377 Airport Road
 Eugene, OR 97402
 (541) 688-7609

DETAIL B: CATCH BASIN INLET PROTECTION

INLET PROTECTION TYPE 5

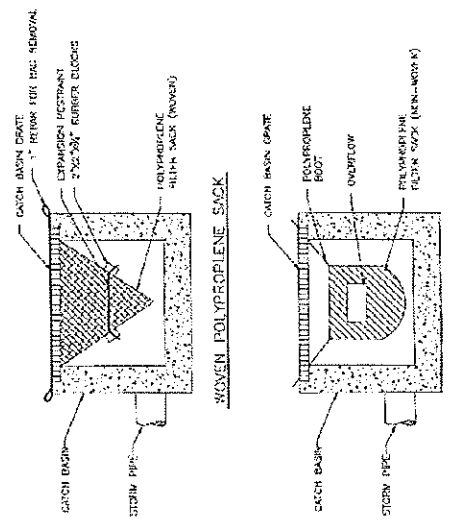

NOTE:
 1. REDUCED CURB INLET CATCH BAGS MUST BE BLOCKED WHEN USING FILTER FABRIC INLET SACKS. SIZE OF FILTER FABRIC INLET SACKS TO BE DETERMINED BY MANUFACTURER.

4-68

EPSC Manual

City of Albany

DESIGNED BY: SCHWABER	DATE: 11/30/2021
CHECKED BY: SCHWABER	DATE: 11/30/2021
DRAWN BY: SCHWABER	DATE: 11/30/2021
REVISIONS:	
NO.	BY:

PUBLIC WORKS DEPARTMENT
ENGINEERING SERVICES

SS-22-01, COX CREEK INTERCEPTOR IMPROVEMENTS: PHASE 2
 EPSC DETAILS

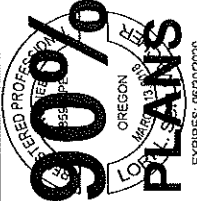

EXPIRES: 06/30/2020
 SHEET NO. 13 OF 14
 PROJECT NO: SS-22-01
 FILE: BASE.DWG

PUBLIC WORKS DEPARTMENT
ENGINEERING SERVICES

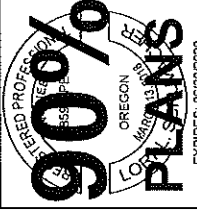

EXPIRES: 05/30/2020
SHEET NO. 14 OF 14
PROJECT NO: SS-22-01
FILE: BASE.DWG

NO.	DATE	BY
1	11/30/2021	LS
2		
3		
4		
5		
6		
7		
8		
9		
10		

DESIGNED: L. SCHUWACHER
 DRAWN: L. SCHUWACHER
 CHECKED: C. CERKLEWSKI
 DATE: 11/30/2021

DETAIL C: CONCRETE WASH AREA
 NOT TO SCALE

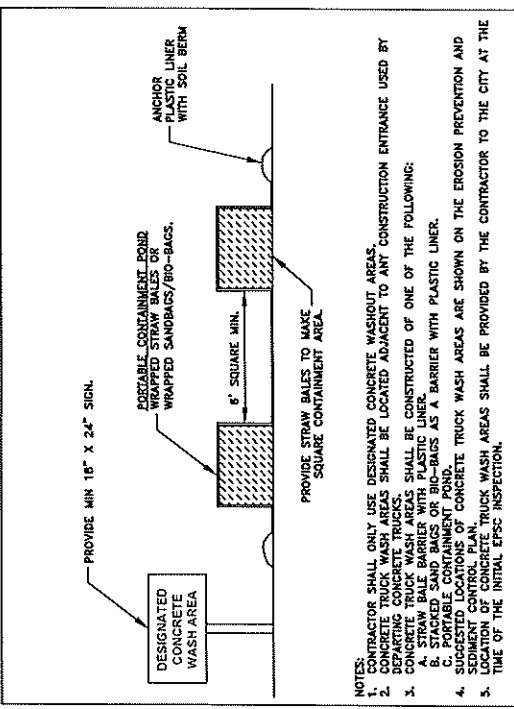

- NOTES:
1. CONTRACTOR SHALL ONLY USE DESIGNATED CONCRETE WASHOUT AREAS.
 2. CONCRETE TRUCK WASH AREAS SHALL BE LOCATED ADJACENT TO ANY CONSTRUCTION ENTRANCE USED BY DEPARTING CONCRETE TRUCKS.
 3. CONCRETE TRUCK WASH AREAS SHALL BE CONSTRUCTED OF ONE OF THE FOLLOWING:
 - A. STACKED SAND BAGS OR BIO-BAGS AS A BARRIER WITH PLASTIC LINER.
 - B. STACKED SAND BAGS OR BIO-BAGS AS A BARRIER WITH PLASTIC LINER.
 - C. PORTABLE CONTAINMENT POND.
 4. SUGGESTED LOCATIONS OF CONCRETE TRUCK WASH AREAS ARE SHOWN ON THE EROSION PREVENTION AND CONTROL PLAN.
 5. LOCATION OF CONCRETE TRUCK WASH AREAS SHALL BE PROVIDED BY THE CONTRACTOR TO THE CITY AT THE TIME OF THE INITIAL EPSC INSPECTION.