

CITY OF ALBANY

WL-22-01, JEFFERSON STREET AND 1ST AVENUE WATER LINE

SHEET INDEX

SHEET NO. 1,	COVER & GENERAL NOTES
SHEET NO. 2 TO 4,	JEFFERSON STREET WATER LINE CONSTRUCTION
SHEET NO. 5 TO 7,	1ST AVENUE WATER LINE CONSTRUCTION
SHEET NO. 8,	LAFAYETTE STREET WATER LINE ABANDONMENT
SHEET NO. 9,	DETAILS

LEGEND

	EXISTING WATER SERVICE		EXISTING POWER POLE
	RECONNECT EXISTING METER		EXISTING STORM MANHOLE
	INSTALL NEW SERVICE WITH NO METER		NEW CURB INLET
	REPLACE EXISTING METER WITH NEW METER		NEW CATCH BASIN
	AIR RELEASE VALVE		NEW CURB INLET
	EXISTING WATER VALVE		NEW CATCH BASIN
	NEW WATER VALVE		EXISTING STREET LIGHT
	EXISTING WATER LINE		EXISTING TRAFFIC SIGN
	EXISTING GAS LINE		NEW TRAFFIC SIGN
	EXISTING STORM LINE		EXISTING HYDRANT
	EXISTING SANITARY SEWER LINE		NEW HYDRANT
	EXISTING QLN DUCT		REDUCER
	EXISTING POWER LINES		
	NEW WATER LINE		
	NEW STORM LINE		
	NEW STORM DRAIN MAINLINE CLEANOUT		
	NEW STORM DRAIN MANHOLE		

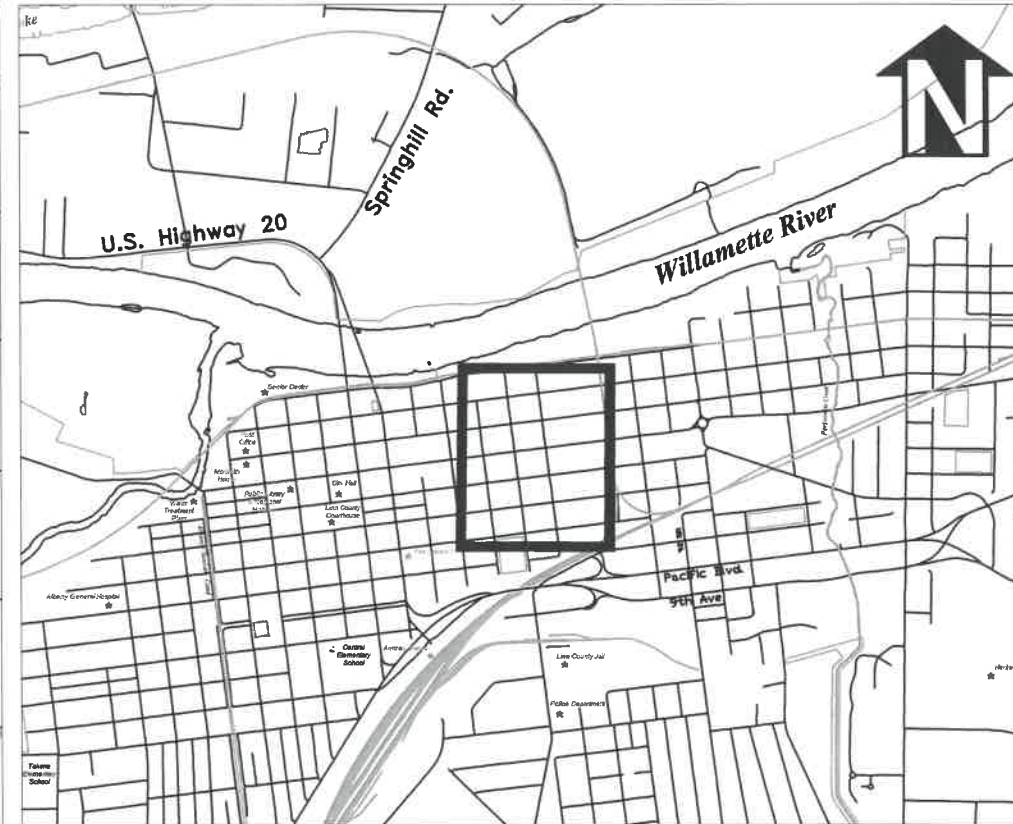

Vicinity Map
Not to Scale

GENERAL NOTES

- ALL CONSTRUCTION SHALL CONFORM TO THE CITY OF ALBANY STANDARD CONSTRUCTION SPECIFICATIONS AND ASSOCIATED STANDARD DRAWINGS. THE CURRENT VERSION OF THE CITY OF ALBANY STANDARD CONSTRUCTION SPECIFICATIONS CAN BE FOUND ON THE CITY'S WEBSITE AT WWW.CITYOFALBANY.NET.
- UTILITIES SHOWN ARE FOR REFERENCE ONLY. FOR A FIELD LOCATE, CALL THE UTILITIES NOTIFICATIONS CENTER AT 1-800-332-2344.
- OPERATING ACCESS FOR CITY MAINTENANCE PERSONNEL TO EXISTING AND NEW WATER VALVES AND MANHOLES SHALL BE CONTINUOUSLY MAINTAINED BY THE CONTRACTOR DURING ALL CONSTRUCTION ACTIVITIES.
- CONTRACTOR SHALL VERIFY ALL EXISTING PIPE ELEVATIONS, PIPE DIAMETERS, AND PIPE MATERIALS AT CONNECTION AND ABANDONMENT LOCATIONS PRIOR TO CONSTRUCTION. ANY DISCREPANCIES SHALL BE REPORTED TO ENGINEER PRIOR TO BEGINNING WORK.
- ATTENTION: OREGON LAW REQUIRES YOU TO FOLLOW RULES ADOPTED BY THE OREGON UTILITY NOTIFICATION CENTER. THOSE RULES ARE SET FORTH IN OAR 952-001-0010 THROUGH OAR 952-001-0090. YOU MAY OBTAIN COPIES OF THE RULES BY CALLING THE CENTER. (NOTE: THE TELEPHONE NUMBER FOR THE OREGON UTILITY NOTIFICATION CENTER IS (503) 232-1987).
- CONTRACTOR SHALL BE RESPONSIBLE FOR PROPER INSTALLATION AND MAINTENANCE OF ALL EROSION PREVENTION SEDIMENT CONTROL (EPSC) MEASURES IN ACCORDANCE WITH LOCAL, STATE, AND FEDERAL REGULATIONS UNTIL ALL CONSTRUCTION IS COMPLETED AND APPROVED BY THE CITY OF ALBANY, AND VEGETATION/LANDSCAPING IS ESTABLISHED. FOR GUIDANCE, REFER TO THE CITY OF ALBANY EPSC MANUAL WHICH CAN BE FOUND AT www.cityofalbany.net.

DESIGNED: C. CERKLEWSKI
DRAWN: C. CERKLEWSKI
CHECKED: S. BELCASTRO
DATE: 2/9/2022

REVISIONS	NO.	BY:

PUBLIC WORKS DEPARTMENT
ENGINEERING SERVICES

WL-22-01, JEFFERSON STREET AND 1ST AVENUE WATER LINE

REGISTERED PROFESSIONAL ENGINEER
56,471PE
Christopher L. Cerkowski
OREGON
JULY 9, 2002
CHRISTOPHER L. CERKLEWSKI

EXPIRATION DATE: 12/31/2023

SHEET NO. 1 OF 9
PROJECT NO: WL-22-01
FILE: COVER.DWG

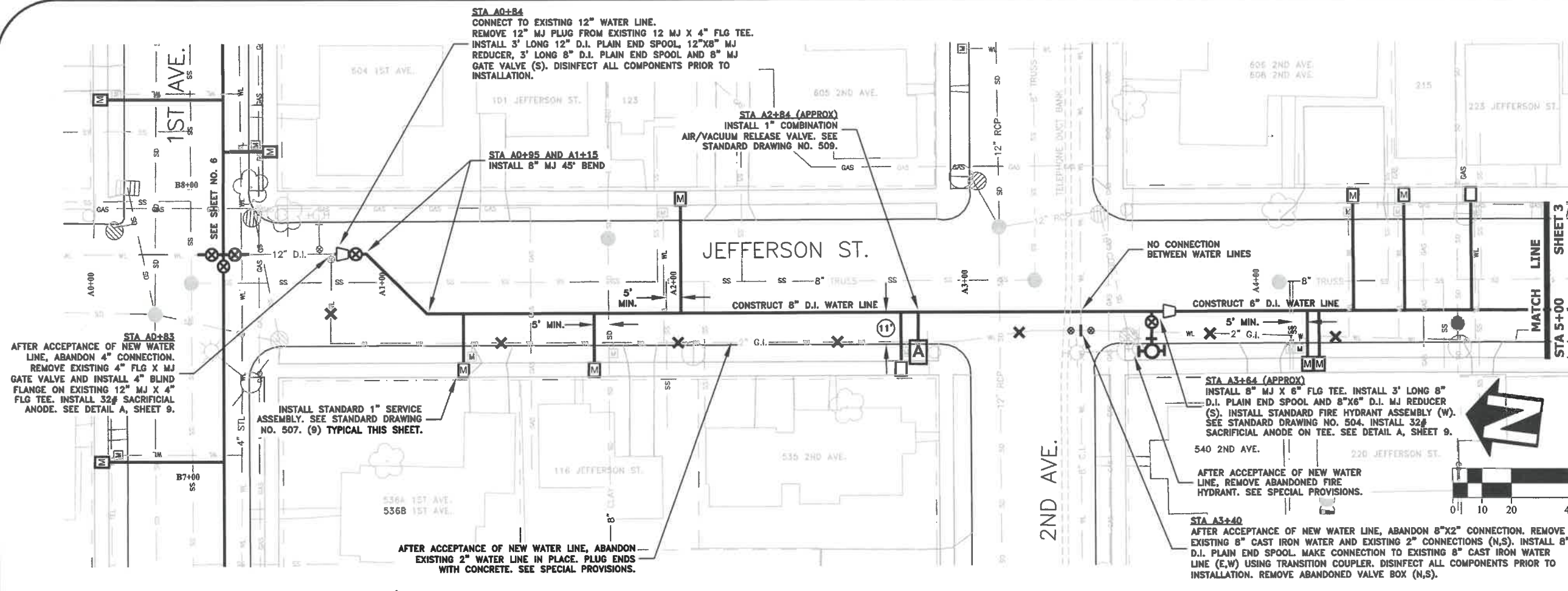

DESIGNED: C. CERKLEWSKI	REVISIONS
DRAWN: C. CERKLEWSKI	NO: ---
CHECKED: S. BELCASTRO	BY: ---
DATE: 2/9/2022	DATE: ---

**PUBLIC WORKS DEPARTMENT
ENGINEERING SERVICES**



**WL-22-01, JEFFERSON STREET AND 1ST AVENUE WATER LINE
JEFFERSON STREET WATER LINE**

REGISTERED PROFESSIONAL ENGINEER
56,471PE
Christopher L. Cerkowski
OREGON
JULY 9, 2002
CHRISTOPHER L. CERKLEWSKI

EXPIRATION DATE: 12/31/2023

SHEET NO. 2 OF 9

PROJECT NO: WL-22-01

FILE: BASE.DWG

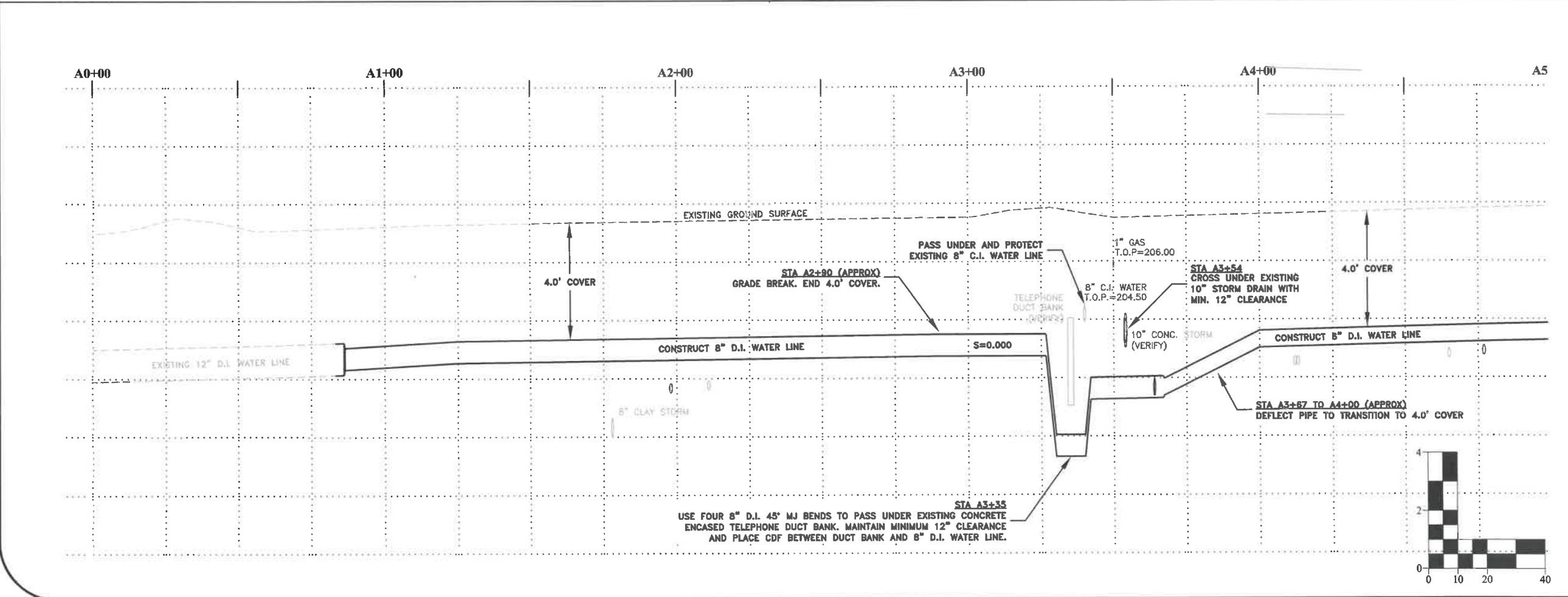

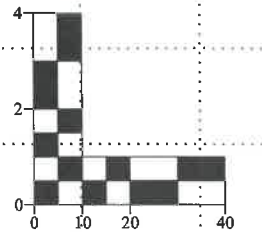
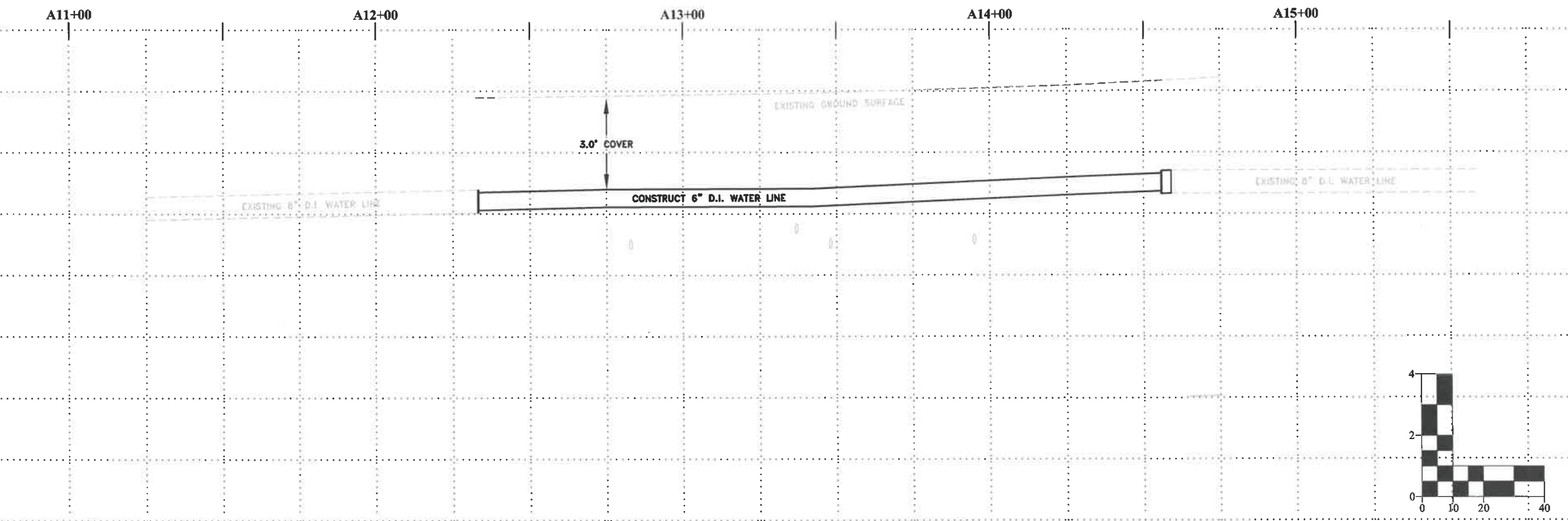
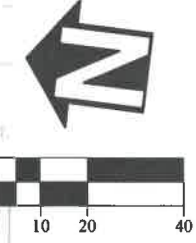
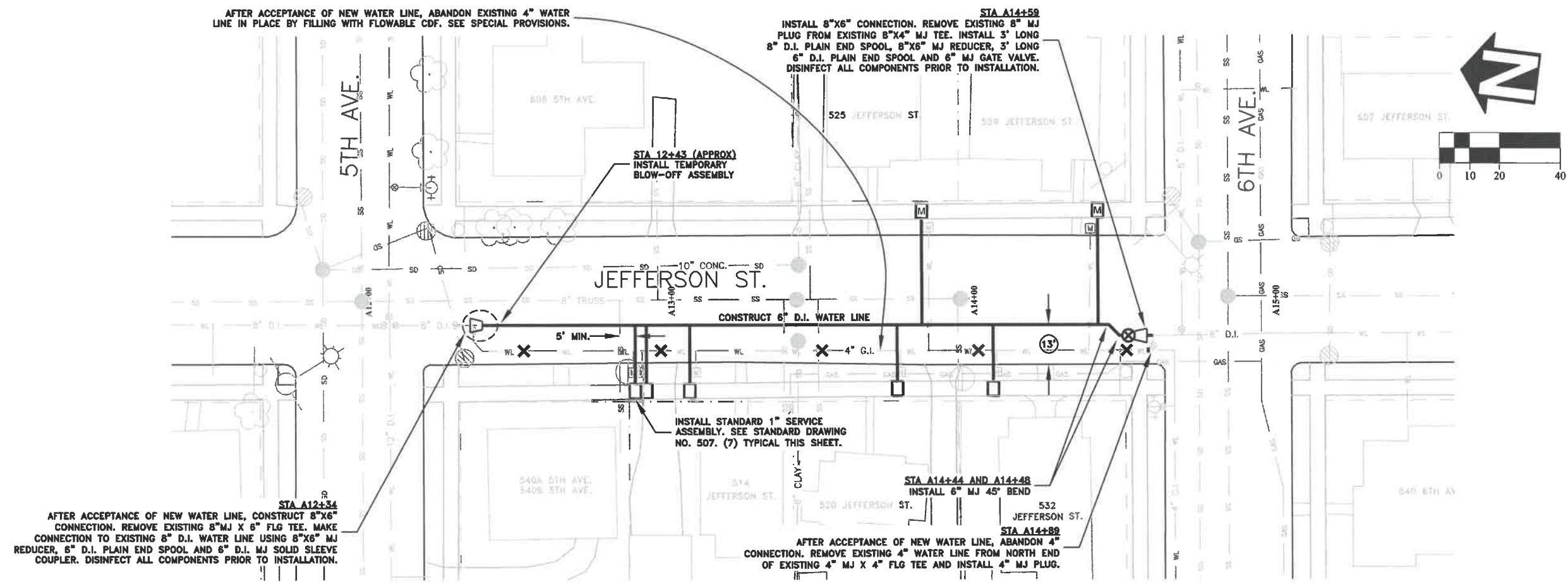

DESIGNED: C. CERKLEWSKI	REVISIONS
DRAWN: C. CERKLEWSKI	NO: ---
CHECKED: S. BELCASTRO	BY: ---
DATE: 2/9/2022	DATE: ---

PUBLIC WORKS DEPARTMENT
ENGINEERING SERVICES

WL-22-01, JEFFERSON STREET AND 1ST AVENUE WATER LINE
JEFFERSON STREET WATER LINE



EXPIRATION DATE: 12/31/2023

SHEET NO. 4 OF 9

PROJECT NO: WL-22-01

FILE: BASE.DWG

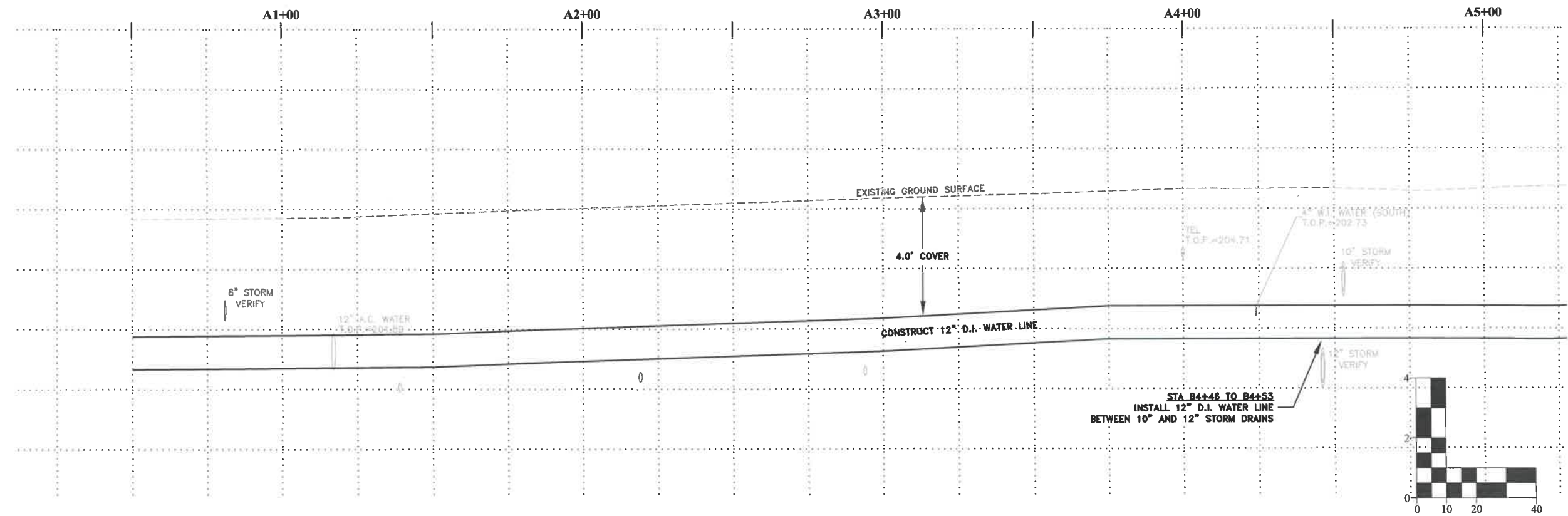
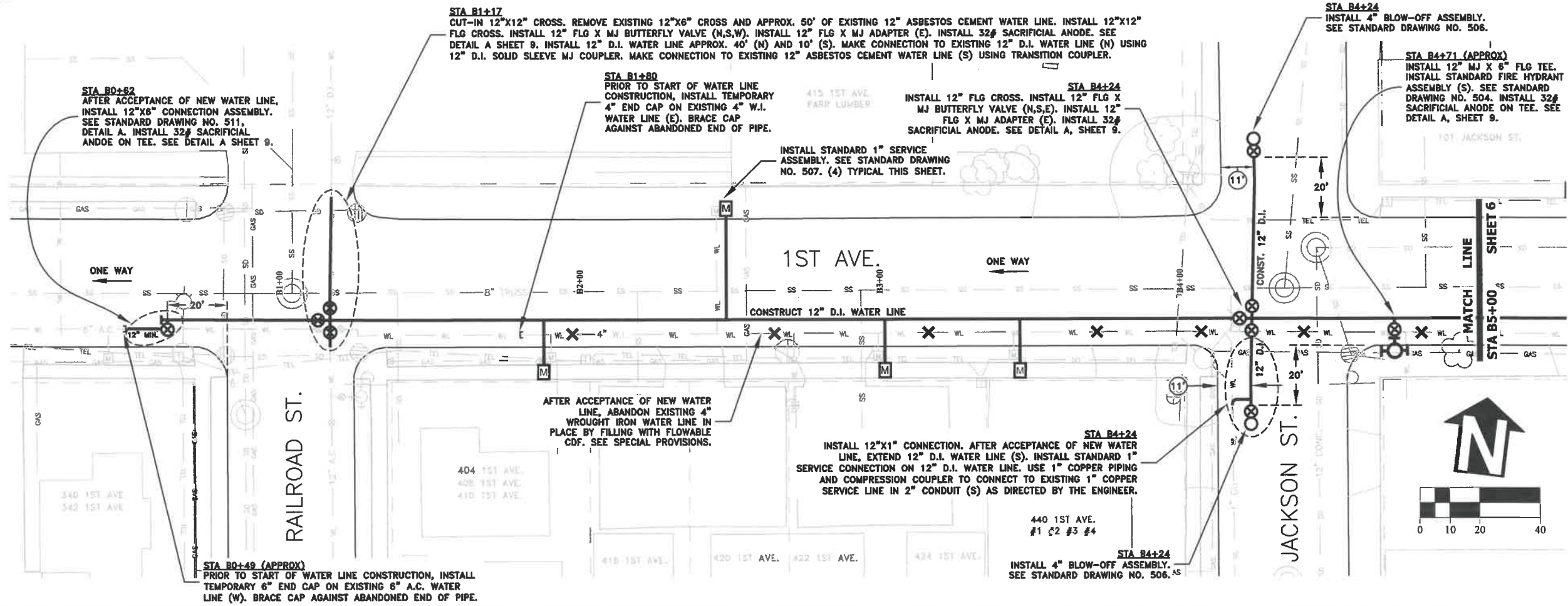

DESIGNED: C. GERKLEWSKI
DRAWN: C. GERKLEWSKI
CHECKED: S. BELCASTRO
DATE: 2/9/2022

REVISIONS	NO.	BY

PUBLIC WORKS DEPARTMENT
ENGINEERING SERVICES

WL-22-01, JEFFERSON STREET AND 1ST AVENUE WATER LINE
1ST AVENUE WATER LINE

CITY OF ALBANY
ENGINEERING



EXPIRATION DATE: 12/31/2023
SHEET NO. 5 OF 9
PROJECT NO: WL-22-01
FILE: BASE.DWG

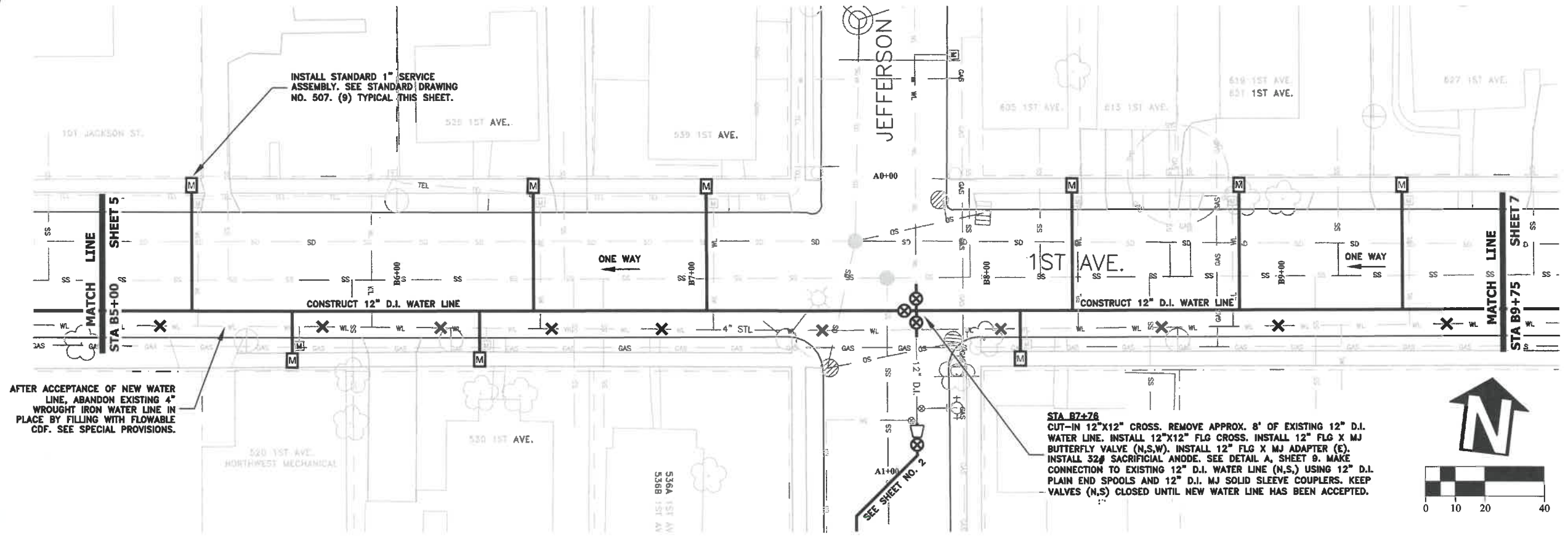

AFTER ACCEPTANCE OF NEW WATER LINE, ABANDON EXISTING 4\"/>

INSTALL STANDARD 1\"/>

STA B7+76
 CUT-IN 12\"/>

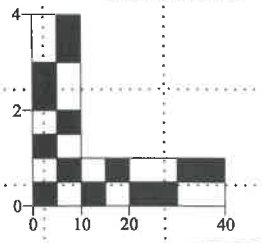
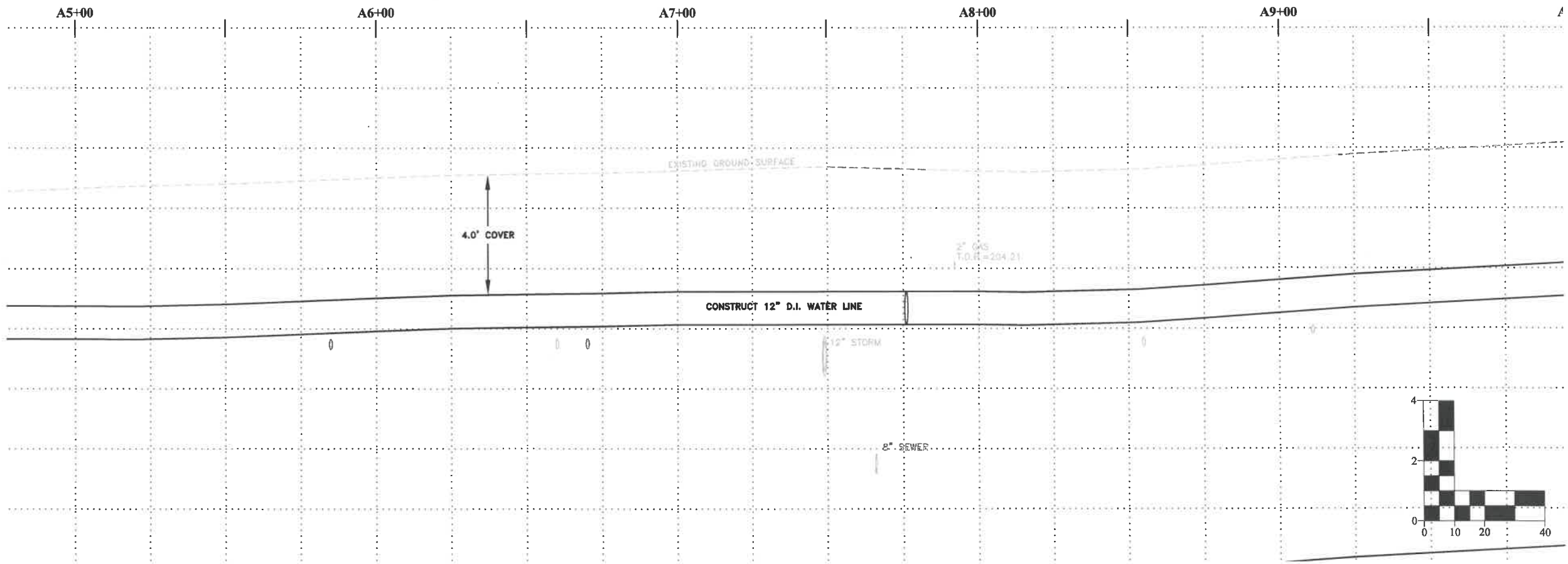
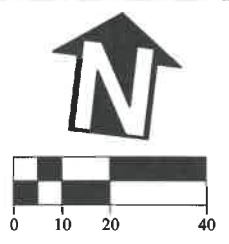

DESIGNED: C. CERKLEWSKI
 DRAWN: C. CERKLEWSKI
 CHECKED: S. BELCASTRO
 DATE: 2/9/2022

REVISIONS	
NO.	BY:

PUBLIC WORKS DEPARTMENT
ENGINEERING SERVICES



WL-22-01, JEFFERSON STREET AND 1ST AVENUE WATER LINE
1ST AVENUE WATER LINE



EXPIRATION DATE: 12/31/2023
 SHEET NO. 6 OF 9
 PROJECT NO: WL-22-01
 FILE: BASE.DWG

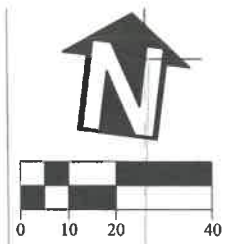
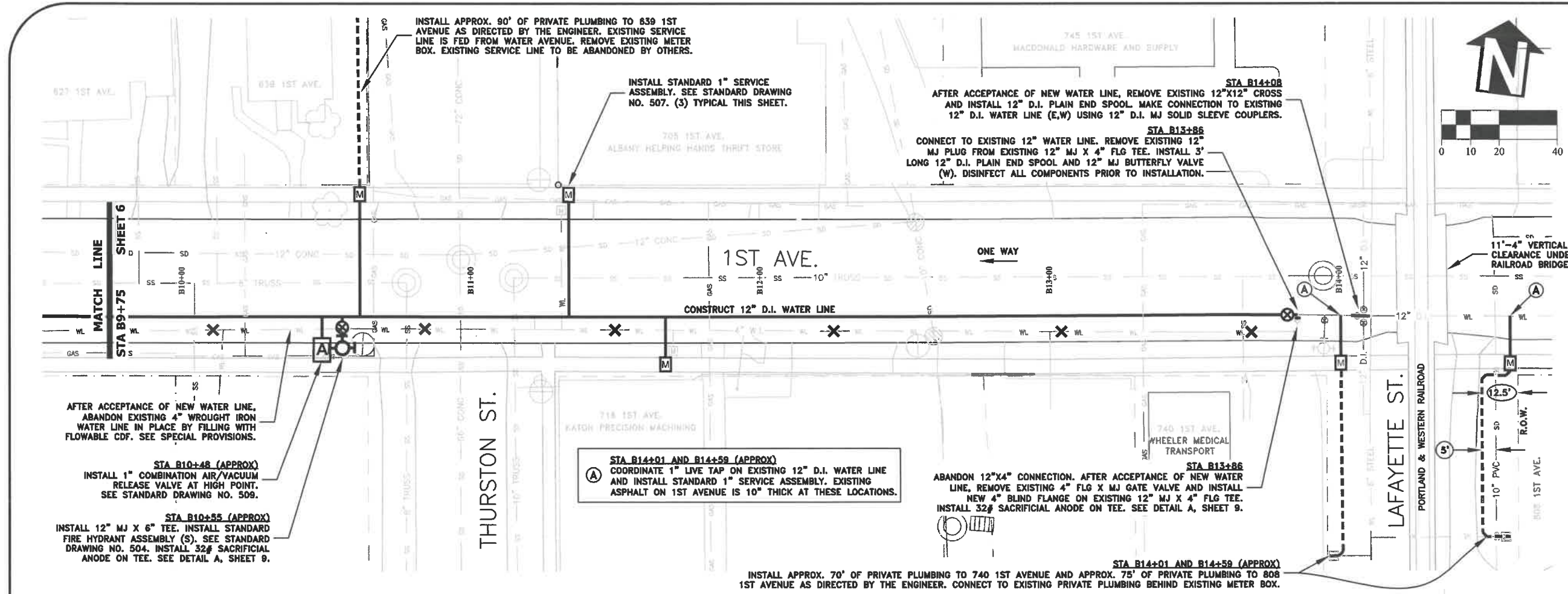

DESIGNED: C. CERKLEWSKI	REVISIONS
DRAWN: C. CERKLEWSKI	NO: ---
CHECKED: S. BELCASTRO	BY: ---
DATE: 2/9/2022	DATE: ---

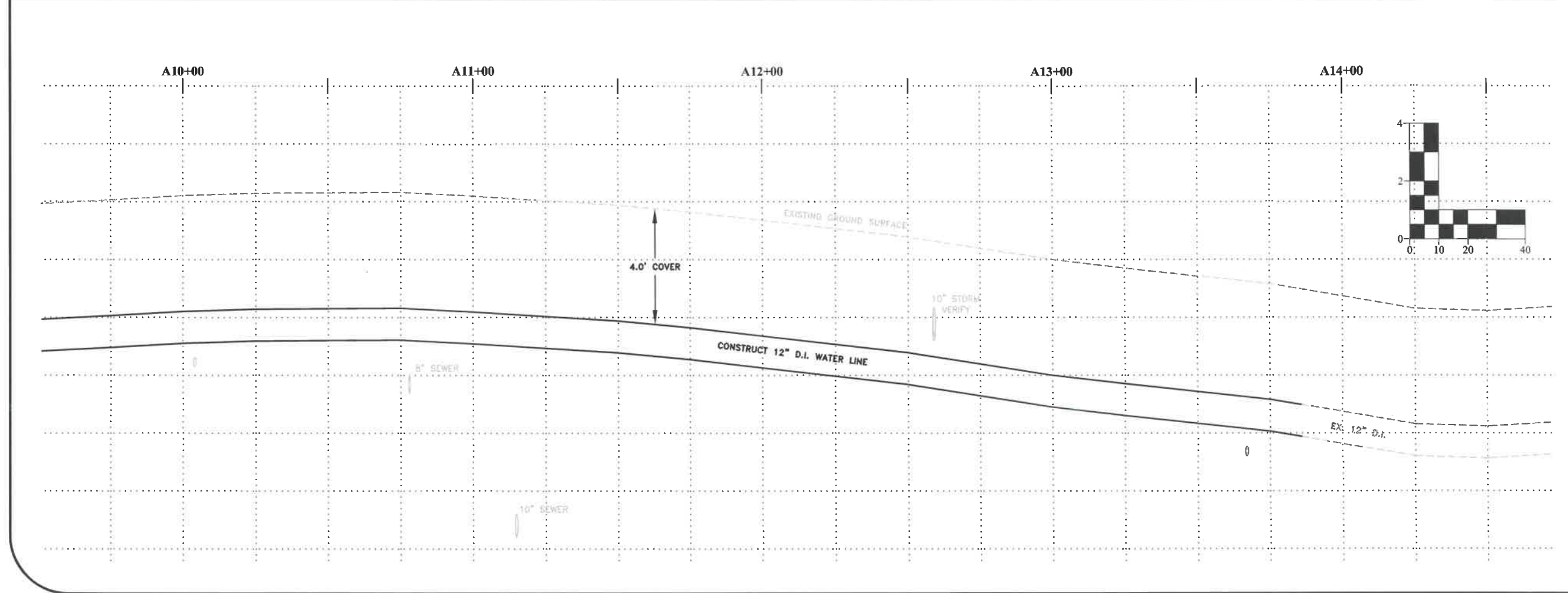

**PUBLIC WORKS DEPARTMENT
ENGINEERING SERVICES**



**WL-22-01, JEFFERSON STREET AND 1ST AVENUE WATER LINE
1ST AVENUE WATER LINE**

REGISTERED PROFESSIONAL
ENGINEER
56,471PE
Christopher L. Cerkowski
OREGON
JULY 9, 2002
CHRISTOPHER L. CERKLEWSKI

EXPIRATION DATE: 12/31/2023

SHEET NO. 7 OF 9

PROJECT NO: WL-22-01

FILE: BASE.DWG

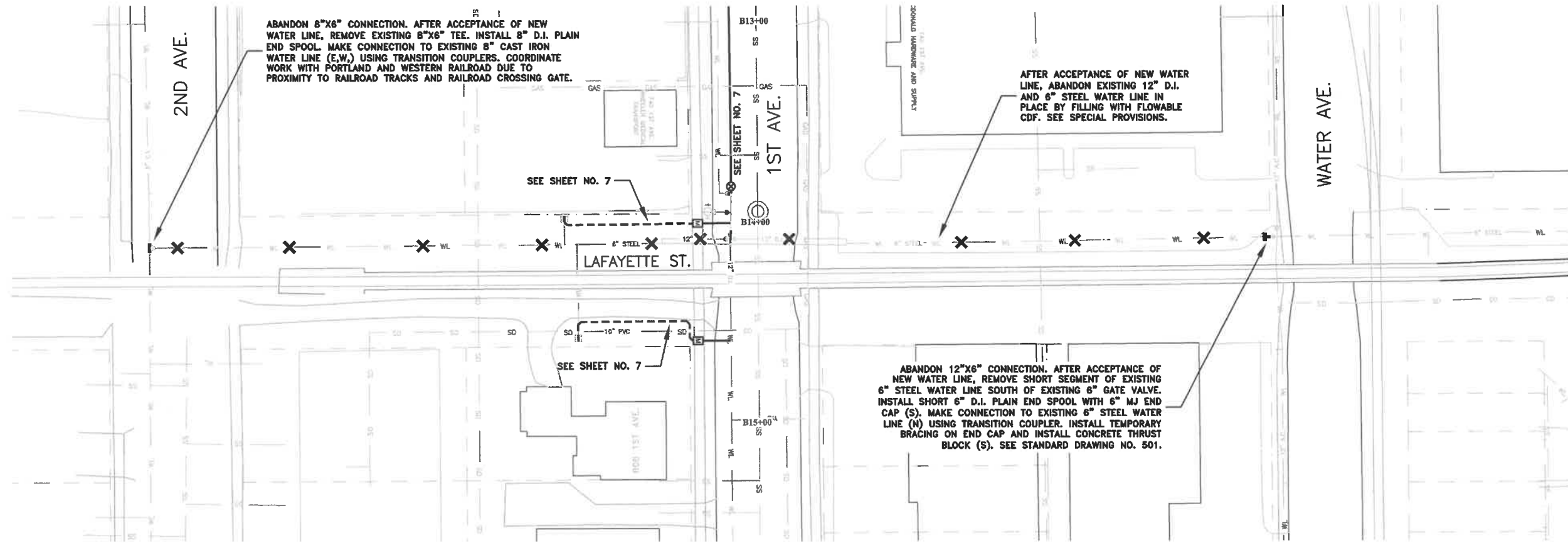

ABANDON 8"x6" CONNECTION. AFTER ACCEPTANCE OF NEW WATER LINE, REMOVE EXISTING 8"x6" TEE. INSTALL 8" D.I. PLAIN END SPOOL. MAKE CONNECTION TO EXISTING 8" CAST IRON WATER LINE (E,W.) USING TRANSITION COUPLERS. COORDINATE WORK WITH PORTLAND AND WESTERN RAILROAD DUE TO PROXIMITY TO RAILROAD TRACKS AND RAILROAD CROSSING GATE.

AFTER ACCEPTANCE OF NEW WATER LINE, ABANDON EXISTING 12" D.I. AND 6" STEEL WATER LINE IN PLACE BY FILLING WITH FLOWABLE CDF. SEE SPECIAL PROVISIONS.

ABANDON 12"x6" CONNECTION. AFTER ACCEPTANCE OF NEW WATER LINE, REMOVE SHORT SEGMENT OF EXISTING 6" STEEL WATER LINE SOUTH OF EXISTING 6" GATE VALVE. INSTALL SHORT 6" D.I. PLAIN END SPOOL WITH 6" MJ END CAP (S). MAKE CONNECTION TO EXISTING 6" STEEL WATER LINE (N) USING TRANSITION COUPLER. INSTALL TEMPORARY BRACING ON END CAP AND INSTALL CONCRETE THRUST BLOCK (S). SEE STANDARD DRAWING NO. 501.

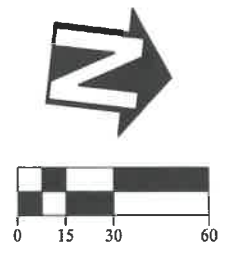

DESIGNED: C. CERKLEWSKI	REVISIONS
DRAWN: C. CERKLEWSKI	NO: ---
CHECKED: S. BELCASTRO	BY: ---
DATE: 2/9/2022	---
DATE: ---	---
---	---
---	---
---	---



**PUBLIC WORKS DEPARTMENT
ENGINEERING SERVICES**

**WL-22-01, JEFFERSON STREET AND 1ST AVENUE WATER LINE
LAFAYETTE STREET WATER LINE ABANDONMENT**



EXPIRATION DATE: 12/31/2023
 SHEET NO. 8 OF 9
 PROJECT NO: WL-22-01
 FILE: BASE.DWG

**DETAIL A:
DUCTILE IRON FLANGED FITTING ANODE CONNECTION DETAIL**
NOT TO SCALE

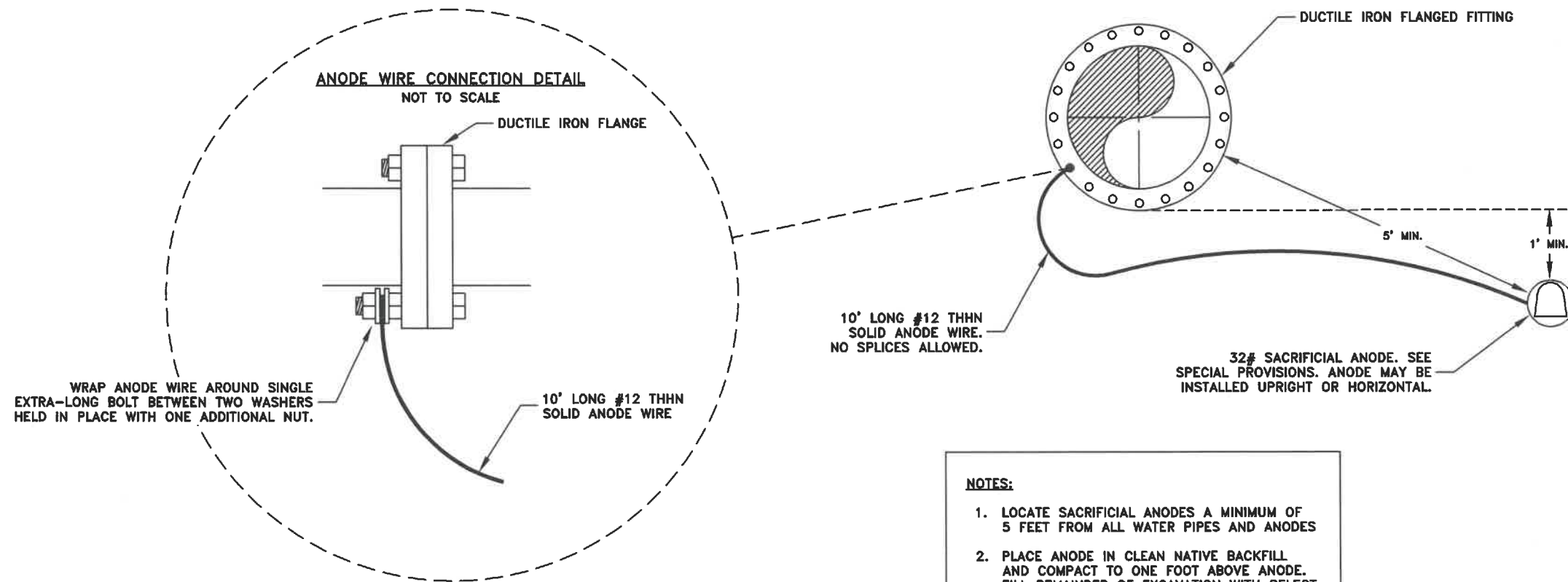

NOTES:

1. LOCATE SACRIFICIAL ANODES A MINIMUM OF 5 FEET FROM ALL WATER PIPES AND ANODES
2. PLACE ANODE IN CLEAN NATIVE BACKFILL AND COMPACT TO ONE FOOT ABOVE ANODE. FILL REMAINDER OF EXCAVATION WITH SELECT BACKFILL.

DESIGNED: C. CERKLEWSKI
DRAWN: C. CERKLEWSKI
CHECKED: S. BELCASTRO
DATE: 2/9/2022

REVISIONS	NO.	BY:

**PUBLIC WORKS DEPARTMENT
ENGINEERING SERVICES**



**WL-22-01, JEFFERSON STREET AND 1ST AVENUE WATER LINE
DETAILS**



EXPIRATION DATE: 12/31/2023

SHEET NO. 9 OF 9

PROJECT NO: WL-22-01

FILE: BASE.DWG