

CITY OF ALBANY

ST-22-04, CHICAGO STREET INFILL

SHEET INDEX	
Sheet No.	Sheet Title
1	COVER
2	SEWER CONSTRUCTION
3	WATER CONSTRUCTION
4	STREET CONSTRUCTION

LEGEND	
<ul style="list-style-type: none"> EXISTING WATER SERVICE RECONNECT EXISTING METER INSTALL NEW SERVICE WITH NO METER REPLACE EXISTING METER WITH NEW METER AIR RELEASE VALVE EXISTING WATER VALVE NEW WATER VALVE EXISTING WATER LINE EXISTING GAS LINE EXISTING STORM LINE EXISTING SANITARY SEWER LINE EXISTING QLN DUCT EXISTING POWER LINES NEW WATER LINE NEW STORM LINE NEW STORM DRAIN MAINLINE CLEANOUT NEW STORM DRAIN MANHOLE 	<ul style="list-style-type: none"> EXISTING POWER POLE EXISTING STORM MANHOLE NEW CURB INLET NEW CATCH BASIN NEW CURB INLET NEW CATCH BASIN EXISTING STREET LIGHT EXISTING TRAFFIC SIGN NEW TRAFFIC SIGN EXISTING HYDRANT NEW HYDRANT REDUCER

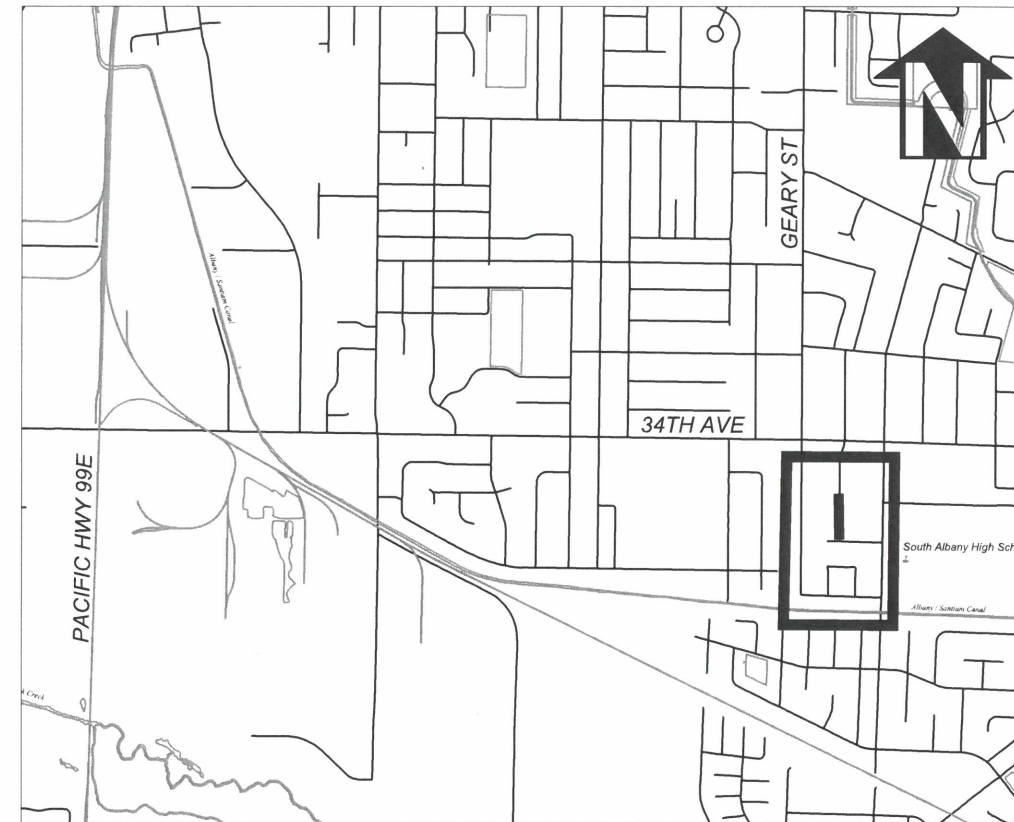
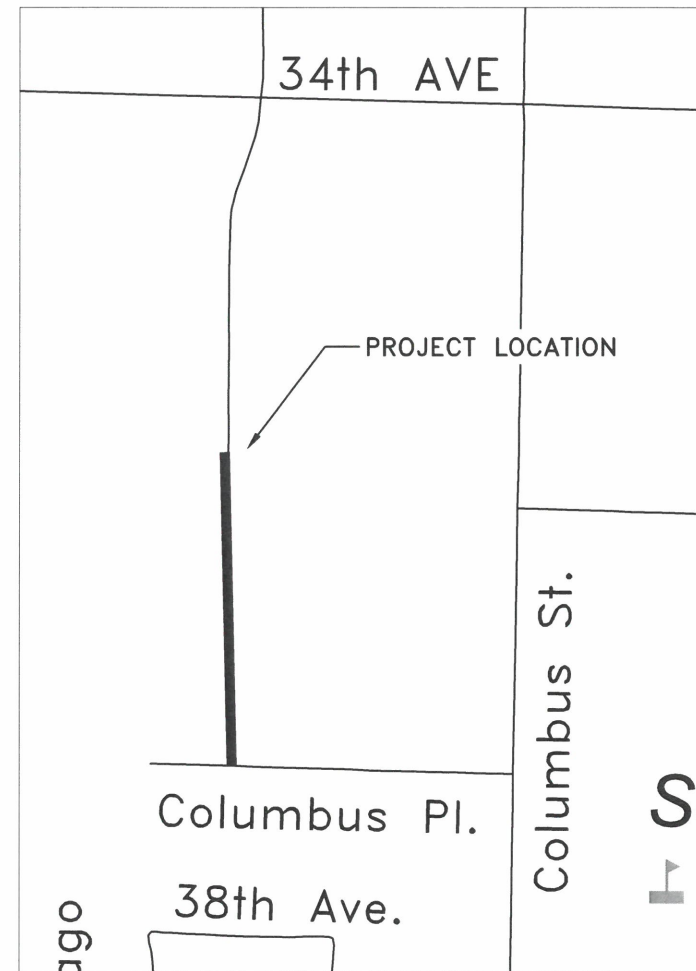

Vicinity Map
Not to Scale

GENERAL NOTES

1. ALL CONSTRUCTION SHALL CONFORM TO THE CITY OF ALBANY STANDARD CONSTRUCTION SPECIFICATIONS AND ASSOCIATED STANDARD DRAWINGS. THE CURRENT VERSION OF THE CITY OF ALBANY STANDARD CONSTRUCTION SPECIFICATIONS CAN BE FOUND ON THE CITY'S WEBSITE AT WWW.CITYOFALBANY.NET.
2. UTILITIES SHOWN ARE FOR REFERENCE ONLY. FOR A FIELD LOCATE, CALL THE UTILITIES NOTIFICATIONS CENTER AT 1-800-332-2344.
3. OPERATING ACCESS FOR CITY MAINTENANCE PERSONNEL TO EXISTING AND NEW WATER VALVES AND MANHOLES SHALL BE CONTINUOUSLY MAINTAINED BY THE CONTRACTOR DURING ALL CONSTRUCTION ACTIVITIES.
4. CONTRACTOR SHALL VERIFY ALL EXISTING PIPE ELEVATIONS, PIPE DIAMETERS, AND PIPE MATERIALS AT CONNECTION AND ABANDONMENT LOCATIONS PRIOR TO CONSTRUCTION. ANY DISCREPANCIES SHALL BE REPORTED TO ENGINEER PRIOR TO BEGINNING WORK.
5. ATTENTION: OREGON LAW REQUIRES YOU TO FOLLOW RULES ADOPTED BY THE OREGON UTILITY NOTIFICATION CENTER. THOSE RULES ARE SET FORTH IN OAR 952-001-0010 THROUGH OAR 952-001-0090. YOU MAY OBTAIN COPIES OF THE RULES BY CALLING THE CENTER. (NOTE: THE TELEPHONE NUMBER FOR THE OREGON UTILITY NOTIFICATION CENTER IS (503) 232-1987).
6. CONTRACTOR SHALL BE RESPONSIBLE FOR PROPER INSTALLATION AND MAINTENANCE OF ALL EROSION PREVENTION SEDIMENT CONTROL (EPSC) MEASURES IN ACCORDANCE WITH LOCAL, STATE, AND FEDERAL REGULATIONS UNTIL ALL CONSTRUCTION IS COMPLETED AND APPROVED BY THE CITY OF ALBANY, AND VEGETATION/LANDSCAPING IS ESTABLISHED. FOR GUIDANCE, REFER TO THE CITY OF ALBANY EPSC MANUAL WHICH CAN BE FOUND AT www.cityofalbany.net.

DESIGNED: N. NELSON	REVISIONS:
DRAWN: N. NELSON	NO: ---
CHECKED: C. CERKLEWSKI	BY: ---
DATE: 3/18/22	DATE: ---

PUBLIC WORKS DEPARTMENT
ENGINEERING SERVICES

ST-22-04, CHICAGO STREET INFILL

EXPIRATION DATE: 12/31/2022

SHEET NO. 1 OF 4

PROJECT NO: ST-22-04

FILE: FILENAME.DWG

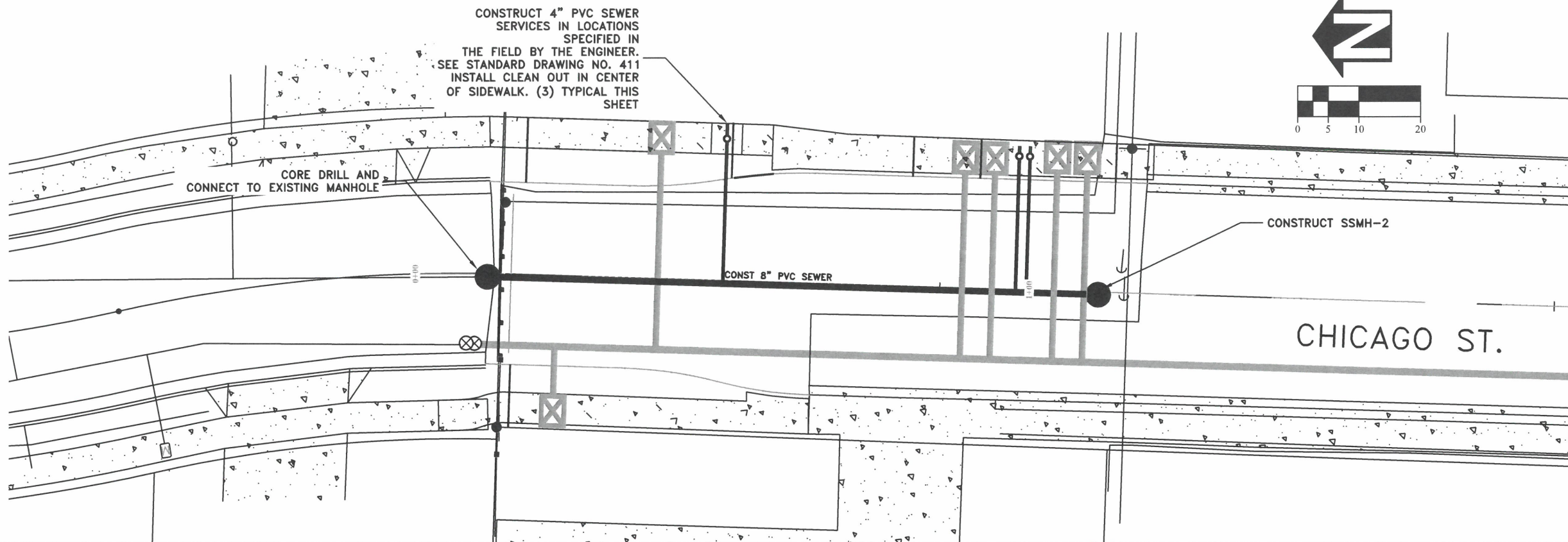

CONSTRUCT 4" PVC SEWER SERVICES IN LOCATIONS SPECIFIED IN THE FIELD BY THE ENGINEER. SEE STANDARD DRAWING NO. 411 INSTALL CLEAN OUT IN CENTER OF SIDEWALK. (3) TYPICAL THIS SHEET

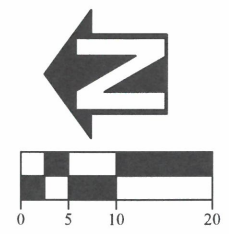

CORE DRILL AND CONNECT TO EXISTING MANHOLE

CONSTRUCT SSMH-2

CONST 8" PVC SEWER

CHICAGO ST.

STA 0+11.75 R0.48
SSMH-1
CONNECT TO EXISTING MANHOLE
RIM=233.25
NEW IE 8" PVC (S)=227.30
EXST. IE 8" PVC (N)=227.20

STA 1+11.22 R0.41
SSMH-2
CONSTRUCT STANDARD PRECAST MANHOLE
RIM=233.64
IE 8" PVC (N)=228.00

NEW 6" WATERLINE

CONSTRUCT 8" PVC S=0.007

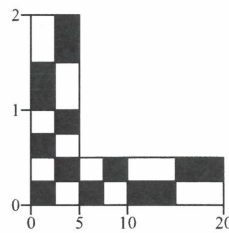

DESIGNED: N. NELSON	REVISIONS
DRAWN: N. NELSON	NO: ---
CHECKED: C. CERKLEWSKI	BY: ---
DATE: 3/18/22	DATE: ---

PUBLIC WORKS DEPARTMENT
ENGINEERING SERVICES

**ST-22-04, CHICAGO STREET INFILL
SEWER CONSTRUCTION**

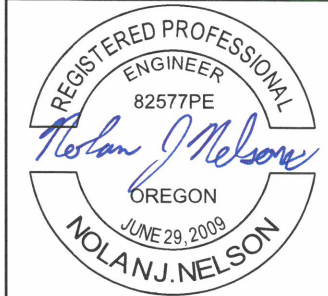

EXPIRATION DATE: 12/31/2022

SHEET NO. 2 OF 4

PROJECT NO: ST-22-04

FILE: BASE.DWG

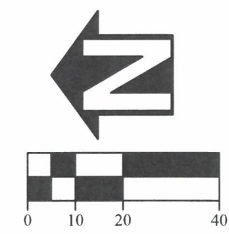
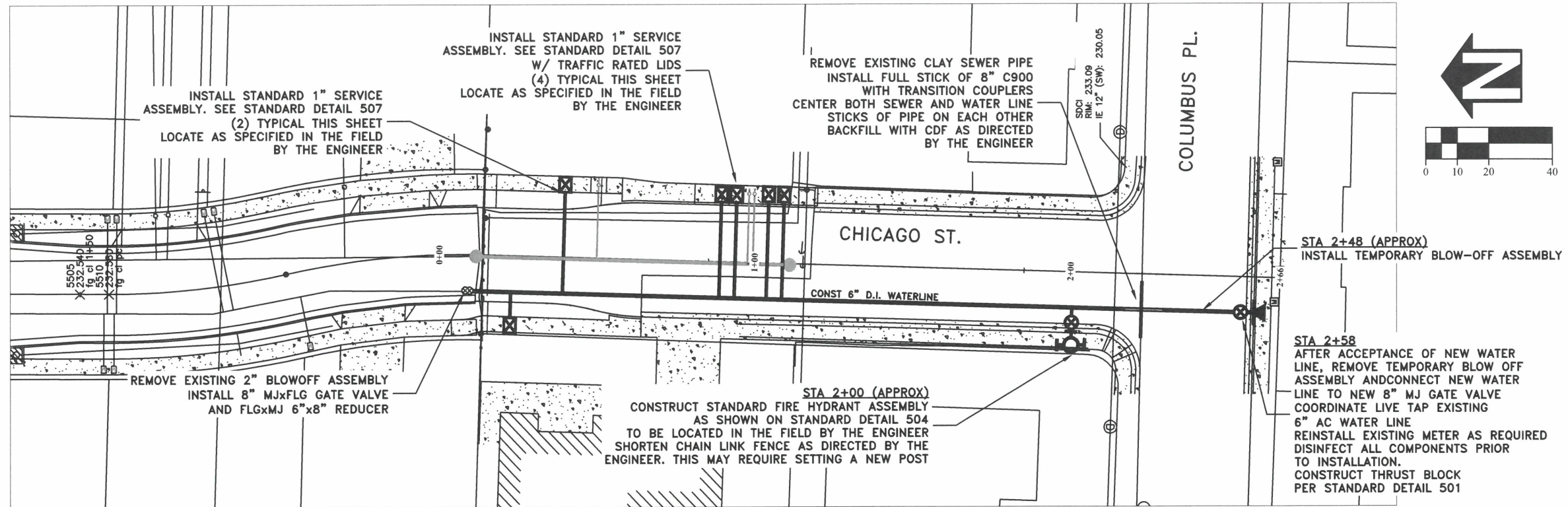

DESIGNED: N. NELSON	REVISIONS
DRAWN: N. NELSON	NO: ---
CHECKED: C. CERKLEWSKI	BY: ---
DATE: 3/18/22	DATE: ---

**PUBLIC WORKS DEPARTMENT
ENGINEERING SERVICES**

**ST-22-04, CHICAGO STREET INFILL
WATER CONSTRUCTION**



EXPIRATION DATE: 12/31/2022

SHEET NO. 3 OF 4

PROJECT NO: ST-22-04

FILE: BASE.DWG

NOTES:

1. MINIMUM COVER OVER THE NEW WATER LINE SHALL BE 3 FEET AS MEASURED FROM THE EXISTING GROUND. THE WATER LINE WILL NEED TO BE LOWERED IN ORDER TO CROSS THE EXISTING UTILITIES IN COLUMBUS PLACE. CONTRACTOR SHALL EXCAVATE AND LOCATE EACH KNOWN UNDERGROUND UTILITY WHERE THEY CROSS THE NEW WATER LINE WELL ENOUGH IN ADVANCE TO ADJUST THE NEW WATER LINE GRADE WITHOUT THE NEED FOR ADDITIONAL FITTINGS OR THRUST RESTRAINT.
2. TEMPORARY PAVEMENT RESTORATION WILL BE REQUIRED ON ALL ROAD SURFACES BY THE END OF EACH WORKING DAY PER THE STANDARD CONSTRUCTION SPECIFICATIONS.
5. DRIVEWAYS SHALL BE 6" THICK CONCRETE UNLESS OTHERWISE INDICATED ON THIS SHEET

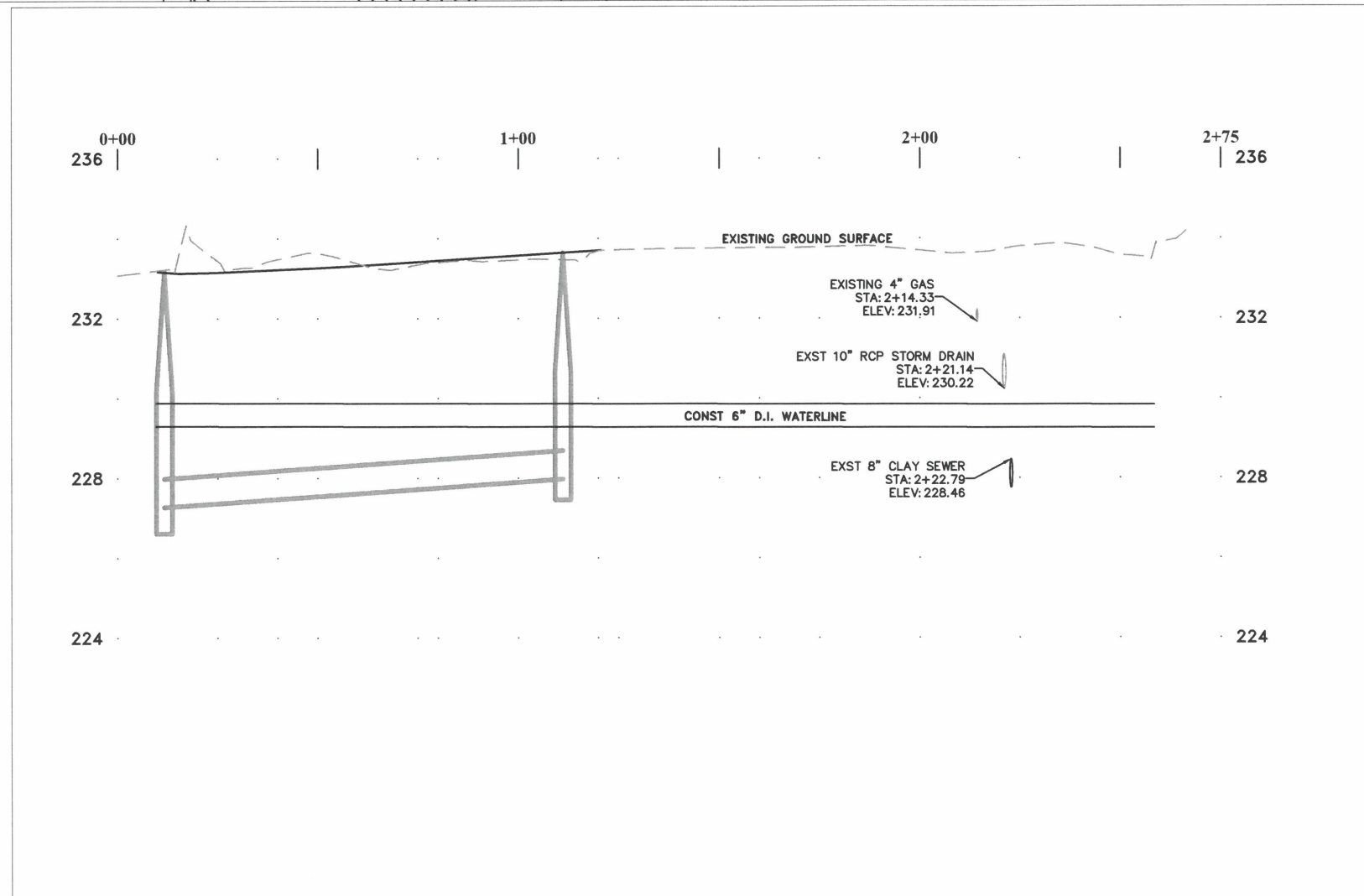
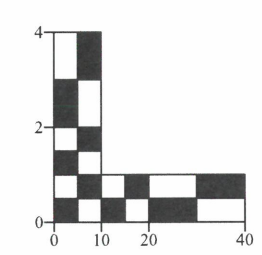

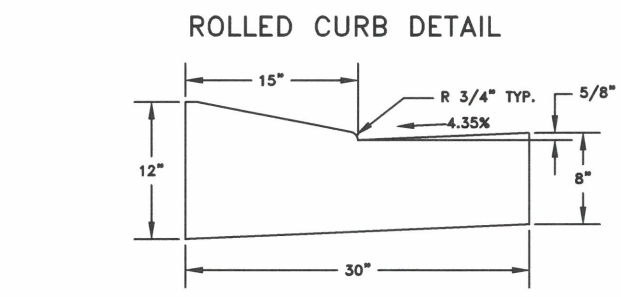
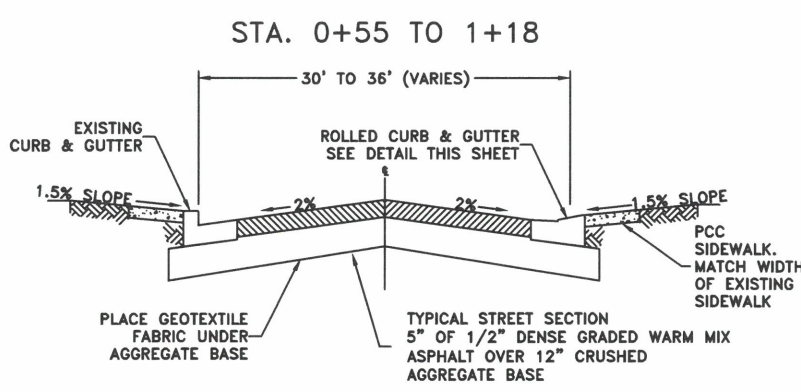
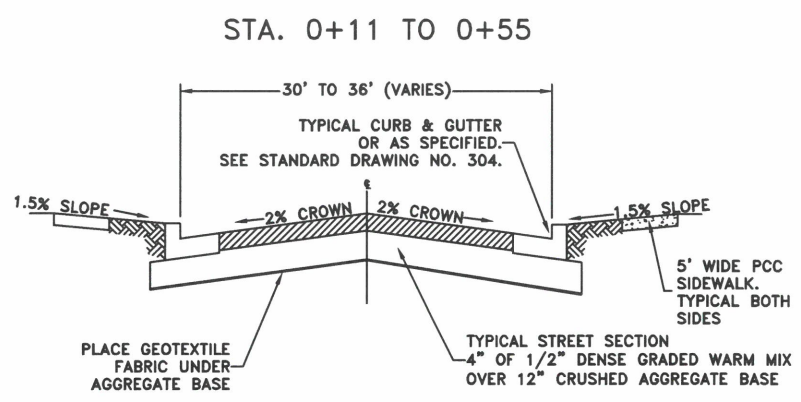
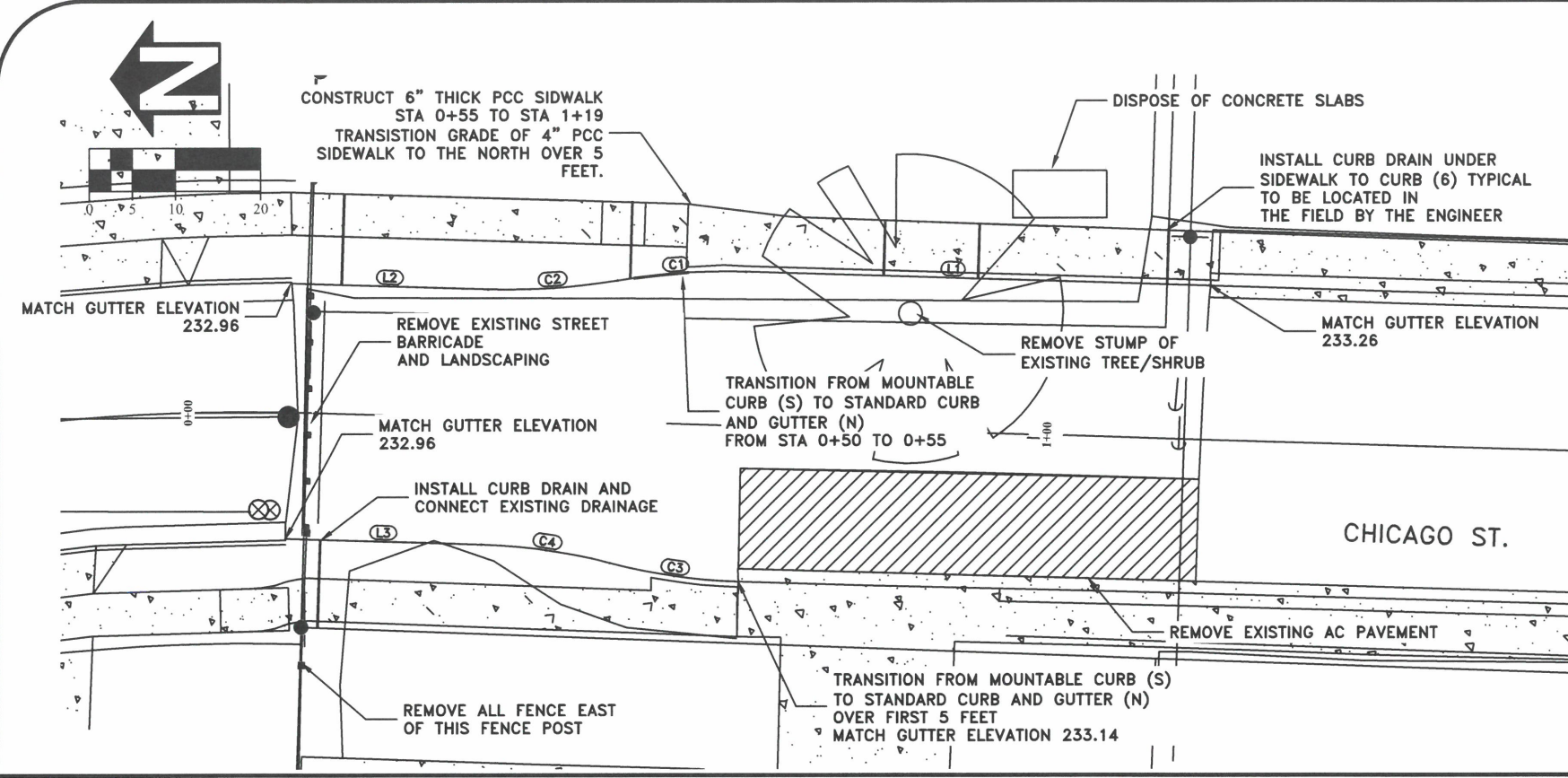

EAST GUTTER			
Number	Radius	Length	Line/Chord Direction
L2		22.84	S1° 46' 11.49\"W
C2	76.60	15.09	S3° 52' 29.93\"E
C1	76.68	15.09	S3° 52' 29.93\"E
L1		54.11	S1° 45' 37.72\"W

WEST GUTTER			
Number	Radius	Length	Line/Chord Direction
L3		22.75	S1° 46' 11.49\"W
C4	66.81	15.16	S8° 16' 16.96\"W
C3	66.81	15.16	S8° 16' 16.96\"W

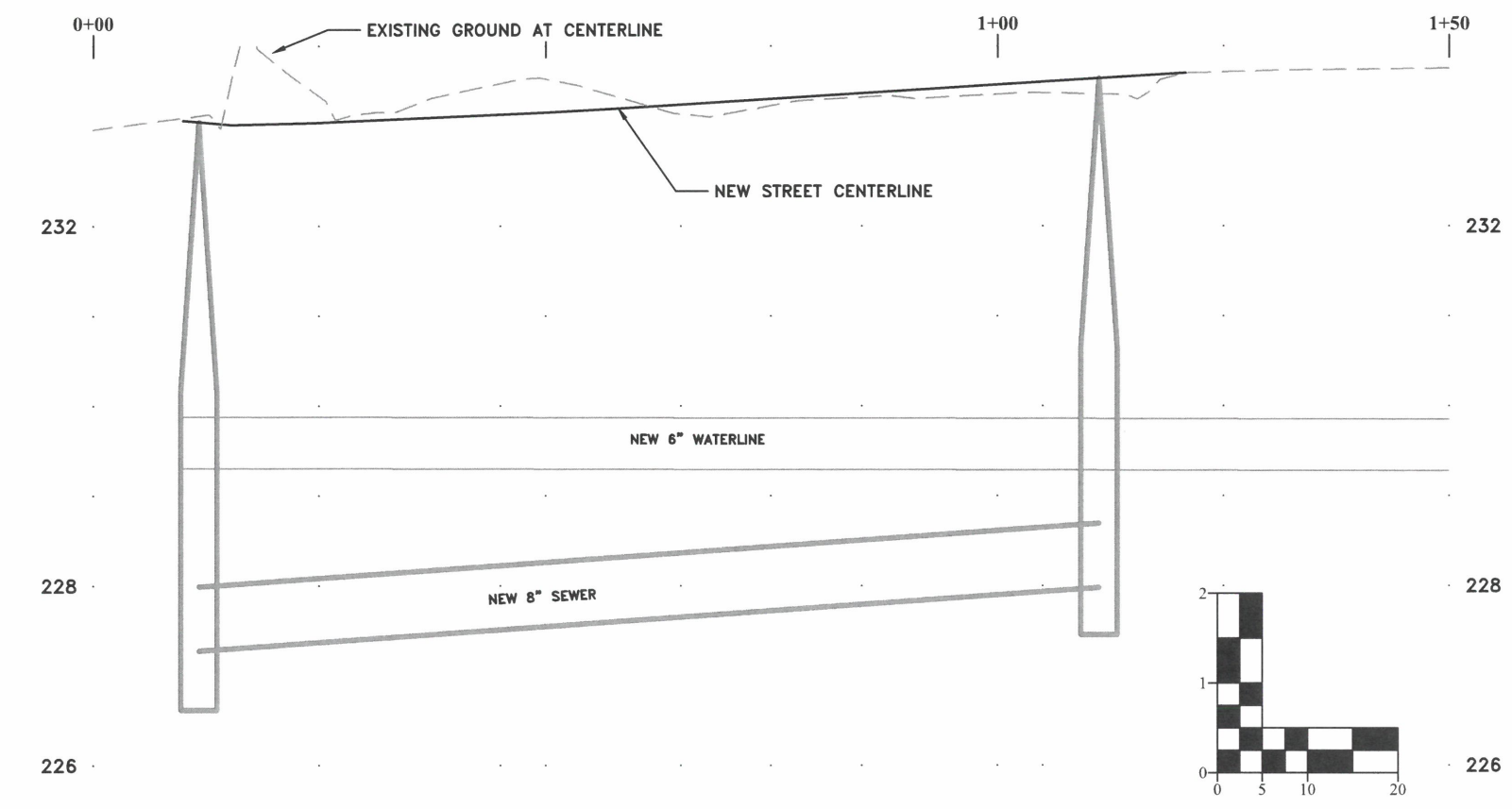

DESIGNED: N. NELSON	REVISIONS
DRAWN: N. NELSON	NO:
CHECKED: C. CERKLEWSKI	BY:
DATE: 3/18/22	DATE:

PUBLIC WORKS DEPARTMENT
ENGINEERING SERVICES



ST-22-04, CHICAGO STREET INFILL
STREET CONSTRUCTION

REGISTERED PROFESSIONAL
ENGINEER
82577PE
Nolan J. Nelson
OREGON
JUNE 29, 2009
NOLAN J. NELSON

EXPIRATION DATE: 12/31/2022

SHEET NO. 4 OF 4
PROJECT NO: ST-22-04
FILE: BASE.DWG