

REVISIONS		DESIGNED	TR.
DATE	NO.	BY	WVC
2/24/17	AS-BUILT	RAJ	
		CHECKED	
		SCALE:	
		HORIZ.	1" = 10'
		VERT.	

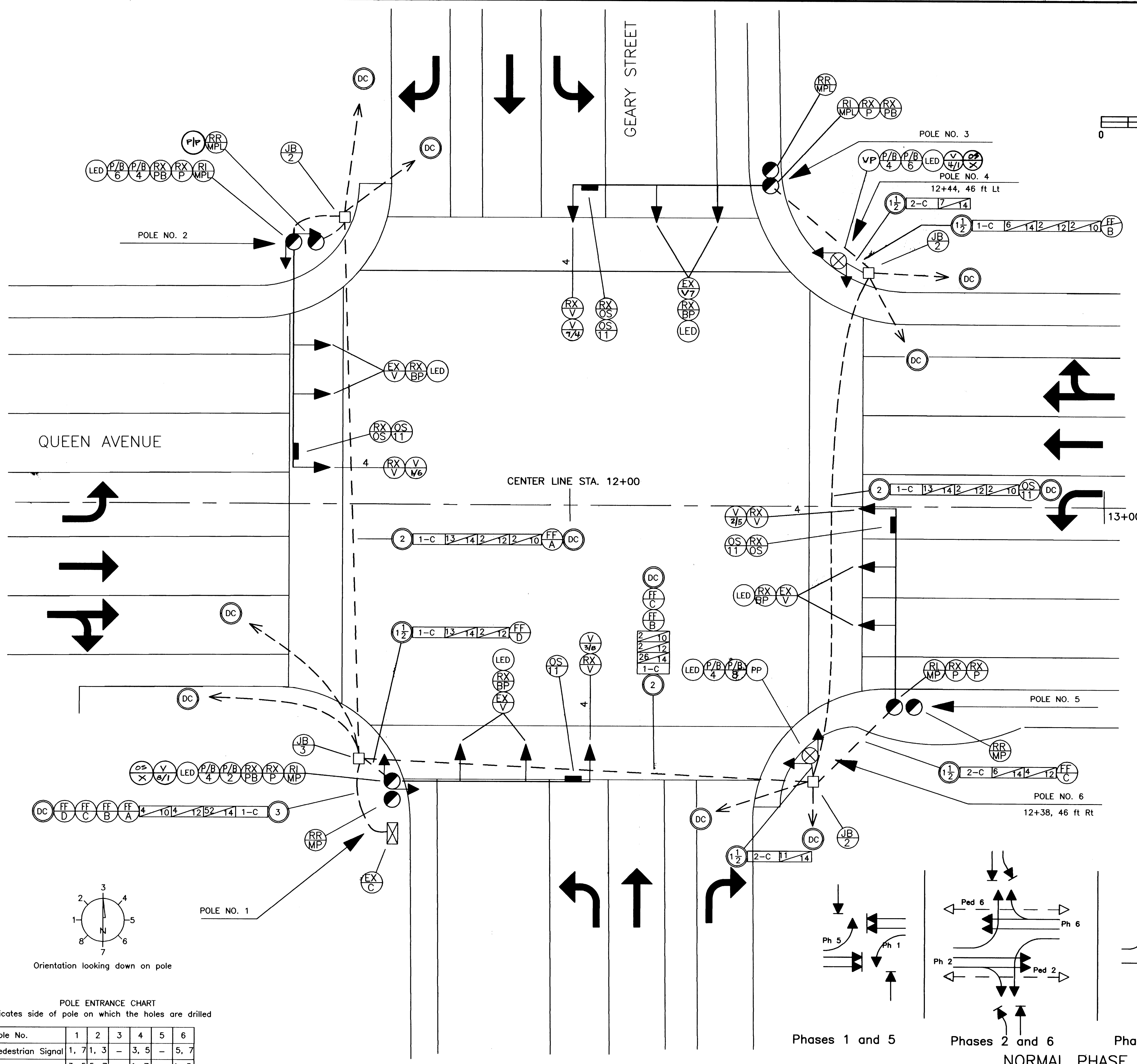

LEGEND

- Retain and protect existing controller
 - Remove and relocate existing traffic signal mast arm pole
 - Remove and relocate existing traffic signal mast arm pole with luminaire extension
 - Remove existing pedestrian signals
 - Remove existing pedestrian pushbuttons and pedestrian signs
 - Remove existing vehicle signal
 - Remove existing interior illuminated sign
 - Install pedestrian signal pedestal with frangible base
 - Install phase (Ph) vehicle signal without backplate
 - Install phase (Ph) clamshell type pedestrian signal, pushbutton, and instruction sign on extruded aluminum assembly
 - Install interior illuminated Left Turn Yield On Green Ball sign
 - Install 22 1/4" x 12 1/4" x 13" precast concrete junction box
 - Install 30" x 17" x 12" precast concrete junction box
 - Install (S) inch electrical conduit
 - Detector conduit (see Detector Plan)
 - Retain and protect existing electrical conduit
 - Reinstall existing traffic signal mast arm pole
 - Reinstall existing traffic signal mast arm pole with luminaire extension
 - Install channel (Ch) fire pre-emption detector feeder cable
 - Retain and protect existing vehicle signal
 - Remove existing vehicle signal backplate
 - Install LED retrofit kit(s)
 - Install 412W or 412B2 Prom board with latest version of W4IKS program (Contractor supplied)
 - Install (N) no. 8 type THWN wires (signal system common)
 - Install (N) no. (G) type THWN wires
- Ph = Phase shown
 N = Number shown
 G = AWG size shown
 S = size shown
 4 = 12" R, 12" YLTA, 12" Y, 12" GLTA, 12" G
- RIGHT TURN YIELD TO PEDES ON GREEN

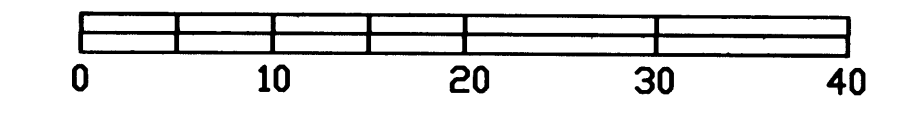
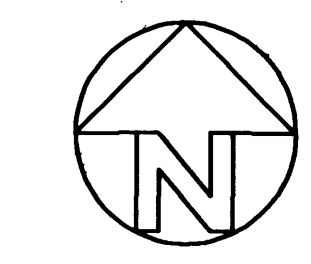
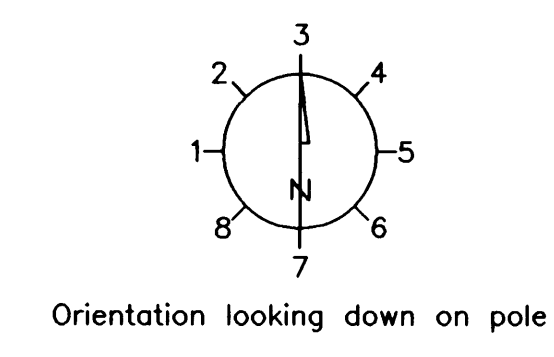

POLE ENTRANCE CHART
 Number indicates side of pole on which the holes are drilled

Pole No.	1	2	3	4	5	6
Pedestrian Signal	1, 7	1, 3	-	3, 5	-	5, 7
Ped Pushbutton	3, 5	5, 7	-	1, 7	-	1, 3

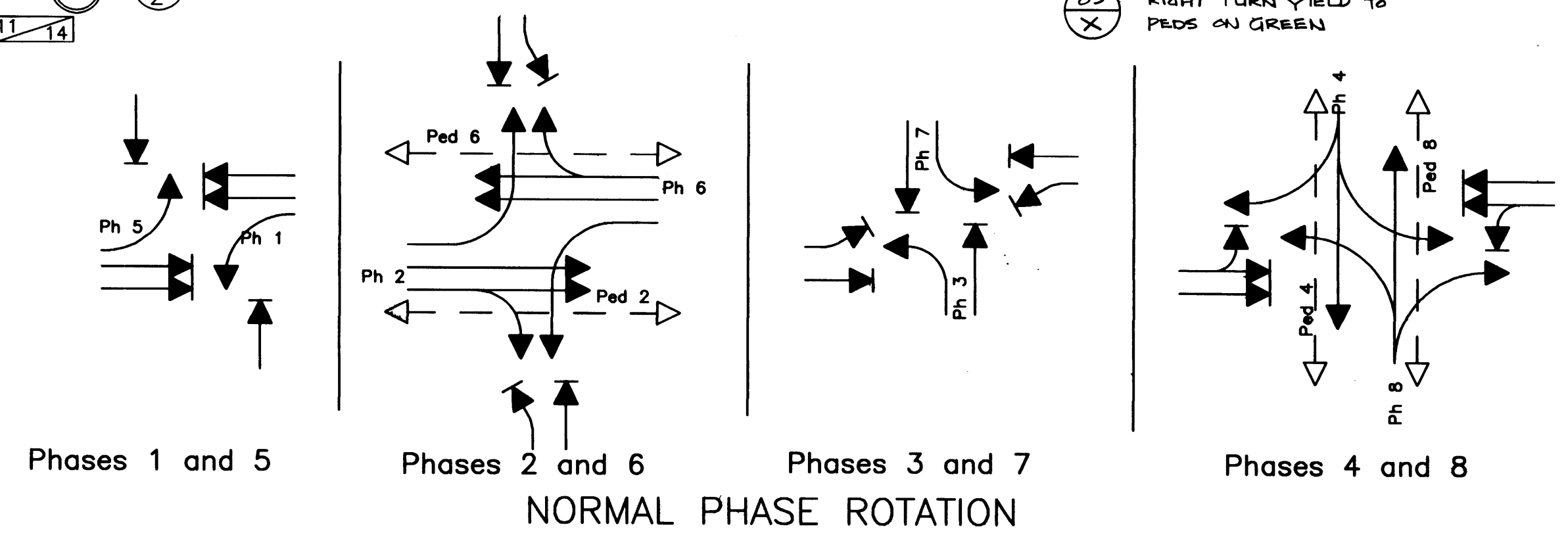

Note:
 Install LED retrofit kits in all vehicle signal red arrow and red ball sections and pedestrian orange wait sections. See special provisions for specifications.

94244SIG.DWG

LANCASTER ENGINEERING
 Union Station, Suite 206
 800 N.W. 6th Avenue
 Portland, OR 97209
 (503) 248-0315

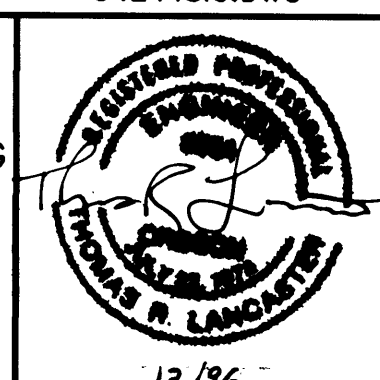

CITY OF ALBANY, OREGON
 PUBLIC WORKS DEPARTMENT
 ENGINEERING/UTILITIES DIVISION

SIGNAL PLAN
QUEEN/GEARY INTERSECTION

12/16

ST-94-8

LOOP DETECTOR WIRING DIAGRAM

DATE	REVISIONS	DESIGNED	TRK
2/14/97	AS-BUILT	PAJ	
		CHECKED	3/28/95
		SCALE:	
		HORIZ.	1" = 20'
		VERT.	

Loop No.	Phase	Function	Slot
1	S	2	E, C, CO — I2U
2	S	2	E, C, CO — I2L
3	S	2	E, C, CO — I2L
4	S	2	E, C, CO — I2L
5	S	2	E, C — I3U
6	S	2	E, C — I3U
7	S	2	E, C — I3U
8	S	2	E, C — I3U
9	S	2	E, C, CO — I3L
10	S	2	E, C, CO — I3L
11	S	5	E, C, CO — J1U
12	S	5	E, C, CO — J1U
13	S	5	E, C, CO — J1U
14	S	4	E, C, CO — I6U
15	S	4	E, C, CO — I6L
16	S	4	E, C, CO — I6L
17	S	4	E, C, CO — I6L
18	S	4	E, C — I7U
19	S	4	E, C — I7U
20	S	4	E, C — I7U
21	S	4	E, C — I7U
22	S	4	E, C, CO — I7L
23	S	4	E, C, CO — I7L
24	S	7	E, C, CO — J5U
25	S	7	E, C, CO — J5U
26	S	7	E, C, CO — J5U
27	S	6	E, C, CO — J2U
28	S	6	E, C, CO — J2U
29	S	6	E, C, CO — J2L
30	S	6	E, C, CO — J2L
31	S	6	E, C, CO — J3U
32	S	6	E, C, CO — J3U
33	S	6	E, C, CO — J3U
34	S	6	E, C, CO — J3L
35	S	6	E, C, CO — J3L
36	S	1	E, C, CO — I1U
37	S	1	E, C, CO — I1U
38	S	1	E, C, CO — I9U
39	S	1	E, C, CO — I9U
40	S	8	E, C, CO — J6U
41	S	8	E, C, CO — J6L
42	S	8	E, C, CO — J6L
43	S	8	E, C, CO — J6L
44	S	8	E, C — J7U
45	S	8	E, C — J7U
46	S	8	E, C, CO — J7L
47	S	8	E, C, CO — J7L
48	S	3	E, C — I5U
49	S	3	E, C — I5U
50	S	3	E, C, CO — I9L
51	S	3	E, C, CO — I9L
52	S	3	E, C, CO — I9L

S = Series, E = Extension, C = Call, CO = Carryover
 See TES Drwg. TS-129 for loop detector details
 Center all loops in travel lanes or as shown on plan
 All loops are to be individually wound clockwise and series wired
 at junction box or controller as shown on the Loop Detector Wiring Diagram.

Program transfer to I4U

Controller Cabinet

Program transfer to I8U

Program transfer to J4U

Program transfer to J8U

Locate 220 ft from Stop Line

Locate 110 ft from Stop Line

QUEEN AVENUE

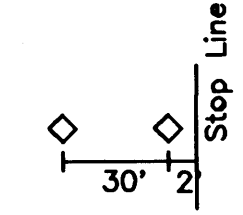
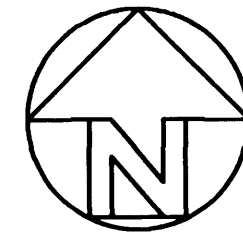

LEGEND

- Retain and protect existing controller
- Junction box (see signal plan)
- Install 17 1/4" x 10 1/2" x 12" precast concrete junction box
- Install phase (Ph) 2 ft diamond preformed bicycle detector loop
- Install phase (Ph) 3 ft diamond preformed vehicle detector loop
- Install phase (Ph) 4 ft diamond preformed vehicle detector loop
- Install (X) phase (Ph) loop feeder cables
- Install (N) pair of loop wires
- Install (S) inch electrical conduit
- Electrical conduit (see Signal Plan)

Ph = Phase shown
 X = Number of cables shown
 N = Number shown
 S = Size shown (inches)

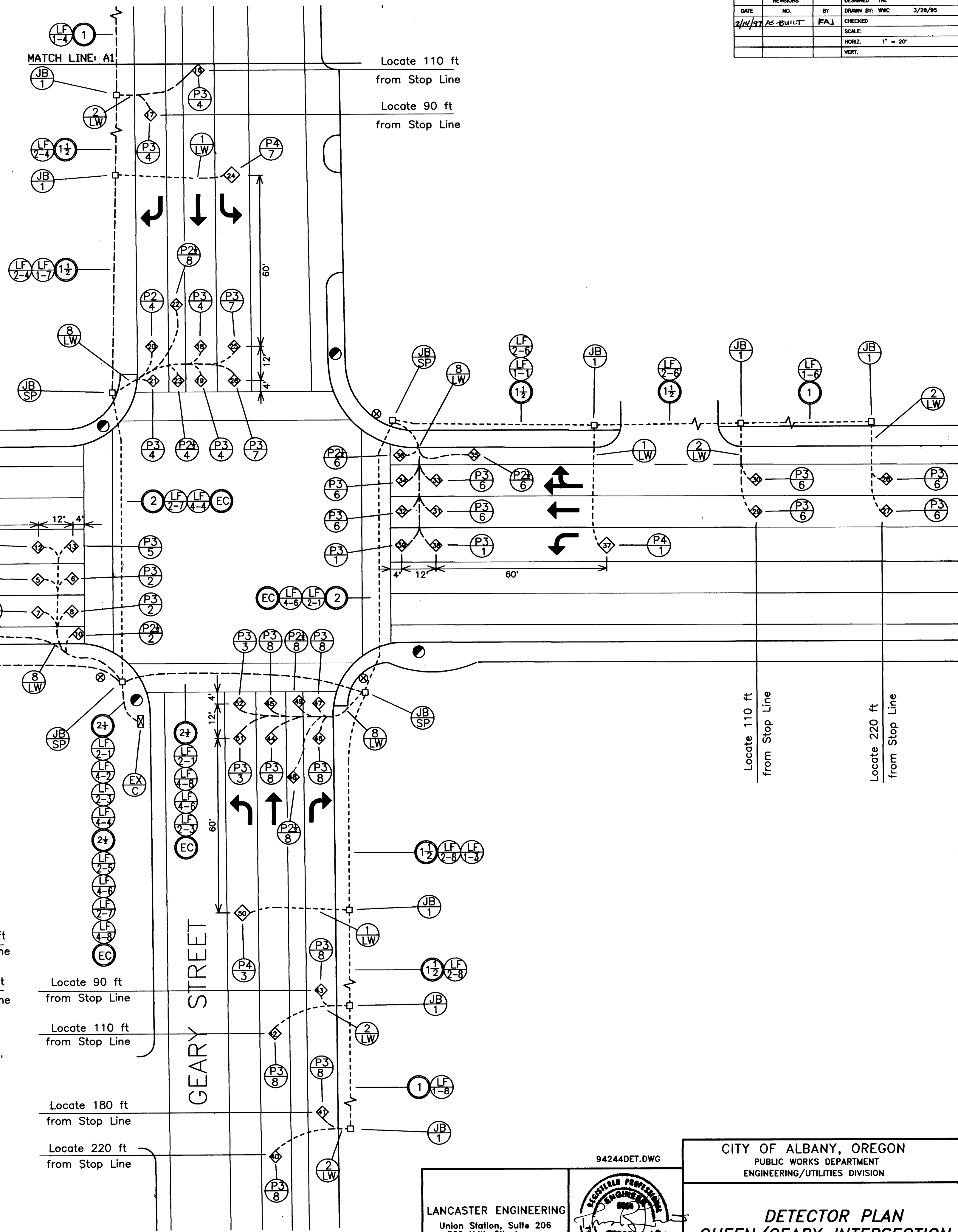
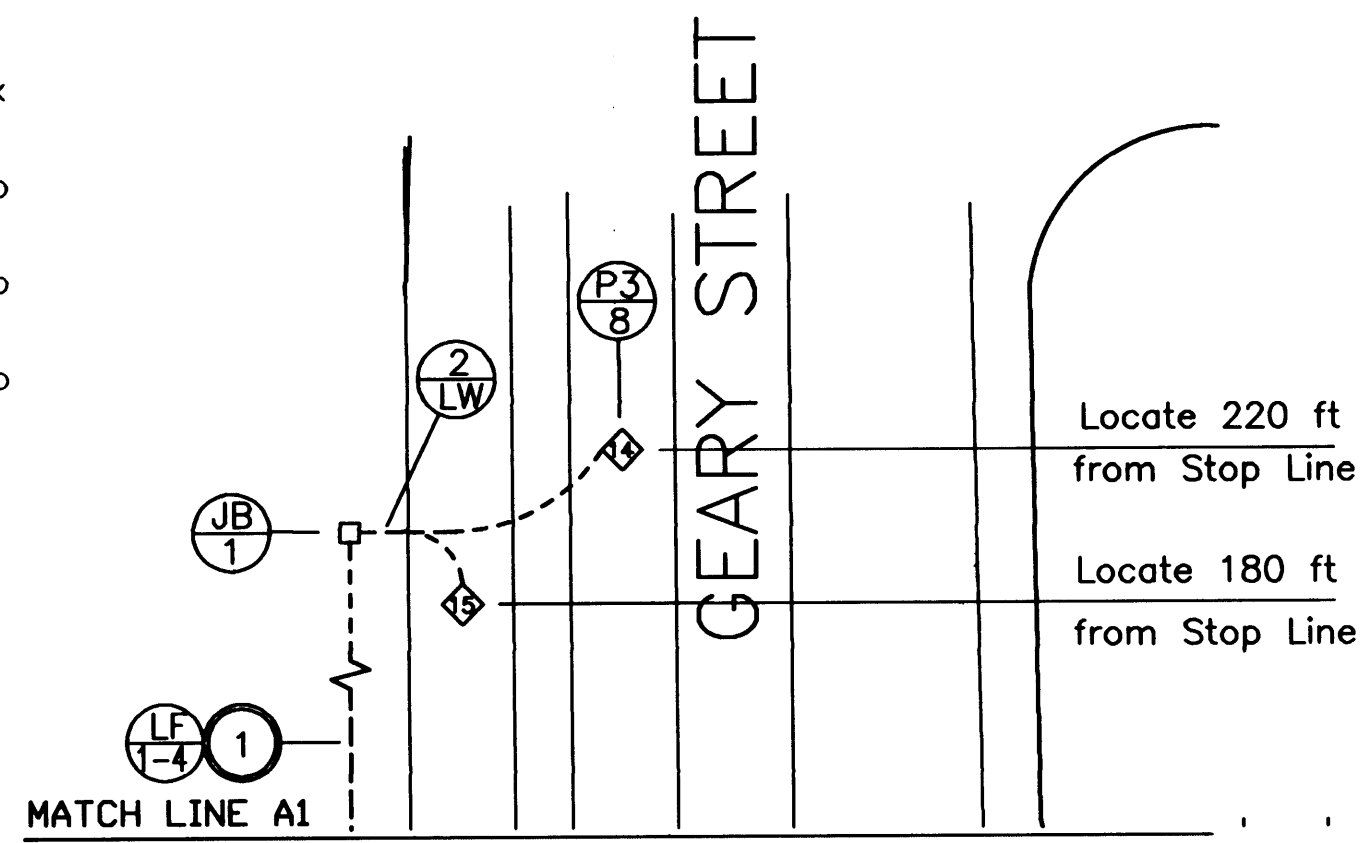

94244DET.DWG

LANCASTER ENGINEERING
 Union Station, Suite 206
 800 N.W. 6th Avenue
 Portland, OR 97209
 (503) 248-0313

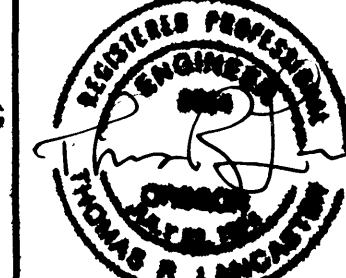

CITY OF ALBANY, OREGON
 PUBLIC WORKS DEPARTMENT
 ENGINEERING/UTILITIES DIVISION

DETECTOR PLAN
 QUEEN/GEARY INTERSECTION

ST-94-8