

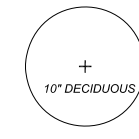

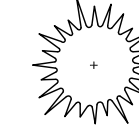

LEGEND

-  EX. DECIDUOUS TREE TO REMAIN (W/ TRUNK DIAMETER)
-  EXISTING CONIFER TO REMAIN (W/ TRUNK DIAMETER)
-  NEW CONCRETE PAVING WITH JOINTING (NOT VEHICLE LOAD) JOINTING LAYOUT IS TO MATCH THIS PLAN UNLESS APPROVED BY LANDSCAPE ARCHITECT
-  TREE PROTECTION FENCING
-  NEW CONCRETE PAVING (VEHICLE LOAD)
-  WETLAND
-  SCH. 40 PVC IRRIGATION SLEEVE (2" 4" SLEEVES AT EACH LOCATION SHOWN)

NOTES:

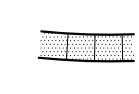
1. PROVIDE NEW CONCRETE SIDEWALK WHERE SHOWN. SEE SHEET L-3 FOR PAVING DETAILS. SEE SPECIFICATIONS FOR ADDITIONAL REQUIREMENTS.
2. SEE SHEET L-2 FOR LAYOUT AND DIMENSIONING OF SITE ELEMENTS.
3. SEE L-3 FOR GRADING AND ADDITIONAL DETAILS.
4. SEE ELECTRICAL PLANS FOR POLE LIGHT AND ELECTRIC SUPPLY DOCUMENTATION.
5. CONTRACTOR TO INSTALL SLEEVES FOR IRRIGATION SYSTEM AT SIZES AND LOCATIONS AS SHOWN ON PLAN AND IN LEGEND.
6. PROVIDE TREE PROTECTION FENCING WHERE SHOWN. SEE SHEET L-3 FOR TREE PROTECTION REQUIREMENTS.
7. NO DISTURBANCE IS ALLOWED WITHIN WETLAND BOUNDARIES. SEE SHEET L-3 FOR SEDIMENT FENCE REQUIREMENTS.

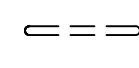
SITE PLAN

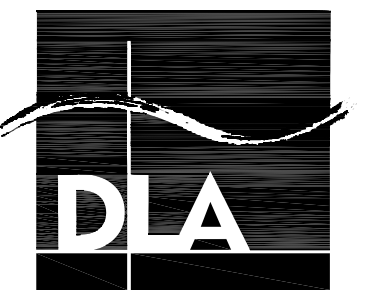
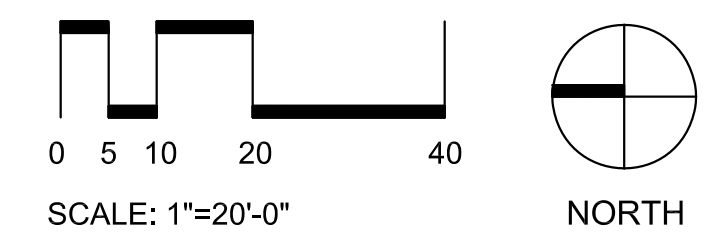

**DOUGHERTY
LANDSCAPE
ARCHITECTS**

474 Willamette Street
Suite 305
Eugene, Oregon 97401

P 541.683.5803
F 541.683.8183

www.DLAdesign.com



CLIENT:
CITY OF ALBANY
DEPT. OF PARKS AND RECREATION

CONTACT:
ED HODNEY
DIRECTOR OF PARKS AND RECREATION
541-917-7769 PHONE
541-917-7776 FAX

PROJECT:
SUNRISE PARK PHASE II
2275 THURSTON STREET
ALBANY, OR 97322

DATE: 05-28-19
REVISIONS:

DWG NO.

L-1

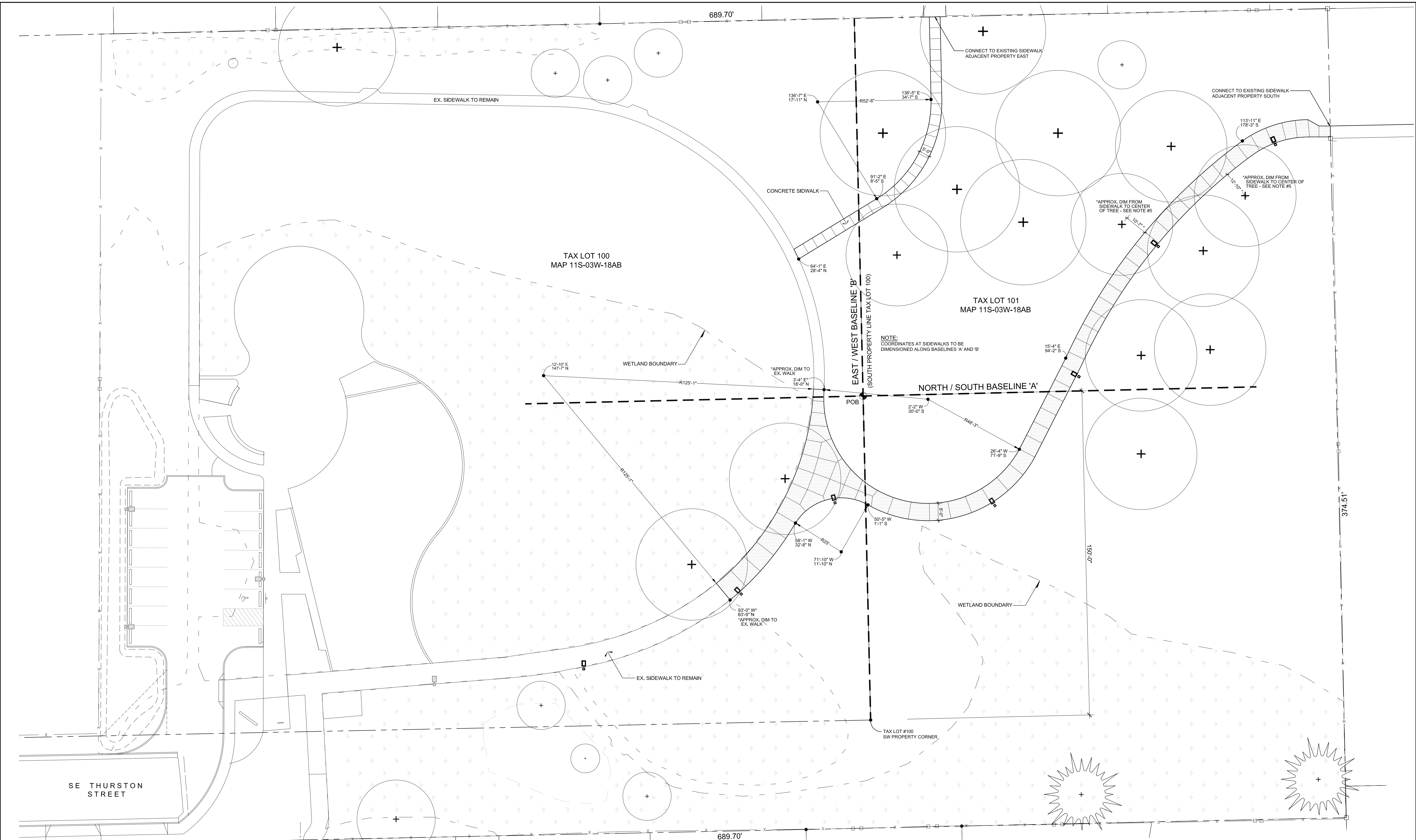

LEGEND	
	POINT OF BEGINNING
	RADIUS DIMENSION
	COORDINATES ALONG BASELINE
	EX. DECIDUOUS TREE TO REMAIN
	EXISTING CONIFER TO REMAIN
	NEW CONCRETE PAVING WITH JOINTING (NOT VEHICLE LOAD) JOINTING LAYOUT IS TO MATCH THIS PLAN UNLESS APPROVED BY LANDSCAPE ARCHITECT
	NEW CONCRETE PAVING (VEHICLE LOAD)
	WETLAND

- NOTES:**
- CONTRACTOR WILL BE PROVIDED WITH AUTOCAD FILES FOR LAYOUT PURPOSES. CITY WILL SUPPLY SURVEY WORK NEEDED FOR PROJECT STAKING OF PAVING AND SITE IMPROVEMENTS. CONTRACTOR TO REQUEST SURVEY WORK FROM CITY IN ADVANCE.
 - NOTIFY LANDSCAPE ARCHITECT UPON DISCOVERY OF ANY DISCREPANCIES IN DIMENSIONS, LOCATIONS, GRADES OR OTHER CONDITIONS.
 - SEE TOPOGRAPHIC SURVEY FOR EXISTING CONDITIONS AND UTILITY INFORMATION.
 - CONTRACTOR SHALL STAKE OR PAINT LAYOUT OF ALL WALKS AND PAVED AREAS TO BE APPROVED BY OWNER PRIOR TO CONSTRUCTION.
 - APPROXIMATE DIMENSIONS PROVIDED TO CENTER OF EX. TREES. INTENT IS TO LOCATE PATH THROUGH TREES PROVIDING MINIMUM CLEARANCES AS SHOWN. CONTRACTOR TO PAINT ALIGNMENT FOR APPROVAL (PER NOTE ABOVE) PRIOR TO CONSTRUCTION.
 - CONTRACTOR TO COORDINATE CLEAR DELINEATION OF WETLAND BOUNDARY AND LIMITS OF WETLAND DISTURBANCE PRIOR TO LAYOUT. NO SITE IMPROVEMENTS PER LAYOUT OF THIS SHEET ARE ALLOWED BEYOND LIMITS OF WETLAND DISTURBANCE. CONTRACTOR TO NOTIFY OWNER, CIVIL AND LANDSCAPE ARCHITECT FOR LAYOUT REVISIONS IF ANY IMPROVEMENTS PER THIS LAYOUT EXTEND BEYOND LIMITS OF DISTURBANCE.
 - SEE SHEET L-3 FOR TREE PROTECTION REQUIREMENTS.
 - NO CONSTRUCTION DISTURBANCE (OTHER THAN DISTURBANCE IMMEDIATELY ADJACENT TO PATH CONSTRUCTION) OR STAGING IS ALLOWED WITHIN THE DRIPLINES OF EXISTING TREES TO REMAIN.

LAYOUT PLAN

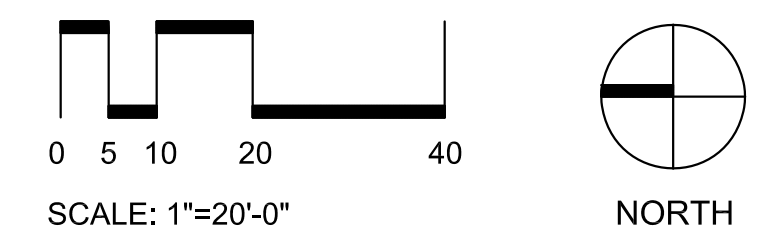

DOUGHERTY LANDSCAPE ARCHITECTS
 474 Willamette Street
 Suite 305
 Eugene, Oregon 97401
 P 541.683.5803
 F 541.683.8183
 www.DLAdesign.com

REGISTERED
 279
 David J. Dougherty
 OREGON
 LANDSCAPE ARCHITECT

CLIENT:
 CITY OF ALBANY
 DEPT. OF PARKS AND RECREATION

CONTACT:
 ED HODNEY
 DIRECTOR OF PARKS AND RECREATION
 541-917-7769 PHONE
 541-917-7776 FAX

PROJECT:
SUNRISE PARK PHASE II
 2275 THURSTON STREET
 ALBANY, OR 97322

DATE: 05-28-19
 REVISIONS:

DWG NO.
L-2
 DLA Inc. COPYRIGHT 2019

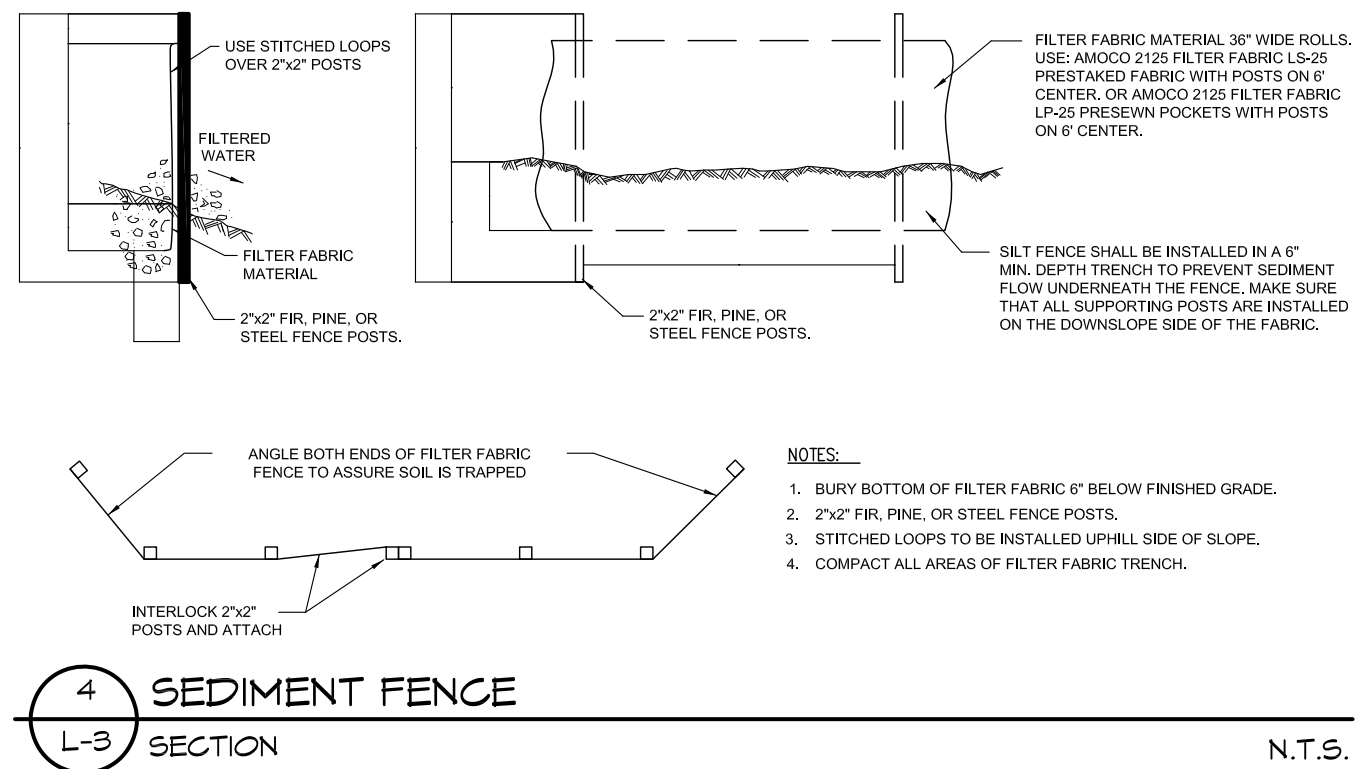
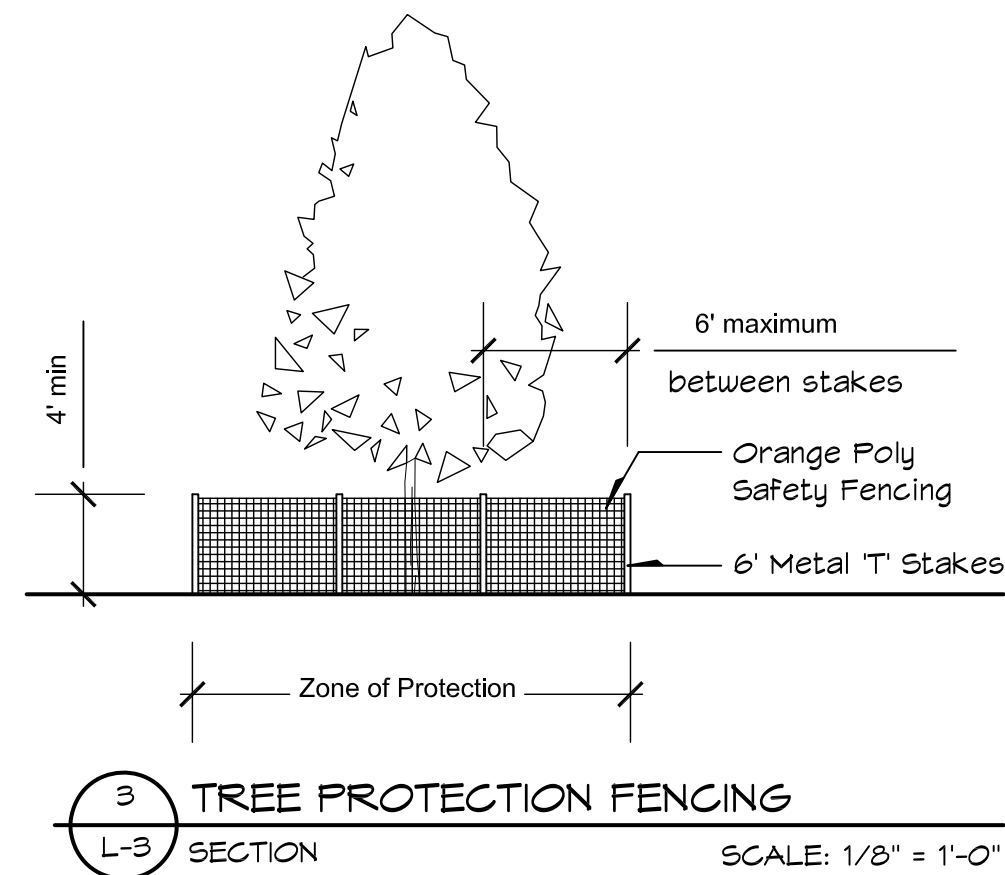
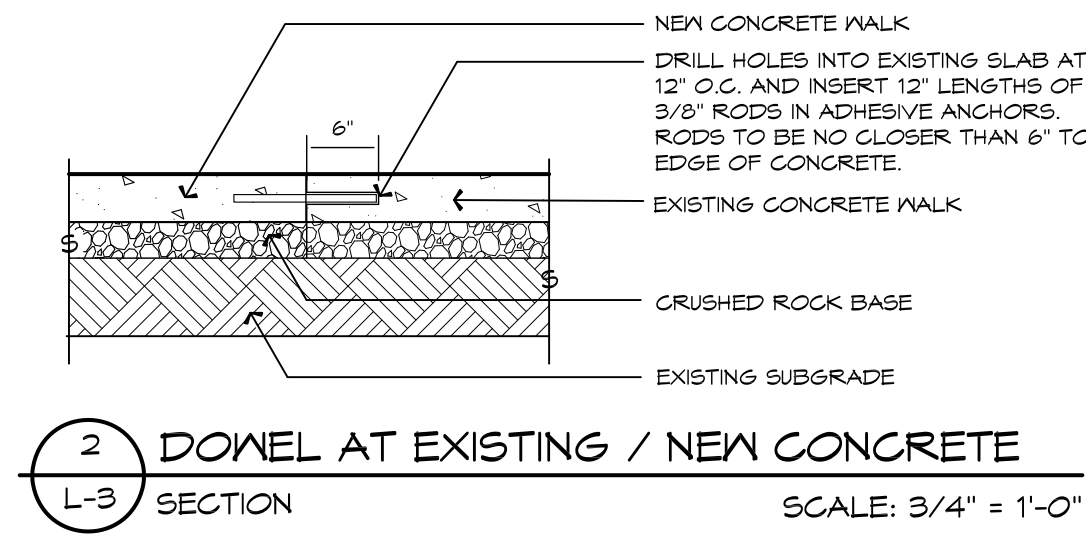
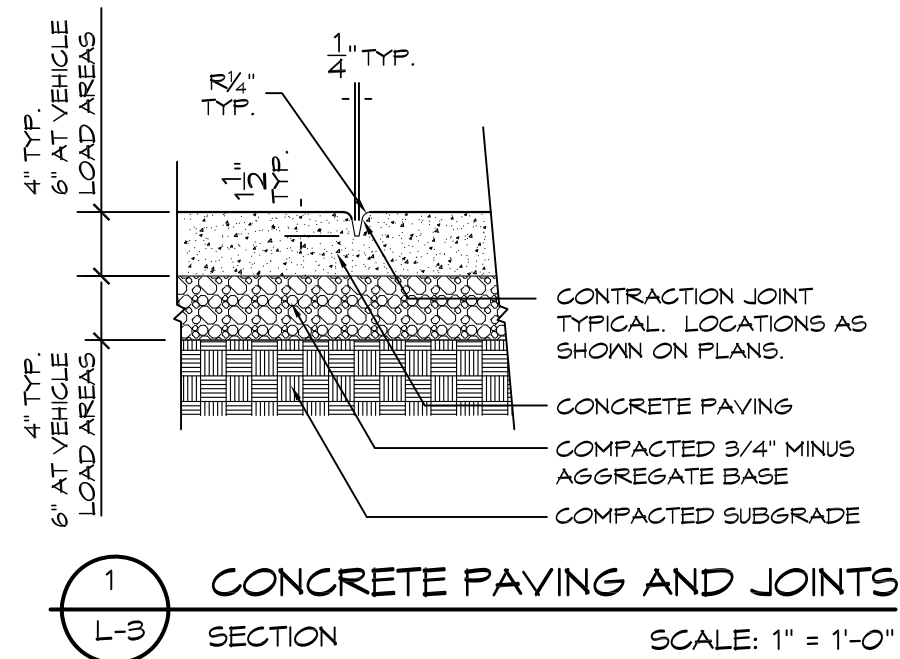

GRADING AND EARTHWORK NOTES

- TOP OF CONCRETE AT NEW SIDEWALKS IS TO MATCH EXISTING GRADES (AS SURVEYED PRIOR TO CONSTRUCTION) AT SIDEWALK EDGES.
- CONTRACTOR IS TO RAKE AND REMOVE ROCK, DEBRIS AND UNWANTED VEGETATION TO A DEPTH OF SIX INCHES AT AREAS OF DISTURBANCE ADJACENT TO NEW SIDEWALK CONSTRUCTION. THIS REQUIREMENT IS ALSO APPLICABLE AT OTHER LANDSCAPE AREAS THAT ARE DISTURBED BY CONSTRUCTION STAGING OR OTHER CONSTRUCTION ACTIVITY.
- CONTRACTOR IS TO PROVIDE IMPORTED SANDY LOAM TOPSOIL (AT DISTURBED AREAS ADJACENT TO SIDEWALK CONSTRUCTION) SO THAT TOP OF FINISHED GRADE IS FLUSH WITH TOP OF CONCRETE AND ADJACENT FINISHED GRADE.
- EXISTING GRADE INFORMATION HAS BEEN DERIVED FROM PROJECT SURVEY BY K AND D ENGINEERING. CONTRACTOR SHALL FIELD VERIFY ELEVATIONS OF EXISTING GRADES TO REMAIN PRIOR TO CONSTRUCTION AND NOTIFY LANDSCAPE ARCHITECT OF DISCREPANCIES TO PLAN.
- CONTRACTOR TO VERIFY THAT ALL SLOPES AT NEW CONCRETE SIDEWALKS ARE IN COMPLIANCE WITH ADA STANDARDS. CROSS SLOPE ON NEW SIDEWALKS NOT TO EXCEED 2%. LONGITUDINAL SLOPE ON NEW SIDEWALKS NOT TO EXCEED 5%. BASED ON EXISTING SPOT ELEVATIONS, LONGITUDINAL SLOPE WILL TYPICALLY BE UNDER 2%. NOTIFY LANDSCAPE ARCHITECT IF, BY MATCHING EXISTING GRADES, SLOPES EXCEED MAXIMUM ALLOWED. LANDSCAPE ARCHITECT WILL THEN PROVIDE ALTERNATIVE GRADING AT THOSE AREAS TO CONFORM TO MAXIMUM SLOPES.
- CONTRACTOR TO ENSURE THAT ALL SIDEWALK SURFACES PROVIDE POSITIVE DRAINAGE AND ARE 'PUDDLE FREE'.
- SEE PAVING DETAILS AND SPECIFICATIONS FOR STRUCTURAL FILL REQUIREMENTS BELOW PAVED AREAS.
- PRIOR TO ANY CONSTRUCTION OPERATIONS, THE CONTRACTOR SHALL ESTABLISH ADEQUATE GRADING INFORMATION FOR PROPOSED WORK TO ALLOW FOR THE EVALUATION OF ITS RELATIONSHIP TO EXISTING SITE FEATURES. CONTRACTOR SHALL VERIFY ELEVATIONS AND MAKE ADJUSTMENTS AS REQUIRED TO MEET FIELD CONDITIONS AND TO PROVIDE POSITIVE SURFACE DRAINAGE. ADJUST ELEVATIONS AS REQUIRED AND AS APPROVED BY LANDSCAPE ARCHITECT.

TREE PROTECTION AND EROSION CONTROL NOTES

- TREE PROTECTION FENCING SHALL BE INSTALLED WHERE INDICATED ON THIS PLAN.
- PROTECTIVE FENCING IS TO REMAIN IN PLACE FOR THE DURATION OF CONSTRUCTION.
- NO STAGING OF MATERIALS OR DUMPING OF ANY DEBRIS IS PERMITTED WITHIN THE FENCED AREA.
- NO EXCAVATION, GRADING, CONSTRUCTION OR LANDSCAPING ACTIVITY SHALL TAKE PLACE WITHIN TREE PROTECTION AREAS WITHOUT PRIOR APPROVAL FROM THE LANDSCAPE ARCHITECT.
- NO ROOT OVER 2\"/>

IRRIGATION NOTES

- CONTRACTOR IS RESPONSIBLE TO LOCATE AND MARK EXISTING IRRIGATION IN FIELD. CITY WILL ASSIST IN LOCATION OF EXISTING IRRIGATION.
- CONTRACTOR TO EVALUATE OPERATION OF EXISTING IRRIGATION PRIOR TO CONSTRUCTION. CONTRACTOR TO NOTE AND INFORM CITY OF ANY OBSERVED OPERATIONAL ISSUES.
- CONTRACTOR IS RESPONSIBLE FOR PROTECTION AND REPAIR OF EXISTING IRRIGATION TO MATCH PRE-CONSTRUCTION CONDITIONS.

LEGEND

x 432.42	EXISTING SPOT ELEVATION		WETLAND
— 431	EXISTING CONTOUR LINE AND ELEVATION		TREE PROTECTION FENCING
MATCH (tc 231.43)	PROPOSED SPOT ELEVATION TO MATCH EXISTING ADJACENT SPOT ELEVATION (tc- TOP OF CONCRETE)		EXISTING CONIFER TO REMAIN
	EX. DECIDUOUS TREE TO REMAIN		NEW CONCRETE PAVING (NOT VEHICLE LOAD)
	POLE LIGHT		NEW CONCRETE PAVING (VEHICLE LOAD)

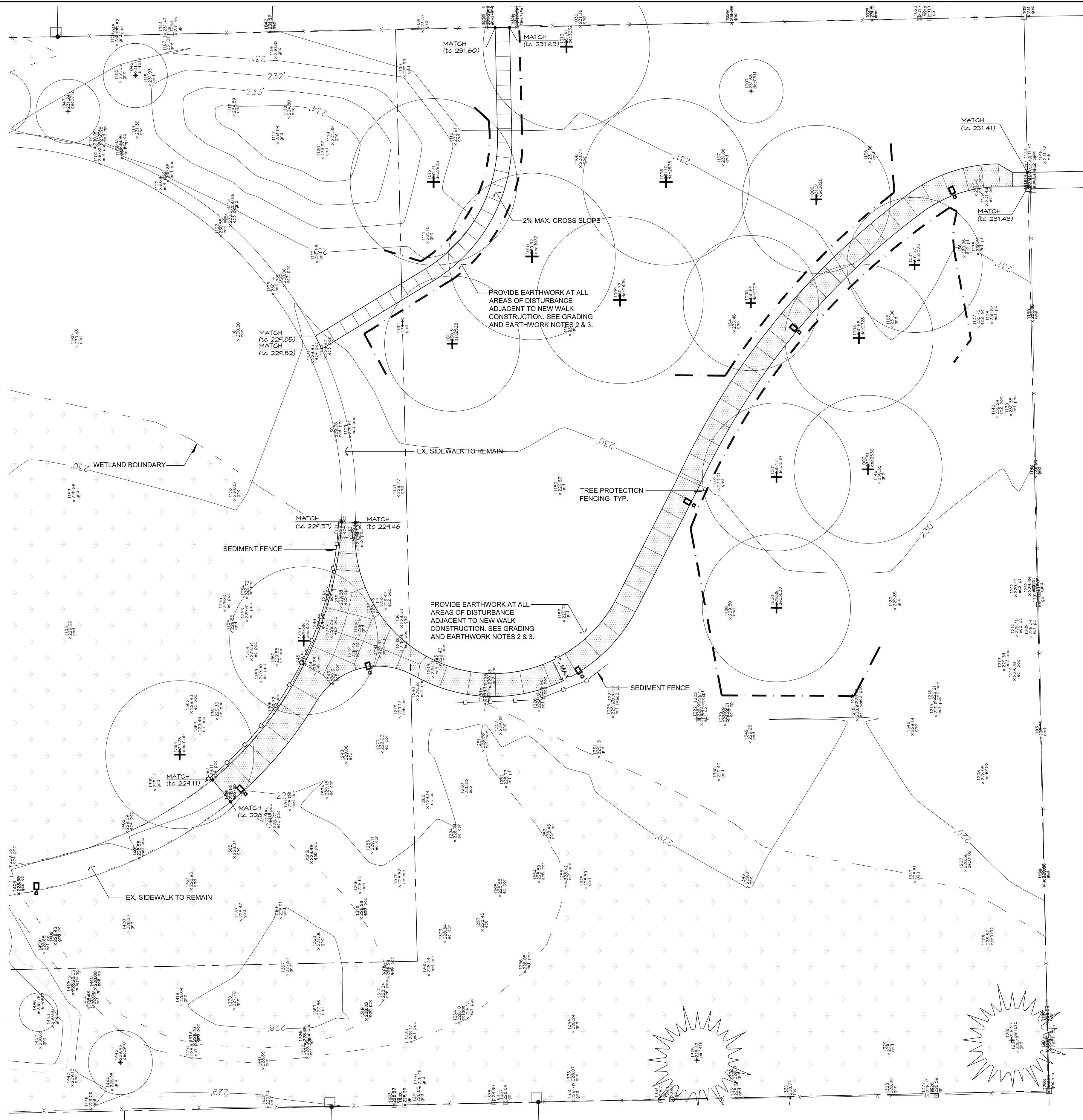

GRADING PLAN AND DETAILS

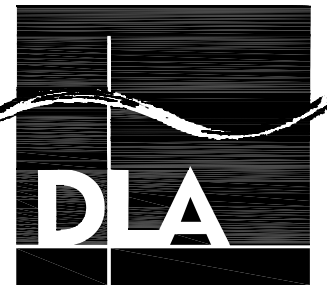
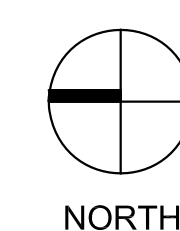
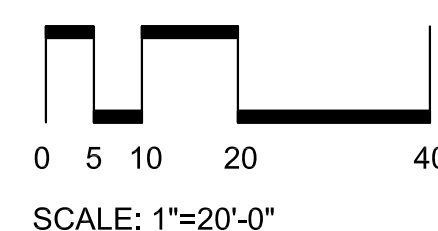

**DOUGHERTY
LANDSCAPE
ARCHITECTS**

474 Willamette Street
Suite 305
Eugene, Oregon 97401

P 541.683.5803
F 541.683.8183

www.DLAdesign.com

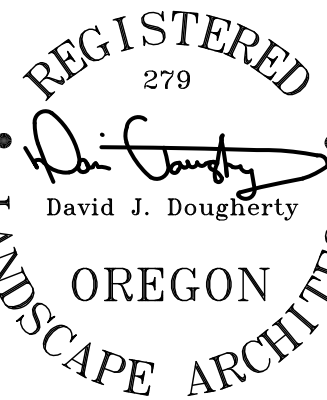

CLIENT:
CITY OF ALBANY
DEPT. OF PARKS AND RECREATION

CONTACT:
ED HODNEY
DIRECTOR OF PARKS AND RECREATION
541-917-7769 PHONE
541-917-7776 FAX

PROJECT:
SUNRISE PARK PHASE II
2275 THURSTON STREET
ALBANY, OR 97322

DATE: 05-28-19
REVISIONS:

DWG NO.
L-3

SYMBOLS AND ABBREVIATIONS LEGEND

POWER

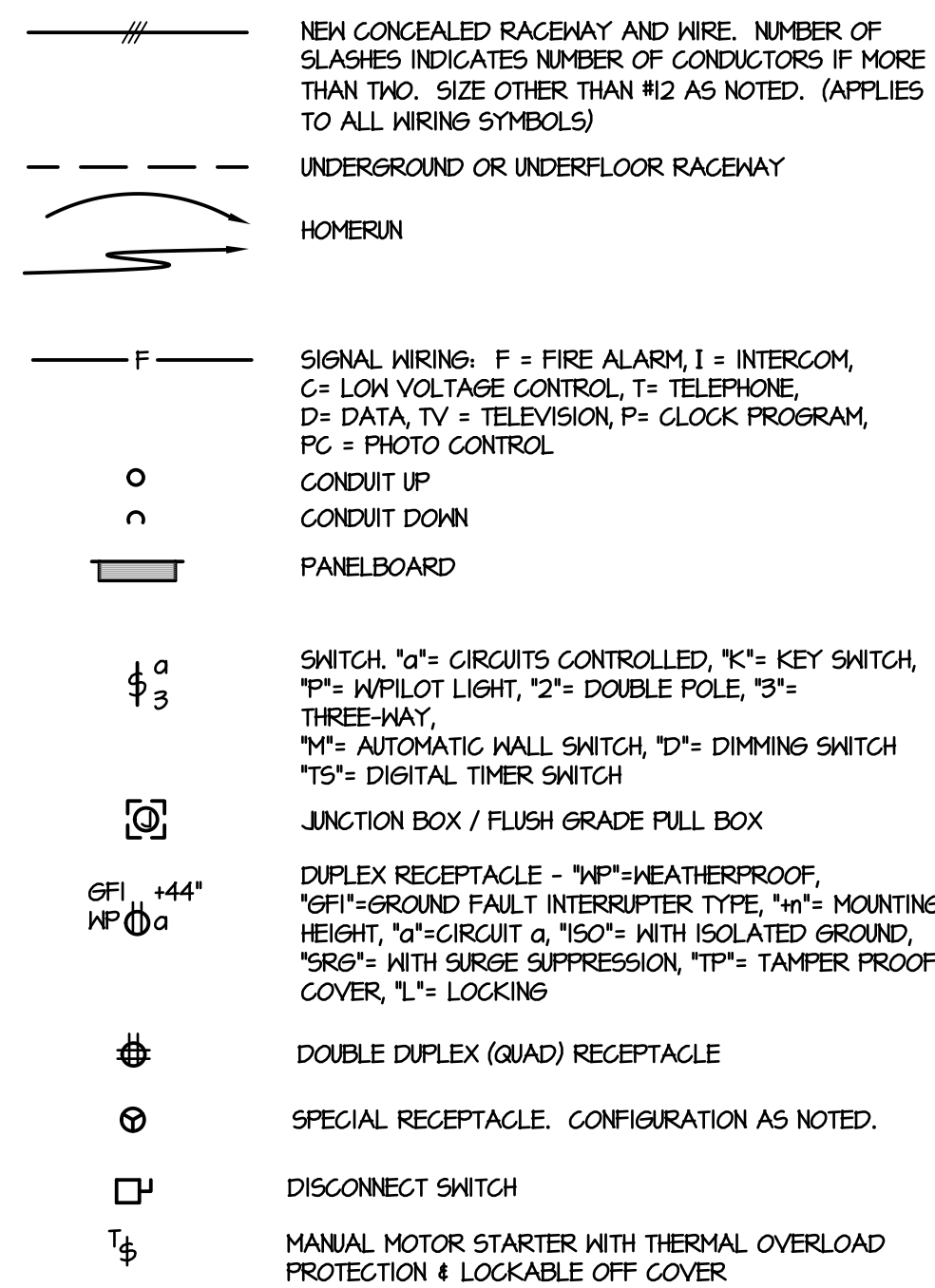

LIGHTING

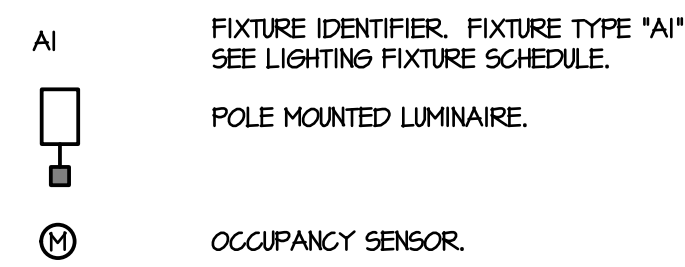

ABBREVIATIONS

AFF BLDG	ABOVE FINISHED FLOOR	IDF	INTERMEDIATE DIST. FRAME
C	CONDUIT	L.V.	LOW VOLTAGE
cd	CANDELA	MDF	MAIN DISTRIBUTION FRAME
CKT	CIRCUIT	MECH	MECHANICAL
DM	0-10V DIMMING	N	NEW
DSP	DIGITAL SIGNAL PROCESSOR	PNL	PANEL
(E)	EXISTING	PRS	PROGRAM RAPID START
ELEC	ELECTRICAL	SHED	SHED
EMERG	EMERGENCY	TTB	TELEPHONE TERMINAL BOARD
FAM	FIRE ALARM MASTER	TVSS	TRANSIENT VOLTAGE SURGE SUPPRESSION
GFI	GROUND FAULT INTERRUPTER	TP	TYPICAL
GND	GROUND	WS	WIREGUARD
HVAC	HEATING, VENTILATING, & AIR CONDITIONING	WP	WEATHERPROOF

GENERAL

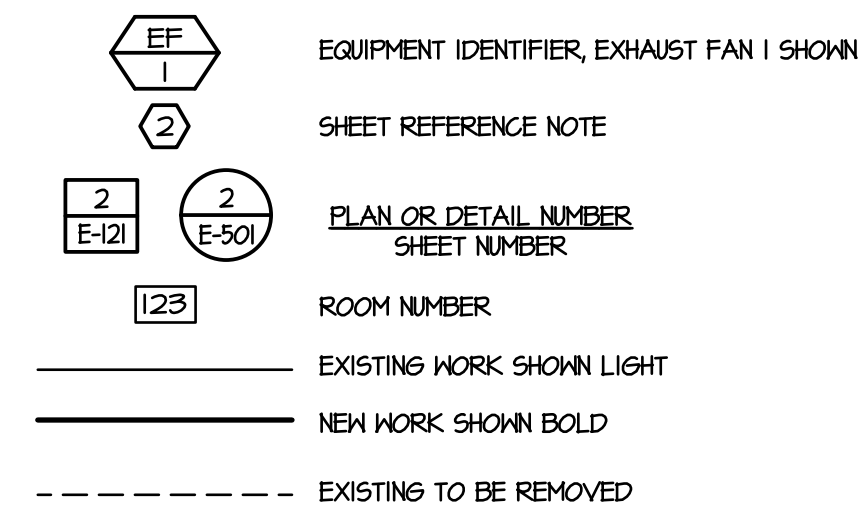

GENERAL NOTES:

- PROVIDE HANDLE-TIES FOR ALL BREAKERS THAT SERVE CIRCUITS WITH COMMON NEUTRALS PER NEC.
- BRANCH CIRCUIT WIRING, OTHER THAN FEEDERS, NOT SHOWN. SEE PANEL AND EQUIPMENT SCHEDULES FOR CIRCUIT ASSIGNMENTS.
- COORDINATE REQUIREMENTS WITH SERVING UTILITIES. PROVIDE ALL REQUIRED SERVICE EQUIPMENT FOR MODIFICATIONS TO ELECTRICAL SERVICE.

MATERIAL NOTES:

RACEWAYS

- ELECTRICAL METALLIC TUBING (EMT): USE CONCEALED ABOVE GRADE OR EXPOSED INDOORS WHERE NOT SUBJECT TO PHYSICAL DAMAGE. FITTINGS: COMPRESSION TYPE OR INDENTER TYPE WATER OR CONCRETE TIGHT WHERE APPROPRIATE.
- SCHEDULE 40 P.V.C.: USE UNDER SLAB OR UNDERGROUND WITH RIGID STEEL ELBOWS AND RISERS.
- FLEXIBLE METAL CONDUIT (FMC) OR LIQUID-TIGHT FLEXIBLE METAL CONDUIT (LFMC): USE FOR CONNECTION TO ADJUSTABLE OR VIBRATING EQUIPMENT. PROVIDE SUITABLE GROUNDING MEANS. CONNECTORS: MALLEABLE IRON, CLAMP TYPE.
- CONNECTORS SHALL HAVE INSULATED THROATS.

WIRE AND CABLE

- COPPER, #12 MINIMUM, COPPER, UNLESS OTHERWISE NOTED OR APPROVED.
- INSULATION: 600 VOLT RATED, MINIMUM. #10 AND SMALLER, TYPE THN STRANDED. #8 AND LARGER, TYPE THN STRANDED.
- CONDUCTORS SHALL BE COLOR CODED TO IDENTIFY PHASE CONNECTIONS.

BOXES

- SIZE FOR NUMBER OF ENTERING CONDUITS AND DEVICES INSTALLED. SHERARDIZED OR GALVANIZED STEEL. BOX COVER AND RING AS REQUIRED TO SUIT WALL MATERIAL AND DEVICES.

- INDOORS: SHEET METAL. OUTDOORS: CAST STEEL WITH CORROSION RESISTANT FINISH.

RECEPTACLES

- DUPLEX RECEPTACLES: FULL GANG SIZE, POLARIZED, DUPLEX, PARALLEL BLADE, U-GROUNDING SLOT, SPECIFICATION GRADE, RATED AT 20 AMPERES, 125 VOLTS (UNLESS OTHERWISE NOTED), DESIGNED FOR SPLIT FEED SERVICE.
- GROUND FAULT RECEPTACLES: SPECIFICATION GRADE DUPLEX RECEPTACLE WITH INTEGRAL GROUND FAULT CIRCUIT INTERRUPTER, TEST AND RESET BUTTONS, MATCHING WALL PLATE.

EQUIPMENT

- PROVIDE BRANCH CIRCUIT PROTECTION AND DISCONNECT SWITCHES REQUIRED BY CODES AND MANUFACTURERS DIRECTIONS. DISCONNECTS FOR 120 VOLT EQUIPMENT; MANUAL MOTOR STARTERS WITH INTEGRAL OVERLOAD PROTECTION. ALL OTHERS: HEAVY DUTY, NON-FUSED SAFETY SWITCHES WITH SUITABLE ENCLOSURE.

PANELBOARDS

- CIRCUIT BREAKERS: THERMAL MAGNETIC, BOLT TO BUS TYPE WITH TRIP INDICATING HANDLE. MULTIPLE POLE BREAKERS SHALL HAVE INTERNAL COMMON TRIP MECHANISM.

- ADDITIONS TO EXISTING PANELS SHALL MATCH OR BE COMPATIBLE WITH EXISTING.

- PROVIDE HANDLE TIES FOR ALL BREAKERS ON CIRCUITS THAT HAVE COMMON NEUTRALS.

GROUNDING AND BONDING

- PROVIDE GROUNDS IN ACCORDANCE WITH NATIONAL ELECTRICAL CODE AND ADDITIONAL REQUIREMENTS AS REQUIRED HEREIN.

GROUNDING CONDUCTORS

- SIZE: GROUNDING ELECTRODE CONDUCTOR: TABLE 250-66. EQUIPMENT GROUNDING CONDUCTOR: TABLE 250-122. POOL BONDING: 680.6.

- MATERIAL: COPPER

- PROTECTION: CONDUCTORS NOT IN RACEWAY OR CONCEALED SHALL BE INSULATED. PROVIDE CONDUIT WHERE SHOWN OR REQUIRED FOR PHYSICAL PROTECTION.

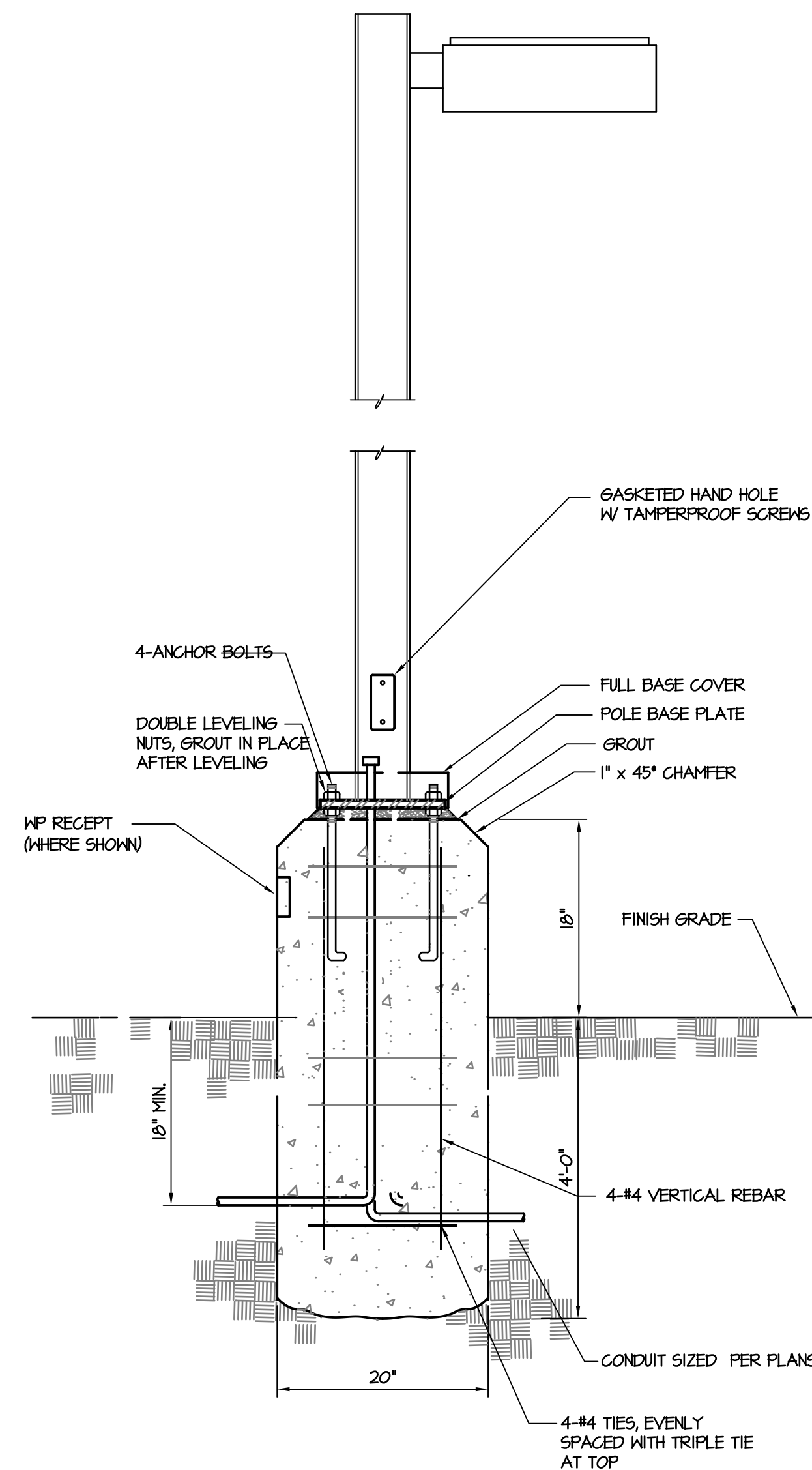

2 POLE BASE DETAIL
NO SCALE

SYMBOLS AND SCHEDULES



CONSULTANT:

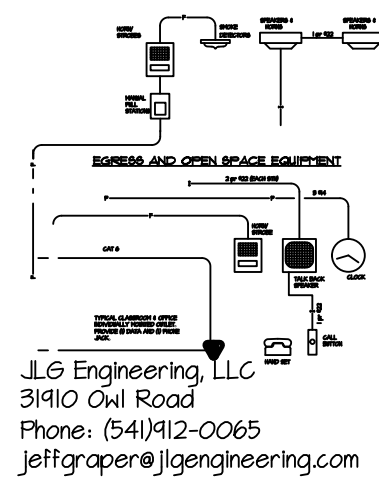

CLIENT:
CITY OF ALBANY
DEPT. OF PARKS & RECREATION

CONTACT:
ED HODNEY
DIRECTOR OF PARKS & RECREATION
541-917-7769 PHONE
541-917-7776 FAX

PROJECT:
SUNRISE PARK PHASE II
2275 THURSTON STREET
ALBANY, OR 97322

DATE: 05-28-19
REVISIONS:

DWG NO.

E-1

REFERENCE NOTES:

- ① INTERCEPT (E) CONDUIT AND EXTEND TO NEW FIXTURES. CONNECT FIXTURES TO (E) CIRCUITS AND BALANCE LOAD TO A MAX. OF 8 AMPS ON THE SHORTER CIRCUIT AND 4.8 AMPS ON THE LONGER.
- ② (E) FLUSH GRADE PULLBOX WITH FEEDER FROM (E) PANEL AND (2) CIRCUITS TO LIGHT FIXTURES.

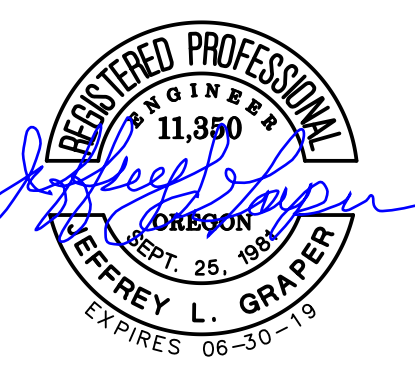
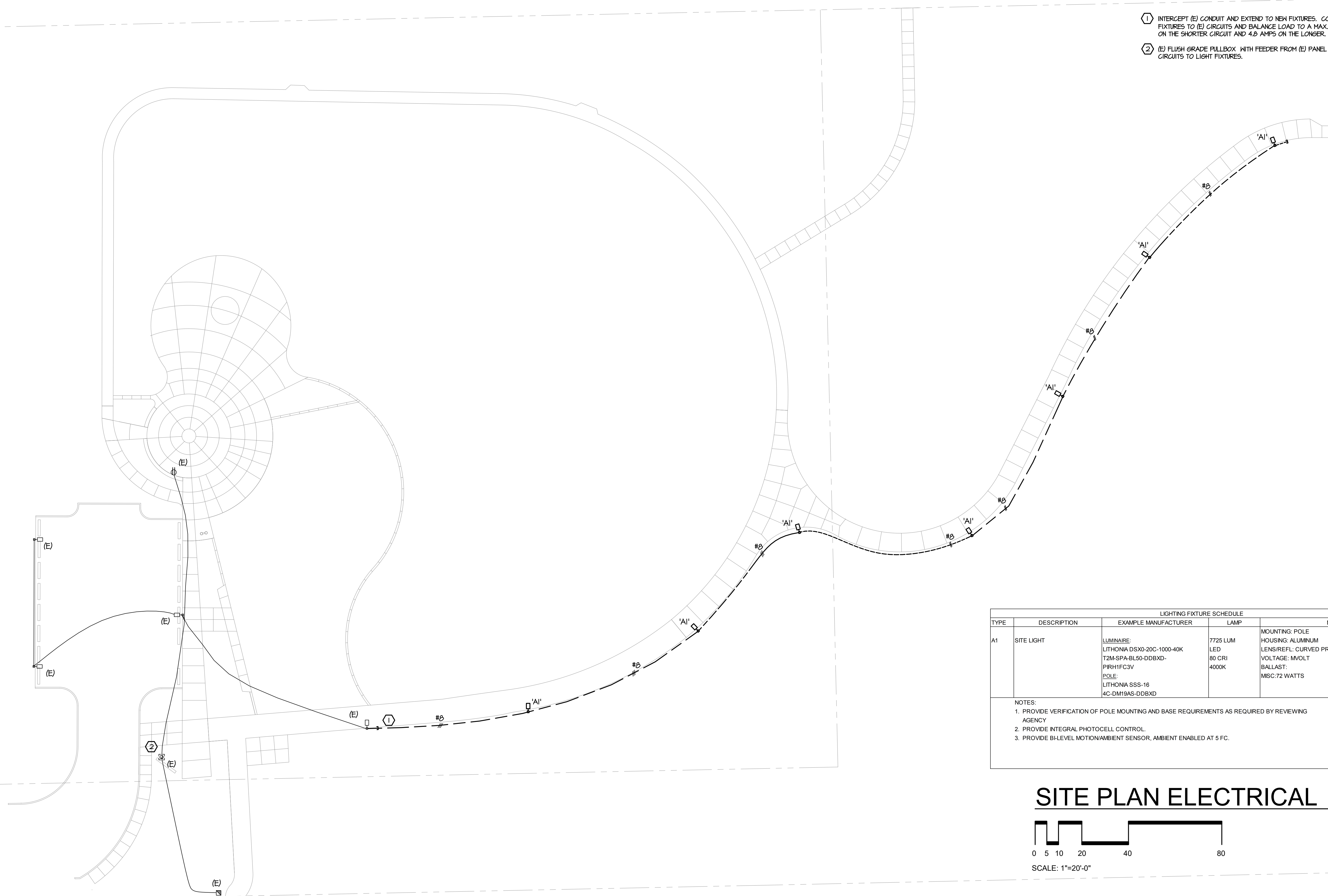

CONSULTANT:

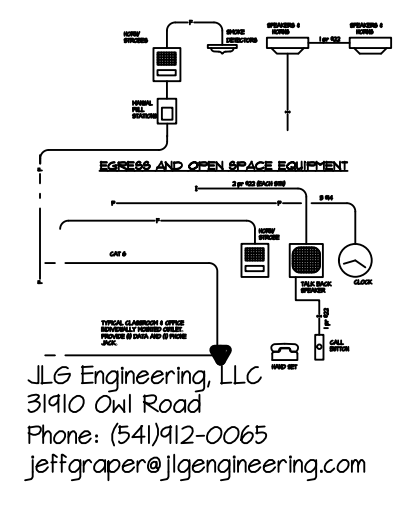

CLIENT:
CITY OF ALBANY
DEPT. OF PARKS & RECREATION
CONTACT:
ED HODNEY
DIRECTOR OF PARKS & RECREATION
541-917-7769 PHONE
541-917-7776 FAX

LIGHTING FIXTURE SCHEDULE				
TYPE	DESCRIPTION	EXAMPLE MANUFACTURER	LAMP	NOTES
A1	SITE LIGHT	LUMINAIRE: LITHONIA DSX0-20C-1000-40K T2M-SPA-BL50-DOBXD- PIRH1FC3V POLE: LITHONIA SSS-16 4C-DM19AS-DOBXD	7725 LUM LED 80 CRI 4000K	MOUNTING: POLE HOUSING: ALUMINUM LENS/REFL: CURVED PRISMATIC VOLTAGE: MVOLT BALLAST: MSC:72 WATTS
NOTES: 1. PROVIDE VERIFICATION OF POLE MOUNTING AND BASE REQUIREMENTS AS REQUIRED BY REVIEWING AGENCY 2. PROVIDE INTEGRAL PHOTOCELL CONTROL. 3. PROVIDE BI-LEVEL MOTION/AMBIENT SENSOR, AMBIENT ENABLED AT 5 FC.				

SITE PLAN ELECTRICAL

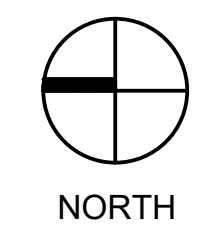
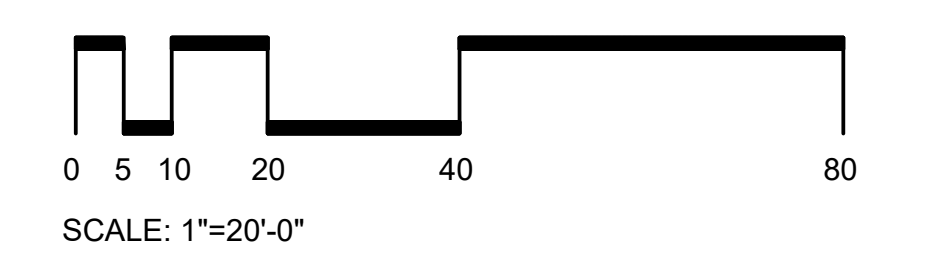

PROJECT:
SUNRISE PARK PHASE II
2275 THURSTON STREET
ALBANY, OR 97322

DATE: 05-28-19
REVISIONS:

DWG NO.
E-2