





# CITY OF ALBANY

## SS-19-03, 2019 SEWER POINT REPAIRS

SHEET INDEX	
Sheet Number	Sheet Title
1	COVER
2	SEGMENT 5558
3	SEGMENT 5573
4	SEGMENT 5575
5	SEGMENT 5587
6	SEGMENT 5658
7	SEGMENT 5726
8	SEGMENT 5728
9	SEGMENT 5942
10	SEGMENT 6289
11	SEGMENT 6386
12	SEGMENT 6391
13	SEGMENT 6829
14	SEGMENT 7344

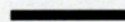
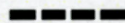
LEGEND	
	EXISTING SEWER MANHOLE, DEAD END OR MAINLINE CLEANOUT CONNECTED TO SEGMENT BEING REPAIRED.
	EXISTING SEWER MANHOLE, DEAD END OR MAINLINE CLEANOUT.
	NEW PRIVATE SS CLEANOUT.
	MAINLINE TO BE REPAIRED.
	PRIVATE LATERAL TO BE REPLACED.
	EXISTING SEWER LINE.

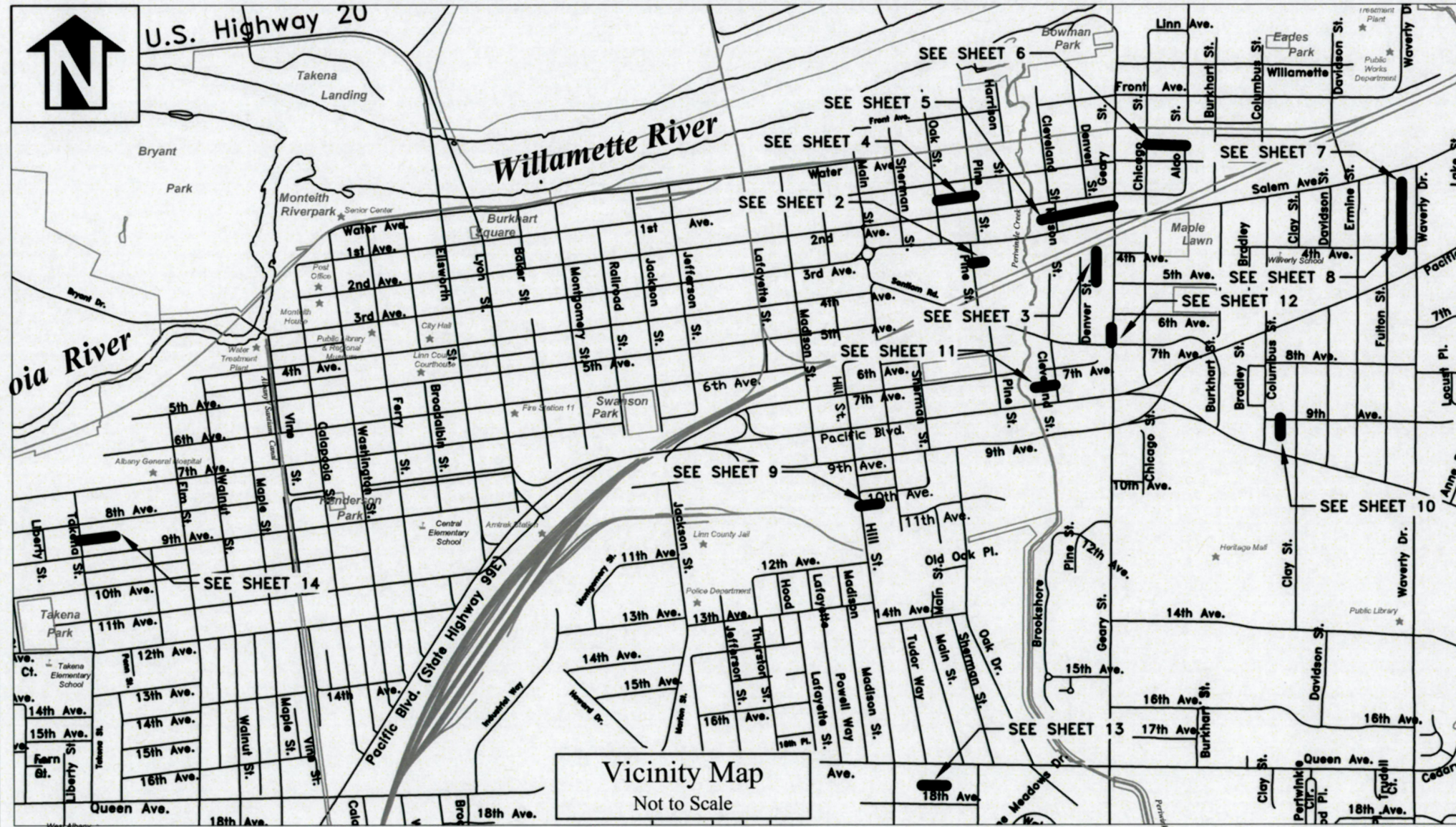

### GENERAL NOTES

1. ALL CONSTRUCTION SHALL CONFORM TO THE CITY OF ALBANY STANDARD CONSTRUCTION SPECIFICATIONS AND ASSOCIATED STANDARD DRAWINGS. THE CURRENT VERSION OF THE CITY OF ALBANY STANDARD CONSTRUCTION SPECIFICATIONS CAN BE FOUND ON THE CITY'S WEBSITE AT [WWW.CITYOFALBANY.NET](http://WWW.CITYOFALBANY.NET).
2. UTILITIES SHOWN ARE FOR REFERENCE ONLY. FOR A FIELD LOCATE, CALL THE UTILITIES NOTIFICATIONS CENTER AT 1-800-332-2344.
3. OPERATING ACCESS FOR CITY MAINTENANCE PERSONNEL TO EXISTING AND NEW WATER VALVES AND MANHOLES SHALL BE CONTINUOUSLY MAINTAINED BY THE CONTRACTOR DURING ALL CONSTRUCTION ACTIVITIES.
4. CONTRACTOR SHALL VERIFY ALL EXISTING PIPE ELEVATIONS, PIPE DIAMETERS, AND PIPE MATERIALS AT CONNECTION AND ABANDONMENT LOCATIONS PRIOR TO CONSTRUCTION. ANY DISCREPANCIES SHALL BE REPORTED TO ENGINEER PRIOR TO BEGINNING WORK.
5. ATTENTION: OREGON LAW REQUIRES YOU TO FOLLOW RULES ADOPTED BY THE OREGON UTILITY NOTIFICATION CENTER. THOSE RULES ARE SET FORTH IN OAR 952-001-0010 THROUGH OAR 952-001-0090. YOU MAY OBTAIN COPIES OF THE RULES BY CALLING THE CENTER. (NOTE: THE TELEPHONE NUMBER FOR THE OREGON UTILITY NOTIFICATION CENTER IS (503) 232-1987).
6. CONTRACTOR SHALL BE RESPONSIBLE FOR PROPER INSTALLATION AND MAINTENANCE OF ALL EROSION PREVENTION SEDIMENT CONTROL (EPSC) MEASURES IN ACCORDANCE WITH LOCAL, STATE, AND FEDERAL REGULATIONS UNTIL ALL CONSTRUCTION IS COMPLETED AND APPROVED BY THE CITY OF ALBANY, AND VEGETATION/LANDSCAPING IS ESTABLISHED. FOR GUIDANCE, REFER TO THE CITY OF ALBANY EPSC MANUAL WHICH CAN BE FOUND AT [www.cityofalbany.net](http://www.cityofalbany.net).

DESIGNED: A. MONACO	REVISIONS
DRAWN: A. MONACO	NO: ---
CHECKED: L. SCHUMACHER	BY: ---
DATE: 7/19/2019	DATE: ---

**PUBLIC WORKS DEPARTMENT**  
**ENGINEERING SERVICES**



**SS-19-03, 2019 SEWER POINT REPAIRS**

REGISTERED PROFESSIONAL  
ENGINEER  
85930PE

*Lori L. Schumacher*

OREGON  
MARCH 13, 2018  
**LORI L. SCHUMACHER**

EXPIRES: 06/30/2020

SHEET NO. 1 OF 14  
PROJECT NO: SS-19-03  
FILE: FILENAME.DWG



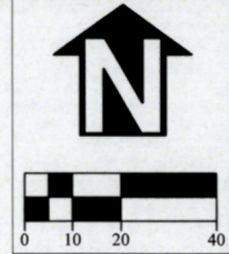

DESIGNED: A. MONACO	REVISIONS
DRAWN: A. MONACO	NO: --
CHECKED: L. SCHUMACHER	BY: --
DATE: 7/19/2019	NO: --
DATE: --	BY: --
DATE: --	NO: --
DATE: --	BY: --

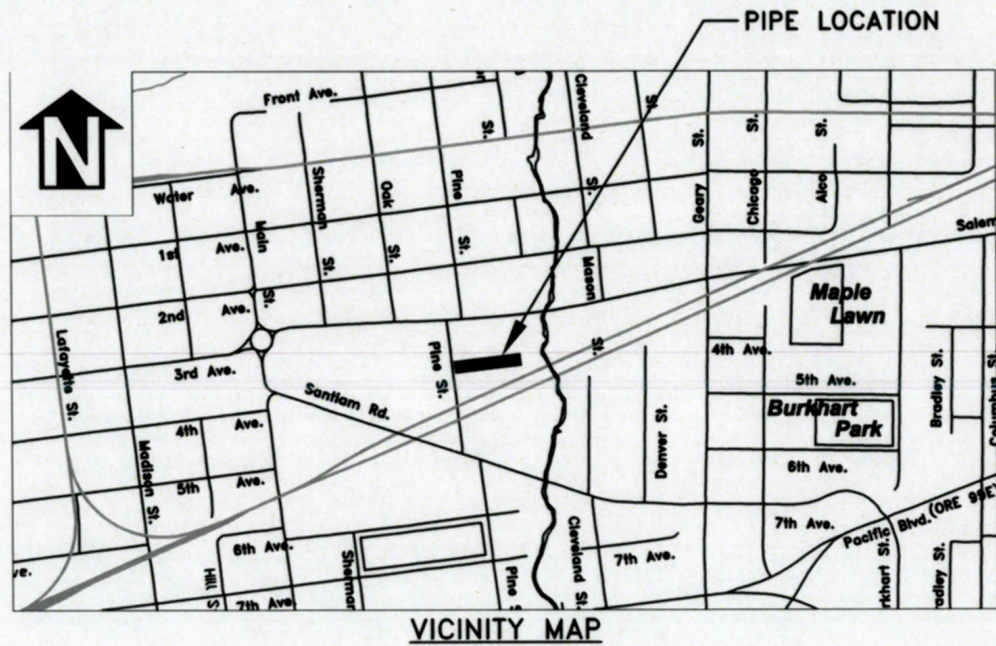
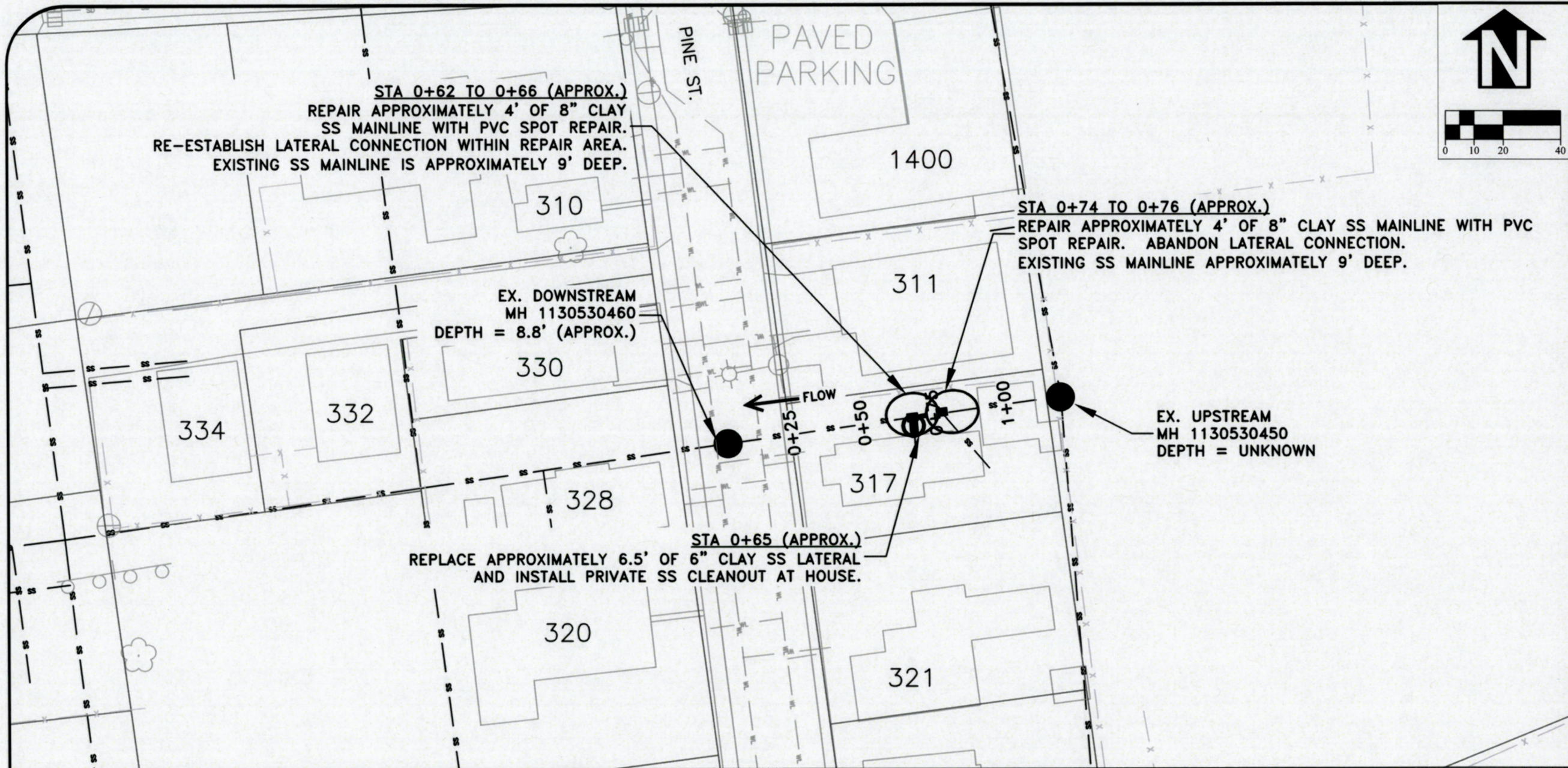

**PUBLIC WORKS DEPARTMENT**  
**ENGINEERING SERVICES**

**SS-19-03, 2019 SEWER POINT REPAIRS**  
**SEGMENT 5558**

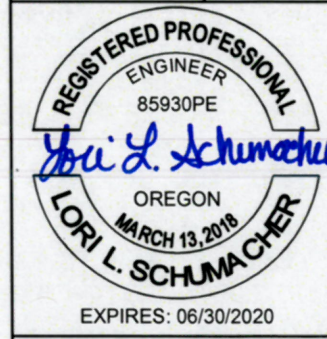

SHEET NO. 2 OF 14  
 PROJECT NO: SS-19-03  
 FILE: BASE.DWG



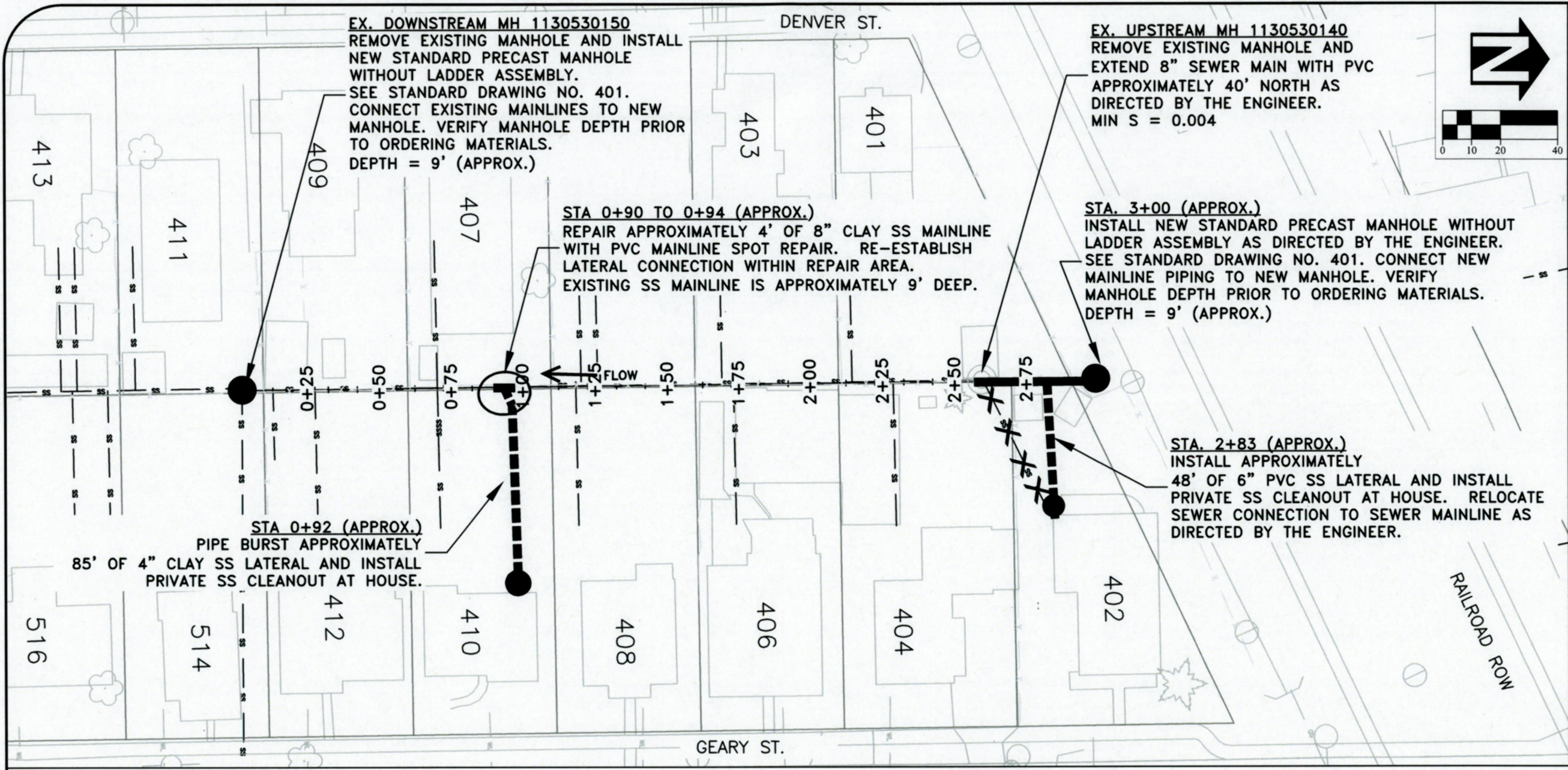

EX. DOWNSTREAM MH 1130530150  
 REMOVE EXISTING MANHOLE AND INSTALL  
 NEW STANDARD PRECAST MANHOLE  
 WITHOUT LADDER ASSEMBLY.  
 SEE STANDARD DRAWING NO. 401.  
 CONNECT EXISTING MAINLINES TO NEW  
 MANHOLE. VERIFY MANHOLE DEPTH PRIOR  
 TO ORDERING MATERIALS.  
 DEPTH = 9' (APPROX.)

EX. UPSTREAM MH 1130530140  
 REMOVE EXISTING MANHOLE AND  
 EXTEND 8" SEWER MAIN WITH PVC  
 APPROXIMATELY 40' NORTH AS  
 DIRECTED BY THE ENGINEER.  
 MIN S = 0.004

STA 0+90 TO 0+94 (APPROX.)  
 REPAIR APPROXIMATELY 4' OF 8" CLAY SS MAINLINE  
 WITH PVC MAINLINE SPOT REPAIR. RE-ESTABLISH  
 LATERAL CONNECTION WITHIN REPAIR AREA.  
 EXISTING SS MAINLINE IS APPROXIMATELY 9' DEEP.

STA. 3+00 (APPROX.)  
 INSTALL NEW STANDARD PRECAST MANHOLE WITHOUT  
 LADDER ASSEMBLY AS DIRECTED BY THE ENGINEER.  
 SEE STANDARD DRAWING NO. 401. CONNECT NEW  
 MAINLINE PIPING TO NEW MANHOLE. VERIFY  
 MANHOLE DEPTH PRIOR TO ORDERING MATERIALS.  
 DEPTH = 9' (APPROX.)

STA 0+92 (APPROX.)  
 PIPE BURST APPROXIMATELY  
 85' OF 4" CLAY SS LATERAL AND INSTALL  
 PRIVATE SS CLEANOUT AT HOUSE.

STA. 2+83 (APPROX.)  
 INSTALL APPROXIMATELY  
 48' OF 6" PVC SS LATERAL AND INSTALL  
 PRIVATE SS CLEANOUT AT HOUSE. RELOCATE  
 SEWER CONNECTION TO SEWER MAINLINE AS  
 DIRECTED BY THE ENGINEER.

DESIGNED: A. MONACO  
 DRAWN: A. MONACO  
 CHECKED: L. SCHUMACHER  
 DATE: 7/19/2019

REVISIONS	
NO.	BY:

**PUBLIC WORKS DEPARTMENT**  
**ENGINEERING SERVICES**

**SS-19-03, 2019 SEWER POINT REPAIRS**  
 SEGMENT 5573

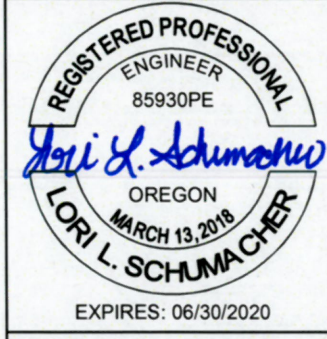
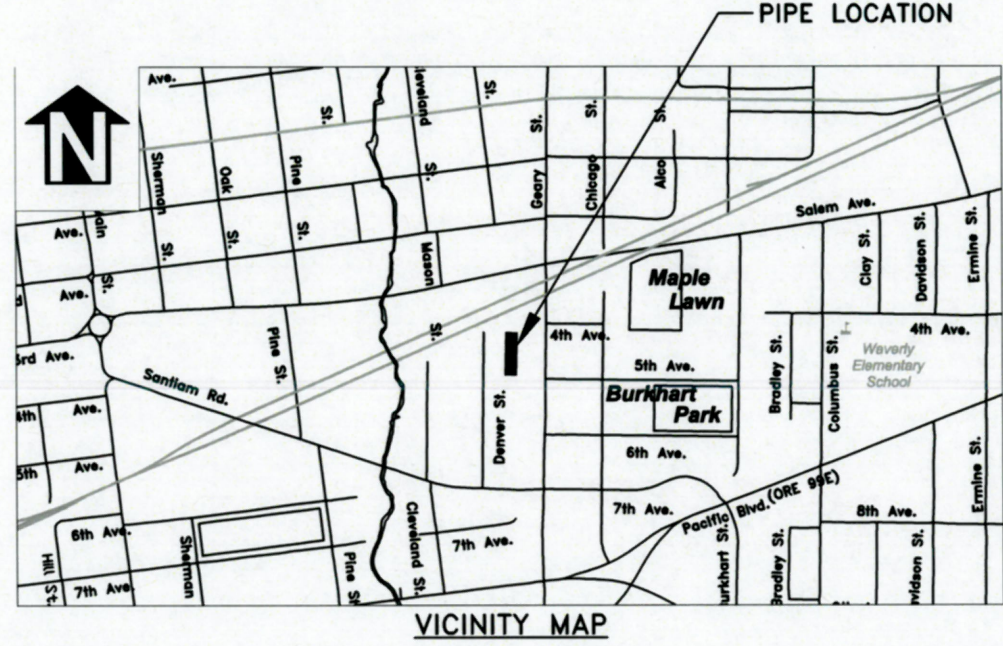

SHEET NO. 3 OF 14  
 PROJECT NO: SS-19-03  
 FILE: BASE.DWG



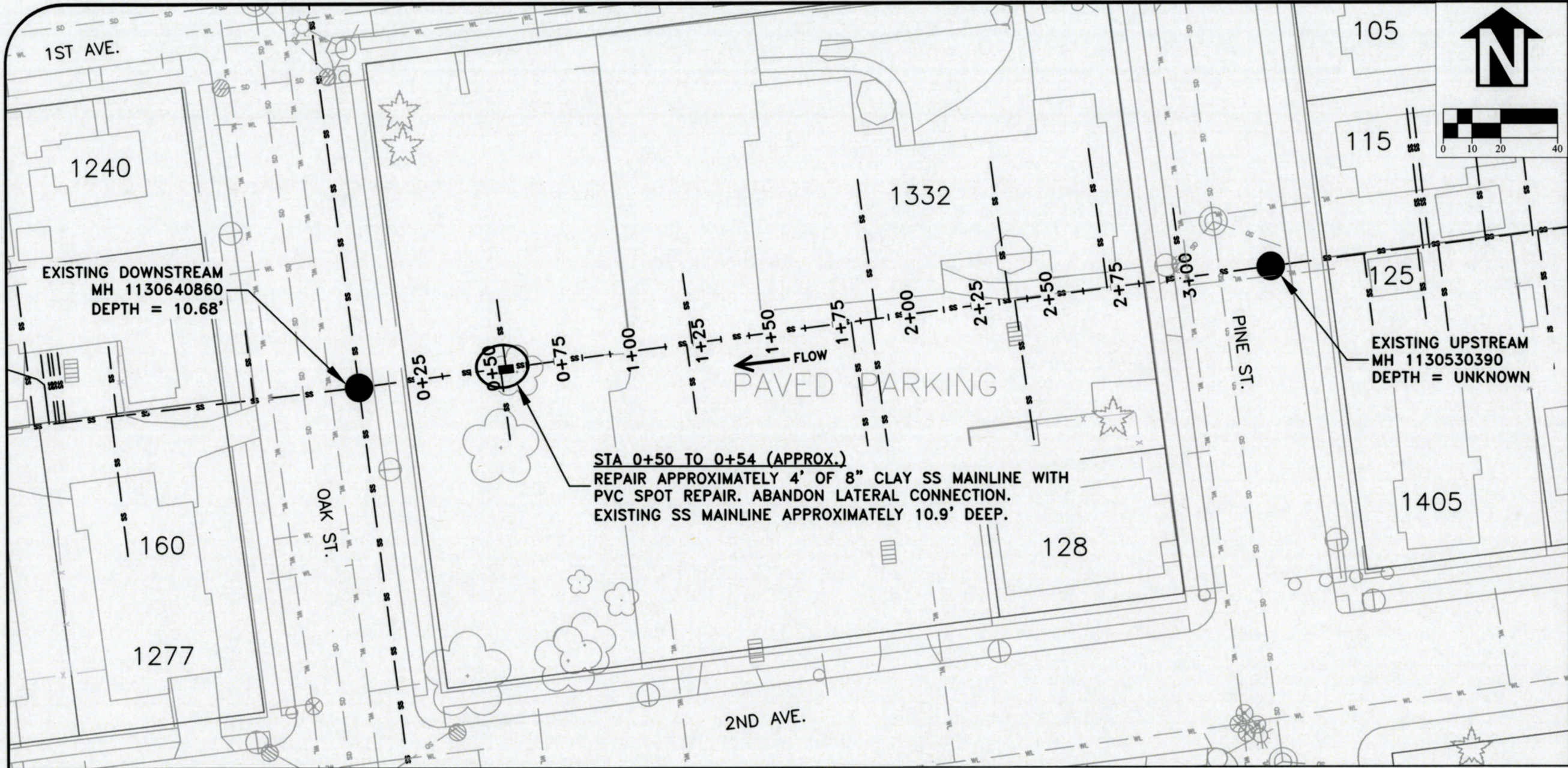

STA 0+50 TO 0+54 (APPROX.)  
 REPAIR APPROXIMATELY 4' OF 8" CLAY SS MAINLINE WITH  
 PVC SPOT REPAIR. ABANDON LATERAL CONNECTION.  
 EXISTING SS MAINLINE APPROXIMATELY 10.9' DEEP.

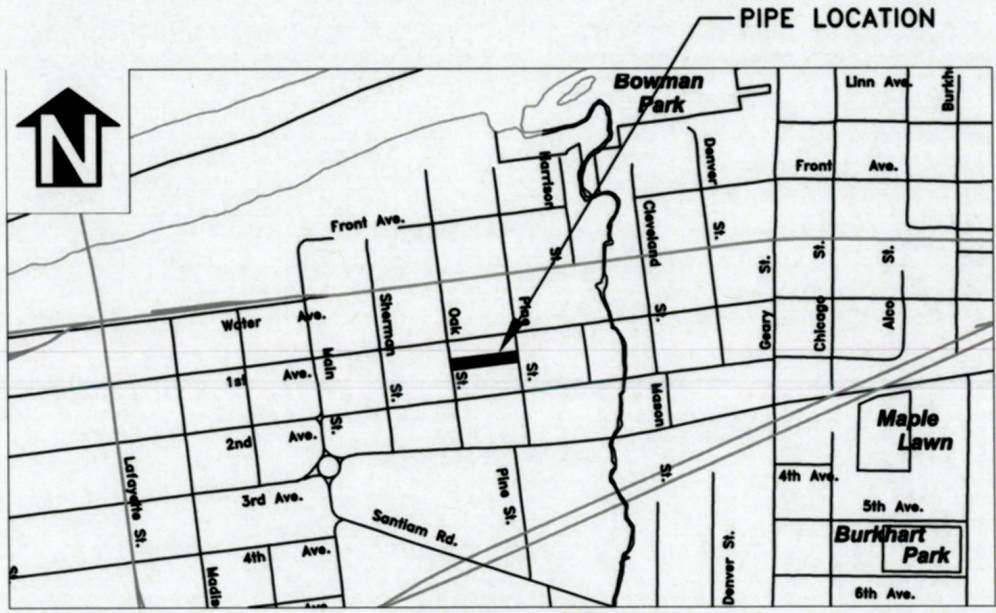

VICINITY MAP

DESIGNED: A. MONACO	REVISIONS
DRAWN: A. MONACO	NO: ---
CHECKED: L. SCHUMACHER	BY: ---
DATE: 7/19/2019	DATE: ---

**PUBLIC WORKS DEPARTMENT**  
**ENGINEERING SERVICES**

**SS-19-03, 2019 SEWER POINT REPAIRS**  
 SEGMENT 5575

REGISTERED PROFESSIONAL ENGINEER  
 85930PE  
*Lori L. Schumacher*  
 OREGON  
 MARCH 13, 2018  
 LORI L. SCHUMACHER  
 EXPIRES: 06/30/2020



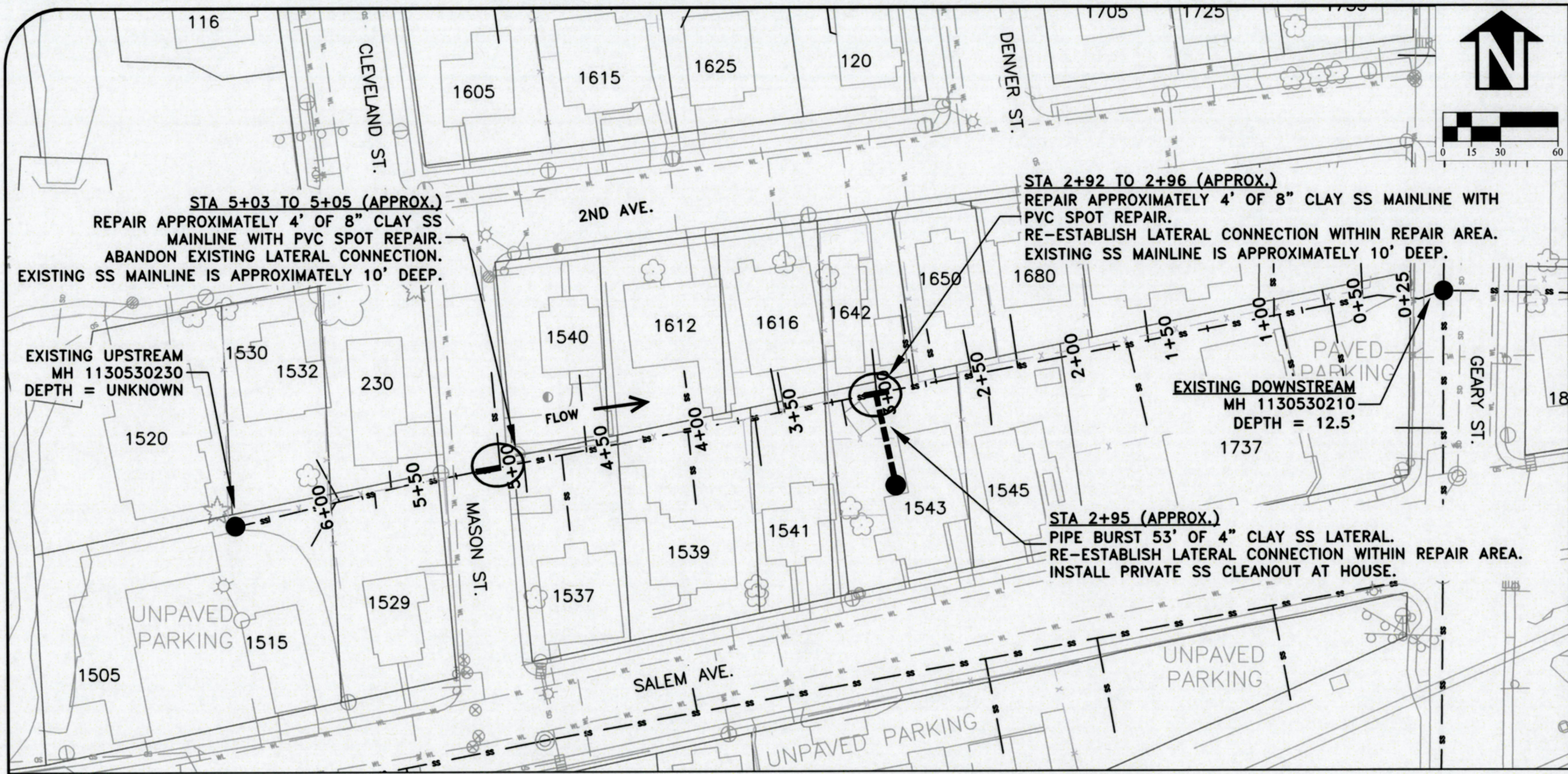

DESIGNED: A. MONACO  
 DRAWN: A. MONACO  
 CHECKED: L. SCHUMACHER  
 DATE: 7/19/2019

REVISIONS	NO.	BY	DATE

**PUBLIC WORKS DEPARTMENT**  
**ENGINEERING SERVICES**

**SS-19-03, 2019 SEWER POINT REPAIRS**  
**SEGMENT 5587**

REGISTERED PROFESSIONAL ENGINEER  
 85930PE  
*Lori L. Schumacher*  
 OREGON  
 MARCH 13, 2018  
 LORI L. SCHUMACHER  
 EXPIRES: 06/30/2020

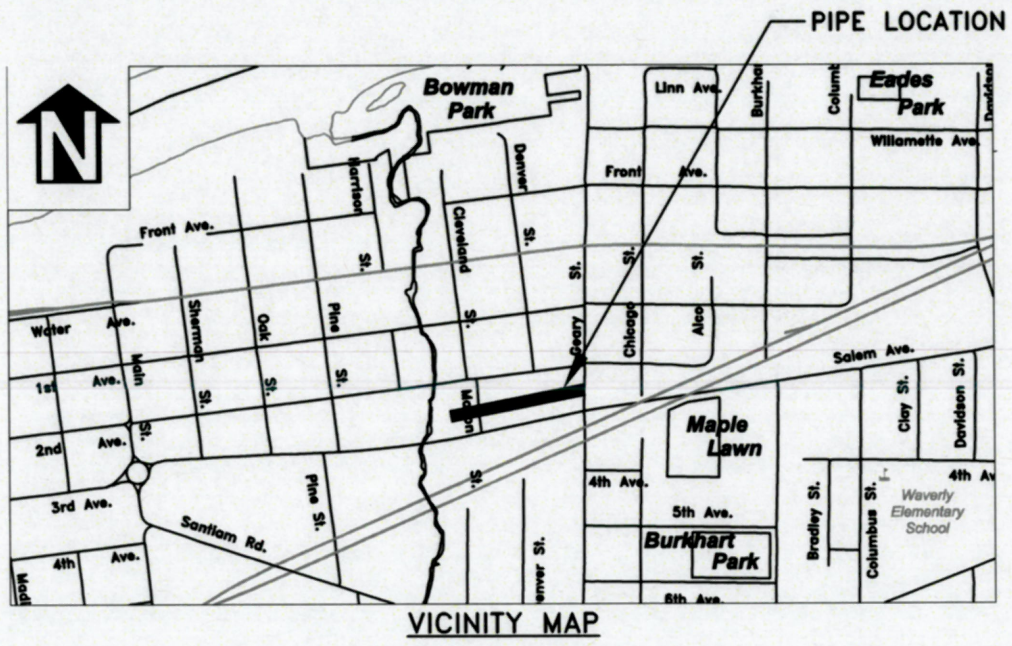

**STA 5+03 TO 5+05 (APPROX.)**  
 REPAIR APPROXIMATELY 4' OF 8" CLAY SS MAINLINE WITH PVC SPOT REPAIR.  
 ABANDON EXISTING LATERAL CONNECTION.  
 EXISTING SS MAINLINE IS APPROXIMATELY 10' DEEP.

EXISTING UPSTREAM  
 MH 1130530230  
 DEPTH = UNKNOWN

**STA 2+92 TO 2+96 (APPROX.)**  
 REPAIR APPROXIMATELY 4' OF 8" CLAY SS MAINLINE WITH PVC SPOT REPAIR.  
 RE-ESTABLISH LATERAL CONNECTION WITHIN REPAIR AREA.  
 EXISTING SS MAINLINE IS APPROXIMATELY 10' DEEP.

EXISTING DOWNSTREAM  
 MH 1130530210  
 DEPTH = 12.5'

**STA 2+95 (APPROX.)**  
 PIPE BURST 53' OF 4" CLAY SS LATERAL.  
 RE-ESTABLISH LATERAL CONNECTION WITHIN REPAIR AREA.  
 INSTALL PRIVATE SS CLEANOUT AT HOUSE.



BURLINGTON NORTHERN RR

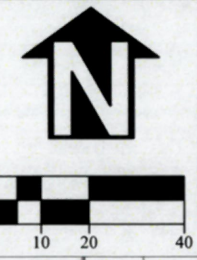

DESIGNED: A. MONACO	REVISIONS
DRAWN: A. MONACO	NO:
CHECKED: L. SCHUMACHER	BY:
DATE: 7/19/2019	DATE:

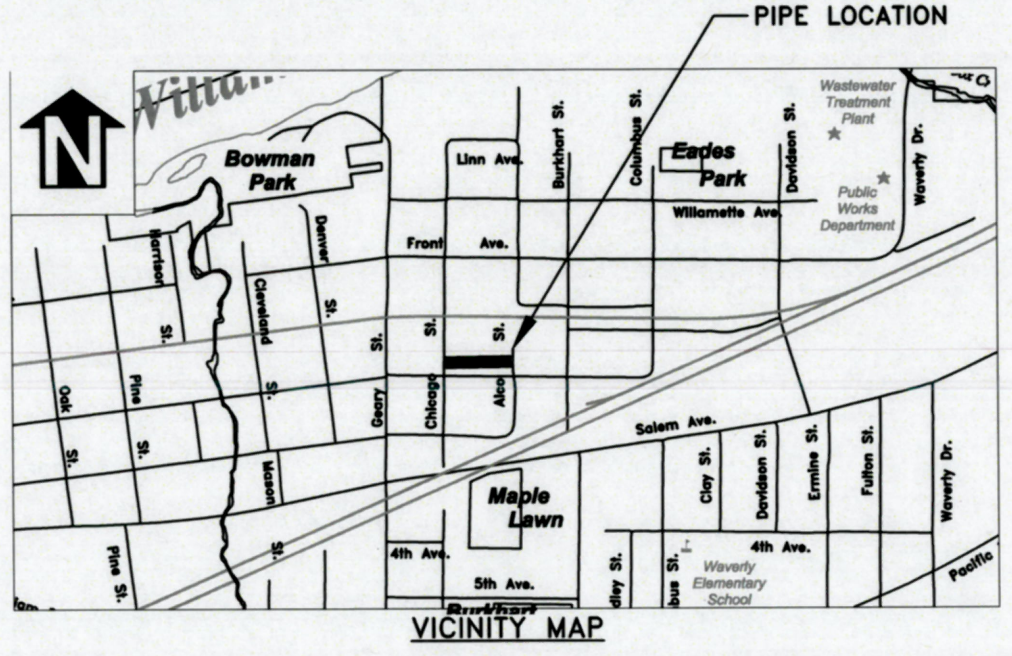
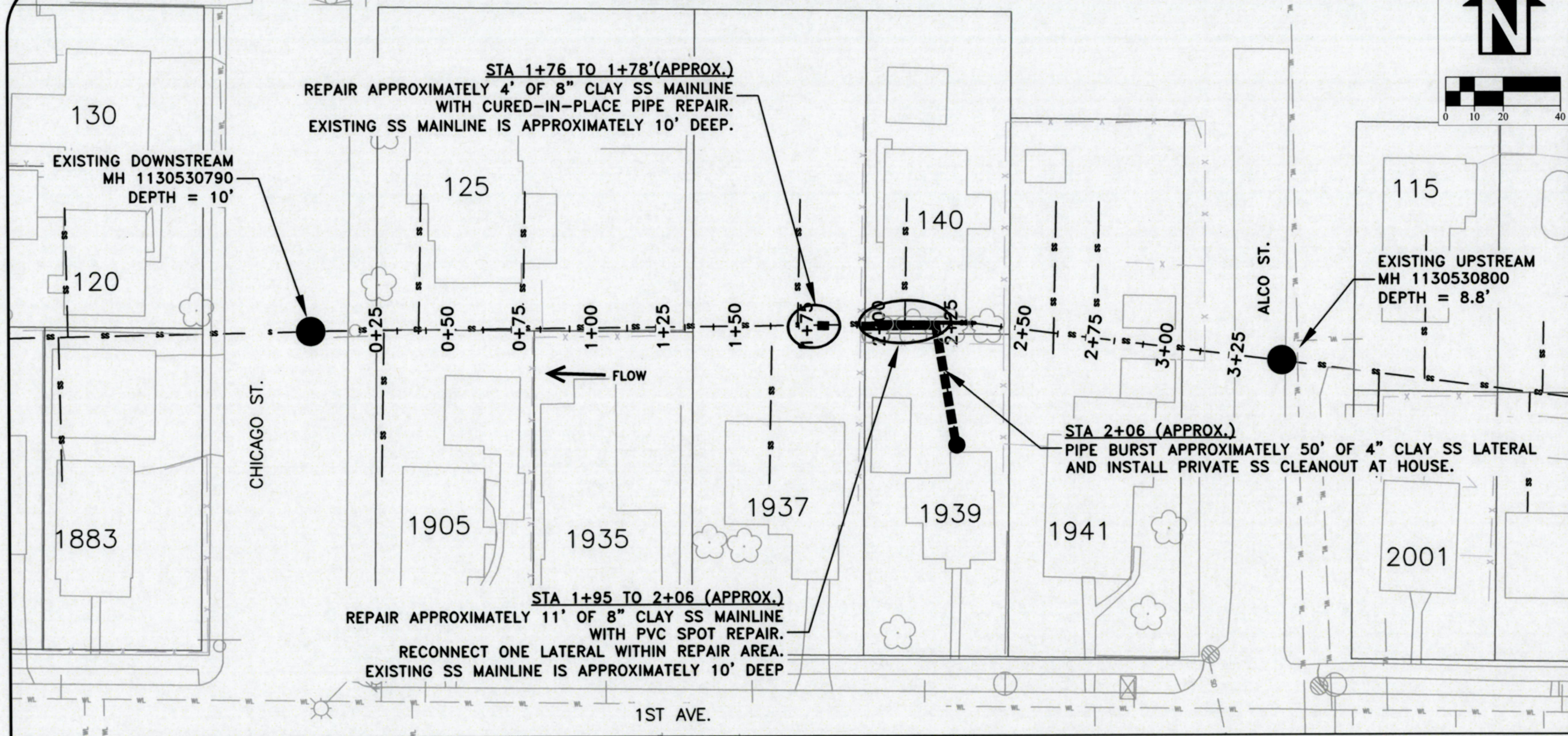

**PUBLIC WORKS DEPARTMENT  
ENGINEERING SERVICES**



**SS-19-03, 2019 SEWER POINT REPAIRS  
SEGMENT 5658**



EXPIRES: 06/30/2020  
SHEET NO. 6 OF 14  
PROJECT NO: SS-19-03  
FILE: BASE.DWG



BURLINGTON NORTHERN RR

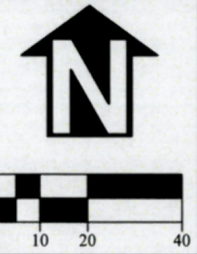

DESIGNED: A. MONACO	REVISIONS
DRAWN: A. MONACO	NO: --
CHECKED: L. SCHUMACHER	BY: --
DATE: 7/19/2019	DATE: --

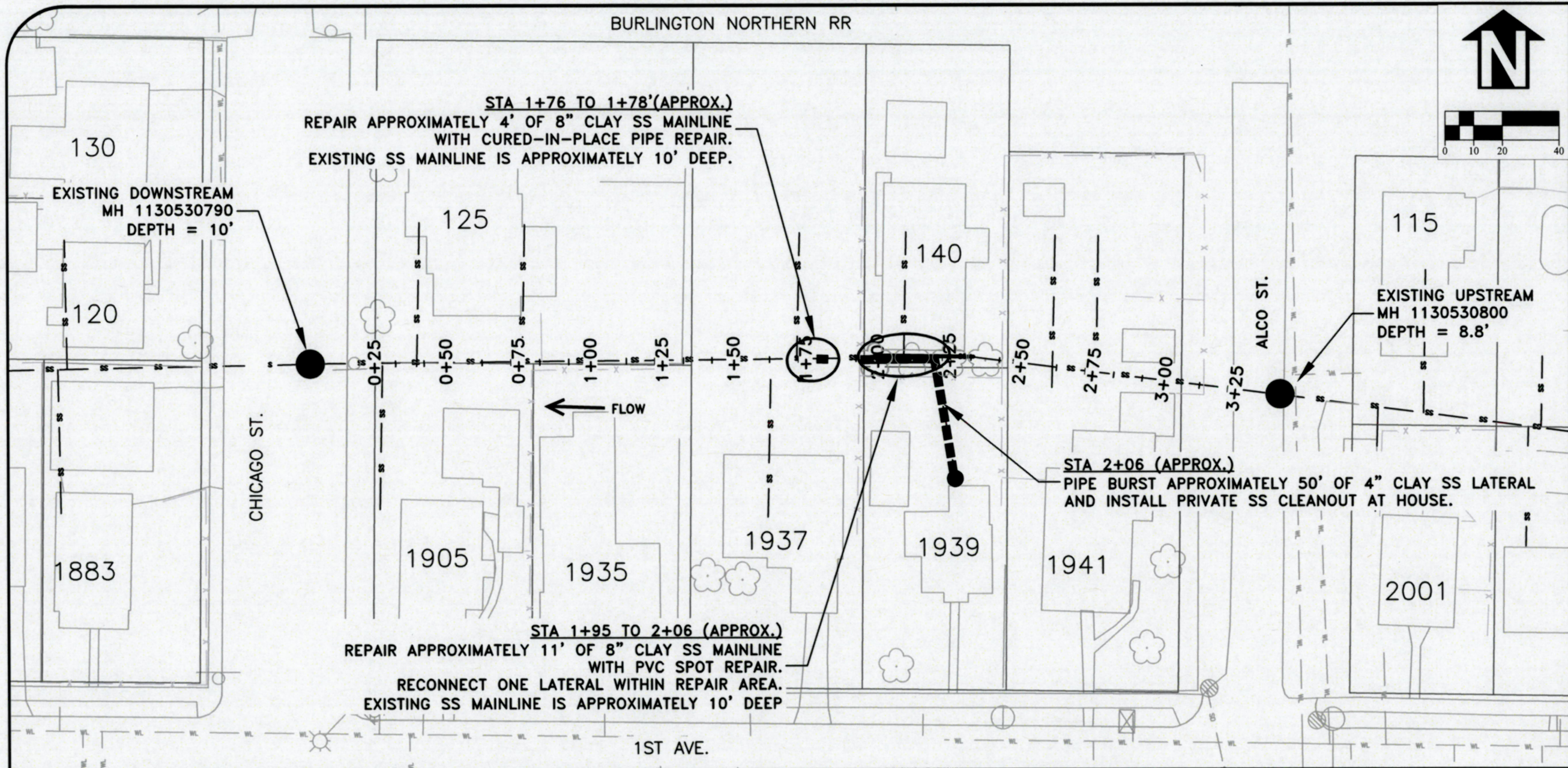

PUBLIC WORKS DEPARTMENT  
ENGINEERING SERVICES



SS-19-03, 2019 SEWER POINT REPAIRS  
SEGMENT 5658

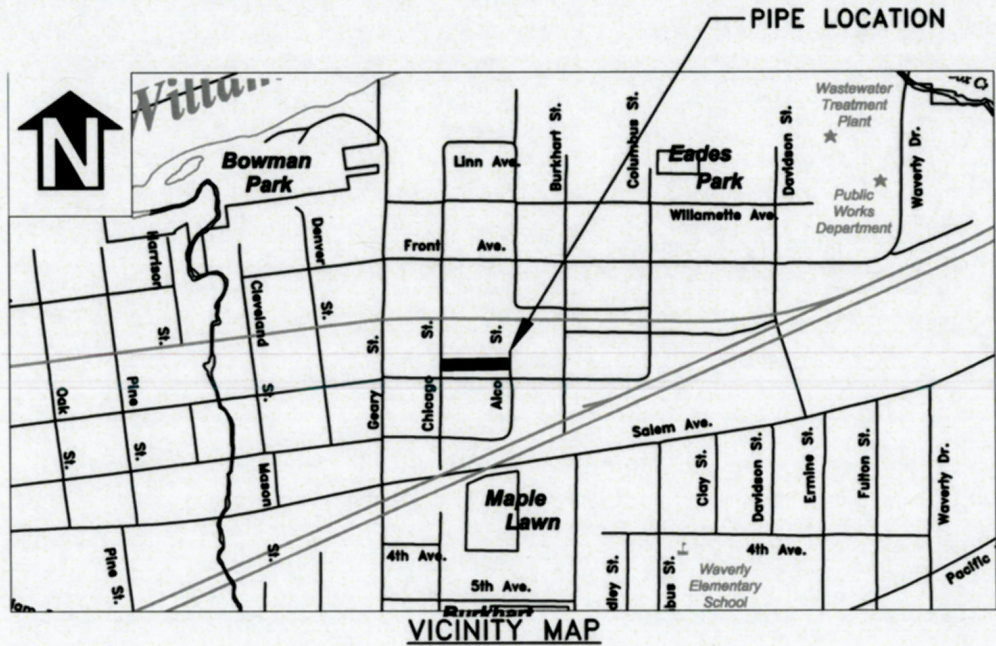



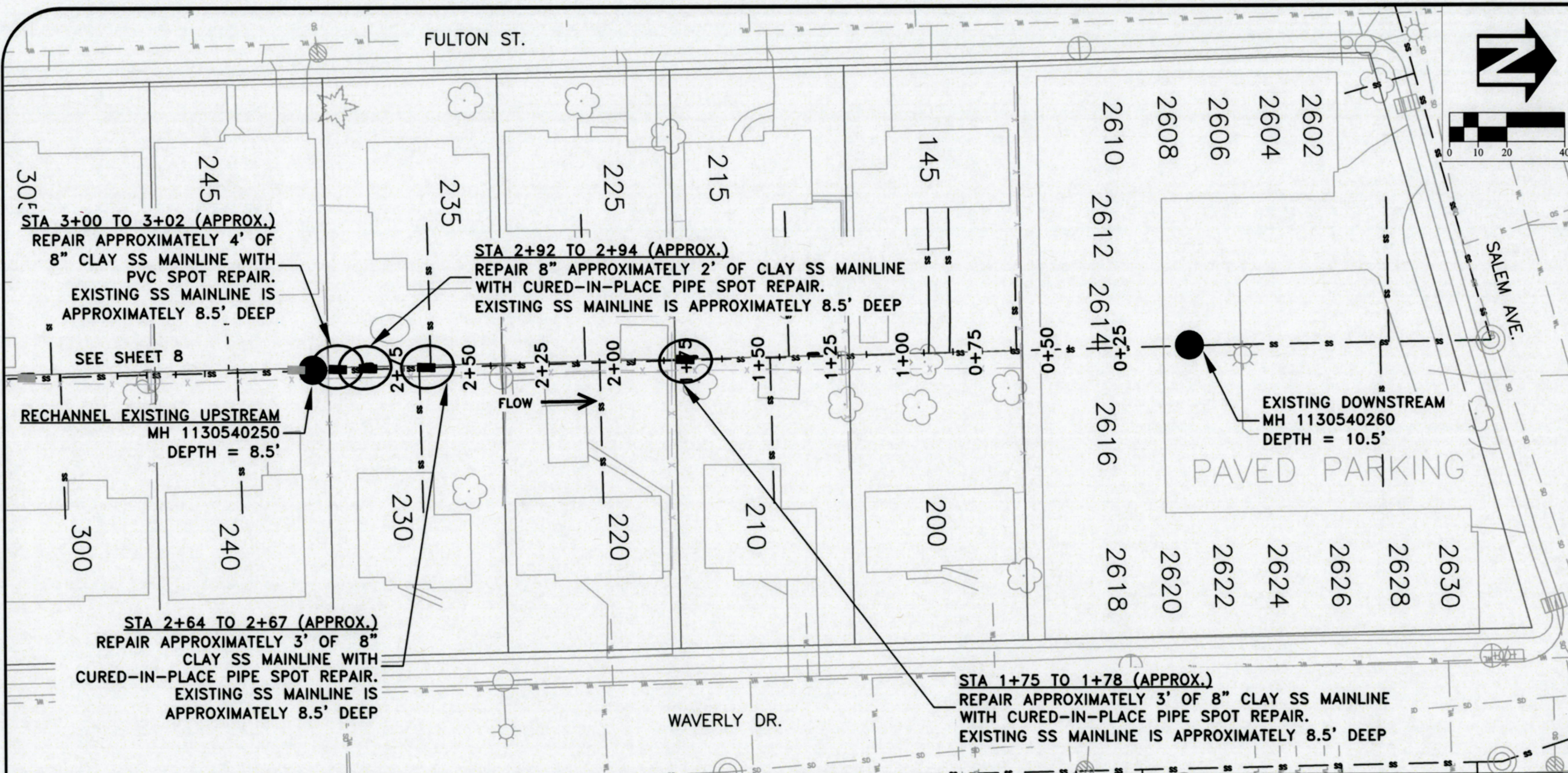

DESIGNED: A. MONACO	6/10/2017/7
DRAWN: A. MONACO	
CHECKED: J. SCHUMACHER	
DATE:	
REVISIONS	
NO:	
BY:	
DATE:	

**PUBLIC WORKS DEPARTMENT**  
**ENGINEERING SERVICES**

**SS-19-03, 2016 SEWER POINT REPAIRS**  
SEGMENT 5726



REGISTERED PROFESSIONAL  
ENGINEER  
85930PE  
*Lori L. Schumacher*  
OREGON  
MARCH 13, 2018  
LORI L. SCHUMACHER  
EXPIRES: 06/30/2020

SHEET NO. 7 OF 14  
PROJECT NO: SS-19-03  
FILE: BASE.DWG

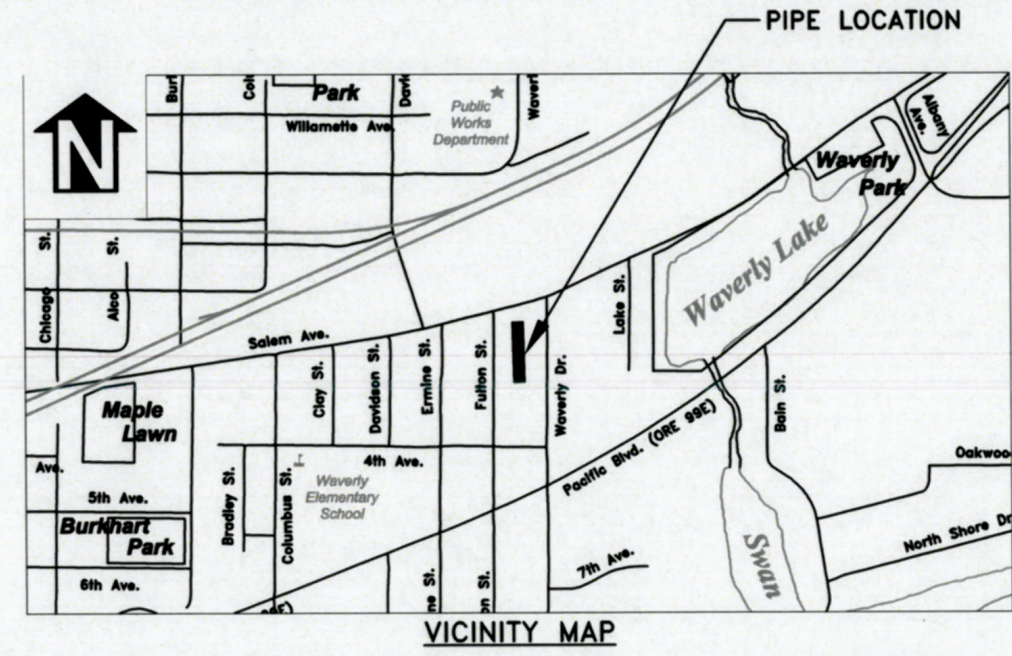

VICINITY MAP



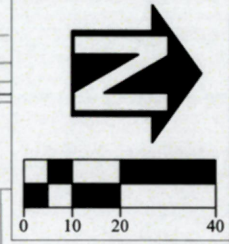
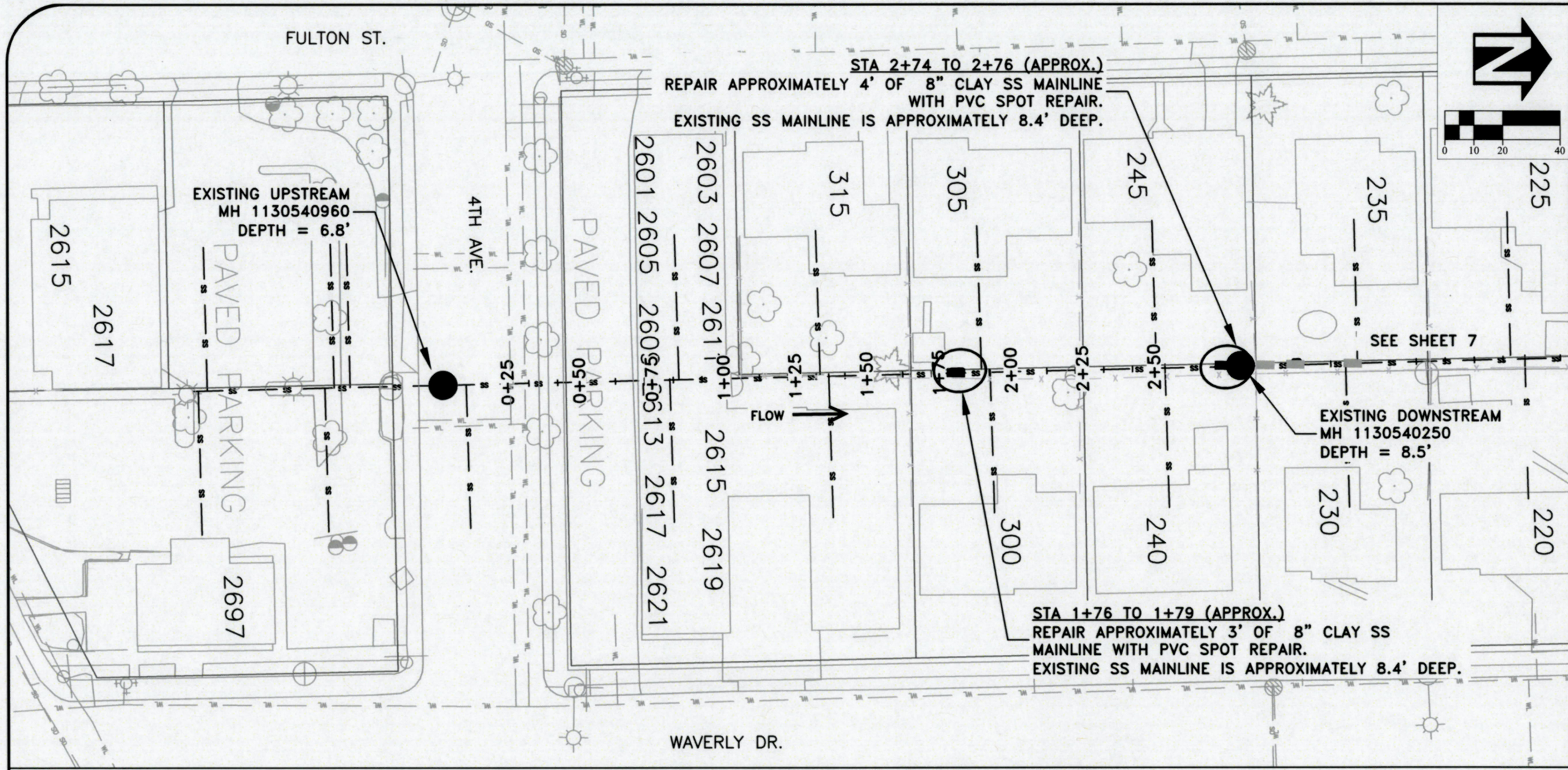

DESIGNED: A. MONACO	REVISIONS:
DRAWN: A. MONACO	NO: --
CHECKED: L. SCHUMACHER	BY: --
DATE: 7/19/2019	DATE: --

**PUBLIC WORKS DEPARTMENT**  
**ENGINEERING SERVICES**

**SS-19-03, 2019 SEWER POINT REPAIRS**  
 SEGMENT 5728

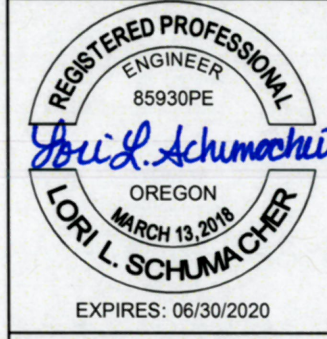
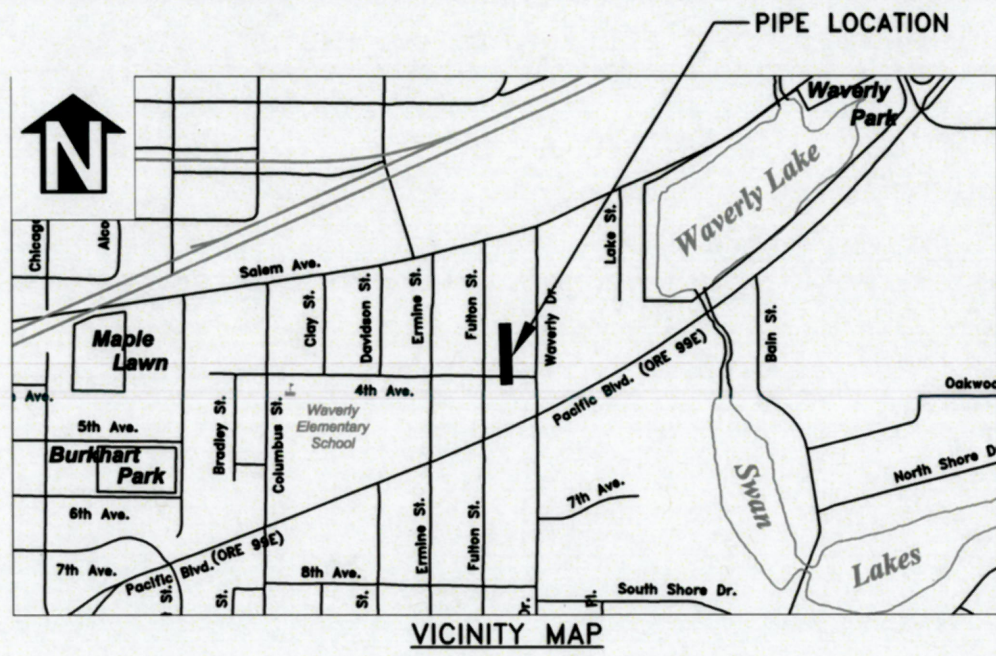

SHEET NO. 8 OF 14  
 PROJECT NO: SS-19-03  
 FILE: BASE.DWG



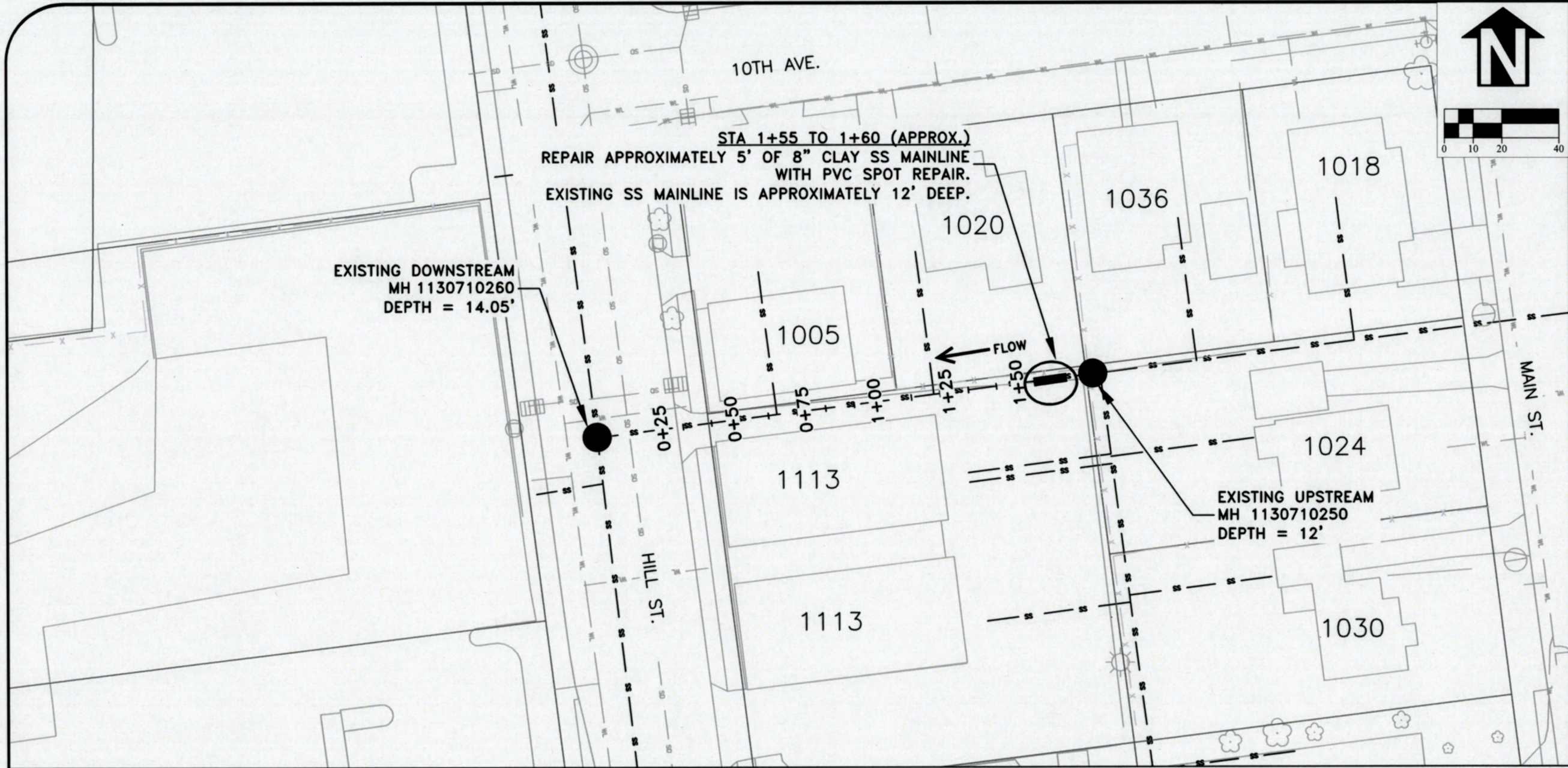

DESIGNED: A. MONACO  
DRAWN: A. MONACO  
CHECKED: L. SCHUMACHER  
DATE: 7/19/2019

REVISIONS	
NO.	BY:

**PUBLIC WORKS DEPARTMENT**  
**ENGINEERING SERVICES**

**SS-19-03, 2019 SEWER POINT REPAIRS**  
SEGMENT 5942



REGISTERED PROFESSIONAL  
ENGINEER  
85930PE  
*Lori L. Schumacher*  
OREGON  
MARCH 13, 2018  
LORI L. SCHUMACHER  
EXPIRES: 06/30/2020

SHEET NO. 9 OF 14  
PROJECT NO: SS-19-03  
FILE: BASE.DWG

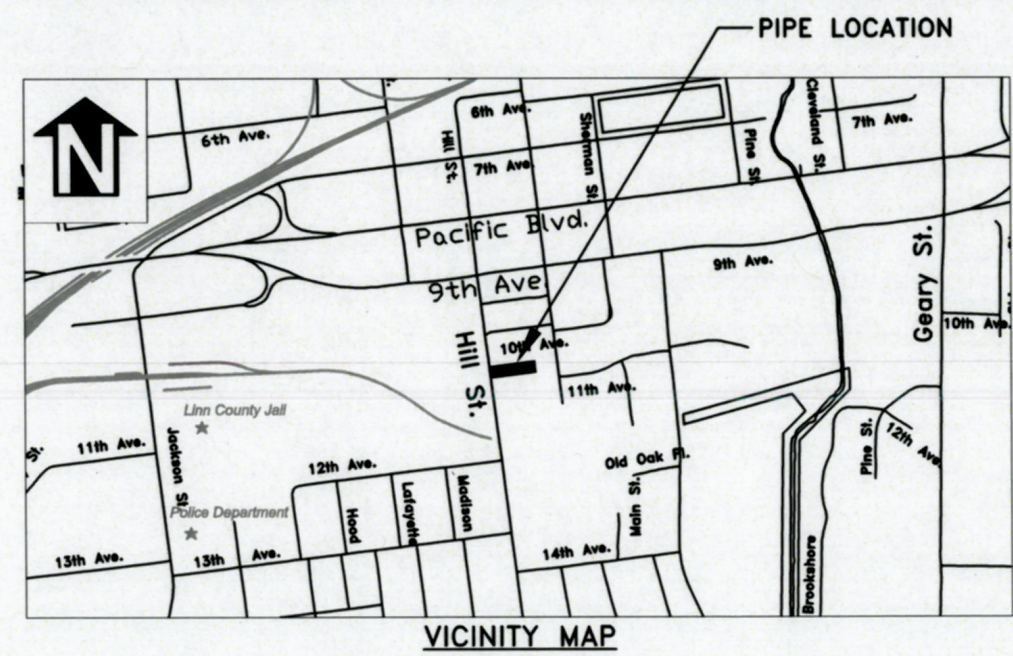



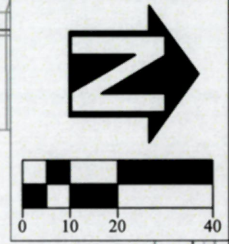
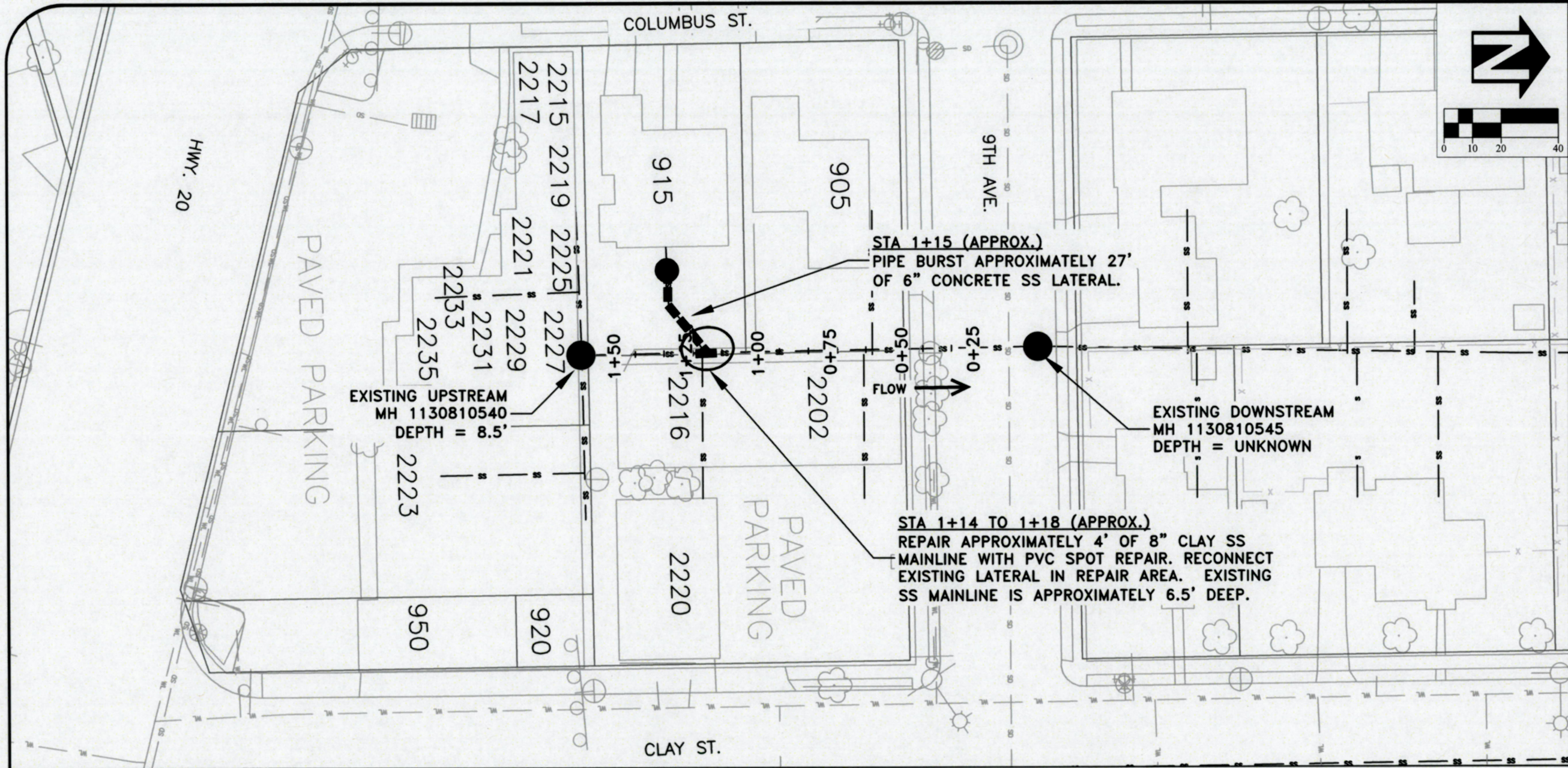

DESIGNED: A. MONACO	REVISIONS
DRAWN: A. MONACO	NO: --
CHECKED: L. SCHUMACHER	BY: --
DATE: 7/19/2019	DATE: --

**PUBLIC WORKS DEPARTMENT  
ENGINEERING SERVICES**



**SS-19-03, 2019 SEWER POINT REPAIRS  
SEGMENT 6289**

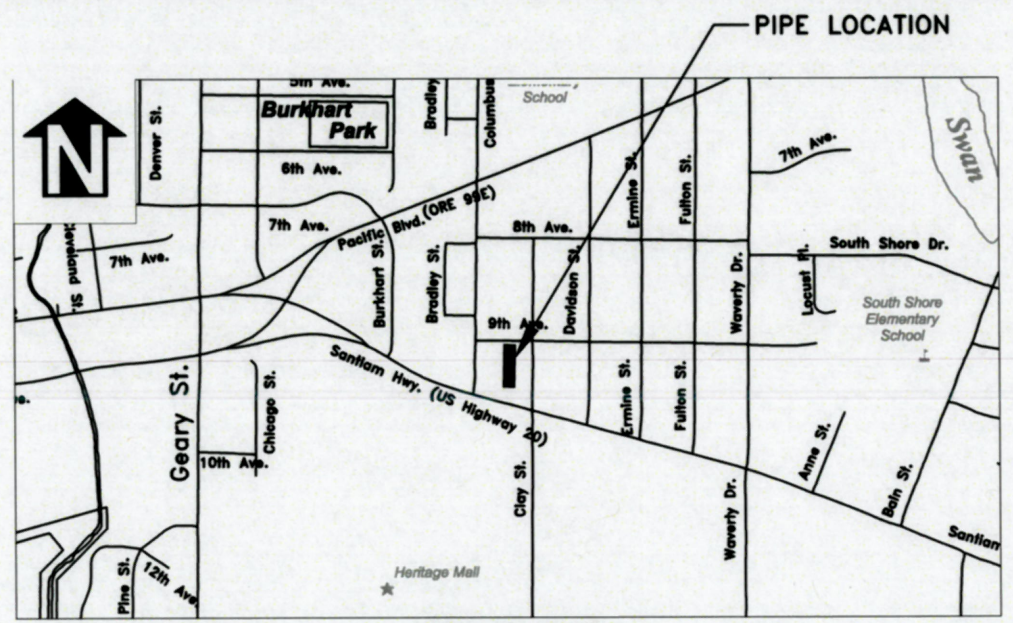

**VICINITY MAP**



SHEET NO. 10 OF 14  
PROJECT NO: SS-19-03  
FILE: BASE.DWG



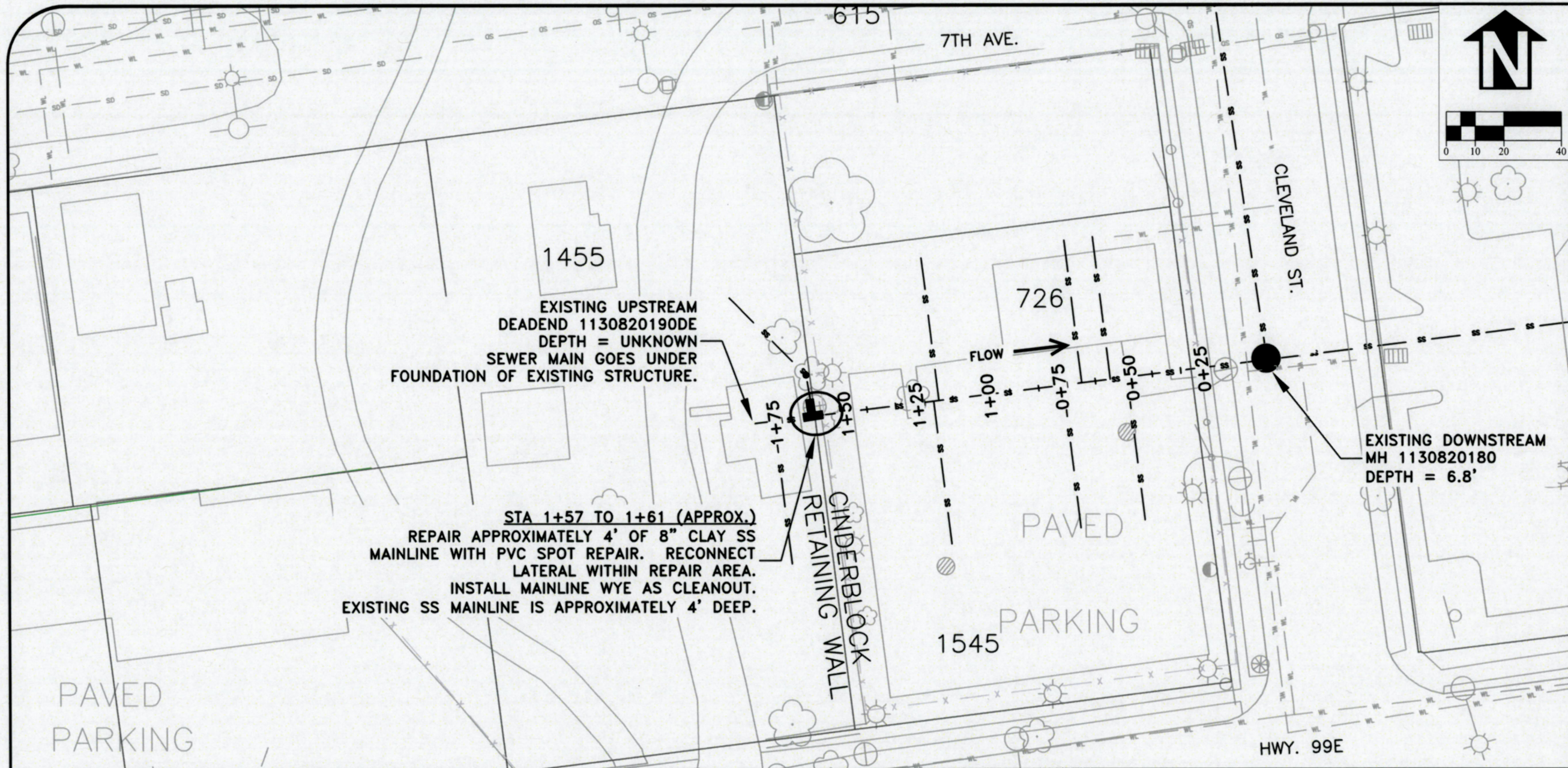



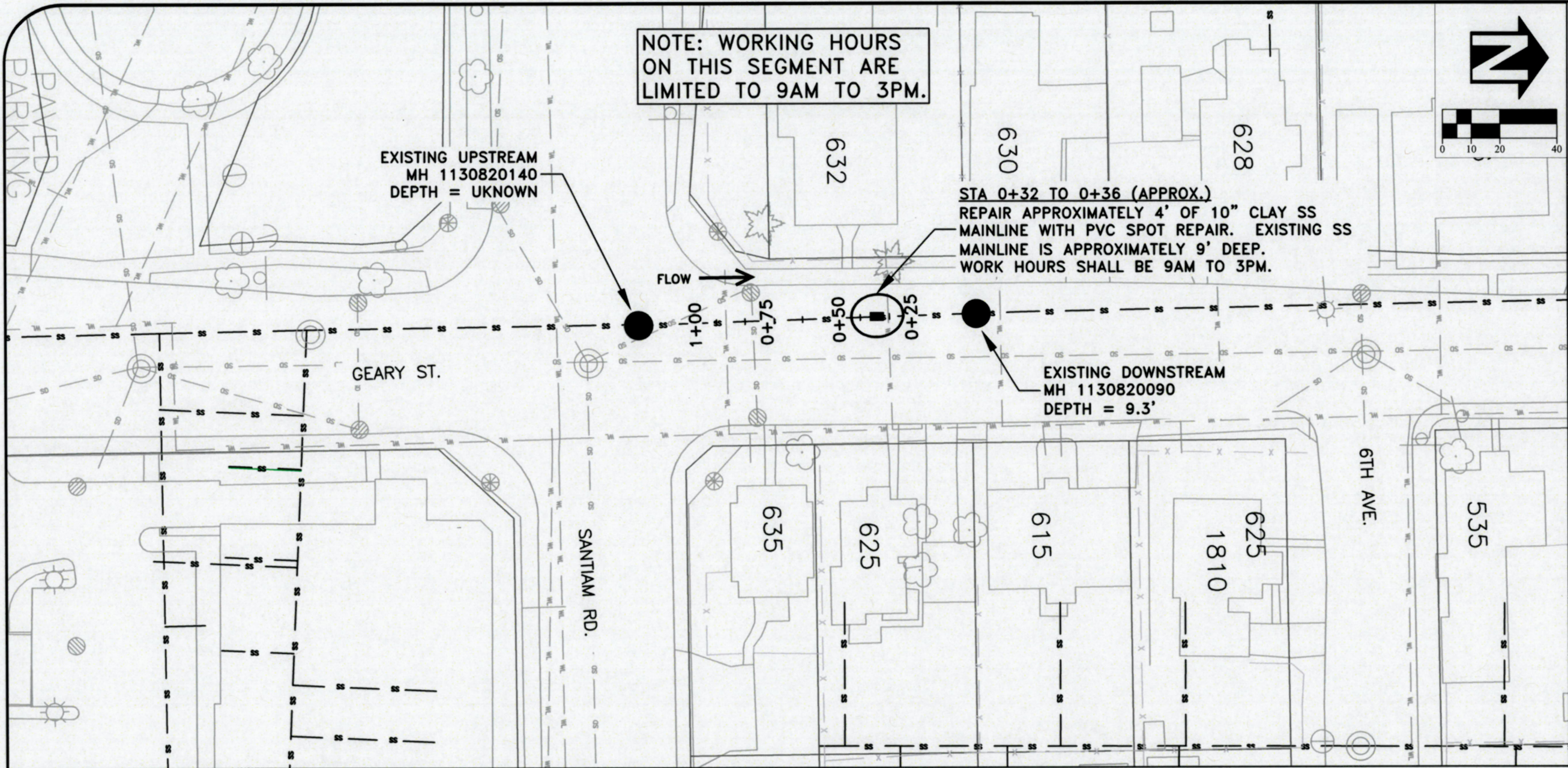

DESIGNED: A. MONACO  
DRAWN: A. MONACO  
CHECKED: L. SCHUMACHER  
DATE: 7/19/2019

REVISIONS	
NO.	BY:

**PUBLIC WORKS DEPARTMENT**  
**ENGINEERING SERVICES**

**SS-19-03, 2019 SEWER POINT REPAIRS**  
SEGMENT 639I

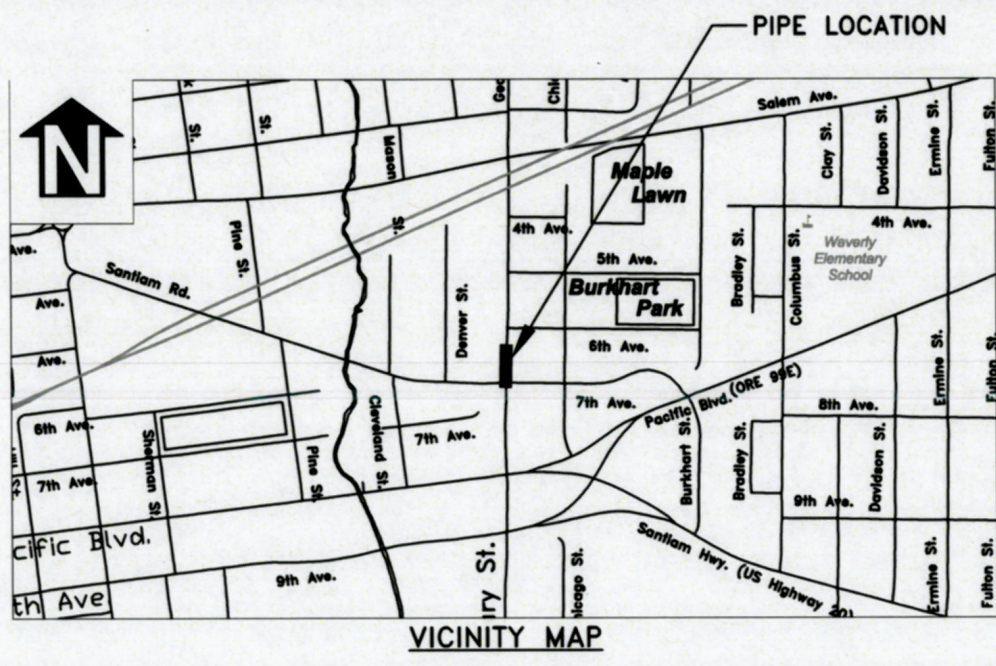
REGISTERED PROFESSIONAL  
ENGINEER  
85930PE

*Lori L. Schumacher*

OREGON  
MARCH 13, 2018

LORI L. SCHUMACHER

EXPIRES: 06/30/2020

SHEET NO. 12 OF 14  
PROJECT NO: SS-19-03  
FILE: BASE.DWG



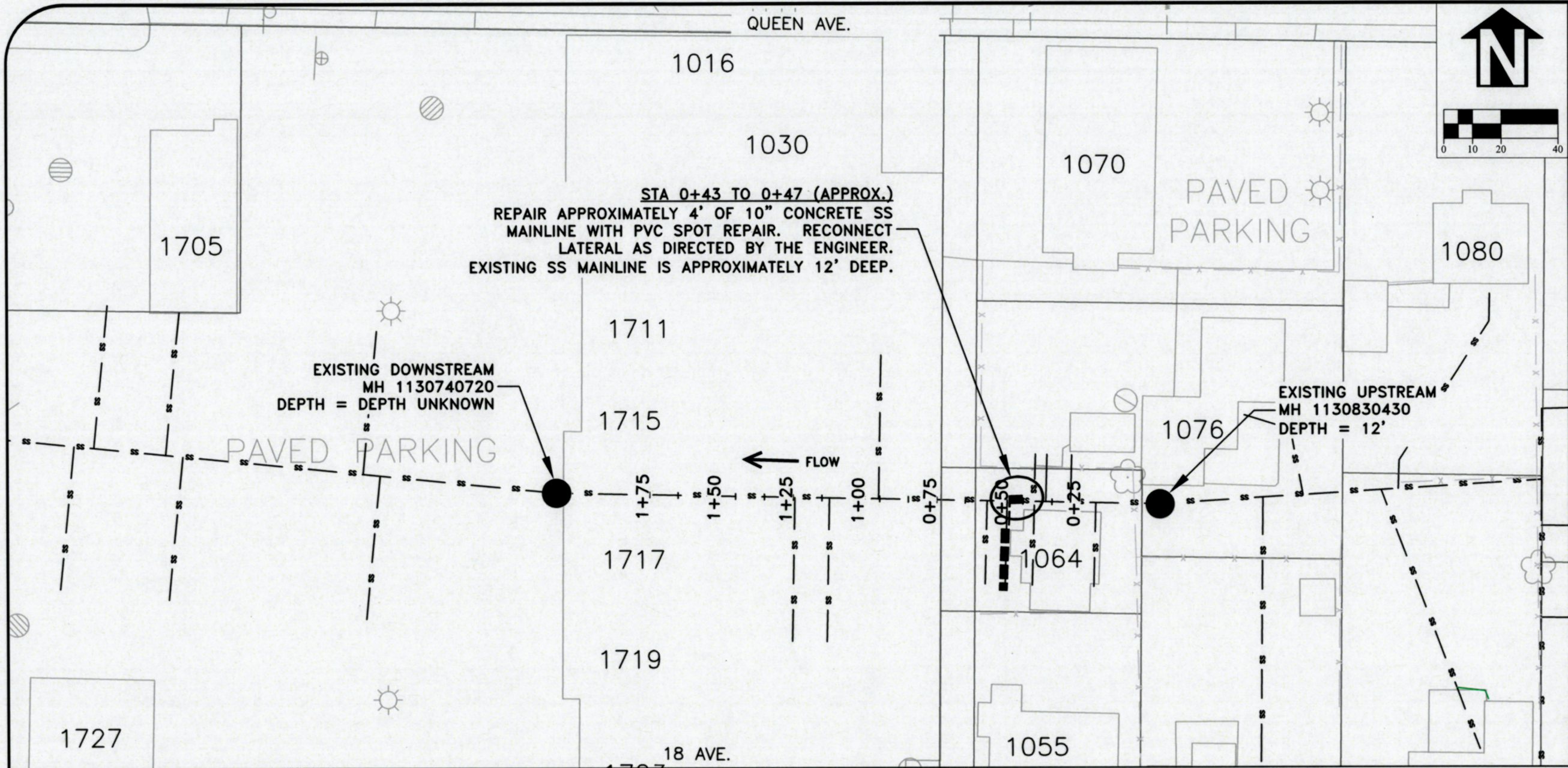

STA 0+43 TO 0+47 (APPROX.)  
 REPAIR APPROXIMATELY 4' OF 10" CONCRETE SS  
 MAINLINE WITH PVC SPOT REPAIR. RECONNECT  
 LATERAL AS DIRECTED BY THE ENGINEER.  
 EXISTING SS MAINLINE IS APPROXIMATELY 12' DEEP.

EXISTING DOWNSTREAM  
 MH 1130740720  
 DEPTH = DEPTH UNKNOWN

EXISTING UPSTREAM  
 MH 1130830430  
 DEPTH = 12'

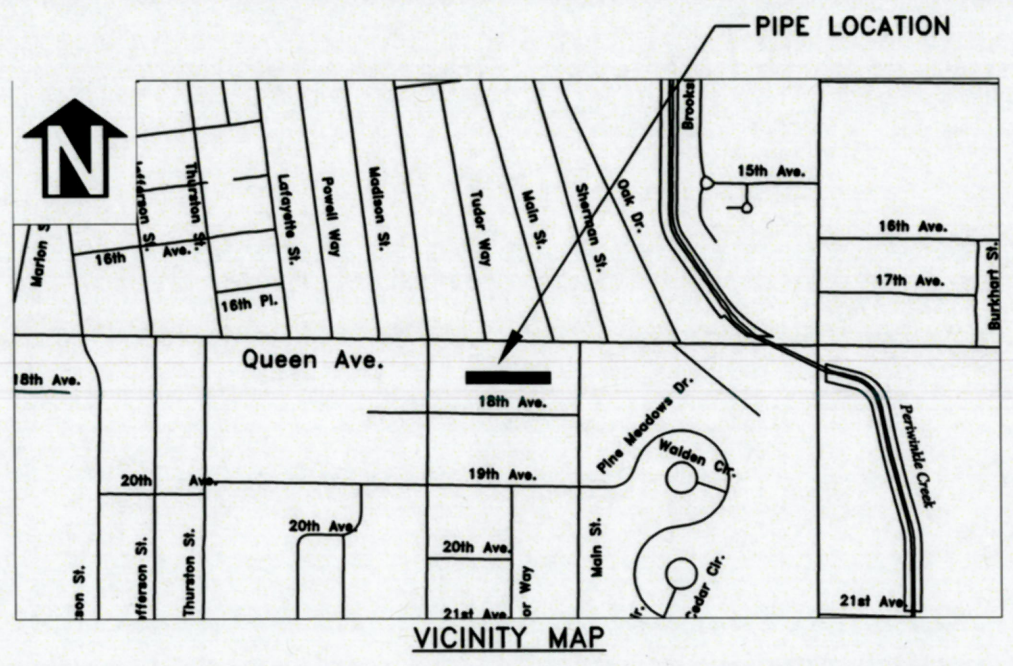
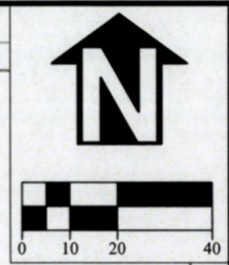

DESIGNED: A. MONACO  
 DRAWN: A. MONACO  
 CHECKED: L. SCHUMACHER  
 DATE: 7/19/2019

REVISIONS	
NO.	BY:

**PUBLIC WORKS DEPARTMENT**  
**ENGINEERING SERVICES**

**SS-19-03, 2019 SEWER POINT REPAIRS**  
**SEGMENT 6829**

REGISTERED PROFESSIONAL  
 ENGINEER  
 85930PE

*Lori L. Schumacher*

OREGON  
 MARCH 13, 2018  
**LORI L. SCHUMACHER**

EXPIRES: 06/30/2020

SHEET NO. 13 OF 14  
 PROJECT NO: SS-19-03  
 FILE: BASE.DWG



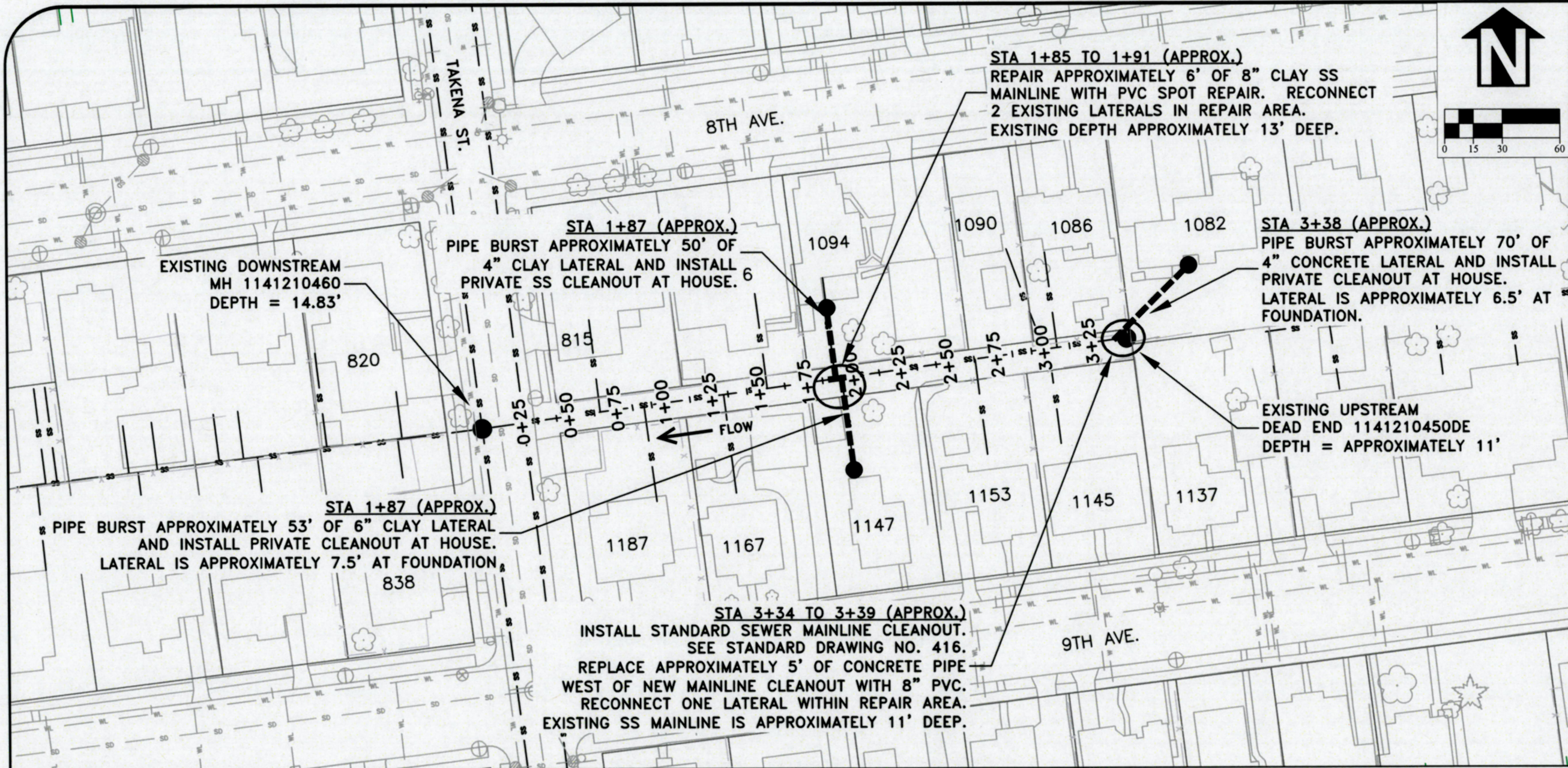
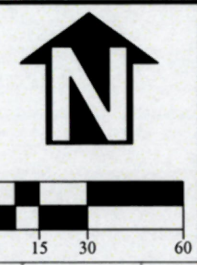

STA 1+85 TO 1+91 (APPROX.)  
 REPAIR APPROXIMATELY 6' OF 8" CLAY SS  
 MAINLINE WITH PVC SPOT REPAIR. RECONNECT  
 2 EXISTING LATERALS IN REPAIR AREA.  
 EXISTING DEPTH APPROXIMATELY 13' DEEP.

STA 1+87 (APPROX.)  
 PIPE BURST APPROXIMATELY 50' OF  
 4" CLAY LATERAL AND INSTALL  
 PRIVATE SS CLEANOUT AT HOUSE.

STA 3+38 (APPROX.)  
 PIPE BURST APPROXIMATELY 70' OF  
 4" CONCRETE LATERAL AND INSTALL  
 PRIVATE CLEANOUT AT HOUSE.  
 LATERAL IS APPROXIMATELY 6.5' AT  
 FOUNDATION.

EXISTING DOWNSTREAM  
 MH 1141210460  
 DEPTH = 14.83'

STA 1+87 (APPROX.)  
 PIPE BURST APPROXIMATELY 53' OF 6" CLAY LATERAL  
 AND INSTALL PRIVATE CLEANOUT AT HOUSE.  
 LATERAL IS APPROXIMATELY 7.5' AT FOUNDATION

EXISTING UPSTREAM  
 DEAD END 1141210450DE  
 DEPTH = APPROXIMATELY 11'

STA 3+34 TO 3+39 (APPROX.)  
 INSTALL STANDARD SEWER MAINLINE CLEANOUT.  
 SEE STANDARD DRAWING NO. 416.  
 REPLACE APPROXIMATELY 5' OF CONCRETE PIPE  
 WEST OF NEW MAINLINE CLEANOUT WITH 8" PVC.  
 RECONNECT ONE LATERAL WITHIN REPAIR AREA.  
 EXISTING SS MAINLINE IS APPROXIMATELY 11' DEEP.

DESIGNED: A. MONACO	REVISIONS:
DRAWN: A. MONACO	NO: --
CHECKED: L. SCHUMACHER	BY: --
DATE: 7/19/2019	DATE: --

PUBLIC WORKS DEPARTMENT  
 ENGINEERING SERVICES

SS-19-03, 2019 SEWER POINT REPAIRS  
 SEGMENT 7344

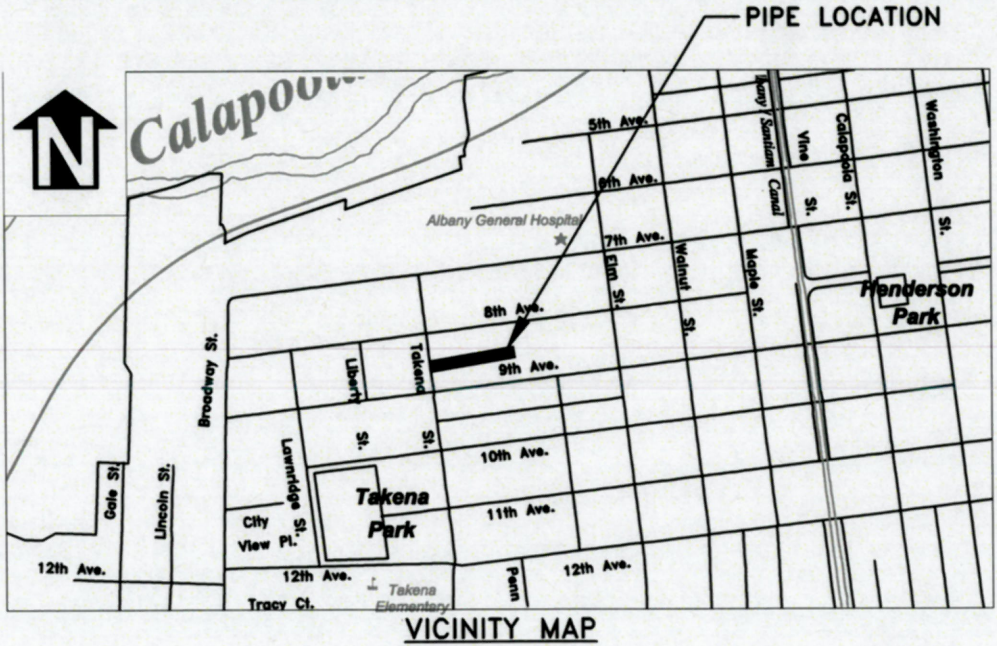

SHEET NO. 14 OF 14  
 PROJECT NO: SS-19-03  
 FILE: BASE.DWG