











CITY OF ALBANY

SS-21-01, 2021 PIPE BURSTING PROJECTS

SHEET INDEX	
Sheet Number	Sheet Title
1	COVER
2	PIPE ID 6736
3	PIPE ID 7341
4	PIPE ID 6053
5	PIPE ID 5894
6	PIPE ID 5620 AND 5627
7	PIPE ID 5445 AND 5446
8	PIPE ID 5444 AND 5447
9	PIPE ID 5436
10	PIPE ID 6441, 6442 AND 139268
11	PIPE ID 6435, 6431 AND 7381
12	PIPE ID 4806, 4807 AND 4809
13	PIPE ID 4808 AND 4804
14	PIPE ID 4803 AND 4790
15	PIPE ID 4792

LEGEND

	EXISTING SEWER MANHOLE, DEAD END OR MAINLINE CLEANOUT CONNECTED TO SEGMENT BEING REHABILITATED
	EXISTING SEWER MANHOLE, DEAD END OR MAINLINE CLEANOUT
	EXISTING SEWER MAIN
	EXISTING SEWER LATERAL
	EXISTING PRIVATE CLEANOUT
	NEW PRIVATE CLEANOUT
	NEW PROPERTY LINE CLEANOUT
	PIPE BURST SEWER MAINLINE
	OPEN TRENCH SEWER MAINLINE
	NEW PRIVATE SEWER LATERAL
	SEWER LATERAL CONNECTION TO BE ABANDONED



GENERAL NOTES

1. ALL CONSTRUCTION SHALL CONFORM TO THE CITY OF ALBANY STANDARD CONSTRUCTION SPECIFICATIONS AND ASSOCIATED STANDARD DRAWINGS. THE CURRENT VERSION OF THE CITY OF ALBANY STANDARD CONSTRUCTION SPECIFICATIONS CAN BE FOUND ON THE CITY'S WEBSITE AT WWW.CITYOFALBANY.NET.
2. UTILITIES SHOWN ARE FOR REFERENCE ONLY. FOR A FIELD LOCATE, CALL THE UTILITIES NOTIFICATIONS CENTER AT 1-800-332-2344.
3. OPERATING ACCESS FOR CITY MAINTENANCE PERSONNEL TO EXISTING AND NEW WATER VALVES AND MANHOLES SHALL BE CONTINUOUSLY MAINTAINED BY THE CONTRACTOR DURING ALL CONSTRUCTION ACTIVITIES.
4. CONTRACTOR SHALL VERIFY ALL EXISTING PIPE ELEVATIONS, PIPE DIAMETERS, AND PIPE MATERIALS AT CONNECTION AND ABANDONMENT LOCATIONS PRIOR TO CONSTRUCTION. ANY DISCREPANCIES SHALL BE REPORTED TO ENGINEER PRIOR TO BEGINNING WORK.
5. ATTENTION: OREGON LAW REQUIRES YOU TO FOLLOW RULES ADOPTED BY THE OREGON UTILITY NOTIFICATION CENTER. THOSE RULES ARE SET FORTH IN OAR 952-001-0010 THROUGH OAR 952-001-0090. YOU MAY OBTAIN COPIES OF THE RULES BY CALLING THE CENTER. (NOTE: THE TELEPHONE NUMBER FOR THE OREGON UTILITY NOTIFICATION CENTER IS (503) 232-1987).
6. CONTRACTOR SHALL BE RESPONSIBLE FOR PROPER INSTALLATION AND MAINTENANCE OF ALL EROSION PREVENTION SEDIMENT CONTROL (EPSC) MEASURES IN ACCORDANCE WITH LOCAL, STATE, AND FEDERAL REGULATIONS UNTIL ALL CONSTRUCTION IS COMPLETED AND APPROVED BY THE CITY OF ALBANY, AND VEGETATION/LANDSCAPING IS ESTABLISHED. FOR GUIDANCE, REFER TO THE CITY OF ALBANY EPSC MANUAL WHICH CAN BE FOUND AT WWW.CITYOFALBANY.NET.
7. CONTRACTOR SHALL VERIFY AND EXPOSE ALL PRIVATE LATERAL CONNECTIONS AT THE MAIN PRIOR TO CONSTRUCTION. ANY DISCREPANCIES REGARDING PIPE DIAMETER AND MATERIAL SHALL BE REPORTED TO THE ENGINEER PRIOR TO BEGINNING MAINLINE CONSTRUCTION.
8. PIPE AND MATERIALS INSTALLED ON PRIVATE PROPERTY SHALL BE IN ACCORDANCE WITH THE CURRENT OREGON PLUMBING SPECIALTY CODE.
9. CONTRACTOR SHALL VERIFY THE CITY HAS OBTAINED PLUMBING PERMITS FOR EACH PROPERTY PRIOR TO CONSTRUCTING IMPROVEMENTS ON PRIVATE PROPERTY.
10. ALL PRIVATE SERVICE LATERALS SHOWN TO BE REPLACED SHALL BE PIPE BURST UNLESS OTHERWISE NOTED ON THE PLANS OR AS SPECIFIED BY THE ENGINEER.
11. ALL SEWER MAINS SHALL BE REHABILITATED USING PIPE BURSTING. SEE SPECIAL PROVISIONS.

DESIGNED: L. SCHUMACHER
 DRAWN: L. SCHUMACHER
 CHECKED: C. CERKLEWSKI
 DATE: 2/15/2021

REVISIONS	
NO.	BY:

PUBLIC WORKS DEPARTMENT
ENGINEERING SERVICES



SS-21-01, 2021 PIPE BURSTING PROJECTS

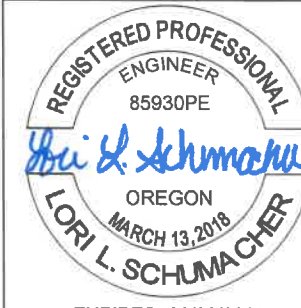

SHEET NO. 1 OF 15
 PROJECT NO: SS-21-01
 FILE: FILENAME.DWG

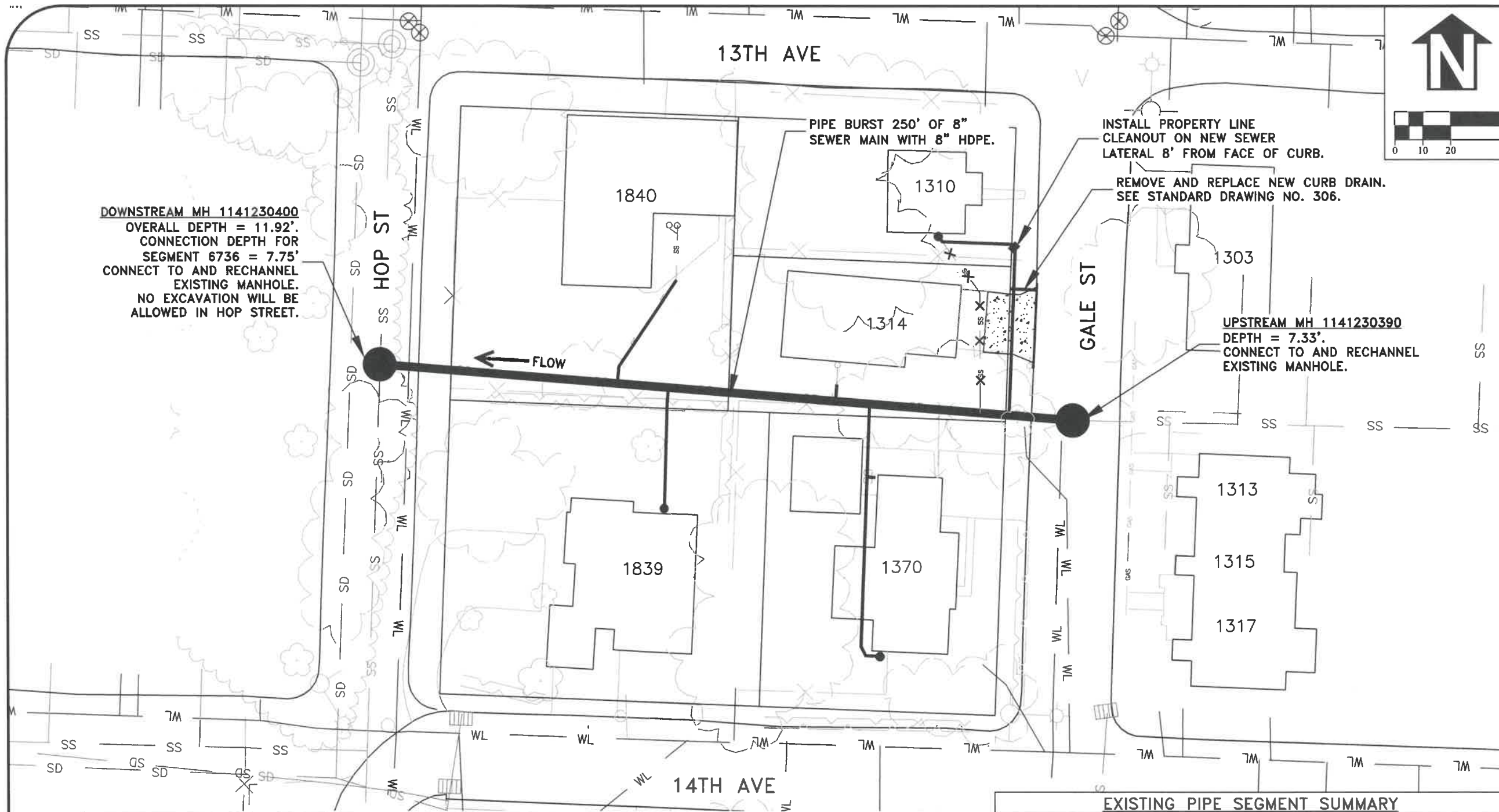

DOWNSTREAM MH 1141230400
 OVERALL DEPTH = 11.92'.
 CONNECTION DEPTH FOR
 SEGMENT 6736 = 7.75'
 CONNECT TO AND RECHANNEL
 EXISTING MANHOLE.
 NO EXCAVATION WILL BE
 ALLOWED IN HOP STREET.

PIPE BURST 250' OF 8"
 SEWER MAIN WITH 8" HDPE.

INSTALL PROPERTY LINE
 CLEANOUT ON NEW SEWER
 LATERAL 8' FROM FACE OF CURB.

REMOVE AND REPLACE NEW CURB DRAIN.
 SEE STANDARD DRAWING NO. 306.

UPSTREAM MH 1141230390
 DEPTH = 7.33'.
 CONNECT TO AND RECHANNEL
 EXISTING MANHOLE.

DESIGNED: L. SCHUMACHER
 DRAWN: L. SCHUMACHER
 CHECKED: C. CERKLEWSKI
 DATE: 2/15/2021

REVISIONS	
NO.	BY:

PUBLIC WORKS DEPARTMENT
 ENGINEERING SERVICES



SS-21-01, 2021 PIPE BURSTING PROJECTS
 PIPE ID 6736

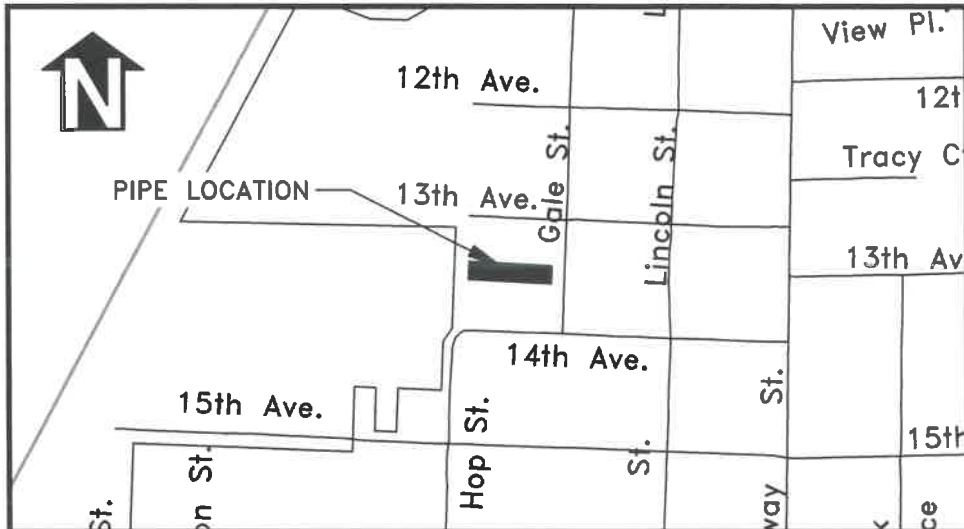

VICINITY MAP

MATERIAL CHANGE SUMMARY STARTING FROM
 UPSTREAM MH 1141230390

FOOTAGE	DESCRIPTION
74'-77'	PVC MAINLINE TEE
216'-250'	CURED-IN-PLACE PIPE

EXISTING PIPE SEGMENT SUMMARY

PIPE ID	6736
PIPE DIAMETER AND MATERIAL	8" CONC.
UPSTREAM MH ID	1141230390
DOWNSTREAM MH ID	1141230400
TOTAL LENGTH (FT)	250
TOTAL NUMBER OF CONNECTED LATERALS	5
TOTAL NUMBER OF PIPE BURST LATERAL REPLACEMENTS	3
TOTAL NUMBER OF OPEN TRENCH LATERAL REPLACEMENTS	1

LATERAL SUMMARY STARTING FROM UPSTREAM MH 1141230390

FOOTAGE	ACTION	PROPERTY SERVED	PRIVATE SEWER LATERAL CONSTRUCTION NOTES
33.8'R	REPLACE/RELOCATE	1310 GALE ST SW	OPEN TRENCH NEW LATERAL AS SHOWN
75.7'L	REPLACE	1370 GALE ST SW	PIPE BURST 4" ORANGEBURG LATERAL WITH 4" HDPE RECONNECT EX TEE CONNECTION AS SHOWN
85.6'R	RECONNECT	1314 GALE ST SW	RECONNECT 4" ABS LATERAL AS SPECIFIED
146.1'L	REPLACE	1839 14TH AVE SW	PIPE BURST 4" ORANGEBURG LATERAL WITH 4" HDPE
164.6'R	REPLACE	1840 13TH AVE SW	PIPE BURST 4" ORANGEBURG SECTION OF LATERAL WITH 4" HDPE



EXPIRES: 06/30/2022

SHEET NO. 2 OF 15
 PROJECT NO: SS-21-01
 FILE: BASE.DWG

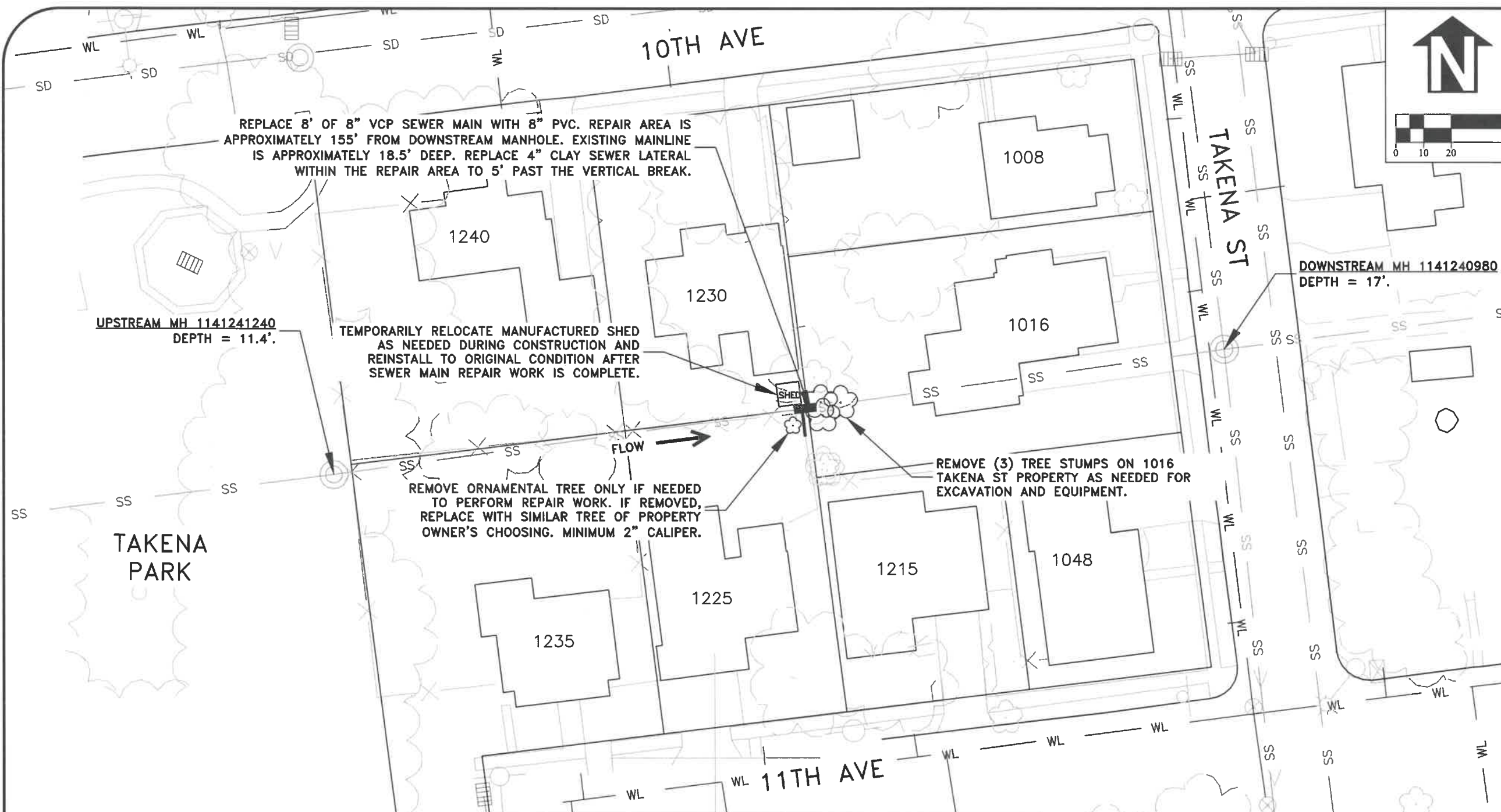

REPLACE 8' OF 8" VCP SEWER MAIN WITH 8" PVC. REPAIR AREA IS APPROXIMATELY 155' FROM DOWNSTREAM MANHOLE. EXISTING MAINLINE IS APPROXIMATELY 18.5' DEEP. REPLACE 4" CLAY SEWER LATERAL WITHIN THE REPAIR AREA TO 5' PAST THE VERTICAL BREAK.

UPSTREAM MH 1141241240
DEPTH = 11.4'.

TEMPORARILY RELOCATE MANUFACTURED SHED AS NEEDED DURING CONSTRUCTION AND REINSTALL TO ORIGINAL CONDITION AFTER SEWER MAIN REPAIR WORK IS COMPLETE.

REMOVE ORNAMENTAL TREE ONLY IF NEEDED TO PERFORM REPAIR WORK. IF REMOVED, REPLACE WITH SIMILAR TREE OF PROPERTY OWNER'S CHOOSING. MINIMUM 2" CALIPER.

REMOVE (3) TREE STUMPS ON 1016 TAKENA ST PROPERTY AS NEEDED FOR EXCAVATION AND EQUIPMENT.

DOWNSTREAM MH 1141240980
DEPTH = 17'.

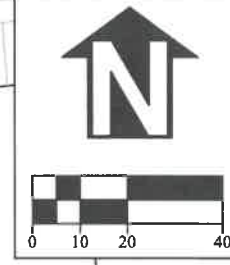

DESIGNED: L. SCHUMACHER	REVISIONS
DRAWN: L. SCHUMACHER	NO: ---
CHECKED: C. CERKLEWSKI	BY: ---
DATE: 2/15/2021	DATE: ---

PUBLIC WORKS DEPARTMENT
ENGINEERING SERVICES



SS-21-01, 2021 PIPE BURSTING PROJECTS
PIPE ID 7341

REGISTERED PROFESSIONAL
ENGINEER
85930PE
Lori L. Schumacher
OREGON
MARCH 13, 2018
LORI L. SCHUMACHER

EXPIRES: 06/30/2022

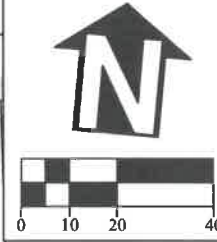
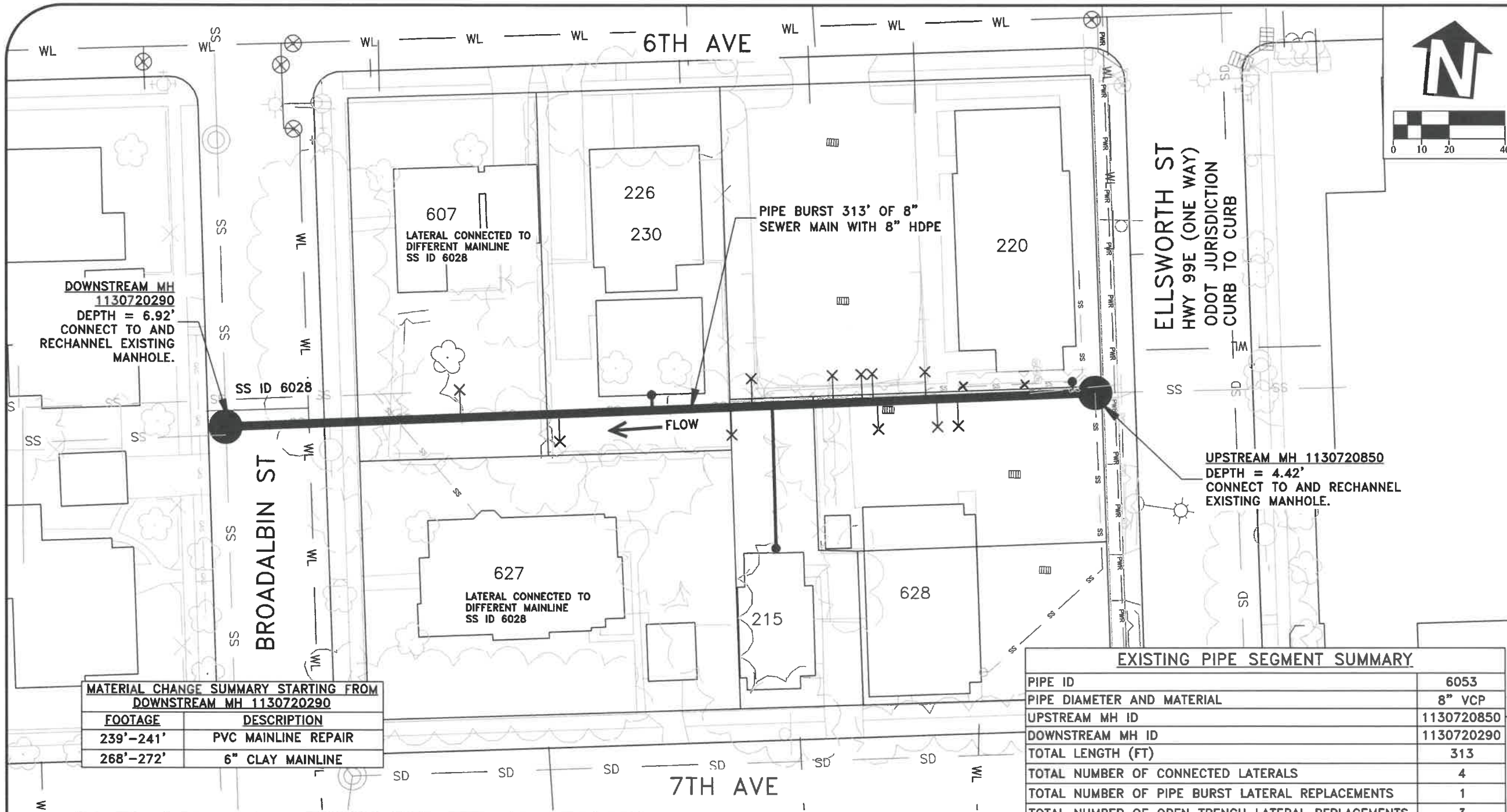

DESIGNED: L. SCHUMACHER
 DRAWN: L. SCHUMACHER
 CHECKED: C. CERKLEWSKI
 DATE: 2/15/2021

REVISIONS	
NO.	BY:

**PUBLIC WORKS DEPARTMENT
 ENGINEERING SERVICES**

**SS-21-01, 2021 PIPE BURSTING PROJECTS
 PIPE ID 6053**



MATERIAL CHANGE SUMMARY STARTING FROM DOWNSTREAM MH 1130720290

FOOTAGE	DESCRIPTION
239'-241'	PVC MAINLINE REPAIR
268'-272'	6" CLAY MAINLINE

EXISTING PIPE SEGMENT SUMMARY

PIPE ID	6053
PIPE DIAMETER AND MATERIAL	8" VCP
UPSTREAM MH ID	1130720850
DOWNSTREAM MH ID	1130720290
TOTAL LENGTH (FT)	313
TOTAL NUMBER OF CONNECTED LATERALS	4
TOTAL NUMBER OF PIPE BURST LATERAL REPLACEMENTS	1
TOTAL NUMBER OF OPEN TRENCH LATERAL REPLACEMENTS	3

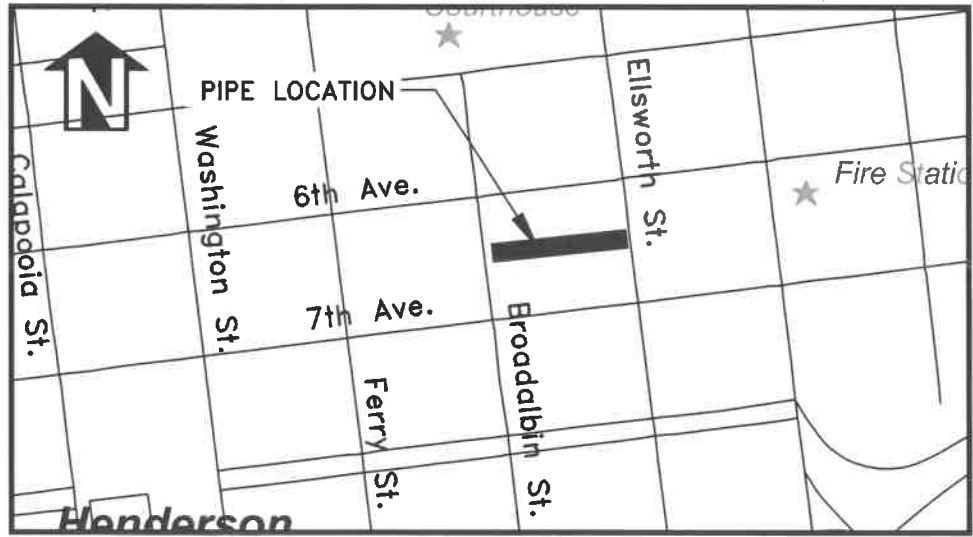

LATERAL SUMMARY STARTING FROM DOWNSTREAM MH 1130720290

FOOTAGE	ACTION	PROPERTY SERVED	PRIVATE SEWER LATERAL CONSTRUCTION NOTES
84.0'L	ABANDON	-	-
120.1'R	ABANDON	-	-
153.7'L	RECONNECT	226 6TH AVE SW	OPEN TRENCH NEW 4" PVC LATERAL AS SHOWN
181.9'R	ABANDON	-	-
189.6'R	ABANDON	-	-
206.0'R	RECONNECT	215 7TH AVE SW	PIPE BURST 6" CLAY LATERAL WITH 6" HDPE
219.9'L	ABANDON	-	-
229.3'L	ABANDON	-	-
233.3'L	ABANDON	-	-
234.9'R	ABANDON	-	-
252.3'L	RECONNECT	220 6TH AVE SW	RELOCATE CONNECTION IN LINE WITH EXISTING CLEANOUT AS SHOWN. INSTALL NEW 4" CLEANOUT.
256.1'R	ABANDON	-	-
263.6'R	ABANDON	-	-

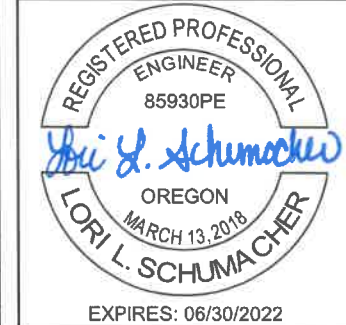

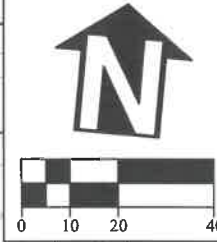
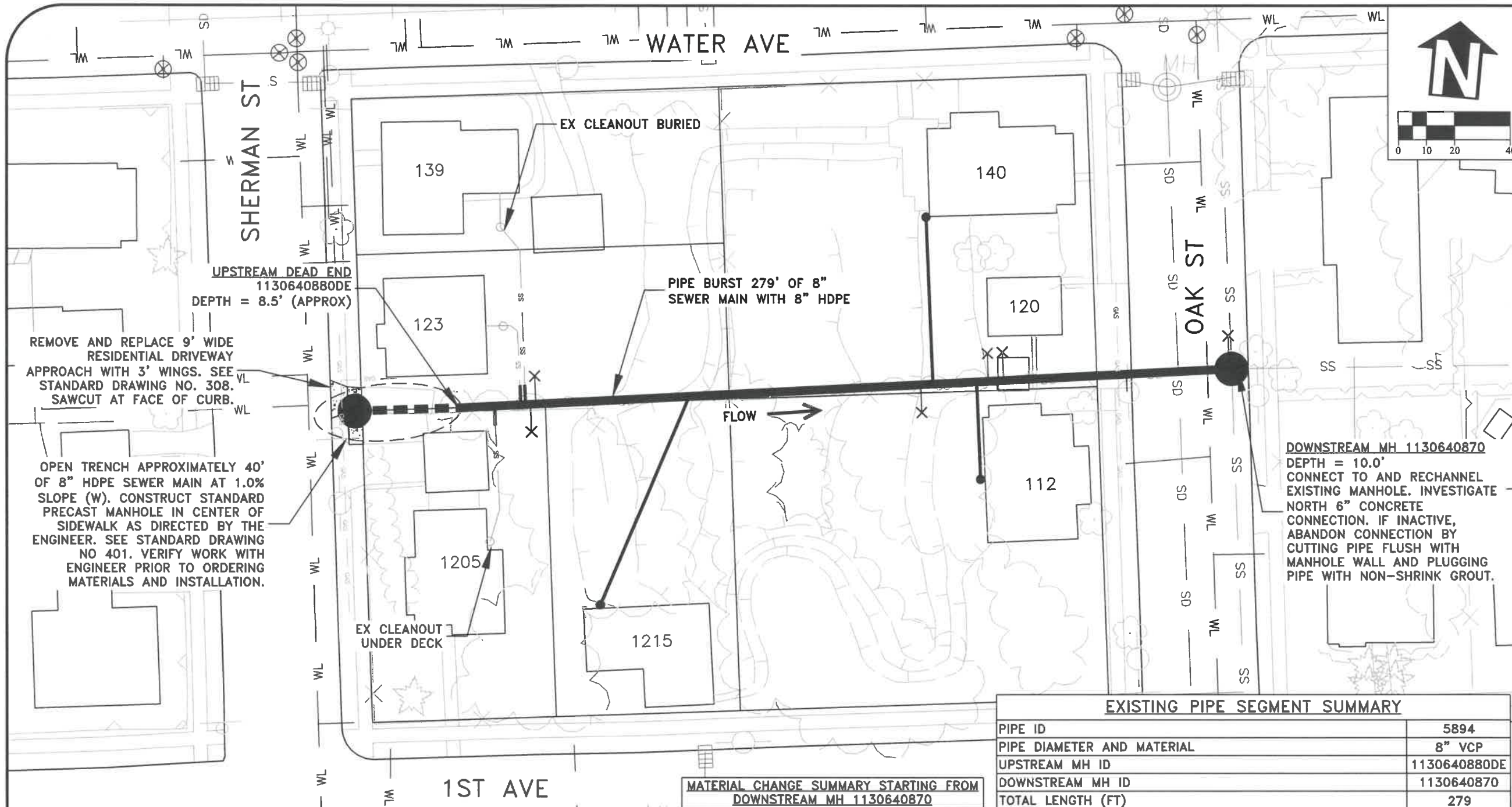

DESIGNED: L. SCHUMACHER	REVISIONS
DRAWN: L. SCHUMACHER	NO: -
CHECKED: C. CERKLEWSKI	BY: -
DATE: 2/15/2021	DATE: -

UPSTREAM DEAD END
1130640880DE
DEPTH = 8.5' (APPROX)

REMOVE AND REPLACE 9' WIDE
RESIDENTIAL DRIVEWAY
APPROACH WITH 3' WINGS. SEE
STANDARD DRAWING NO. 308.
SAWCUT AT FACE OF CURB.

OPEN TRENCH APPROXIMATELY 40'
OF 8" HDPE SEWER MAIN AT 1.0%
SLOPE (W). CONSTRUCT STANDARD
PRECAST MANHOLE IN CENTER OF
SIDEWALK AS DIRECTED BY THE
ENGINEER. SEE STANDARD DRAWING
NO 401. VERIFY WORK WITH
ENGINEER PRIOR TO ORDERING
MATERIALS AND INSTALLATION.

PIPE BURST 279' OF 8"
SEWER MAIN WITH 8" HDPE

DOWNSTREAM MH 1130640870
DEPTH = 10.0'
CONNECT TO AND RECHANNEL
EXISTING MANHOLE. INVESTIGATE
NORTH 6" CONCRETE
CONNECTION. IF INACTIVE,
ABANDON CONNECTION BY
CUTTING PIPE FLUSH WITH
MANHOLE WALL AND PLUGGING
PIPE WITH NON-SHRINK GROUT.

PUBLIC WORKS DEPARTMENT
ENGINEERING SERVICES

SS-21-01, 2021 PIPE BURSTING PROJECTS
PIPE ID 5894

EXISTING PIPE SEGMENT SUMMARY

PIPE ID	5894
PIPE DIAMETER AND MATERIAL	8" VCP
UPSTREAM MH ID	1130640880DE
DOWNSTREAM MH ID	1130640870
TOTAL LENGTH (FT)	279
TOTAL NUMBER OF CONNECTED LATERALS	6
TOTAL NUMBER OF PIPE BURST LATERAL REPLACEMENTS	3
TOTAL NUMBER OF OPEN TRENCH LATERAL REPLACEMENTS	0

MATERIAL CHANGE SUMMARY STARTING FROM
DOWNSTREAM MH 1130640870

FOOTAGE	DESCRIPTION
182'-191'	PVC SPOT REPAIR
262'-269'	PVC SPOT REPAIR

LATERAL SUMMARY STARTING FROM DOWNSTREAM MH 1130640870

FOOTAGE	ACTION	PROPERTY SERVED	PRIVATE SEWER LATERAL CONSTRUCTION NOTES
81.7'R	ABANDON	-	ABANDON CONNECTION
87.2'R	ABANDON	-	ABANDON CONNECTION
89.7'L	RECONNECT	112 OAK ST NE	PIPE BURST 4" AND 6" CLAY LATERAL WITH 4" HDPE
107.3'R	RECONNECT	140 OAK ST NE	PIPE BURST 6" CLAY LATERAL WITH 4" HDPE
111.7'L	ABANDON	-	ABANDON CONNECTION
195.0'L	RECONNECT	1215 1ST AVE NE	PIPE BURST 6" CLAY LATERAL WITH 6" HDPE
250.1'R	ABANDON	-	ABANDON CONNECTION
252.0'L	ABANDON	-	ABANDON CONNECTION
253.8'R	RECONNECT	139 SHERMAN ST NE	RECONNECT 4" PVC/HDPE LATERAL AS SPECIFIED
255.1'R	RECONNECT	123 SHERMAN ST NE	RECONNECT 4" PVC LATERAL AS SPECIFIED
264.8'R	RECONNECT	1205 1ST AVE NE	RECONNECT 4" ABS LATERAL AS SPECIFIED
269.7'R	ABANDON	-	ABANDON CONNECTION

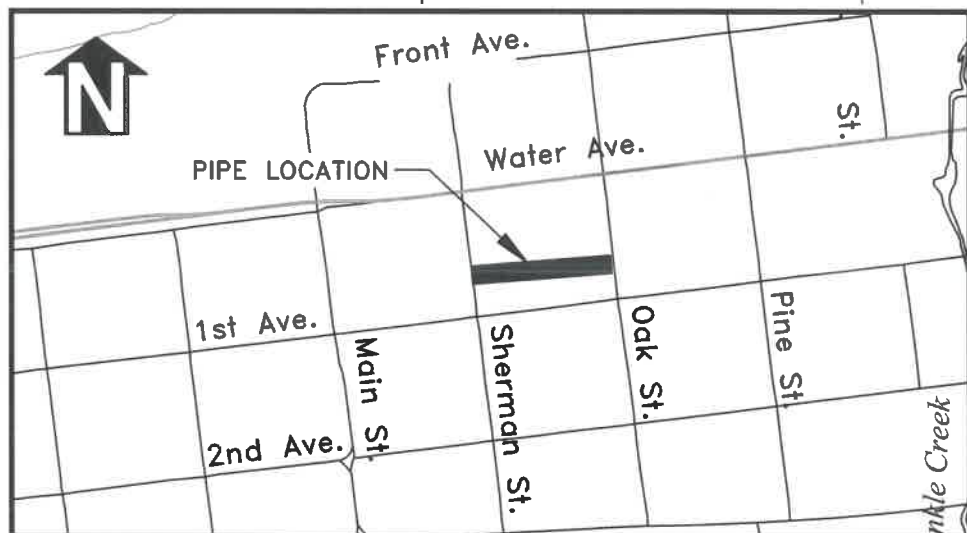

VICINITY MAP



AFTER ACCEPTANCE OF ALL NEW SEWER LATERALS, FILL EXISTING MANHOLE WITH FLOWABLE CDF TO WITHIN 6" OF FINISHED GRADE. SEE SPECIAL PROVISIONS. REMOVE COVER AND FILL TOP 6" OF MANHOLE WITH 4000 PSI CONCRETE. LEAVE MANHOLE FRAME IN PLACE.

AFTER ACCEPTANCE OF ALL NEW SEWER LATERALS, ABANDON EXISTING 8" SEWER MAINS WITH FLOWABLE CDF. SEE SPECIAL PROVISIONS.

DOWNSTREAM MH 1130531010

DEPTH = 11.75'
AFTER ABANDONMENT OF SEWER MAINS, ABANDON 8" CONNECTION IN MANHOLE WITH NON-SHRINK GROUT (S) AND RECHANNEL MANHOLE.

REMOVE UPSTREAM CLEANOUT 1130530980DE TO WITHIN 18" OF FINISHED GRADE. DEPTH = 4.8'

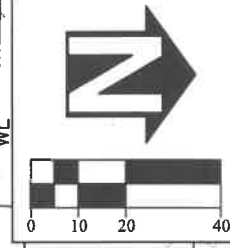

DESIGNED: L. SCHUMACHER	REVISIONS
DRAWN: L. SCHUMACHER	NO: BY:
CHECKED: C. CERKLEWSKI	DATE:
DATE: 2/15/2021	

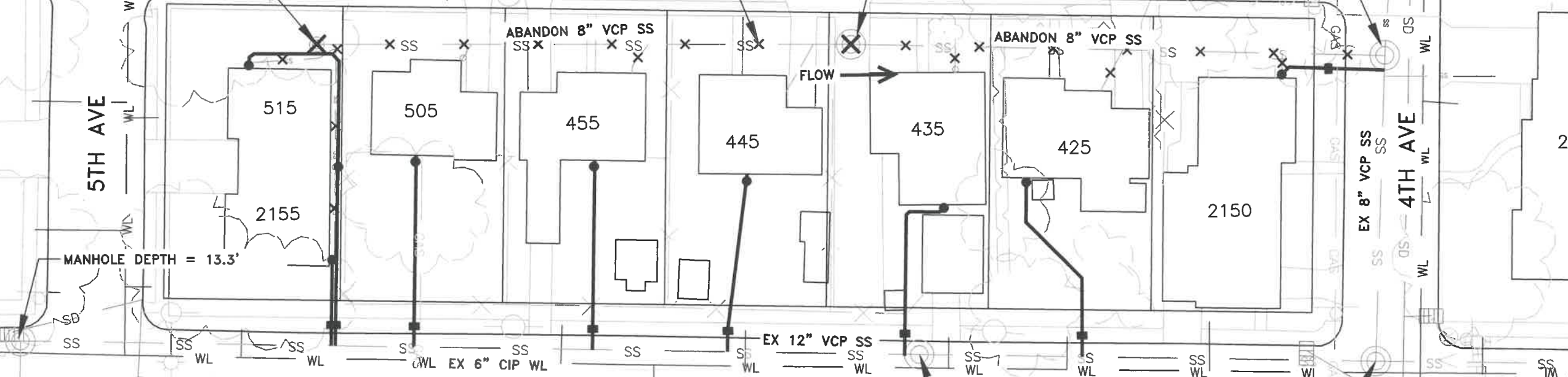

- NOTES:**
- SEE STANDARD DRAWING NO. 411 FOR ALL LATERALS THIS SHEET. CONNECT TO EX 12" AND 8" VCP SEWER MAINS USING 4" MECHANICAL TAPS.
 - MAINTAIN 6' MIN HORIZONTAL CLEARANCE BETWEEN WATER METERS AND NEW SEWER LATERAL ALIGNMENTS.
 - ALL WORK REQUIRED TO TURN PLUMBING UNDERNEATH HOMES AND WITHIN 5' OF FOUNDATIONS SHALL BE PERFORMED BY A LICENSED PLUMBER. ALL HOMES REQUIRING TURNED PLUMBING HAVE CRAWL SPACES.
 - CONSTRUCT PRIVATE SEWER LATERALS AT 2% MINIMUM SLOPE FROM HOUSE TO SIDEWALK AND CONSTRUCT VERTICAL BREAK AT SIDEWALK.

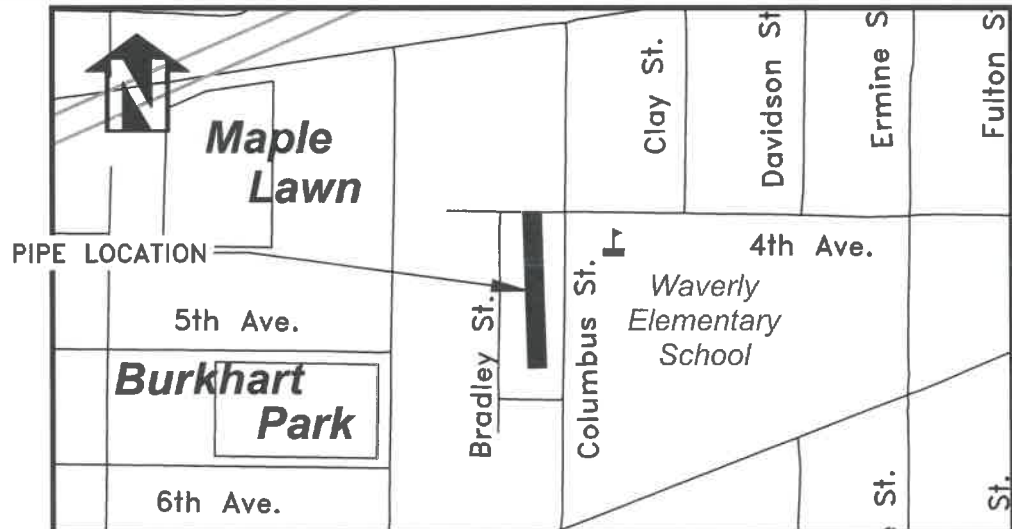

VICINITY MAP

LATERAL SUMMARY	
PROPERTY SERVED	PRIVATE SEWER LATERAL CONSTRUCTION NOTES
515 BRADLEY ST SE	OPEN TRENCH (2) 4" PVC LATERALS AND CONNECT TO 12" VCP SEWER MAIN IN COLUMBUS STREET.
505 BRADLEY ST SE	TURN SEWER PLUMBING UNDER HOUSE. OPEN TRENCH 4" PVC LATERAL AND CONNECT TO 12" VCP SEWER MAIN IN COLUMBUS ST.
455 BRADLEY ST SE	TURN SEWER PLUMBING UNDER HOUSE. OPEN TRENCH 4" PVC LATERAL AND CONNECT TO 12" VCP SEWER MAIN IN COLUMBUS ST.
445 BRADLEY ST SE	TURN SEWER PLUMBING UNDER HOUSE. OPEN TRENCH 4" PVC LATERAL AND CONNECT TO 12" VCP SEWER MAIN IN COLUMBUS ST.
435 BRADLEY ST SE	TURN SEWER PLUMBING UNDER HOUSE. OPEN TRENCH 4" PVC LATERAL BETWEEN HOUSE AND GARAGE AS SHOWN. USE HORIZONTAL DIRECTIONAL DRILLING TO CONSTRUCT 4" LATERAL FROM WEST END OF GARAGE TO SIDEWALK.
425 BRADLEY ST SE	TURN SEWER PLUMBING UNDER HOUSE. OPEN TRENCH 4" PVC LATERAL FROM HOUSE TO LANDSCAPED AREA OF YARD. USE HORIZONTAL DIRECTIONAL DRILLING TO CONSTRUCT 4" LATERAL UNDER LANDSCAPED AREA OF YARD.
2150 4TH AVE SE	OPEN TRENCH 4" PVC LATERAL AND CONNECT TO 8" VCP SEWER MAIN IN 4TH AVE.



EXPIRES: 06/30/2022
SHEET NO. 6 OF 15
PROJECT NO: SS-21-01
FILE: BASE.DWG

PUBLIC WORKS DEPARTMENT
ENGINEERING SERVICES

SS-21-01, 2021 PIPE BURSTING PROJECTS
PIPE ID 5620 AND 5627

EXISTING PIPE SEGMENT SUMMARY

PIPE ID	5446
PIPE DIAMETER AND MATERIAL	8" CONC.
UPSTREAM MH ID	1130430220
DOWNSTREAM MH ID	1130430230
TOTAL LENGTH (FT)	103
TOTAL NUMBER OF CONNECTED LATERALS	2
TOTAL NUMBER OF PIPE BURST LATERAL REPLACEMENTS	1

UPSTREAM MH 1130430210
DEPTH = 11.0'.
CONNECT TO AND RECHANNEL
EXISTING MANHOLE. ACCESS MANHOLE
FROM 3121 NORTH SHORE DR.



OAKWOOD AVE

PIPE BURST A TOTAL OF 653' OF
8" SEWER MAIN WITH 8" HDPE.

DOWNSTREAM MH 1130430230
DEPTH = 10.44'.
CONNECT TO AND RECHANNEL
EXISTING MANHOLE.

INSTALL PRIVATE
TWO-WAY CLEANOUT ON
EXISTING SEWER LATERAL.

MH 1130430220
DEPTH = 10.5'
PIPE BURST THROUGH EXISTING
MANHOLE. ABANDON MANHOLE BY
REMOVING CONE SECTION AND FILLING
BARREL SECTION WITH 1-INCH MINUS
SELECT BACKFILL TO WITHIN 18" OF
FINISHED GRADE. BACKFILL REMAINING
EXCAVATION WITH TOPSOIL. ACCESS
MANHOLE FROM 2927 NORTH SHORE DR.

EXISTING PIPE SEGMENT SUMMARY

PIPE ID	5445
PIPE DIAMETER AND MATERIAL	8" CONC.
UPSTREAM MH ID	1130430210
DOWNSTREAM MH ID	1130430220
TOTAL LENGTH (FT)	550
TOTAL NUMBER OF CONNECTED LATERALS	12
TOTAL NUMBER OF PIPE BURST LATERAL REPLACEMENTS	5

NORTH SHORE DR

5446 LATERAL SUMMARY STARTING FROM DOWNSTREAM MH 1130430230

FOOTAGE	ACTION	PROPERTY SERVED	PRIVATE SEWER LATERAL CONSTRUCTION NOTES
27.9'L	RECONNECT	633 BAIN ST SE	RECONNECT 4" PVC LATERAL AS SPECIFIED
31.2'R	RECONNECT	641 BAIN ST SE	PIPE BURST 4" CLAY LATERAL WITH 4" HDPE

5445 LATERAL SUMMARY STARTING FROM DOWNSTREAM MH 1130430220

FOOTAGE	ACTION	PROPERTY SERVED	PRIVATE SEWER LATERAL CONSTRUCTION NOTES
16.1'L	RECONNECT	2924 OAKWOOD AVE SE	RECONNECT 4" ABS LATERAL AS SPECIFIED
19.2'R	RECONNECT	2927 NORTH SHORE DR	RECONNECT 4" CLAY LATERAL AS SPECIFIED
110.6'L	ABANDON	-	-
114.4'R	ABANDON	-	-
118.2'R	RECONNECT	2931 NORTH SHORE DR SE	RECONNECT 4" PVC LATERAL AS SPECIFIED
119.5'L	RECONNECT	3004 OAKWOOD AVE SE	RECONNECT 4" HDPE LATERAL AS SPECIFIED
190.3'L	RECONNECT	3012 OAKWOOD AVE SE	RECONNECT 4" CLAY LATERAL AS SPECIFIED AND INSTALL PRIVATE CLEANOUT AT FOUNDATION.
196.0'L	ABANDON	-	-
198.9'R	RECONNECT	3013 NORTH SHORE DR SE	PIPE BURST 4" CONCRETE LATERAL WITH 4" HDPE
283.7'L	RECONNECT	3020 OAKWOOD AVE SE	RECONNECT 4" ABS LATERAL AS SPECIFIED
286.6'R	ABANDON	-	-
313.2'R	RECONNECT	3025 NORTH SHORE DR SE	RECONNECT 4" CONCRETE LATERAL AS SPECIFIED
374.3'L	ABANDON	-	-
378.0'R	RECONNECT	3037 NORTH SHORE DR SE	PIPE BURST 4" AC LATERAL WITH 4" HDPE
383.6'L	RECONNECT	3028 OAKWOOD AVE SE	PIPE BURST 4" CLAY LATERAL WITH 4" HDPE
474.6'L	ABANDON	-	-
476.8'L	RECONNECT	3110 OAKWOOD AVE SE	PIPE BURST 4" CLAY LATERAL WITH 4" HDPE
477.7'R	RECONNECT	3107 NORTH SHORE DR SE	PIPE BURST 4" PVC/ORANGEBURG LATERAL WITH 4" HDPE

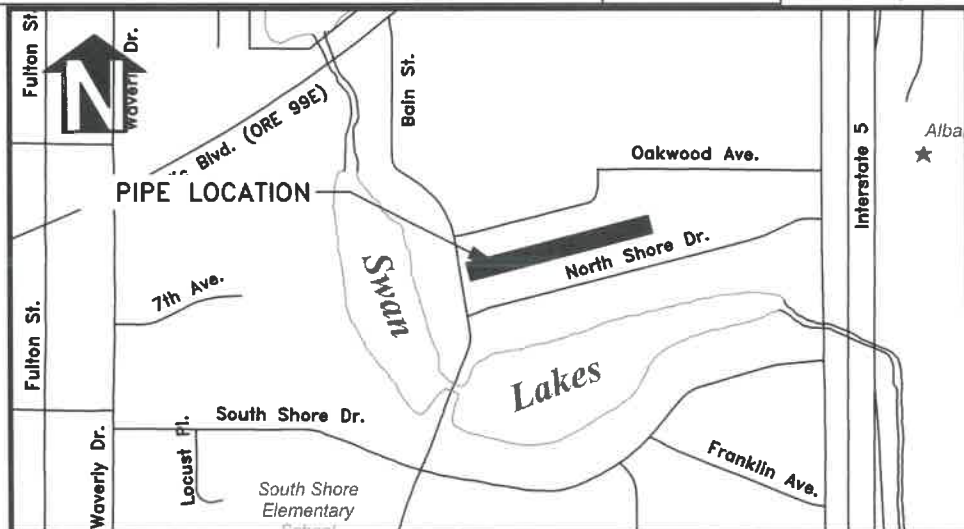

VICINITY MAP

DESIGNED: L. SCHUMACHER
DRAWN: L. SCHUMACHER
CHECKED: C. CERKLEWSKI
DATE: 2/15/2021

REVISIONS

NO:	BY:

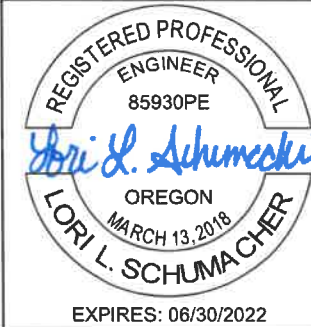

SHEET NO. 7 OF 15
PROJECT NO: SS-21-01
FILE: BASE.DWG

PUBLIC WORKS DEPARTMENT
ENGINEERING SERVICES

SS-21-01, 2021 PIPE BURSTING PROJECTS
PIPE ID 5445 AND 5446

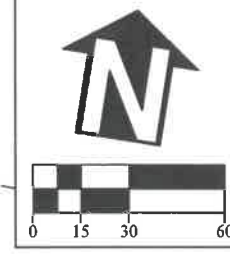
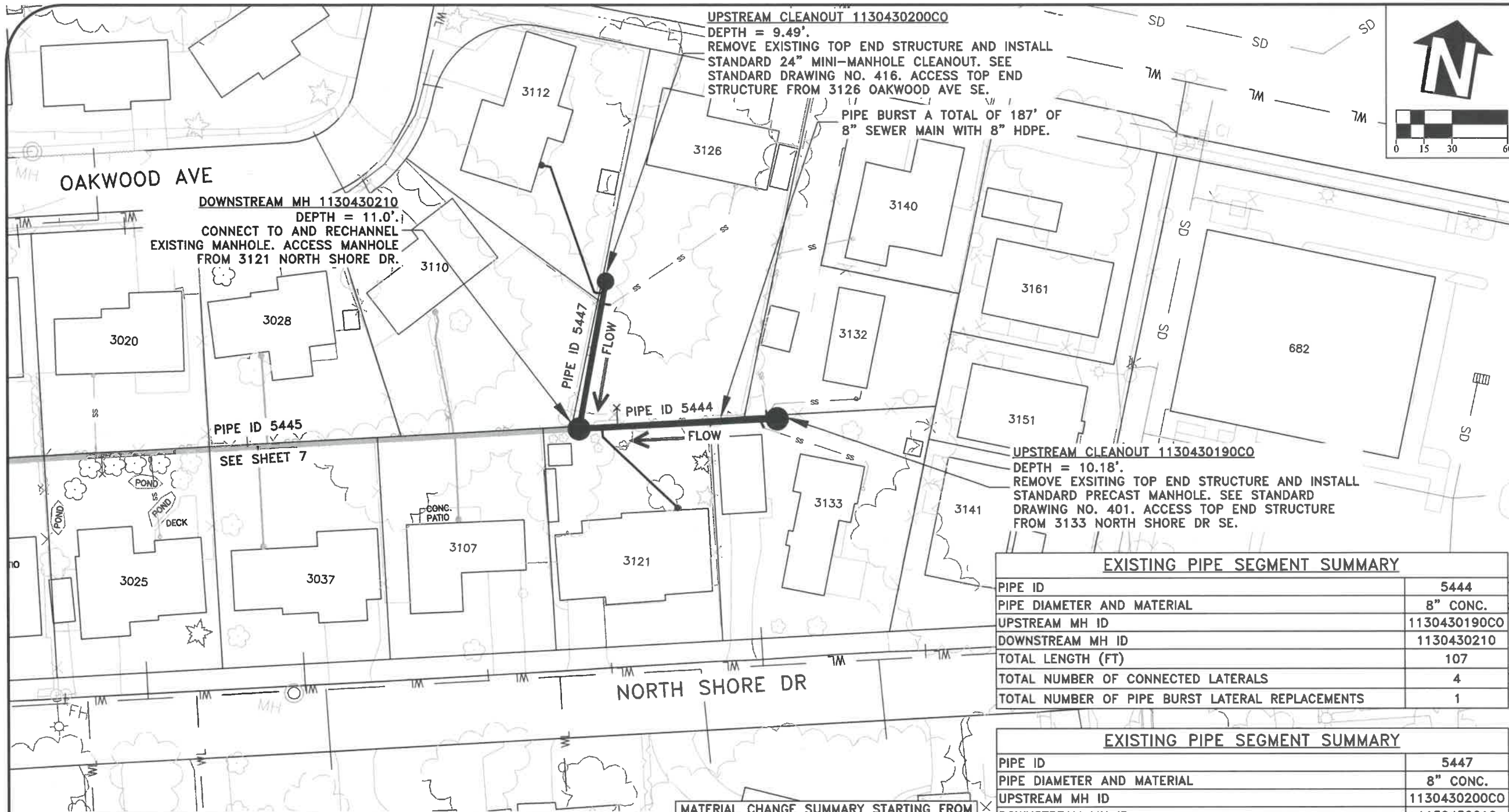

DESIGNED: L. SCHUMACHER	REVISIONS
DRAWN: L. SCHUMACHER	NO: BY:
CHECKED: C. CERKLEWSKI	DATE:
DATE: 2/15/2021	DATE:

EXISTING PIPE SEGMENT SUMMARY	
PIPE ID	5444
PIPE DIAMETER AND MATERIAL	8" CONC.
UPSTREAM MH ID	1130430190CO
DOWNSTREAM MH ID	1130430210
TOTAL LENGTH (FT)	107
TOTAL NUMBER OF CONNECTED LATERALS	4
TOTAL NUMBER OF PIPE BURST LATERAL REPLACEMENTS	1

EXISTING PIPE SEGMENT SUMMARY	
PIPE ID	5447
PIPE DIAMETER AND MATERIAL	8" CONC.
UPSTREAM MH ID	1130430200CO
DOWNSTREAM MH ID	1130430210
TOTAL LENGTH (FT)	80
TOTAL NUMBER OF CONNECTED LATERALS	2
TOTAL NUMBER OF PIPE BURST LATERAL REPLACEMENTS	1

MATERIAL CHANGE SUMMARY STARTING FROM DOWNSTREAM MH 1130430210	
FOOTAGE	DESCRIPTION
98'-107' (END)	PVC MAIN WITH 2 MAINLINE TEES AND MAINLINE C/O

5444 LATERAL SUMMARY STARTING FROM DOWNSTREAM MH 1130430210			
FOOTAGE	ACTION	PROPERTY SERVED	PRIVATE SEWER LATERAL CONSTRUCTION NOTES
12.4'R	RECONNECT	3121 NORTH SHORE DR SE	PIPE BURST 4" ORANGEBURG WITH 4" HDPE
20.8'L	ABANDON	-	-
97.7'R	RECONNECT	3133 NORTH SHORE DR SE	RECONNECT 4" PVC LATERAL AS SPECIFIED
101.3'L	RECONNECT	3140 OAKWOOD AVE SE	RECONNECT 4" PVC LATERAL AS SPECIFIED
104.0'L	RECONNECT	3132 OAKWOOD AVE SE	RECONNECT 4" PVC LATERAL AS SPECIFIED

5447 LATERAL SUMMARY STARTING FROM DOWNSTREAM MH 1130430210			
FOOTAGE	ACTION	PROPERTY SERVED	PRIVATE SEWER LATERAL CONSTRUCTION NOTES
68.7'R	RECONNECT	3140 OAKWOOD AVE SE	RECONNECT 4" PVC LATERAL AS SPECIFIED
78.0'L	RECONNECT	3112 OAKWOOD AVE SE	PIPE BURST 4" ORANGEBURG WITH 4" HDPE

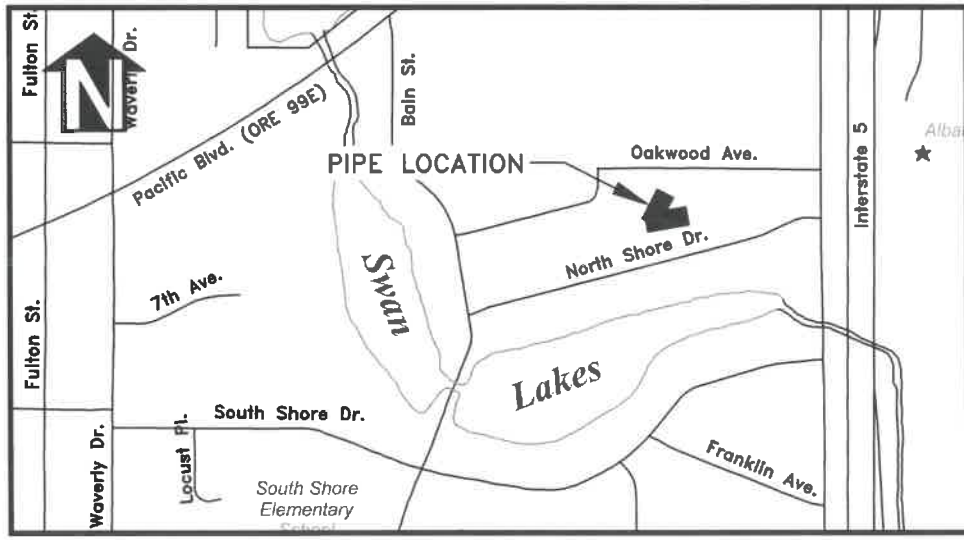

VICINITY MAP

**PUBLIC WORKS DEPARTMENT
 ENGINEERING SERVICES**



EXPIRES: 06/30/2022
 SHEET NO. 8 OF 15
 PROJECT NO: SS-21-01
 FILE: BASE.DWG

**SS-21-01, 2021 PIPE BURSTING PROJECTS
 PIPE ID 5444 AND 5447**

INTERSTATE 5

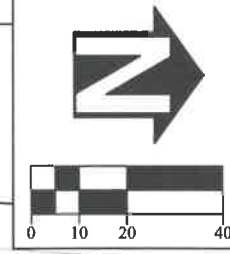

DOWNSTREAM MH 1141230400
 RIM = 218.99 (APPROX)
 IE 8" CONC. (N) = 211.39 (APPROX)

REPLACE 4' OF 8" CONCRETE SEWER MAIN WITH 8" PVC. REPAIR AREA IS APPROXIMATELY 356' FROM DOWNSTREAM MANHOLE. EXISTING MAINLINE IS APPROXIMATELY 9' DEEP. PROTECT EXISTING 1" HDPE WATER SERVICE AND GAS LINE DURING CONSTRUCTION.

UPSTREAM MH 1130430080
 RIM = 221.57 (APPROX)
 IE 8" CONC. (S) = 212.97 (APPROX)

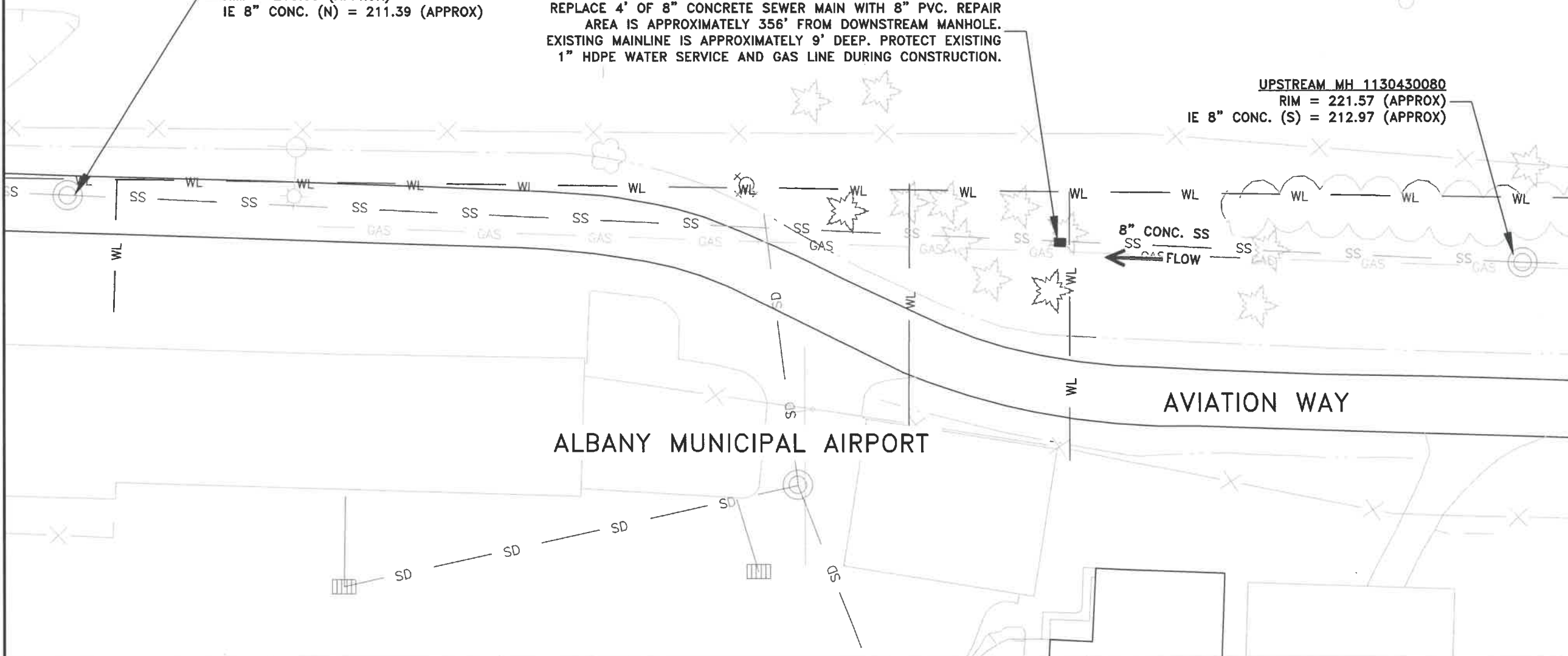

DESIGNED: L. SCHUMACHER	REVISIONS
DRAWN: L. SCHUMACHER	NO: BY:
CHECKED: C. CERKLEWSKI	DATE:
DATE: 2/15/2021	

PUBLIC WORKS DEPARTMENT
ENGINEERING SERVICES



SS-21-01, 2021 PIPE BURSTING PROJECTS
 PIPE ID 5436

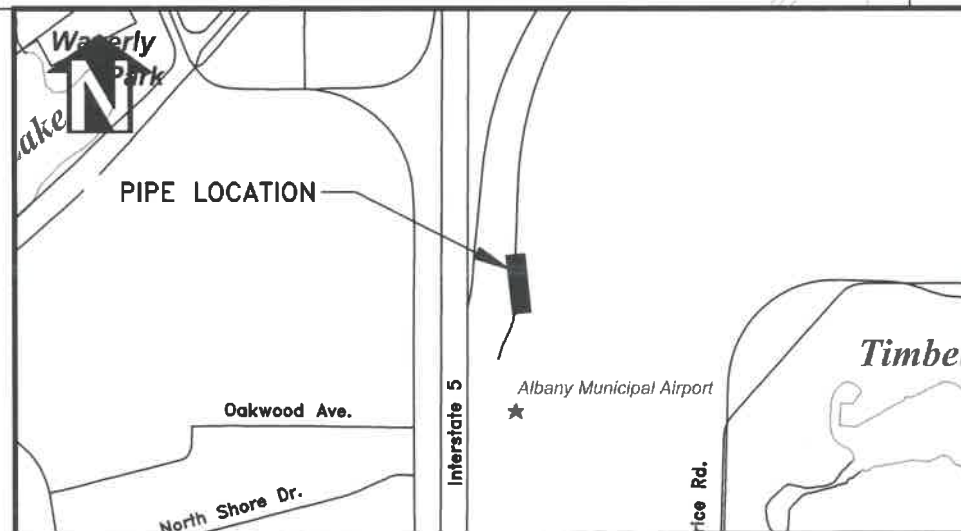

VICINITY MAP



EXPIRES: 06/30/2022
 SHEET NO. 9 OF 15
 PROJECT NO: SS-21-01
 FILE: BASE.DWG

MH 1130830410
 CONNECT NEW 10" PVC THROUGH EXISTING SOUTH PENETRATION. RECHANNEL MANHOLE AFTER COMPLETION OF ALL PIPE WORK. MANHOLE LOCATED AT BASE OF LARGE TREE STUMP.
 EX RIM = 230.26
 NEW 12" HDPE (E) = 216.81
 NEW 10" PVC (S) = 216.81

DOWNSTREAM MH 1130830420
 CONNECT NEW 10" PVC THROUGH EXISTING NORTH PENETRATION. CONSTRUCT 6" DROP OUTSIDE OF MANHOLE (S). CONNECT BOTTOM 6" PVC TO EXISTING 8" PENETRATION. FILL ANNULAR SPACE WITH NON-SHRINK GROUT. RECHANNEL MANHOLE AFTER COMPLETION OF ALL PIPE WORK.
 EX RIM = 231.29
 NEW 6" PVC (S) TOP CONNECTION = 225.00 (APPROX)
 NEW 6" PVC (S) DROP CONNECTION = 216.87
 NEW 10" PVC (N) = 216.83
 EX 12" HDPE (W) = 216.83

REMOVE SMALL TREE STUMPS AS NEEDED TO CONSTRUCT NEW 6" PVC SEWER LATERAL.

CONSTRUCT 6" PVC SEWER LATERAL. S=0.020 MIN.

AFTER ACCEPTANCE OF NEW 6" PVC SEWER LATERAL AND DROP MANHOLE CONNECTION, ABANDON APPROXIMATELY 115' OF 8" SEWER MAIN WITH FLOWABLE CDF. SEE SPECIAL PROVISIONS.

UPSTREAM DEAD END 1130830340CO
 DEPTH = 12' (APPROX).

REMOVE LARGE TREE STUMP NEXT TO MANHOLE 1130830410 AS NEEDED TO CONSTRUCT IMPROVEMENTS.

PIPE BURST 145' OF 8" SEWER MAIN WITH 12" HDPE

PIPE ID 139268

REMOVE EXISTING 8" CONCRETE SEWER MAIN AND OPEN TRENCH NEW 10" PVC SEWER MAIN, IN SAME LOCATION AT S=0.000.
 EX S = 0.005 (REVERSE GRADE)

CONNECT TO EXISTING 4" PVC SEWER LATERAL UPSTREAM OF VERTICAL BREAK WITH 6"X4" PVC REDUCER. INSTALL 6" 45° PVC BENDS AND 6" CLEANOUT AS SHOWN. EXISTING 4" LATERAL IS APPROXIMATELY 3' DEEP UPSTREAM OF VERTICAL BREAK.

UPSTREAM MH 1130830405
 DEPTH = 13.57'
 CONNECT TO AND RECHANNEL EXISTING MANHOLE.

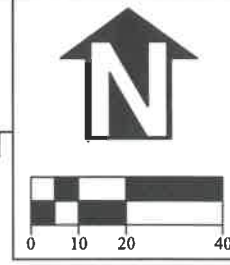

DESIGNED: L. SCHUMACHER	REVISIONS
DRAWN: L. SCHUMACHER	NO:
CHECKED: C. CERKLEWSKI	DATE:
DATE: 2/15/2021	

WL 18TH AVE WL

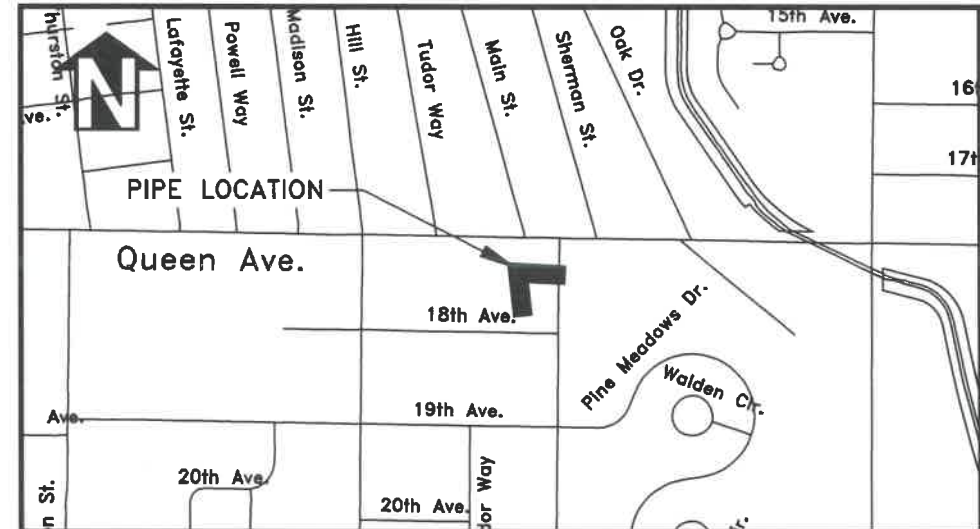

VICINITY MAP

EXISTING PIPE SEGMENT SUMMARY	
PIPE ID	139268
PIPE DIAMETER AND MATERIAL	8" CONC.
UPSTREAM MH ID	1130830405
DOWNSTREAM MH ID	1130830410
TOTAL LENGTH (FT)	145
TOTAL NUMBER OF CONNECTED LATERALS	0

PUBLIC WORKS DEPARTMENT
 ENGINEERING SERVICES



SS-21-01, 2021 PIPE BURSTING PROJECTS
 PIPE ID 6441, 6442 AND 139268



EXPIRES: 06/30/2022
 SHEET NO. 10 OF 15
 PROJECT NO: SS-21-01
 FILE: BASE.DWG

UPSTREAM CLEANOUT 1130830250CO
 DEPTH = 13.0' (APPROX)
 REMOVE EXISTING MAINLINE CLEANOUT AND INSTALL
 STANDARD 24" MINI-MANHOLE CLEANOUT. SEE
 STANDARD DRAWING NO. 416. ACCESS TOP END
 STRUCTURE FROM 2010 MAIN ST SE.

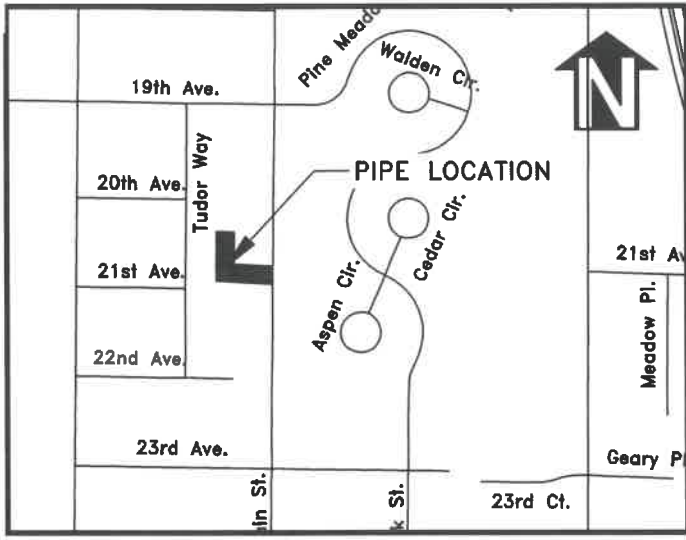
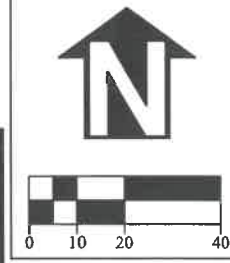

**6435 MATERIAL CHANGE SUMMARY
 STARTING FROM DOWNSTREAM MH
 1130830240**

FOOTAGE	DESCRIPTION
74'-82'	(3) PVC MAINLINE TEES

EXISTING PIPE SEGMENT SUMMARY

PIPE ID	6435
PIPE DIAMETER AND MATERIAL	8" CONC.
UPSTREAM MH ID	1130830250CO
DOWNSTREAM MH ID	1130830240
TOTAL LENGTH (FT)	82
TOTAL NUMBER OF CONNECTED LATERALS	5
TOTAL NUMBER OF PIPE BURST LATERAL REPLACEMENTS	2

EXISTING PIPE SEGMENT SUMMARY

PIPE ID	6431
PIPE DIAMETER AND MATERIAL	8" CONC.
UPSTREAM MH ID	1130830230
DOWNSTREAM MH ID	1130830240
TOTAL LENGTH (FT)	50
TOTAL NUMBER OF CONNECTED LATERALS	2
TOTAL NUMBER OF PIPE BURST LATERAL REPLACEMENTS	1

EXISTING PIPE SEGMENT SUMMARY

PIPE ID	7381
PIPE DIAMETER AND MATERIAL	8" CONC.
UPSTREAM MH ID	1130830910
DOWNSTREAM MH ID	1130830230
TOTAL LENGTH (FT)	155
TOTAL NUMBER OF CONNECTED LATERALS	1

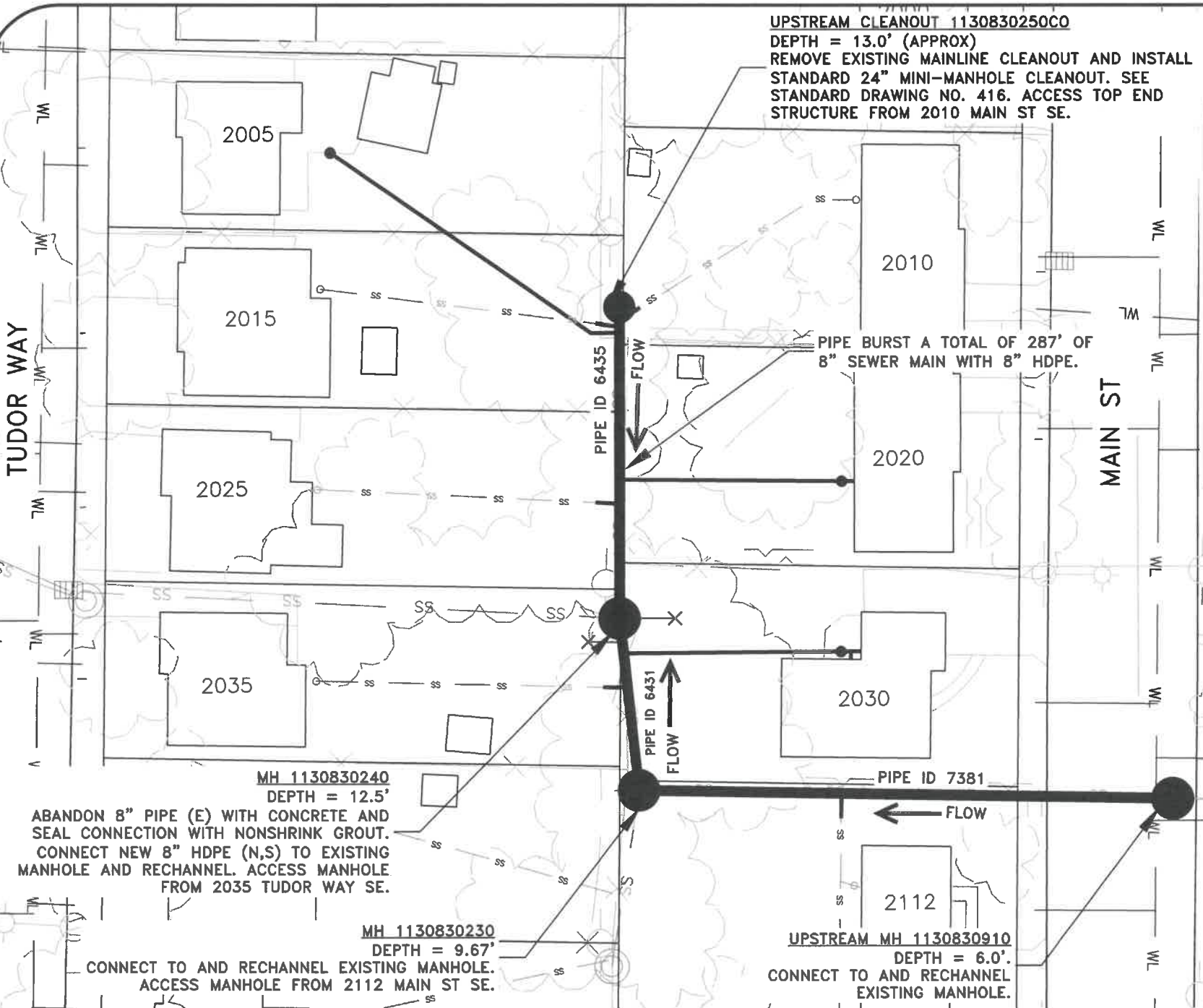

MH 1130830240
 DEPTH = 12.5'
 ABANDON 8" PIPE (E) WITH CONCRETE AND
 SEAL CONNECTION WITH NONSHRINK GROUT.
 CONNECT NEW 8" HDPE (N,S) TO EXISTING
 MANHOLE AND RECHANNEL. ACCESS MANHOLE
 FROM 2035 TUDOR WAY SE.

MH 1130830230
 DEPTH = 9.67'
 CONNECT TO AND RECHANNEL EXISTING MANHOLE.
 ACCESS MANHOLE FROM 2112 MAIN ST SE.

UPSTREAM MH 1130830910
 DEPTH = 6.0'.
 CONNECT TO AND RECHANNEL
 EXISTING MANHOLE.

6435 LATERAL SUMMARY STARTING FROM DOWNSTREAM MH 1130830240

FOOTAGE	ACTION	PROPERTY SERVED	PRIVATE SEWER LATERAL CONSTRUCTION NOTES
24.4'L	RECONNECT	2025 TUDOR WAY SE	RECONNECT 4" ABS LATERAL AS SPECIFIED
30.1'R	RECONNECT	2020 MAIN ST SE	PIPE BURST 4" ORANGEBURG LATERAL WITH 4" HDPE
77.9'L	RECONNECT	2005 TUDOR WAY SE	PIPE BURST 4" ORANGEBURG LATERAL WITH 4" HDPE
79.8'L	RECONNECT	2015 TUDOR WAY SE	RECONNECT 4" PVC LATERAL AS SPECIFIED
80.9'R	RECONNECT	2010 MAIN ST SE	RECONNECT 4" PVC LATERAL AS SPECIFIED

6431 LATERAL SUMMARY STARTING FROM UPSTREAM MH 1130830240

FOOTAGE	ACTION	PROPERTY SERVED	PRIVATE SEWER LATERAL CONSTRUCTION NOTES
30.0'L	RECONNECT	2035 TUDOR WAY SE	RECONNECT 4" HDPE LATERAL AS SPECIFIED
40.0'R	RECONNECT	2030 MAIN ST SE	PIPE BURST 4" ORANGEBURG LATERAL WITH 4" HDPE
43.3'L	ABANDON	-	-

7381 LATERAL SUMMARY STARTING FROM UPSTREAM MH 1130830910

FOOTAGE	ACTION	PROPERTY SERVED	PRIVATE SEWER LATERAL CONSTRUCTION NOTES
95.7'L	RECONNECT	2112 MAIN ST SE	RECONNECT 4" ABS LATERAL AS SPECIFIED

DESIGNED: L. SCHUMACHER
 DRAWN: L. SCHUMACHER
 CHECKED: C. CERKLEWSKI
 DATE: 2/15/2021

REVISIONS	BY:
NO:	---
DATE:	---

**PUBLIC WORKS DEPARTMENT
 ENGINEERING SERVICES**

**SS-21-01, 2021 PIPE BURSTING PROJECTS
 PIPE ID 6435, 6431 AND 7381**

REGISTERED PROFESSIONAL
 ENGINEER
 85930PE
Lori L. Schumacher
 OREGON
 MARCH 13, 2018
 LORI L. SCHUMACHER
 EXPIRES: 06/30/2022

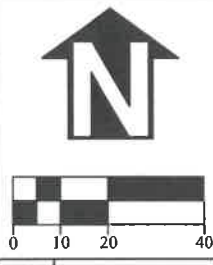
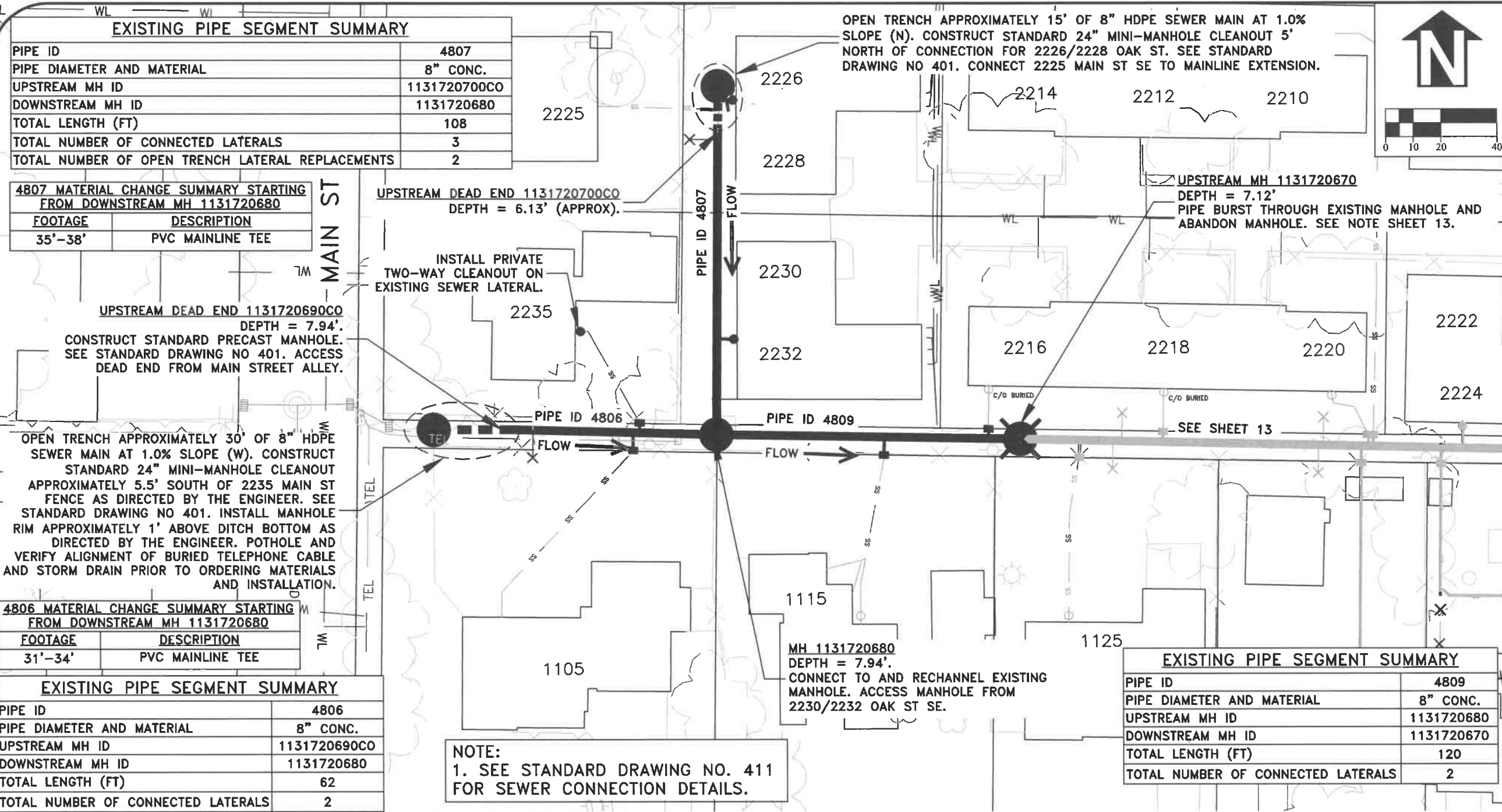

EXISTING PIPE SEGMENT SUMMARY

PIPE ID	4807
PIPE DIAMETER AND MATERIAL	8" CONC.
UPSTREAM MH ID	1131720700CO
DOWNSTREAM MH ID	1131720680
TOTAL LENGTH (FT)	108
TOTAL NUMBER OF CONNECTED LATERALS	3
TOTAL NUMBER OF OPEN TRENCH LATERAL REPLACEMENTS	2

4807 MATERIAL CHANGE SUMMARY STARTING FROM DOWNSTREAM MH 1131720680

FOOTAGE	DESCRIPTION
35'-38'	PVC MAINLINE TEE

UPSTREAM DEAD END 1131720690CO DEPTH = 7.94'.
CONSTRUCT STANDARD PRECAST MANHOLE. SEE STANDARD DRAWING NO 401. ACCESS DEAD END FROM MAIN STREET ALLEY.

OPEN TRENCH APPROXIMATELY 30' OF 8" HDPE SEWER MAIN AT 1.0% SLOPE (W). CONSTRUCT STANDARD 24" MINI-MANHOLE CLEANOUT APPROXIMATELY 5.5' SOUTH OF 2235 MAIN ST FENCE AS DIRECTED BY THE ENGINEER. SEE STANDARD DRAWING NO 401. INSTALL MANHOLE RIM APPROXIMATELY 1' ABOVE DITCH BOTTOM AS DIRECTED BY THE ENGINEER. POTHOLE AND VERIFY ALIGNMENT OF BURIED TELEPHONE CABLE AND STORM DRAIN PRIOR TO ORDERING MATERIALS AND INSTALLATION.

4806 MATERIAL CHANGE SUMMARY STARTING FROM DOWNSTREAM MH 1131720680

FOOTAGE	DESCRIPTION
31'-34'	PVC MAINLINE TEE

EXISTING PIPE SEGMENT SUMMARY

PIPE ID	4806
PIPE DIAMETER AND MATERIAL	8" CONC.
UPSTREAM MH ID	1131720690CO
DOWNSTREAM MH ID	1131720680
TOTAL LENGTH (FT)	62
TOTAL NUMBER OF CONNECTED LATERALS	2

UPSTREAM DEAD END 1131720700CO DEPTH = 6.13' (APPROX).

INSTALL PRIVATE TWO-WAY CLEANOUT ON EXISTING SEWER LATERAL.

UPSTREAM DEAD END 1131720690CO DEPTH = 7.94'.
CONSTRUCT STANDARD PRECAST MANHOLE. SEE STANDARD DRAWING NO 401. ACCESS DEAD END FROM MAIN STREET ALLEY.

UPSTREAM MH 1131720670 DEPTH = 7.12'.
PIPE BURST THROUGH EXISTING MANHOLE AND ABANDON MANHOLE. SEE NOTE SHEET 13.

UPSTREAM MH 1131720680 DEPTH = 7.94'.
CONNECT TO AND RECHANNEL EXISTING MANHOLE. ACCESS MANHOLE FROM 2230/2232 OAK ST SE.

SEE SHEET 13

EXISTING PIPE SEGMENT SUMMARY

PIPE ID	4809
PIPE DIAMETER AND MATERIAL	8" CONC.
UPSTREAM MH ID	1131720680
DOWNSTREAM MH ID	1131720670
TOTAL LENGTH (FT)	120
TOTAL NUMBER OF CONNECTED LATERALS	2

NOTE:
1. SEE STANDARD DRAWING NO. 411 FOR SEWER CONNECTION DETAILS.

DESIGNED: L. SCHUMACHER
DRAWN: L. SCHUMACHER
CHECKED: C. CERKLEWSKI
DATE: 2/15/2021

REVISIONS	BY:
NO:	---
DATE:	---

**PUBLIC WORKS DEPARTMENT
ENGINEERING SERVICES**



**SS-21-01, 2021 PIPE BURSTING PROJECTS
PIPE ID 4806, 4807 AND 4809**

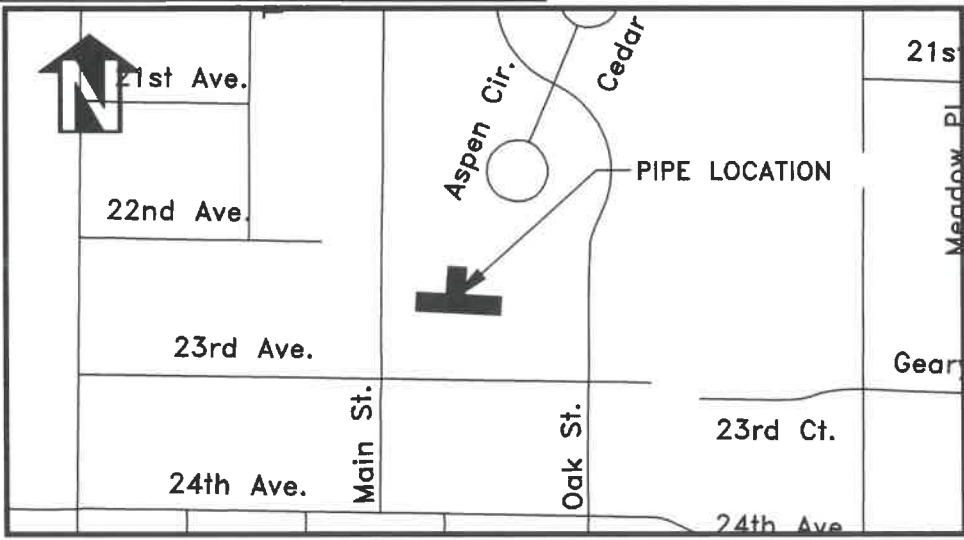

4806 LATERAL SUMMARY STARTING FROM DOWNSTREAM MH 1131720680

FOOTAGE	ACTION	PROPERTY SERVED	PRIVATE SEWER LATERAL CONSTRUCTION NOTES
27.7'R	RECONNECT	2235 MAIN ST SE	RECONNECT 4" ABS LATERAL AS SPECIFIED
31.0'L	RECONNECT	1105 23RD AVE SE	RECONNECT 4" ABS LATERAL AS SPECIFIED
70.4'L	ABANDON	-	-

4807 LATERAL SUMMARY STARTING FROM DOWNSTREAM MH 1131720670

FOOTAGE	ACTION	PROPERTY SERVED	PRIVATE SEWER LATERAL CONSTRUCTION NOTES
37.0'L	RECONNECT	2230/2232 OAK ST SE	OPEN TRENCH NEW 4" PVC LATERAL
105.8'L	ABANDON (VERIFY)	-	CONTRACTOR TO VERIFY PRIOR TO ABANDONMENT
108.6'T	RELOCATE	2226/2228 OAK ST SE & 2225 MAIN ST SE	SEPARATE AND RELOCATE CONNECTIONS TO MAINLINE EXTENSION

4809 LATERAL SUMMARY STARTING FROM DOWNSTREAM MH 1131720670

FOOTAGE	ACTION	PROPERTY SERVED	PRIVATE SEWER LATERAL CONSTRUCTION NOTES
11.5'R	RECONNECT	2216 OAK ST SE	RECONNECT 4" CAST IRON LATERAL AS SPECIFIED
49.4'L	RECONNECT	1115 23RD AVE SE	RECONNECT 4" ABS LATERAL AS SPECIFIED

REGISTERED PROFESSIONAL
ENGINEER
85930PE
Lori L. Schumacher
OREGON
MARCH 13, 2018
LORI L. SCHUMACHER

EXPIRES: 06/30/2022

EXISTING PIPE SEGMENT SUMMARY	
PIPE ID	4804
PIPE DIAMETER AND MATERIAL	8" CONC.
UPSTREAM MH ID	1131720660
DOWNSTREAM MH ID	1131720640
TOTAL LENGTH (FT)	171
TOTAL NUMBER OF CONNECTED LATERALS	3

NOTES:
 1. ALL WORK THIS SHEET MUST BE COMPLETED BY JUNE 21, 2021.
 2. MAINLINE BURSTING PIT AT DOWNSTREAM MANHOLE 1131720640 SHALL BE BACKFILLED WITH SELECT BACKFILL AND TEMPORARILY PATCHED WITH 2" WARM MIX ASPHALT. CURB AND GUTTER AND PERMANENT ASPHALT TO BE INSTALLED BY OTHERS.
 3. SEE STANDARD DRAWING NO. 411 FOR SEWER LATERAL CONNECTION DETAILS.

UPSTREAM MANHOLE 1131720660
 DEPTH = 4.82'.
 CONNECT TO EXISTING 8" PVC WITH HDPE/C900 TRANSITION COUPLER.

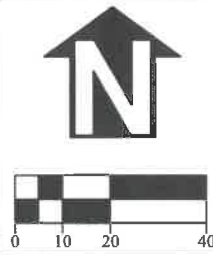

EXISTING PIPE SEGMENT SUMMARY	
PIPE ID	4808
PIPE DIAMETER AND MATERIAL	8" CONC.
UPSTREAM MH ID	1131720670
DOWNSTREAM MH ID	1131720640
TOTAL LENGTH (FT)	261
TOTAL NUMBER OF CONNECTED LATERALS	7
TOTAL NUMBER OF PIPE BURST LATERAL REPLACEMENTS	2
TOTAL NUMBER OF OPEN TRENCH LATERALS	1

4808 MATERIAL CHANGE SUMMARY STARTING FROM DOWNSTREAM MH 1131720640	
FOOTAGE	DESCRIPTION
108'-112'	PVC MAINLINE TEE
209'-213'	PVC MAINLINE TEE
238'-241'	PVC MAINLINE TEE

SEE SHEET 12

PIPE BURST A TOTAL OF 395' OF 8" SEWER MAIN WITH 8" HDPE.

UPSTREAM MH 1131720670
 DEPTH = 7.12'
 PIPE BURST THROUGH EXISTING MANHOLE. ABANDON MANHOLE BY REMOVING CONE SECTION AND FILLING BARREL SECTION WITH 1-INCH MINUS SELECT BACKFILL TO WITHIN 18" OF FINISHED GRADE. BACKFILL REMAINING EXCAVATION WITH TOPSOIL. ACCESS MANHOLE FROM 2216 OAK ST SE TRIPLEX.

PROPERTY OWNER HAS REFUSED CONTRACTOR/CITY ACCESS TO PROPERTY

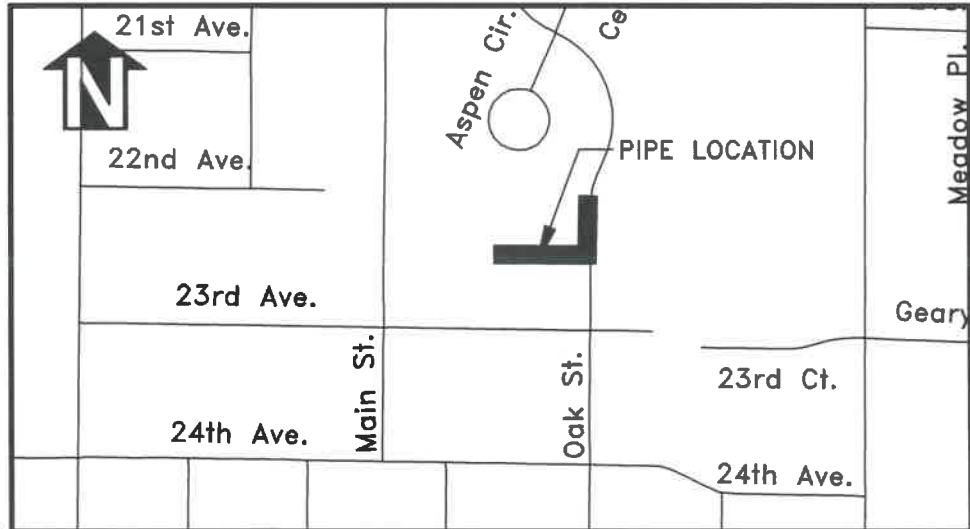

VICINITY MAP

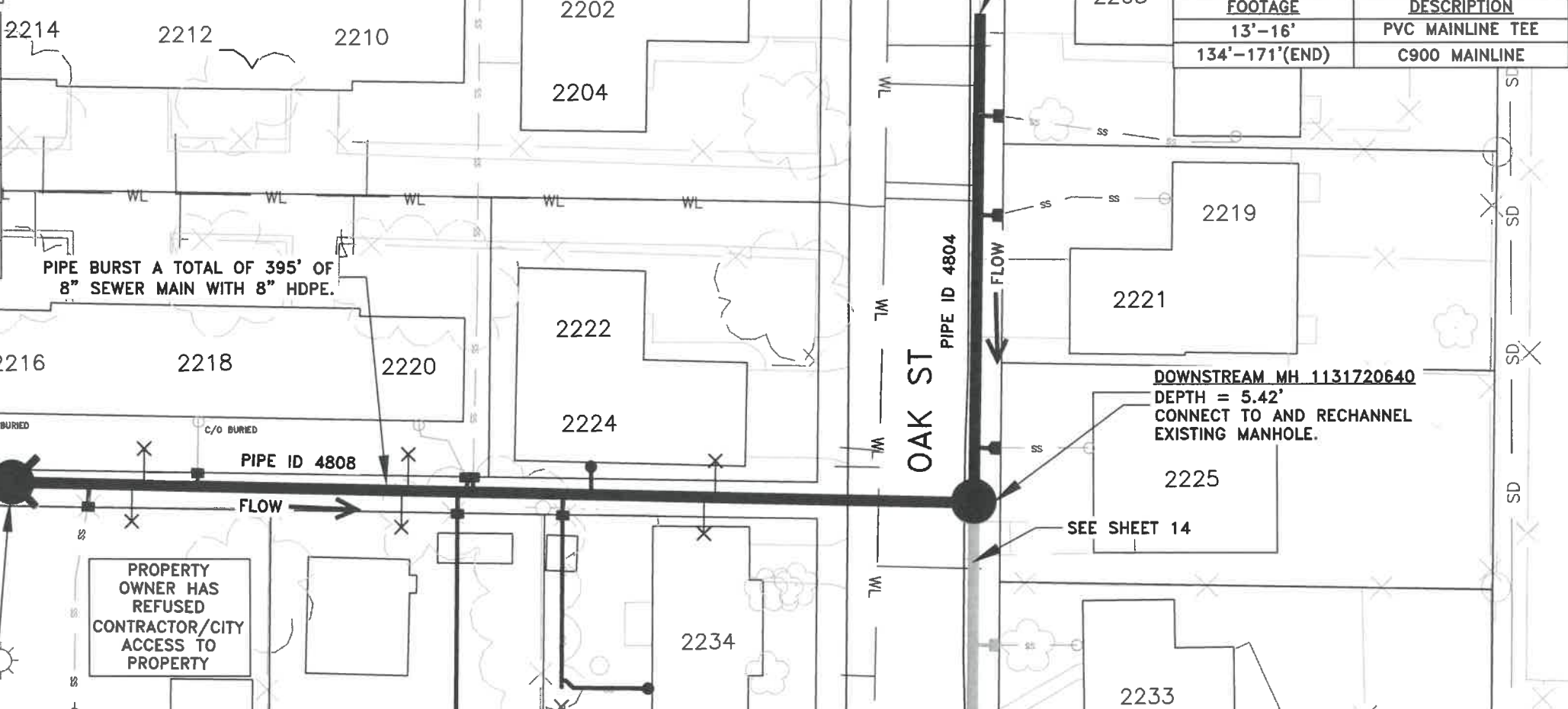

4804 MATERIAL CHANGE SUMMARY STARTING FROM DOWNSTREAM MH 1131720640	
FOOTAGE	DESCRIPTION
13'-16'	PVC MAINLINE TEE
134'-171'(END)	C900 MAINLINE

DOWNSTREAM MH 1131720640
 DEPTH = 5.42'
 CONNECT TO AND RECHANNEL EXISTING MANHOLE.

SEE SHEET 14

4804 LATERAL SUMMARY STARTING FROM DOWNSTREAM MH 1131720640			
FOOTAGE	ACTION	PROPERTY SERVED	PRIVATE SEWER LATERAL CONSTRUCTION NOTES
15.0'R	RECONNECT	2225 OAK ST SE	RECONNECT 4" PVC LATERAL AS SPECIFIED
78.8'R	RECONNECT	2221 OAK ST SE	RECONNECT 4" AC LATERAL AS SPECIFIED
106.7'R	RECONNECT	2205 OAK ST SE	RECONNECT 4" PVC LATERAL AS SPECIFIED

4808 LATERAL SUMMARY STARTING FROM DOWNSTREAM MH 1131720640			
FOOTAGE	ACTION	PROPERTY SERVED	PRIVATE SEWER LATERAL CONSTRUCTION NOTES
74.6'R	ABANDON	-	-
77.7'L	ABANDON	-	-
110.3'R	RECONNECT	2224/2222 OAK ST SE	RECONNECT 4" PVC LATERAL AS SPECIFIED
114.5'L	RECONNECT	2234 OAK/1159 23RD	AFTER ACCEPTANCE OF NEW LATERAL SERVING 1159 23RD AVE, PIPE BURST 2234 OAK ST LATERAL. SEE SHEET 14 FOR DETAILS ON 1159 23RD LATERAL.
137.4'T	RECONNECT	2202 & 2214 OAK ST SE	RECONNECT 4" ABS LATERAL AS SPECIFIED
138.9'R	RECONNECT	2220 OAK ST SE	RECONNECT 4" ABS LATERAL AS SPECIFIED
145.6'L	RECONNECT	1149 23RD AVE SE	PIPE BURST 4" ORANGEBURG WITH 4" HDPE
155.0'R	ABANDON	-	-
156.8'L	ABANDON	-	-
212.8'R	RECONNECT	2218 OAK ST SE	RECONNECT 4" PVC/CAST LATERAL AS SPECIFIED
227.4'R	ABANDON	-	-
230.7'L	ABANDON	-	-
242.3'L	RECONNECT	1125 23RD AVE SE	RECONNECT 4" PVC/HDPE LATERAL AS SPECIFIED

DESIGNED: L. SCHUMACHER	REVISIONS
DRAWN: L. SCHUMACHER	NO: BY:
CHECKED: C. CERKLEWSKI	DATE:
DATE: 2/15/2021	

**PUBLIC WORKS DEPARTMENT
ENGINEERING SERVICES**



**SS-21-01, 2021 PIPE BURSTING PROJECTS
PIPE ID 4808 AND 4804**



SHEET NO. 13 OF 15
 PROJECT NO: SS-21-01
 FILE: BASE.DWG

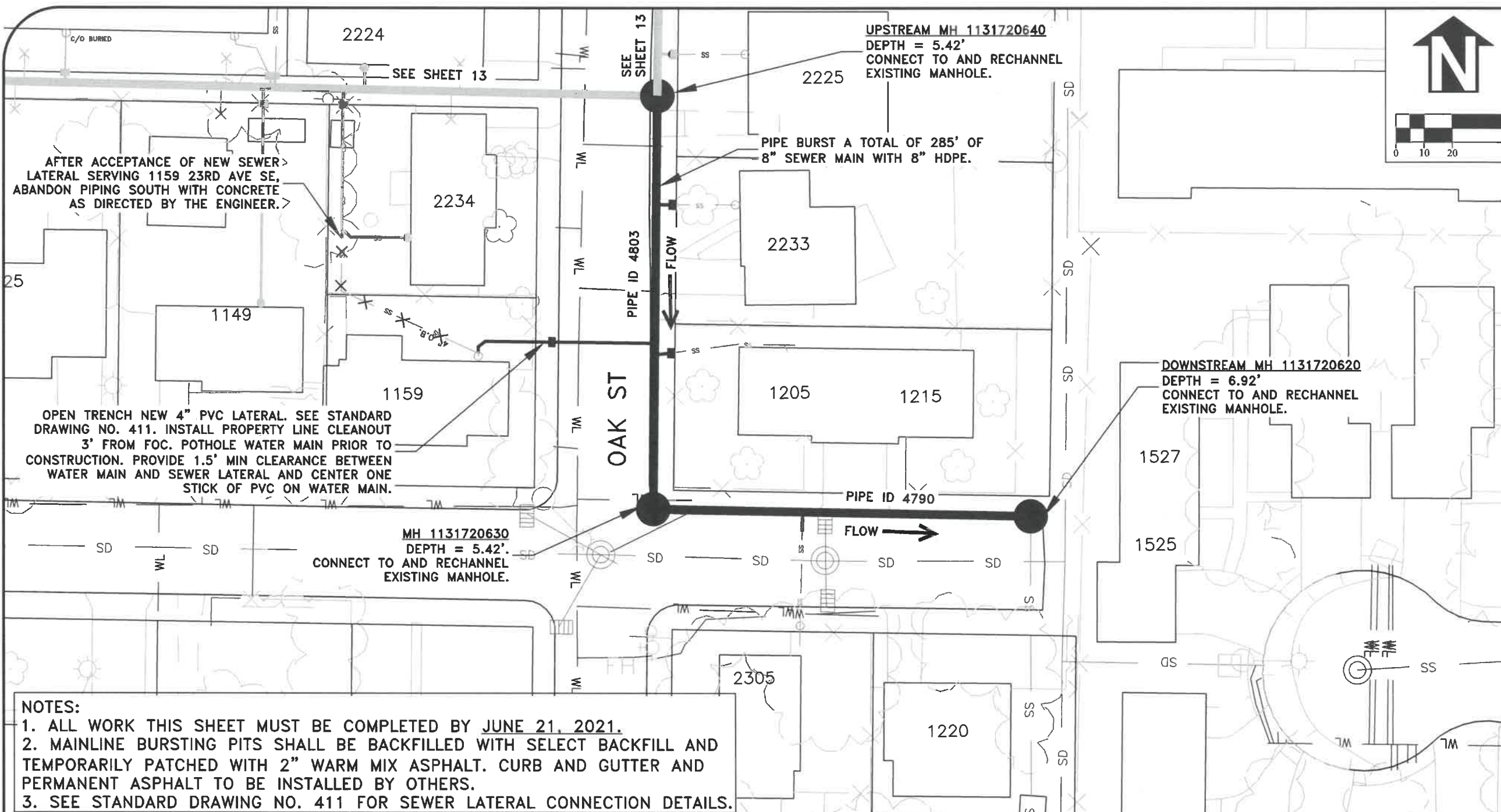

AFTER ACCEPTANCE OF NEW SEWER LATERAL SERVING 1159 23RD AVE SE, ABANDON PIPING SOUTH WITH CONCRETE AS DIRECTED BY THE ENGINEER.

OPEN TRENCH NEW 4" PVC LATERAL. SEE STANDARD DRAWING NO. 411. INSTALL PROPERTY LINE CLEANOUT 3' FROM FOC. POT HOLE WATER MAIN PRIOR TO CONSTRUCTION. PROVIDE 1.5' MIN CLEARANCE BETWEEN WATER MAIN AND SEWER LATERAL AND CENTER ONE STICK OF PVC ON WATER MAIN.

MH 1131720630
DEPTH = 5.42'
CONNECT TO AND RECHANNEL EXISTING MANHOLE.

UPSTREAM MH 1131720640
DEPTH = 5.42'
CONNECT TO AND RECHANNEL EXISTING MANHOLE.

PIPE BURST A TOTAL OF 285' OF 8" SEWER MAIN WITH 8" HDPE.

DOWNSTREAM MH 1131720620
DEPTH = 6.92'
CONNECT TO AND RECHANNEL EXISTING MANHOLE.

- NOTES:**
1. ALL WORK THIS SHEET MUST BE COMPLETED BY JUNE 21, 2021.
 2. MAINLINE BURSTING PITS SHALL BE BACKFILLED WITH SELECT BACKFILL AND TEMPORARILY PATCHED WITH 2" WARM MIX ASPHALT. CURB AND GUTTER AND PERMANENT ASPHALT TO BE INSTALLED BY OTHERS.
 3. SEE STANDARD DRAWING NO. 411 FOR SEWER LATERAL CONNECTION DETAILS.

DESIGNED: L. SCHUMACHER
DRAWN: L. SCHUMACHER
CHECKED: C. CERKLEWSKI
DATE: 2/15/2021

REVISIONS	
NO.	BY:

**PUBLIC WORKS DEPARTMENT
ENGINEERING SERVICES**

**SS-21-01, 2021 PIPE BURSTING PROJECTS
PIPE ID 4803 AND 4790**

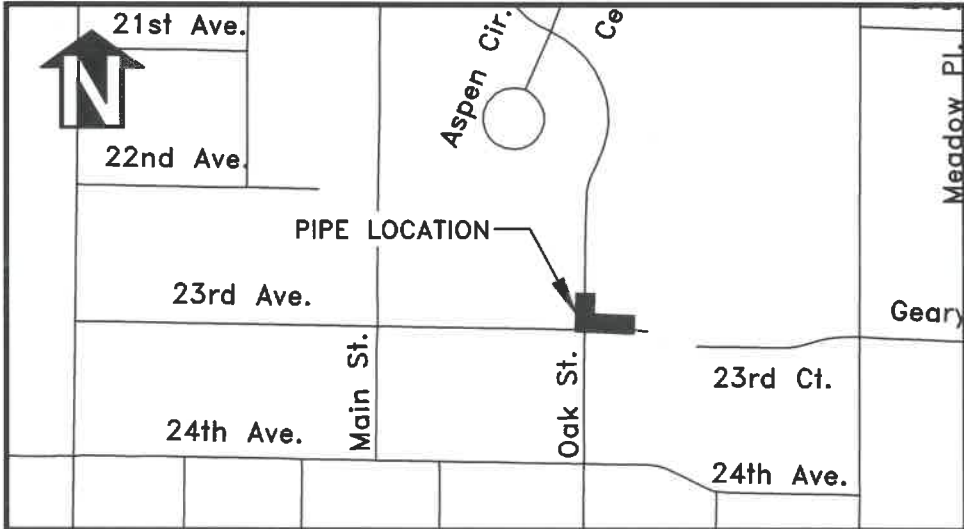
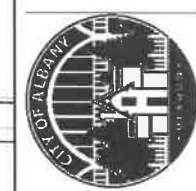

VICINITY MAP

EXISTING PIPE SEGMENT SUMMARY	
PIPE ID	4803
PIPE DIAMETER AND MATERIAL	8" CONC.
UPSTREAM MH ID	1131720640
DOWNSTREAM MH ID	1131720630
TOTAL LENGTH (FT)	150
TOTAL NUMBER OF CONNECTED LATERALS	2

EXISTING PIPE SEGMENT SUMMARY	
PIPE ID	4790
PIPE DIAMETER AND MATERIAL	8" CONC.
UPSTREAM MH ID	1131720630
DOWNSTREAM MH ID	1131720620
TOTAL LENGTH (FT)	135
TOTAL NUMBER OF CONNECTED LATERALS	1

4790 LATERAL SUMMARY STARTING FROM DOWNSTREAM MH 1131720620			
FOOTAGE	ACTION	PROPERTY SERVED	PRIVATE SEWER LATERAL CONSTRUCTION NOTES
81.6'R	RECONNECT	2305 OAK ST SE	RECONNECT 4" PVC LATERAL IN RIGHT OF WAY AS SPECIFIED

4803 LATERAL SUMMARY STARTING FROM DOWNSTREAM MH 1131720630			
FOOTAGE	ACTION	PROPERTY SERVED	PRIVATE SEWER LATERAL CONSTRUCTION NOTES
55.4'R	RECONNECT	2233 OAK ST SE	RECONNECT 4" ABS LATERAL IN RIGHT OF WAY AS SPECIFIED
108.4'R	RECONNECT	1215 23RD AVE SE	RECONNECT 4" CAST IRON LATERAL IN RIGHT OF WAY AS SPECIFIED



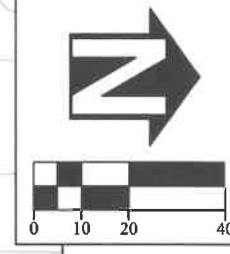
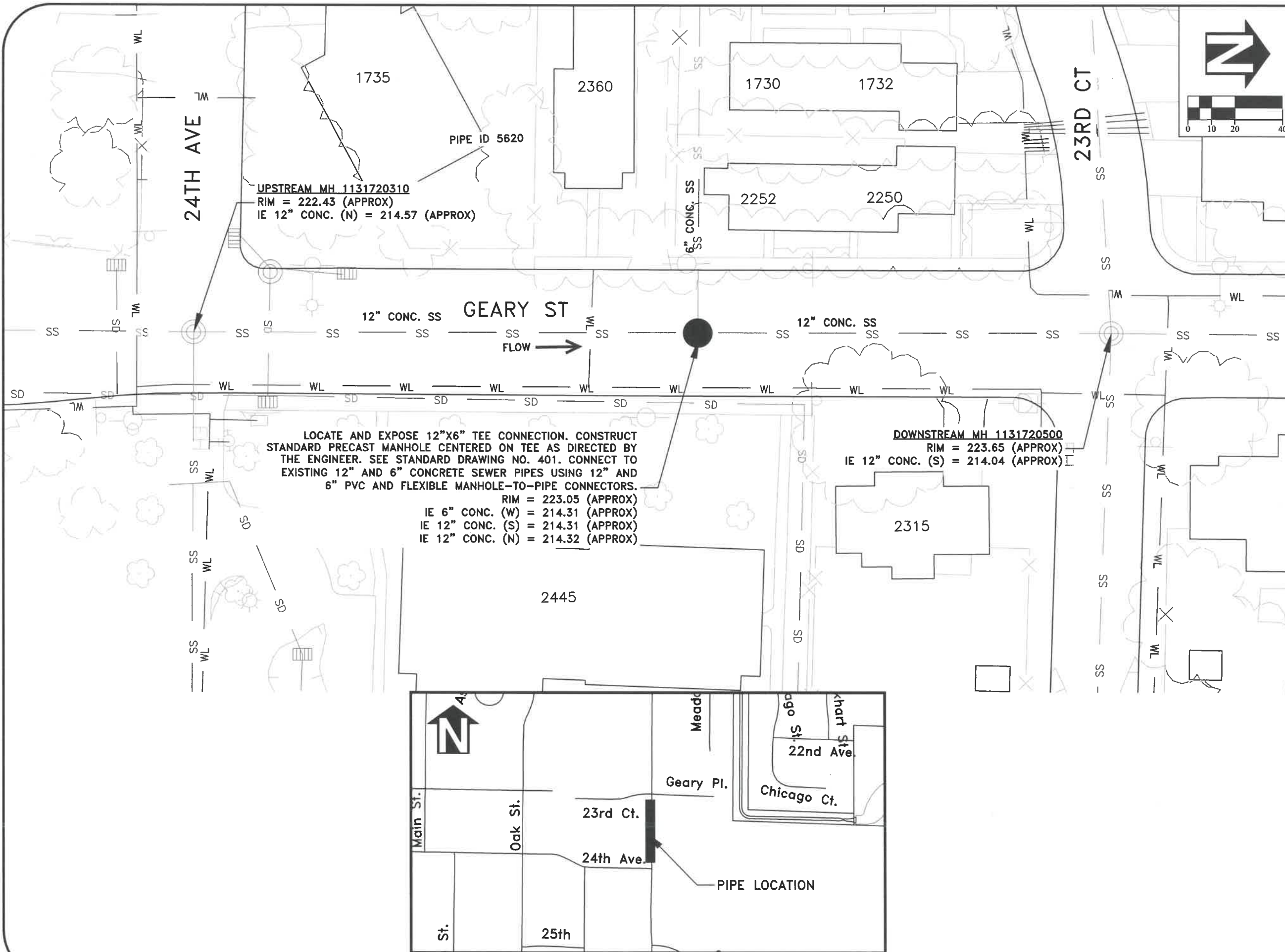

UPSTREAM MH 1131720310
 RIM = 222.43 (APPROX)
 IE 12" CONC. (N) = 214.57 (APPROX)

DOWNSTREAM MH 1131720500
 RIM = 223.65 (APPROX)
 IE 12" CONC. (S) = 214.04 (APPROX)

LOCATE AND EXPOSE 12"x6" TEE CONNECTION. CONSTRUCT STANDARD PRECAST MANHOLE CENTERED ON TEE AS DIRECTED BY THE ENGINEER. SEE STANDARD DRAWING NO. 401. CONNECT TO EXISTING 12" AND 6" CONCRETE SEWER PIPES USING 12" AND 6" PVC AND FLEXIBLE MANHOLE-TO-PIPE CONNECTORS.
 RIM = 223.05 (APPROX)
 IE 6" CONC. (W) = 214.31 (APPROX)
 IE 12" CONC. (S) = 214.31 (APPROX)
 IE 12" CONC. (N) = 214.32 (APPROX)

DESIGNED: L. SCHUMACHER
 DRAWN: L. SCHUMACHER
 CHECKED: C. CERKLEWSKI
 DATE: 2/15/2021

REVISIONS	
NO:	BY:

PUBLIC WORKS DEPARTMENT
ENGINEERING SERVICES

SS-21-01, 2021 PIPE BURSTING PROJECTS
 PIPE ID 4792

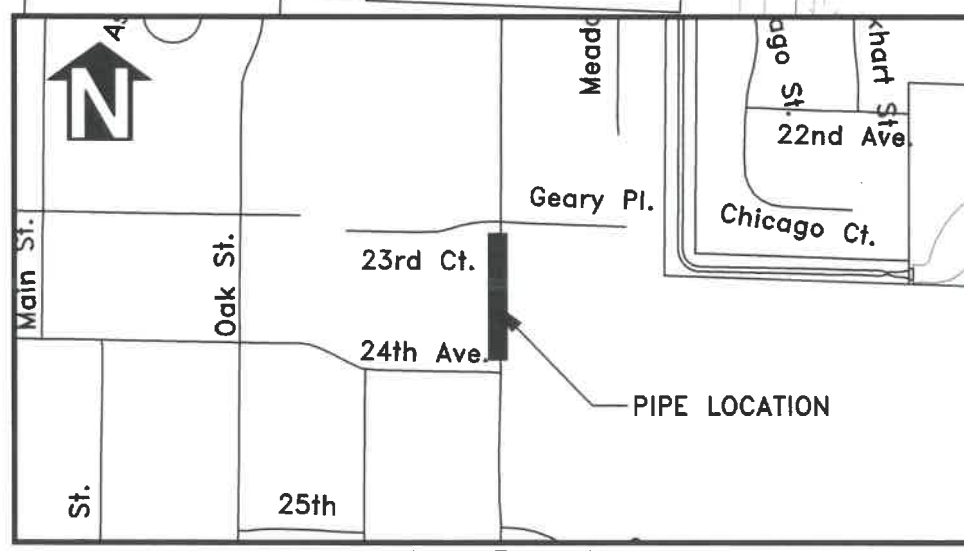
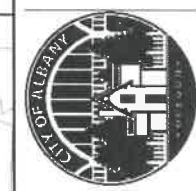

EXPIRES: 06/30/2022

SHEET NO. 15 OF 15
 PROJECT NO: SS-21-01
 FILE: BASE.DWG