







# CITY OF ALBANY

## ST-19-05, WAVERLY DRIVE SIDEWALK INFILL

### SHEET INDEX

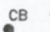
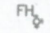
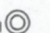
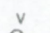
SHEET NO. 1,	COVER & GENERAL NOTES
SHEET NO. 2,	SIDEWALK CONSTRUCTION
SHEET NO. 3,	SIDEWALK CONSTRUCTION
SHEET NO. 4,	PEDESTRIAN CROSSING PLAN
SHEET NO. 5,	PEDESTRIAN CROSSING DETAIL

### LEGEND

	EXISTING TREE
	EXISTING STREET LIGHT
	EXISTING CATCH BASIN/CURB INLET
	EXISTING FIRE HYDRANT
	EXISTING MANHOLE
	EXISTING VALVE
	PEDESTRIAN CROSSING ASSEMBLY
	PROPOSED SIDEWALK
	PROPOSED DRIVEWAY APPROACH

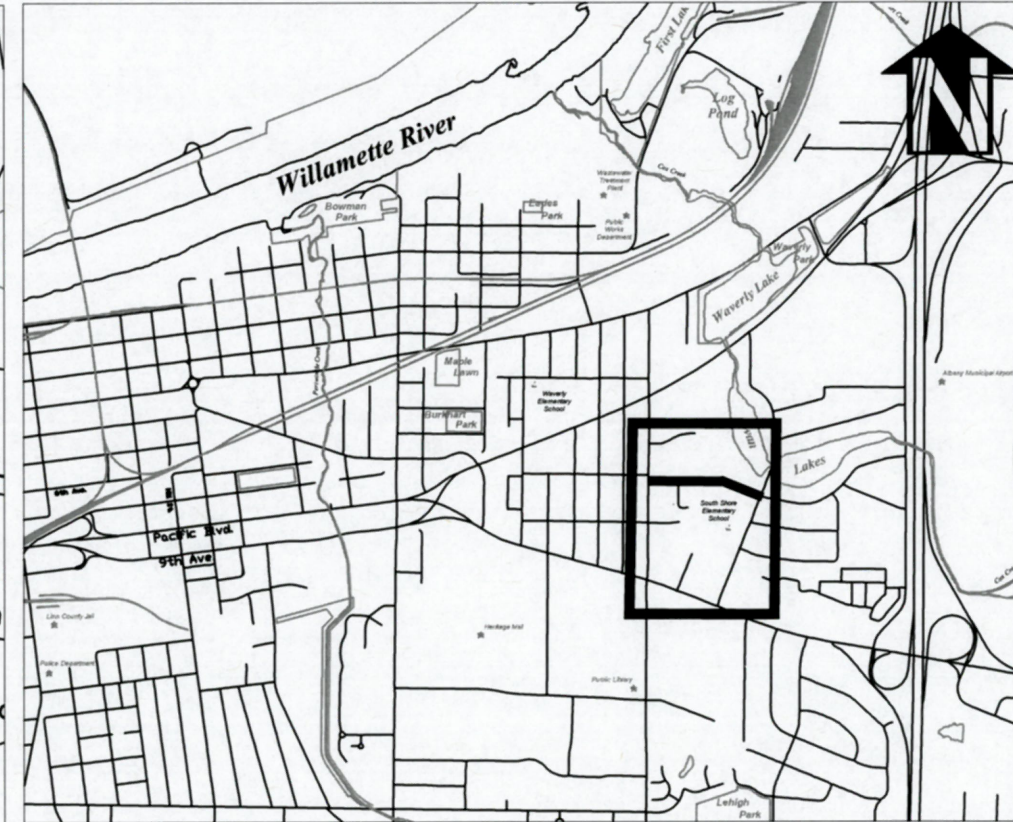

Vicinity Map  
Not to Scale

### GENERAL NOTES

1. ALL CONSTRUCTION SHALL CONFORM TO THE CITY OF ALBANY STANDARD CONSTRUCTION SPECIFICATIONS AND ASSOCIATED STANDARD DRAWINGS. THE CURRENT VERSION OF THE CITY OF ALBANY STANDARD CONSTRUCTION SPECIFICATIONS CAN BE FOUND ON THE CITY'S WEBSITE AT [WWW.CITYOFALBANY.NET](http://WWW.CITYOFALBANY.NET).
2. UTILITIES SHOWN ARE FOR REFERENCE ONLY. FOR A FIELD LOCATE, CALL THE UTILITIES NOTIFICATIONS CENTER AT 1-800-332-2344.
3. OPERATING ACCESS FOR CITY MAINTENANCE PERSONNEL TO EXISTING AND NEW WATER VALVES AND MANHOLES SHALL BE CONTINUOUSLY MAINTAINED BY THE CONTRACTOR DURING ALL CONSTRUCTION ACTIVITIES.
4. CONTRACTOR SHALL VERIFY ALL EXISTING PIPE ELEVATIONS, PIPE DIAMETERS, AND PIPE MATERIALS AT CONNECTION AND ABANDONMENT LOCATIONS PRIOR TO CONSTRUCTION. ANY DISCREPANCIES SHALL BE REPORTED TO ENGINEER PRIOR TO BEGINNING WORK.
5. ATTENTION: OREGON LAW REQUIRES YOU TO FOLLOW RULES ADOPTED BY THE OREGON UTILITY NOTIFICATION CENTER. THOSE RULES ARE SET FORTH IN OAR 952-001-0010 THROUGH OAR 952-001-0090. YOU MAY OBTAIN COPIES OF THE RULES BY CALLING THE CENTER. (NOTE: THE TELEPHONE NUMBER FOR THE OREGON UTILITY NOTIFICATION CENTER IS (503) 232-1987).
6. CONTRACTOR SHALL BE RESPONSIBLE FOR PROPER INSTALLATION AND MAINTENANCE OF ALL EROSION PREVENTION SEDIMENT CONTROL (EPSC) MEASURES IN ACCORDANCE WITH LOCAL, STATE, AND FEDERAL REGULATIONS UNTIL ALL CONSTRUCTION IS COMPLETED AND APPROVED BY THE CITY OF ALBANY, AND VEGETATION/LANDSCAPING IS ESTABLISHED. FOR GUIDANCE, REFER TO THE CITY OF ALBANY EPSC MANUAL WHICH CAN BE FOUND AT [www.cityofalbany.net](http://www.cityofalbany.net).
7. CONTRACTOR SHALL BE RESPONSIBLE FOR RELOCATING IRRIGATION LINES LOCATED IN THE RIGHT-OF-WAY TO PRIVATE PROPERTY.

DESIGNED: A. HIEMSTRA  
DRAWN: A. HIEMSTRA  
CHECKED: S. BELCASTRO  
DATE: 6/10/19

REVISIONS	
NO.	BY:

**PUBLIC WORKS DEPARTMENT**  
**ENGINEERING SERVICES**



**ST-19-05, WAVERLY DRIVE SIDEWALK INFILL**



EXPIRATION DATE: 06/30/2019

SHEET NO. 1 OF 5  
PROJECT NO: ST-19-05  
FILE: FILENAME.DWG



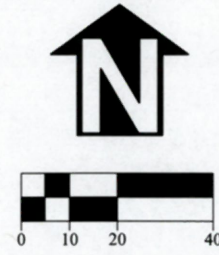
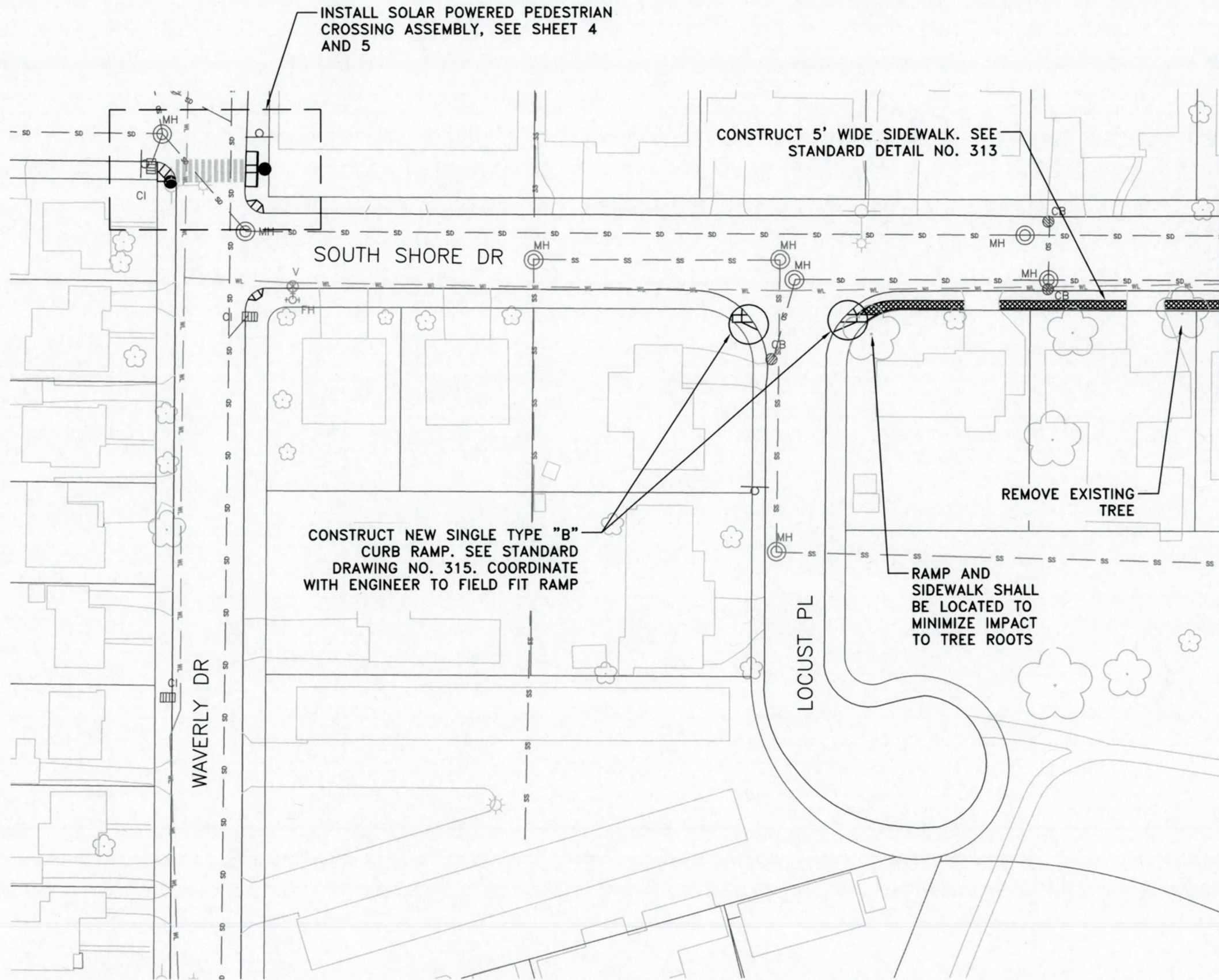

DESIGNED: A. HIEMSTRA	REVISIONS:
DRAWN: A. HIEMSTRA	NO: ---
CHECKED: S. BELCASTRO	BY: ---
DATE: 6/10/19	DATE: ---

**PUBLIC WORKS DEPARTMENT**  
**ENGINEERING SERVICES**



**ST-19-05, WAVERLY DRIVE SIDEWALK INFILL**  
**SIDEWALK CONSTRUCTION**

REGISTERED PROFESSIONAL  
ENGINEER  
90,524PE



OREGON  
JULY 14, 2015  
AARON KYLE HIEMSTRA

EXPIRATION DATE: 06/30/2019



CONSTRUCT 5' WIDE SIDEWALK. SEE STANARD DETAIL NO. 313

MATCHLINE SEE SHEET 2

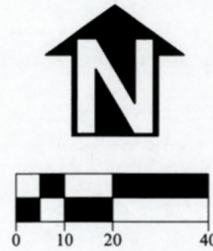
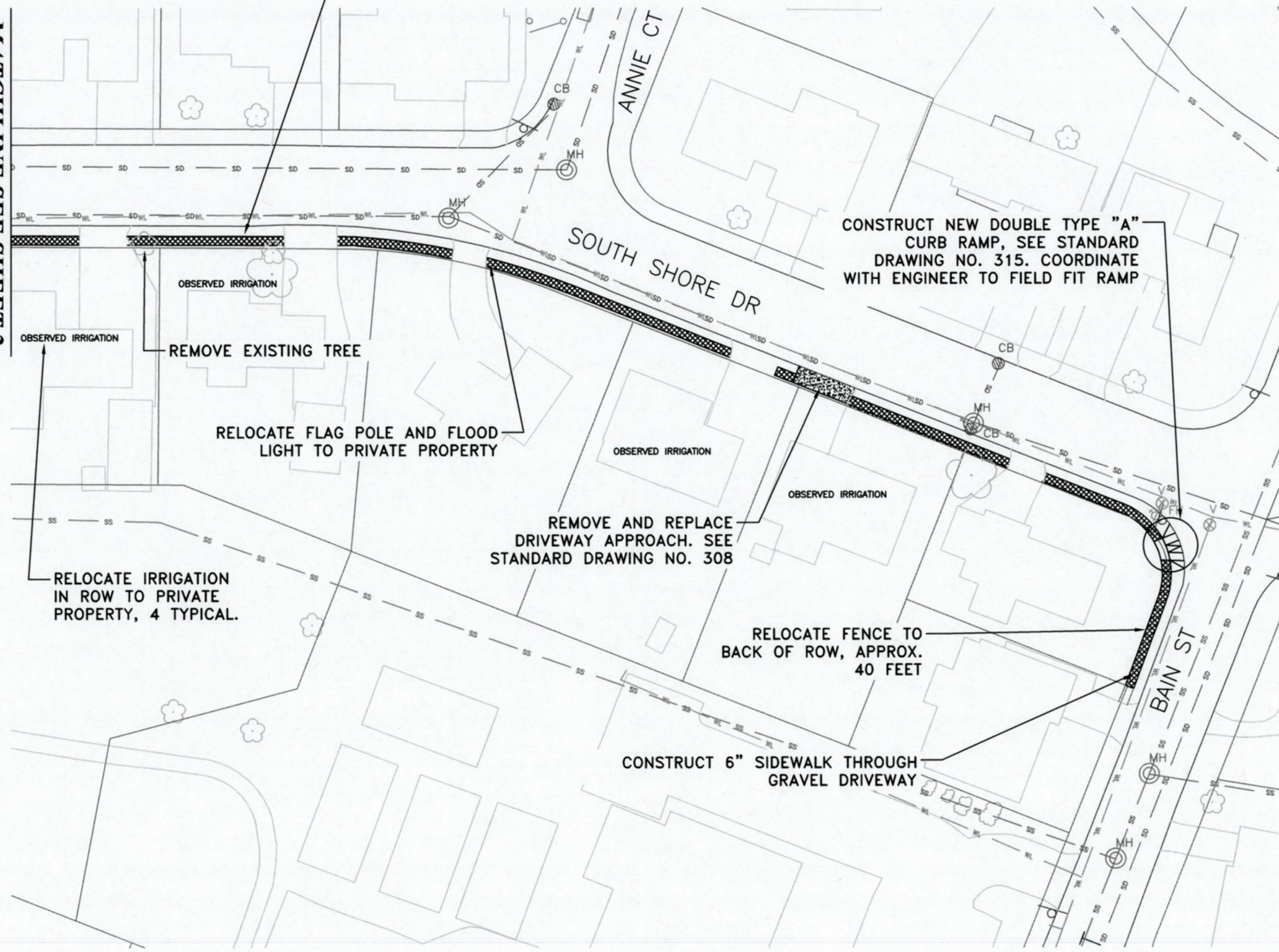

DESIGNED: A. HIEMSTRA	REVISIONS
DRAWN: A. HIEMSTRA	NO: --
CHECKED: S. BELCASTRO	BY: --
DATE: 6/10/19	NO: --
	BY: --
	NO: --
	BY: --
	NO: --

**PUBLIC WORKS DEPARTMENT  
ENGINEERING SERVICES**



**ST-19-05, WAVERLY DRIVE SIDEWALK INFILL  
SIDEWALK CONSTRUCTION**



EXPIRATION DATE: 06/30/2019

SHEET NO. 3 OF 5  
PROJECT NO: ST-19-05  
FILE: BASE.DWG



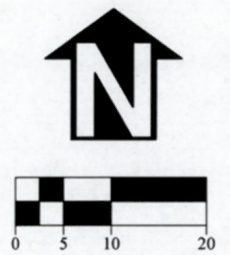
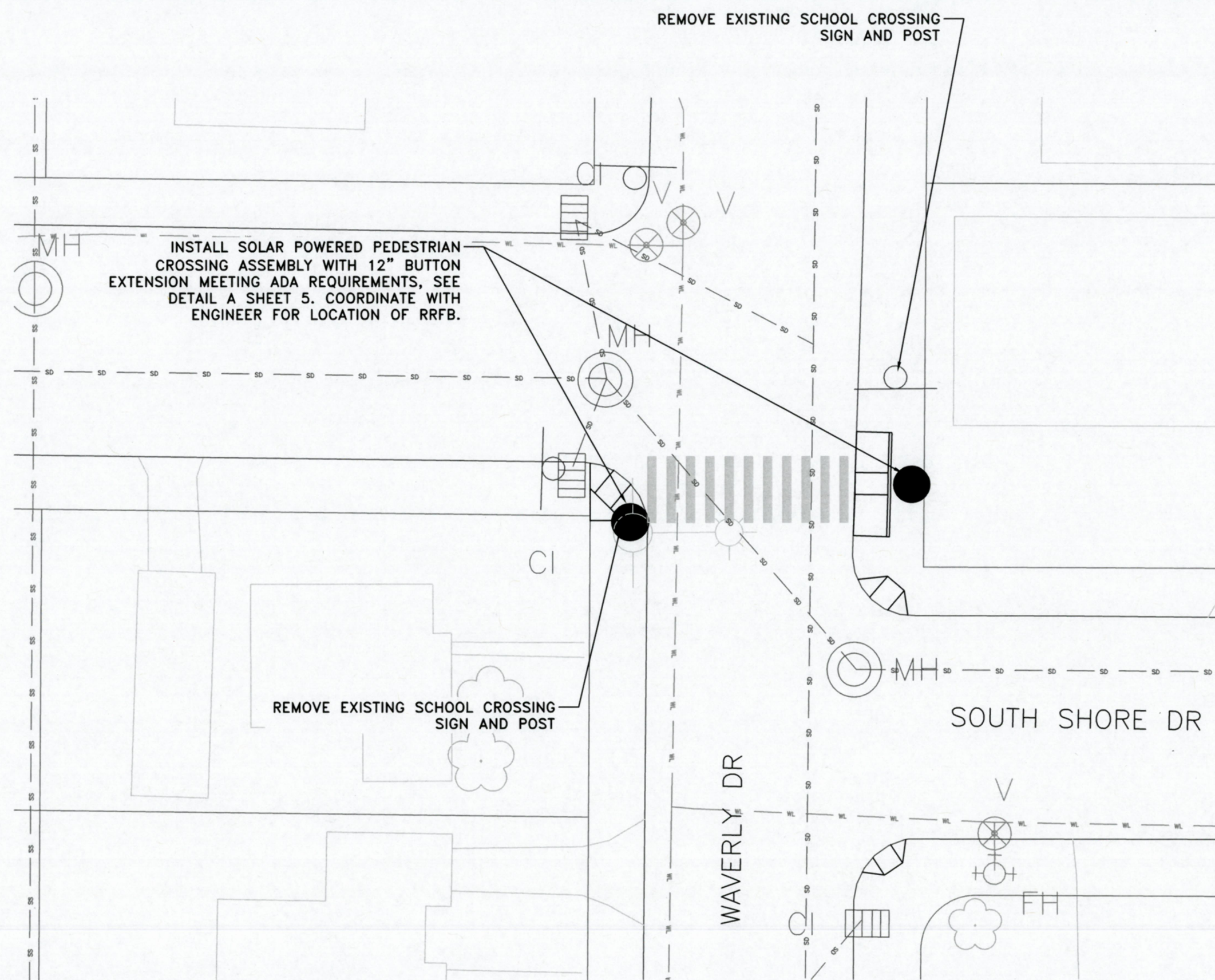

DESIGNED: A. HIEMSTRA	REVISIONS
DRAWN: A. HIEMSTRA	NO: ---
CHECKED: S. BELCASTRO	BY: ---
DATE: 6/10/19	DATE: ---

**PUBLIC WORKS DEPARTMENT**  
**ENGINEERING SERVICES**



**ST-19-05, WAVERLY DRIVE SIDEWALK INFILL**  
**PEDESTRIAN CROSSING PLAN**

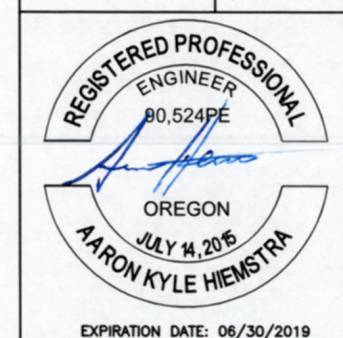

EXPIRATION DATE: 06/30/2019

SHEET NO. 4 OF 5

PROJECT NO: ST-19-05

FILE: BASE.DWG



**DETAIL A**  
**RECTANGULAR RAPID FLASHING BEACON SYSTEM**  
**PEDESTRIAN PEDESTAL INSTALLATION (TWO SIDED)**  
 (NOT TO SCALE)

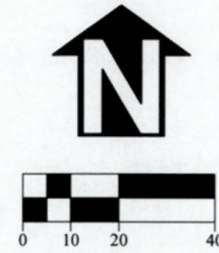

DESIGNED: A. HIEMSTRA	REVISIONS
DRAWN: A. HIEMSTRA	NO:
CHECKED: S. BELCASTRO	BY:
DATE: 6/10/19	
DATE:	

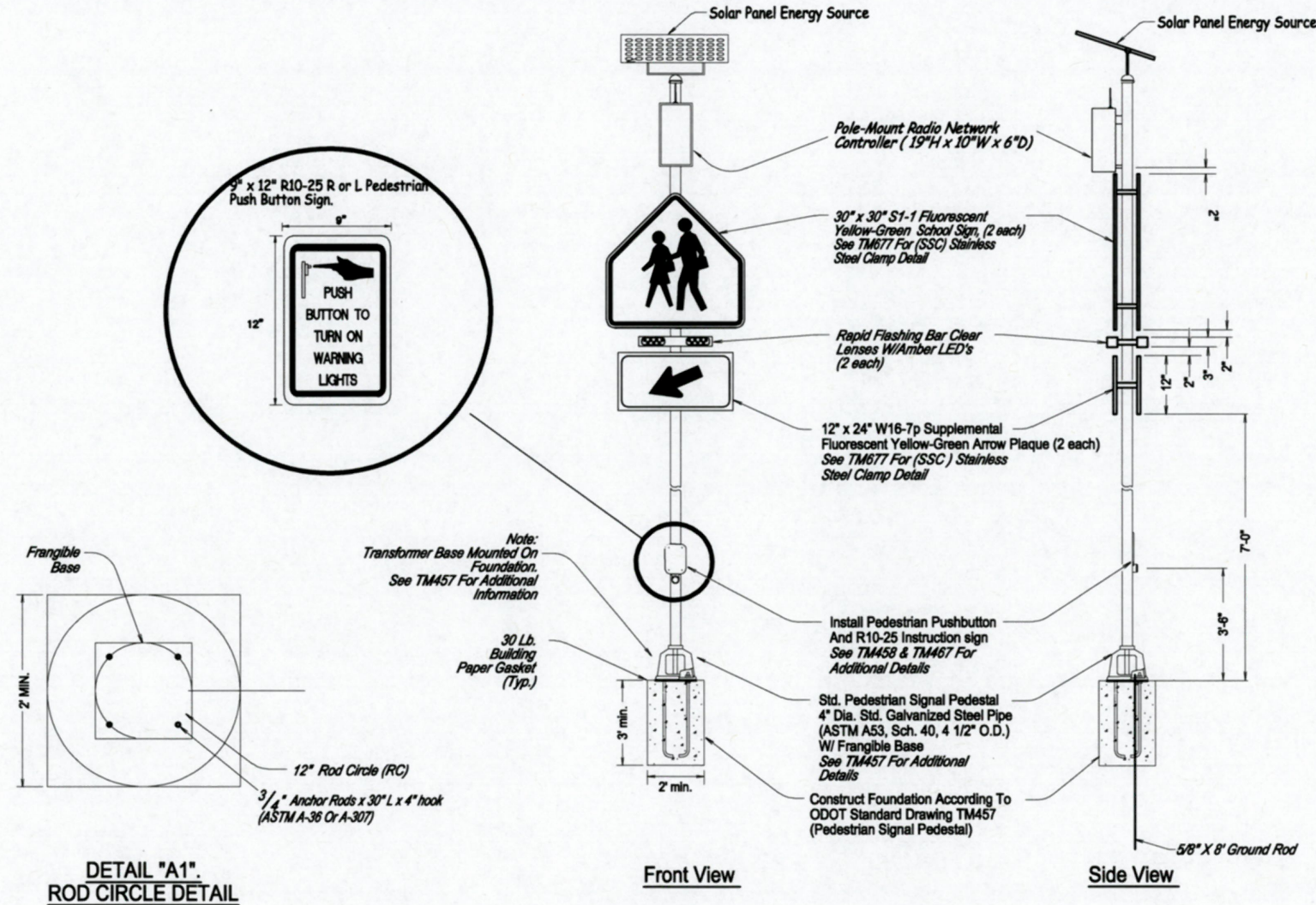

- GENERAL NOTES:**
- Use ODOT Green Sheet Listed Systems Only
  - Install Controller Cabinet As Per the Manufacturer's Recommendations and as directed By the Engineer.
  - Signs shall conform to the Manual on Uniform Traffic Control Devices and Standard Highway Signs Manuals.

**PUBLIC WORKS DEPARTMENT**  
**ENGINEERING SERVICES**



**ST-19-05, WAVERLY DRIVE SIDEWALK INFILL**  
**PEDESTRIAN CROSSING DETAIL**

**REGISTERED PROFESSIONAL ENGINEER**  
 90,524PE  
  
 OREGON  
 JULY 14, 2015  
 AARON KYLE HIEMSTRA

EXPIRATION DATE: 06/30/2019

SHEET NO. 5 OF 5

PROJECT NO: ST-19-05

FILE: BASE.DWG