



CITY OF ALBANY
Public Works Department

ADDENDUM #1

WL-18-02
PINE MEADOWS WATER LINE REPLACEMENT

In order to clarify the intent of the Specifications and Drawings, the following provisions are provided and shall be considered part of the contract documents.

In order to ensure that all bidders are aware of these provisions, each bidder shall sign this addendum below and attach it to the proposal.

IMPORTANT: Failure to include a signed Addendum could result in the disqualification of your bid.

BID OPENING DATE AND TIME:

The bid opening has been rescheduled for **Tuesday, July 24, 2018, at 2:00 p.m.**

CONSTRUCTION DRAWINGS CHANGE:

Sheets 2 and 7 are being replaced in the Construction Drawings.

The following items are clarifications based on questions received:

- All water services are to be copper from the main to the meter and shall include anodes as described in the Standard Construction Specifications. Those anodes can be buried in the main line trench because the main is HDPE.
- Any portion of the water line or fittings can be constructed with a ductile iron substitute. No additional payment will be made if the Contractor chooses to use ductile iron as a substitute for any of the pipe or fittings.
- Hydrant locations shown are general locations. Final locations will be determined in the field to avoid conflicts.
- Hydrant runs will be ductile iron and constructed as shown in the Standard Construction Specifications. Valves will be located per the Standard Construction Specifications and drawings.
- The trench patching shall be three inches under the grind inlay and two inches outside the limits of the grind inlay.
- No pavement fabric will be placed.
- Speed bumps shall be constructed to match existing. They are approximately 2.5 inches high at the center and 30-inches wide.
- The curbs are not structurally different than the sidewalk and shall be paid for within the sidewalk replacement bid item.
- The Contractor will be allowed to maintain gravel trench surfaces during construction, provided the gravel surfaces are maintained in good condition and loose rock is swept up on a daily basis. If the Engineer determines that trenches are not being maintained in good condition, temporary hot mix or cold mix trench patching shall be placed at the Contractor's expense. Temporary trench patching shall be considered incidental to other bid items.

- All driveways that have meters in the center will require the stamped concrete, not just the ones with four meters.

The following bid item descriptions shall replace the bid item descriptions within the Contract Documents:

Item No. 14 – STA 27+10 6-Inch × 8-Inch Connection Assembly:

See Special Provisions and Construction Drawings.

This bid item includes provision and installation of all specified and unspecified materials necessary to connect the existing 6-inch ductile Asbestos Cement water line and the new 8-inch HDPE water line and coordination of a scheduled water shutdown. Abandoned piping shall be plugged with concrete a minimum distance equal to two pipe diameters.

Provision and installation of locking gaskets and retainer glands are incidental to this bid item. Payment for 6-inch D.I. piping and any fittings shall be included in this bid item. Valves shall be paid for under a separate bid item.

Payment for this bid item will be made on a lump-sum basis and shall include all equipment, labor, materials, and incidentals required to complete the work.

SCHEDULE OF CONTRACT PRICES:

An updated Schedule of Contract Prices is attached.

- Bid Item No. 8, 8-Inch Gate Valve: Bid item quantity changed from 8 to 9.
- Bid Item No. 10, 4-Inch Gate Valve: Bid item quantity changed from 2 to 3.
- Bid Item No. 11, 10-Inch Butterfly Valve: Bid item quantity changed from 2 to 4.

Contractor's Signature

Date

Company Name *(please type or print)*

SCHEDULE OF CONTRACT PRICES

ITEM NO.	BID ITEMS	APPROX. QUANTITY	UNIT OF MEASURE	UNIT PRICE DOLLARS/CTS	TOTAL AMT. DOLLARS/CTS
1	Mobilization	1	LS		
2	Temporary Traffic Control	1	LS		
3	Erosion Prevention and Sediment Control	1	LS		
4	8-Inch HDPE Water Line	3,100	LF		
5	4-Inch HDPE Water Line	870	LF		
6	Standard 1-Inch Service Assembly	169	EA		
7	2-Inch Service Assembly	2	EA		
8	8-Inch Gate Valve	9	EA		
9	6-Inch Gate Valve	7	EA		
10	4-Inch Gate Valve	3	EA		
11	10-Inch Butterfly Valve	4	EA		
12	Standard Fire Hydrant Assembly	7	EA		
13	STA 0+00 8-Inch x 8-Inch Connection Assembly	1	LS		
14	STA 27+10 6-Inch x 8-Inch Connection Assembly	1	LS		
15	STA 30+70 10-Inch x 8-Inch Connection Assembly	1	LS		
16	2-Inch Blow-Off Assembly	2	EA		
17	Abandon Existing Water Main	1	LS		
18	Remove and Replace 6-Inch PCC Driveway	700	SY		
19	1-1/2-Inch Asphalt Overlay	965	TON		
20	2-Inch Asphalt Trench Patch	630	SY		
21	3-Inch Asphalt Trench Patch	2,200	SY		
22	1-1/2-Inch Asphalt Grinding	8,700	SY		
23	Remove and Replace 6-Inch PCC Sidewalk	485	SY		
24	Remove and Replace Speed Bumps	6	EA		
25	Adjust Fixtures to Grade	1	LS		
SUM OF EXTENDED TOTALS					

NOTE: Subject to change if addition or extensions are in error.

_____	_____	_____
Bidder's Signature	Company Name <i>(please print)</i>	Date
_____	_____	_____
Bidder's Name <i>(please print)</i>	Mailing Address <i>(please print)</i>	CCB License Number
_____	_____	_____
Bidder's Title <i>(please print)</i>	City, State Zip	Federal Tax ID Number
Telephone No.: _____	Fax No.: _____	Email: _____

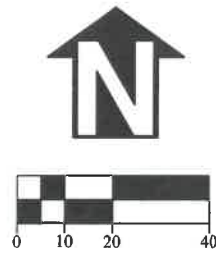

CONSTRUCT STANDARD 2"
SERVICE ASSEMBLY. SEE
STANDARD DRAWING NO. 507
LOCATION TO BE SPECIFIED IN
THE FIELD BY THE ENGINEER

CONSTRUCT STANDARD 2"
SERVICE ASSEMBLY. SEE
STANDARD DRAWING NO. 507
LOCATION TO BE SPECIFIED IN
THE FIELD BY THE ENGINEER

STA. 2+35
INSTALL 8"x6" HDPE TEE
INSTALL 6" MJ GATE VALVE
WITH MJ ADAPTERS (W)
INSTALL FIRE HYDRANT ASSEMBLY
SEE STANDARD DRAWING NO. 504

STA. 4+35
INSTALL 8"x6" HDPE TEE
INSTALL 6" MJ GATE VALVE
WITH MJ ADAPTERS (W)
INSTALL FIRE HYDRANT ASSEMBLY
SEE STANDARD DRAWING NO. 504
INSTALL 8" MJ GATE VALVE WITH
MJ ADAPTERS (NE)

CONSTRUCT STANDARD 1"
SERVICE ASSEMBLY. SEE
STANDARD DRAWING NO. 507
LOCATION TO BE SPECIFIED IN
THE FIELD BY THE ENGINEER
(17) TYPICAL THIS SHEET

STA 0+00 CONNECTION
SEE DETAIL 1 ON SHEET 8

PINE MEADOW DRIVE

STA 0+00
BEGIN OVERLAY

DESIGNED: N. NELSON	REVISIONS
DRAWN: N. NELSON	NO: 1
CHECKED: S. BELCASTRO	DATE: 7/13/18
DATE: 6/29/2018	BY: N/N

PUBLIC WORKS DEPARTMENT
ENGINEERING SERVICES

WL-18-02, PINE MEADOWS WATER LINE REPLACEMENT
PINE MEADOW DR STA 0+00 TO 4+50

REGISTERED PROFESSIONAL
ENGINEER
82577PE
Nolan J. Nelson
OREGON
JUNE 29, 2009
NOLAN J. NELSON

EXPIRATION DATE: 12/31/2018

SHEET NO.	2 OF 11
PROJECT NO:	WL-18-02
FILE:	BASE.DWG

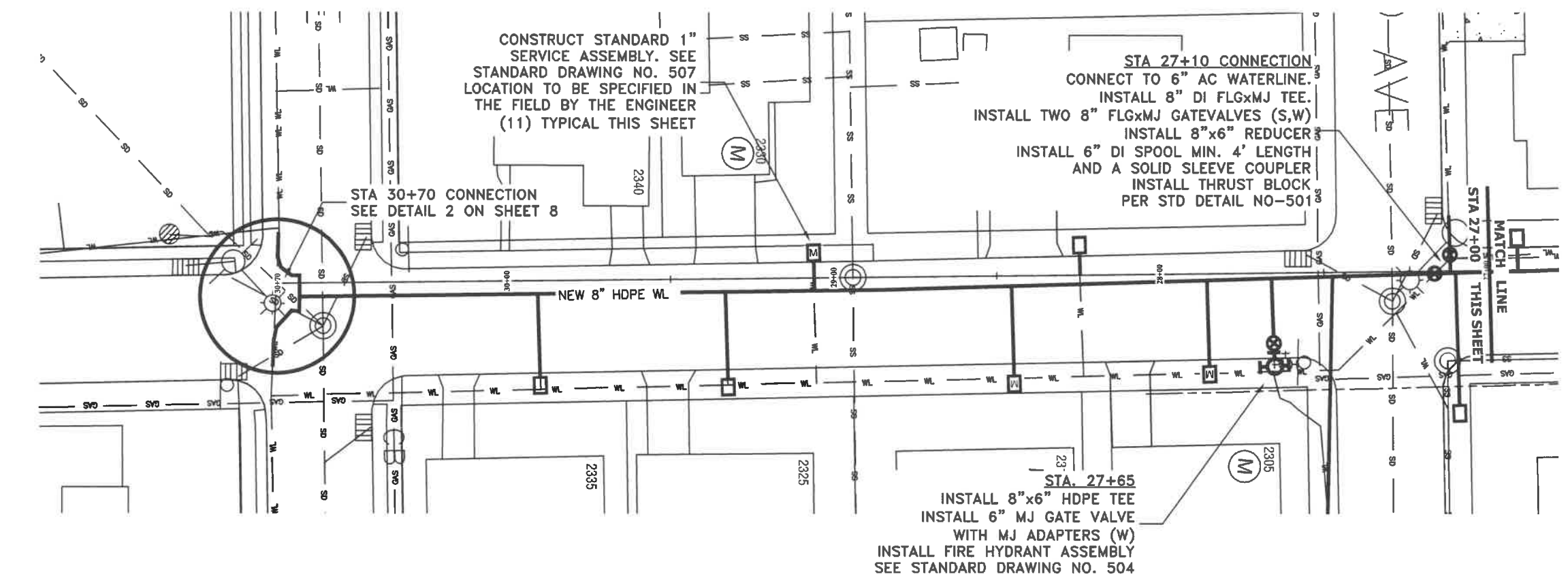
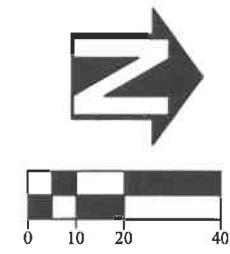
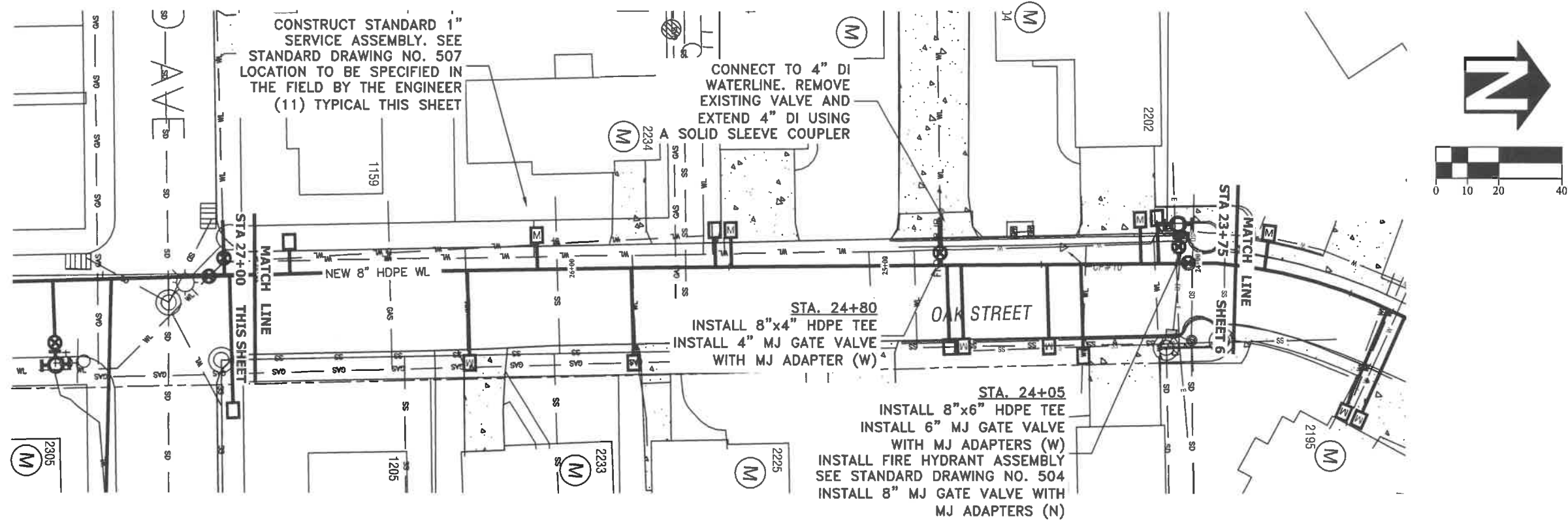

DESIGNED: N. NELSON
 DRAWN: N. NELSON
 CHECKED: S. BELCASTRO
 DATE: 6/29/2018

REVISIONS	NO.	BY	DATE
	1	NUN	7/13/18

PUBLIC WORKS DEPARTMENT
ENGINEERING SERVICES

WL-18-02, PINE MEADOWS WATER LINE REPLACEMENT
 PINE MEADOW DR STA 24+25 TO END

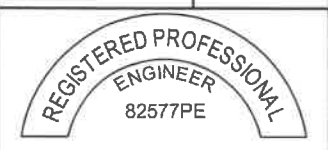

EXPIRATION DATE: 12/31/2018

SHEET NO. 7 OF 11
 PROJECT NO: WL-18-02
 FILE: BASE.DWG