

PD-01-25, RL-04-25, SP-05-25, NR-01-25, and FP-01-25

**East Campus Expansion of Mennonite Village
(Planning Commission, August 18, 2025)**

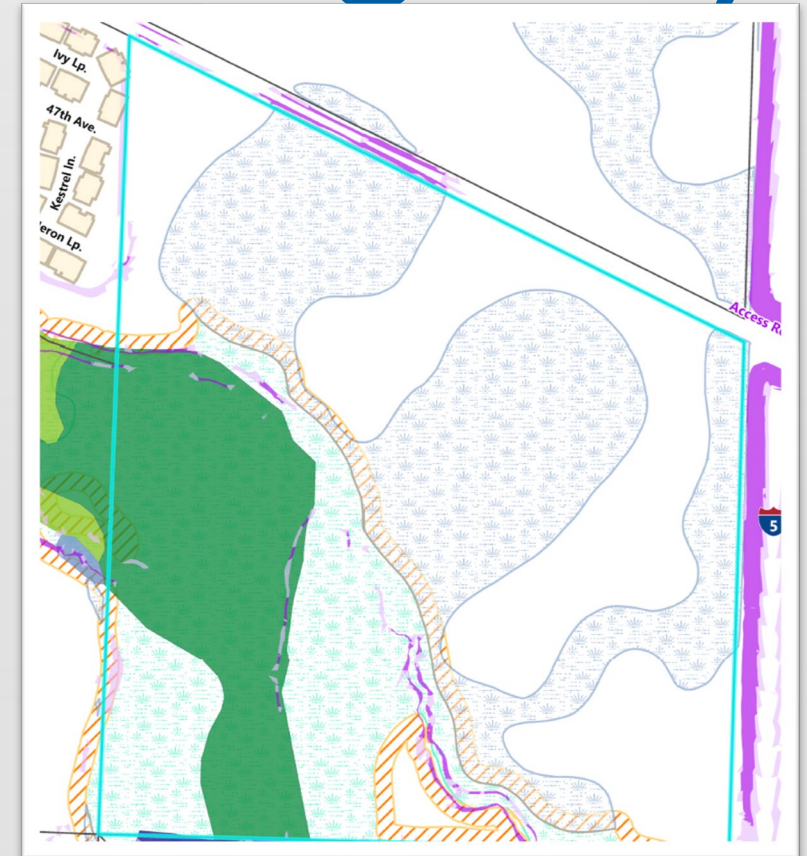

Subject Property (Unassigned)

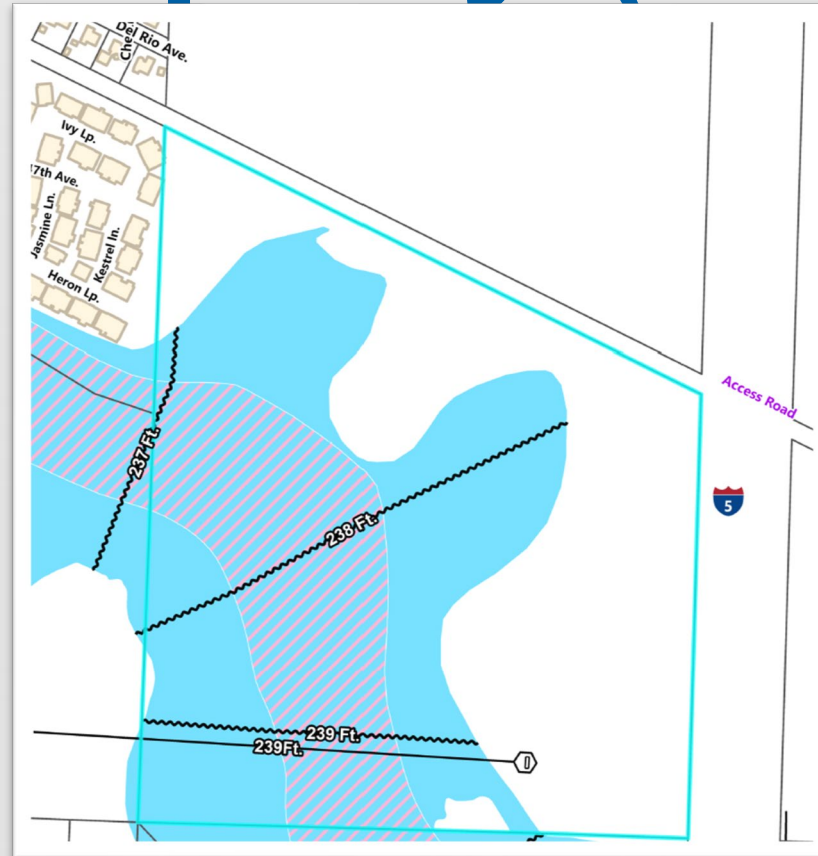
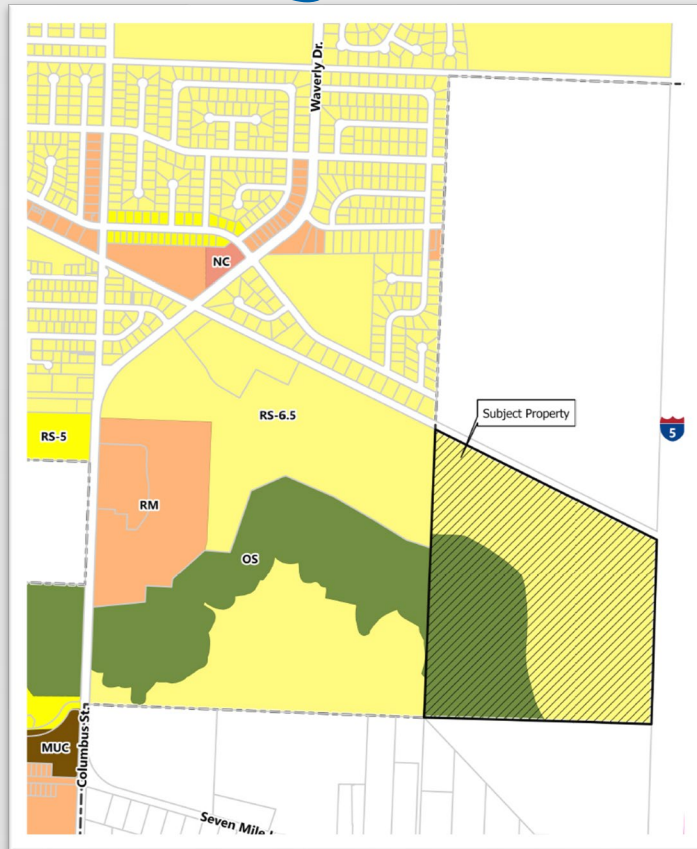

The Proposal

The applicant seeks approval for a Planned Development to develop 98 duplexes for a senior housing development. The application also includes a Replat to consolidated two parcels into on 147.01-acre property; a Site Plan Review for the Felling of 21 Trees; a Natural Resource Impact Review for development within the Riparian Corridor, and a Floodplain Development Review for grading and paving within the Special Flood Hazard Area.



Review Criteria

- Criteria for the application can be found in ADC:
 - 11.310-11.340
 - 11.180
 - 2.450
 - 9.205
 - 6.310
 - 6.110.



Proposed Conditions

Staff's proposed conditions are located on pages 50-53 of the Staff Report.



Decision Options

- Option 1: Approve the requests as proposed and conditioned
- Option 2: Approve the requests with amendments.
- Option 3: Deny the requests.



Questions?

